

# MHF<sup>®</sup>I Connector

## <for MHFI PLUG(2.00)>

### Instruction Manual

Rev.	ECN	Date	Prepared by	Checked by	Approved by
1	S23411	November 21, 2023	K.Tanaka	K.Yufu	Y.Hashimoto
0	S17382	May 17, 2017	S.Hamada	T.Hirakawa	K.Yotsutani

This manual is to explain the insertion & with drawal methods and important points in handling of MHF connector PLUG with cable for the purpose of proper use.

### 【Pushing & Pulling JIG】

To avoid excessive stress to cable connection points, it is recommended to use special jig as show in Fig.1  
The cable connector has a design feature to hook this "Pushing & Pulling JIG".(see Fig.2)

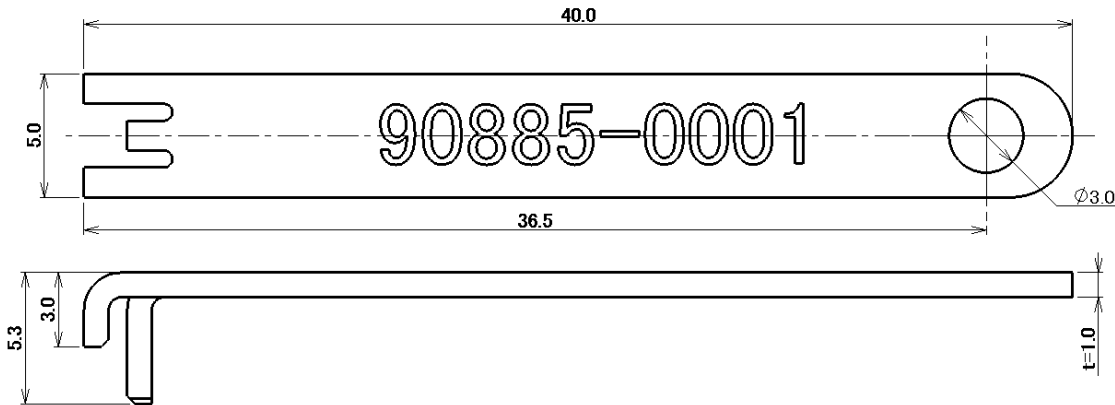

Unit : mm

Fig.1 (Recommendation : Pushing & Pulling JIG \*P/N: 90885-0001)

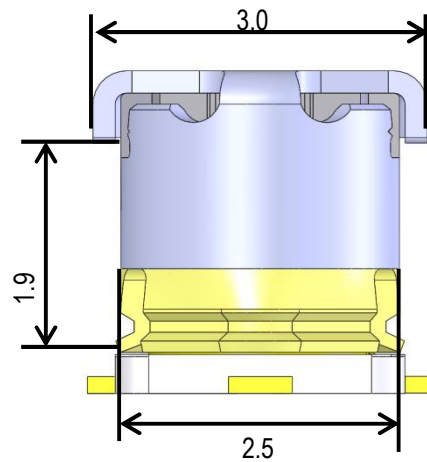

Unit : mm

Fig.2 PLUG connector design feature to hook pull jig)

**【Connector insertion manual】****1. In case of mating by hand**

## ① How to hold a cable connector

Hold the both ends of cable connector as show in Fig.3.

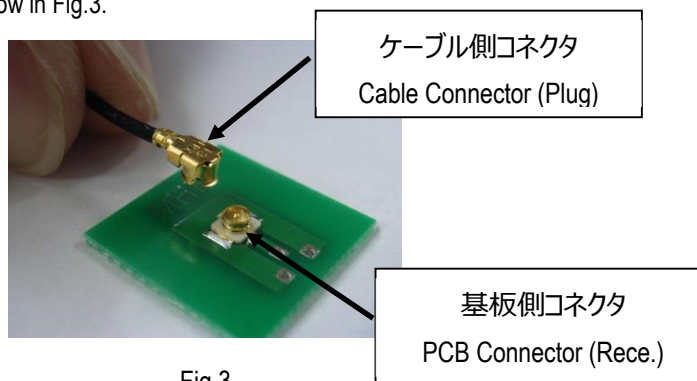
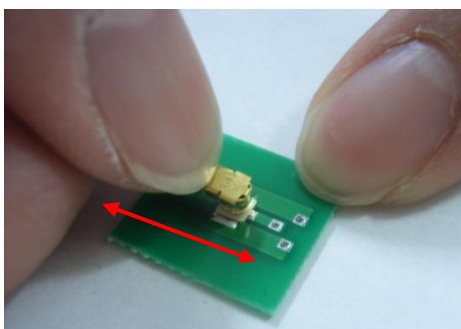

Fig.3

## ② Which direction to mate

Set connectors of the board side and of the cable side as shown in Fig.4.

Please check they are set firmly by moving back and forth slightly.



Move back and forth slightly. Cable connector should not move.

Fig.4

## ③ How to mate

Push cable connector at it's center location vertically as show in Fig.5. When click sound can be heard "the connector mating action is complete".

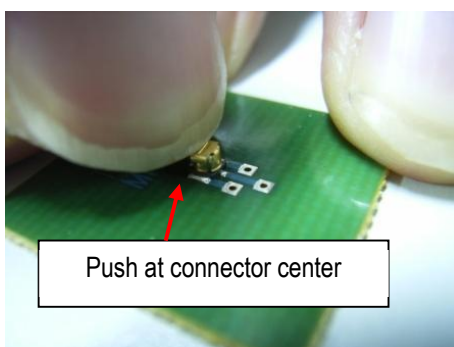

Fig.5

## CAUTION

Please make sure to set the cable side connector parallel to the board. If you mate in not parallel condition as shown in Fig.8, connector will be damaged.

Correct connector mating Parallel <OK>

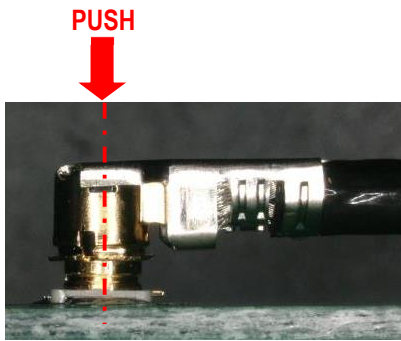

Fig.6

Wrong connector mating Not parallel <NG>

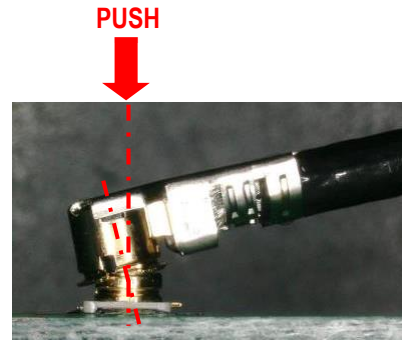

Fig.7

## 2. In case of mating by Pushing & Pulling JIG

- ① Slide the "Pushing & Pulling JIG" from the direction of drawing out of a cable and attach to the cable connector.(see Fig.8-a)
- ② The jig must be moved until it reach a stopper just as it hold the cable connector. (see Fig.8-b)
- ③ Push to the jig vertically to the PCB surface (PCB Connector).(see Fig.8-c)

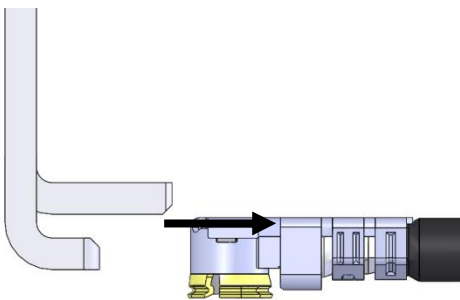

Fig.8-a

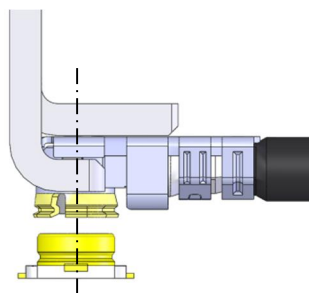

Fig.8-b

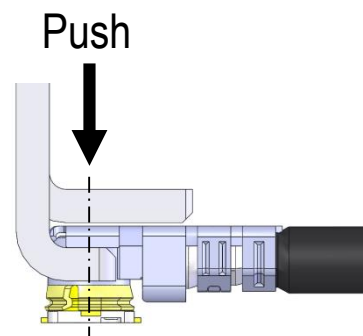

Fig.8-c

**【How to with draw cable connector】**

- ① Slide the “pull jig” from the opposite side of a cable and attach to the cable connector. (see Fig.9-a)
- ② The jig must be moved until it reach a stopper just as it hold the cable connector . (see Fig.9-b)
- ③ Lift up the jig vertically to the PCB surface. (see Fig.9-c)

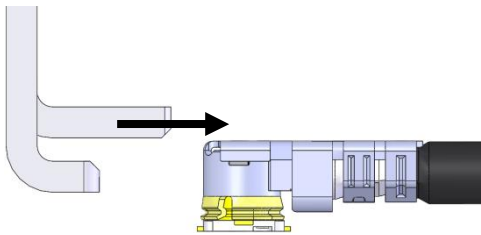

Fig.9-a

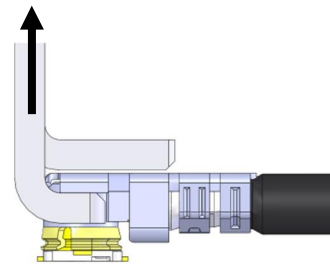

Fig.9-b

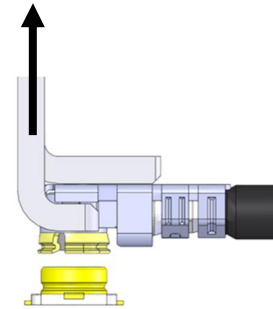

Fig.9-c

**CAUTION**

- Do not unmate a cable connector by pulling cable.
- ” Pushing & Pulling jig” must be lifted up vertically to PCB surface.
- In case you withdraw the cable connector by hand, You must lift it up vertically by holding the hook area which is located at both connector ends.

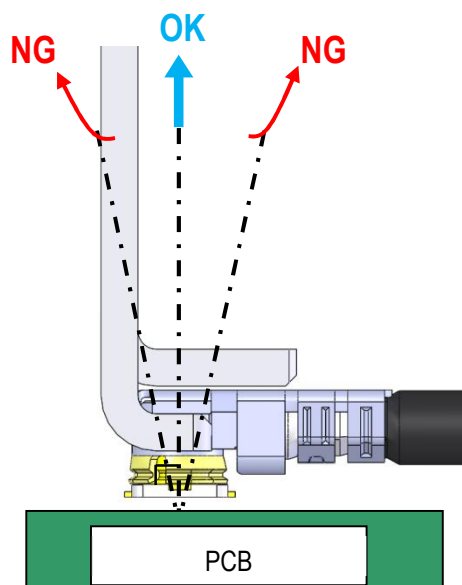

Fig.10

## 【Caution in cable connector handling】

In the case of figure 12, it has possibility to damage to the housing and come off from rece. connector.

Especially when operator give continuous force to the direction(black allow),the tendency become higher.

So please take care of handling of harness.

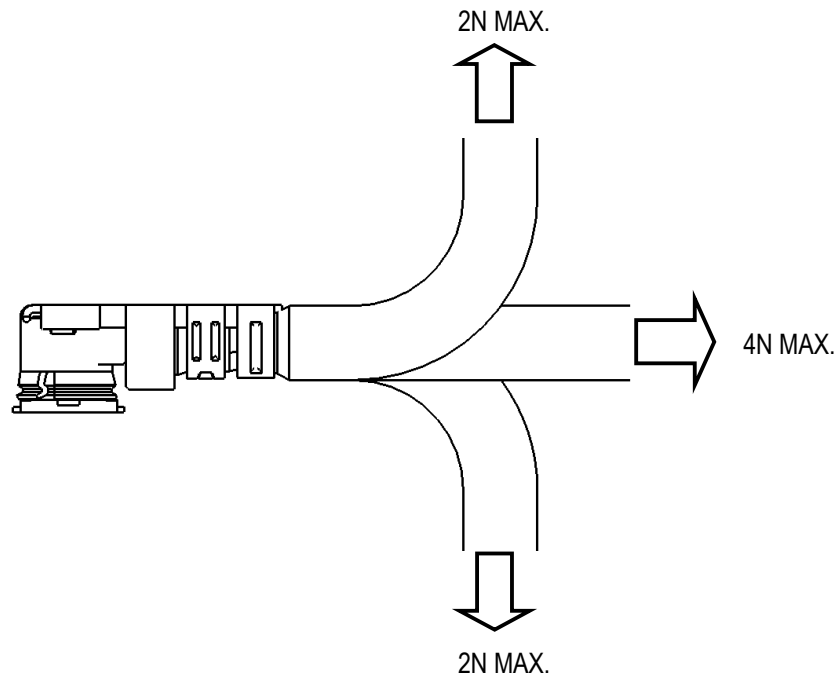

Fig.12