

MHF[®]-SW23 PLUG

极细RF同轴线公座，匹配MHF[®]-SW23 RF开关PCB母座

Product Specifications:

Mated Height (mm max.)	3.7	
Rece. SMT Size (mm)	2.3 x 2.3	
Applicable Frequency	DC ~ 9GHz	
Characteristic Impedance	50 ohm	
VSWR (L=100 mm)	0.3 ~ 3 GHz	1.4 max.
	3 ~ 6 GHz	1.6 max.
	6 ~ 9 GHz	2.0 max.

Applicable Cable Size:

O.D. 1.13 mm / AWG 32

Applicable Standards (Reference Only):

5G sub-6, Wi-Fi 6, LTE/LTE-Advanced, LPWA, Bluetooth, GPS



可灵活选择板载天线或外置天线

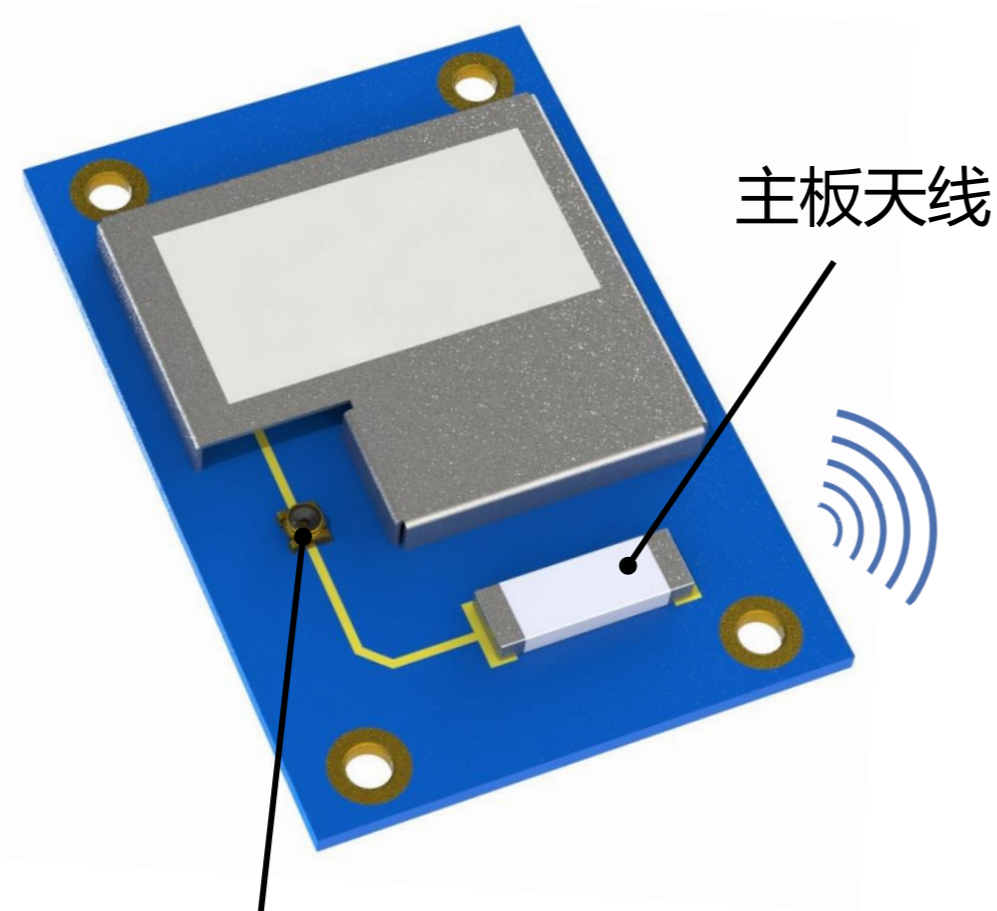

MHF[®]-SW23 (RF 开关)

主板天线

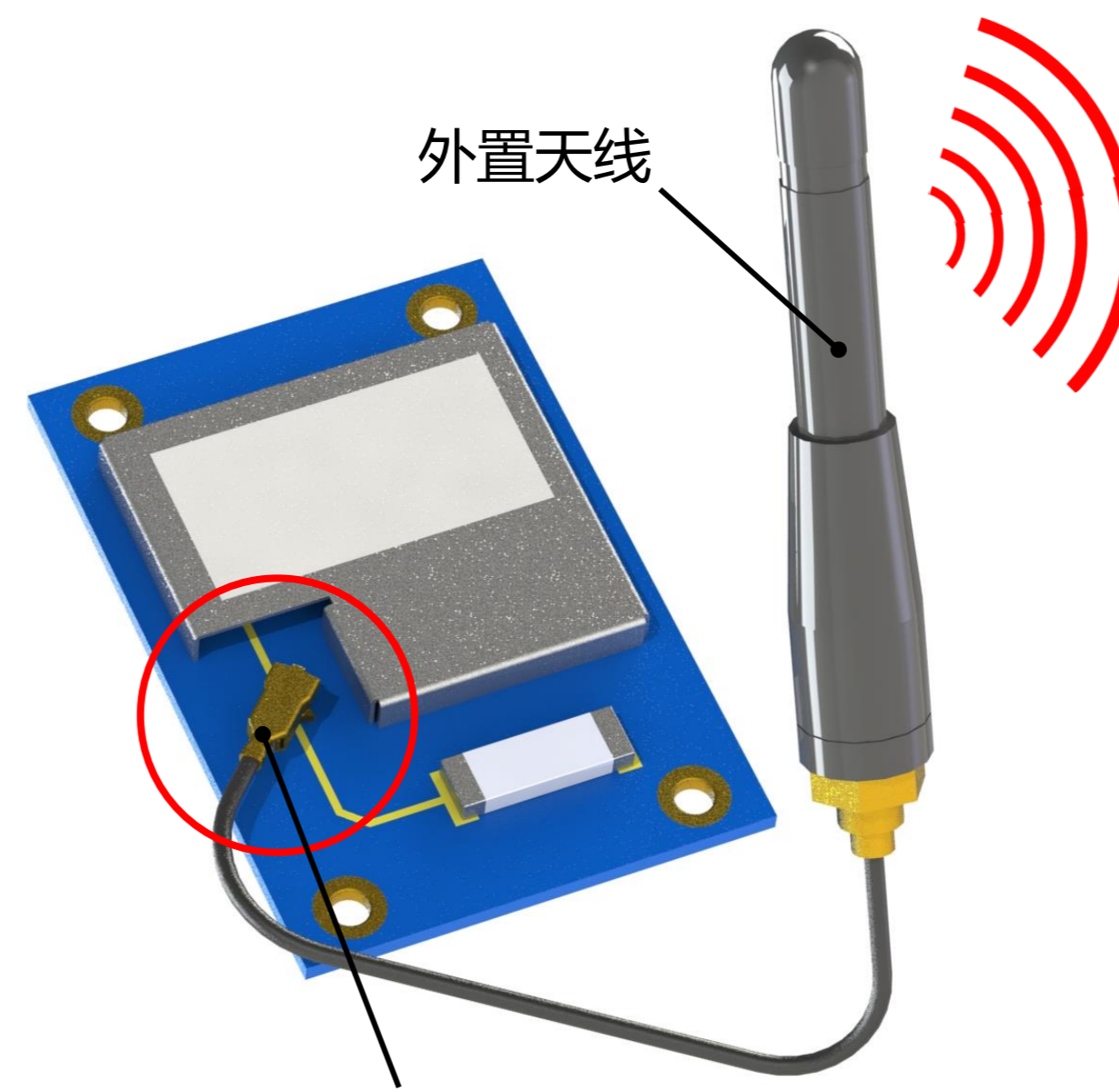

MHF[®]-SW23 PLUG & MHF[®]-SW23

外置天线

匹配RF开关连接器的新选择



RF开关连接器
MHF[®]-SW23

MHF[®]-SW23

公座线束



用于天线连接

线缆探头

摩擦锁



高循环使用系列

普通探头



浮动探头



SMA适配器

适用的线束配置

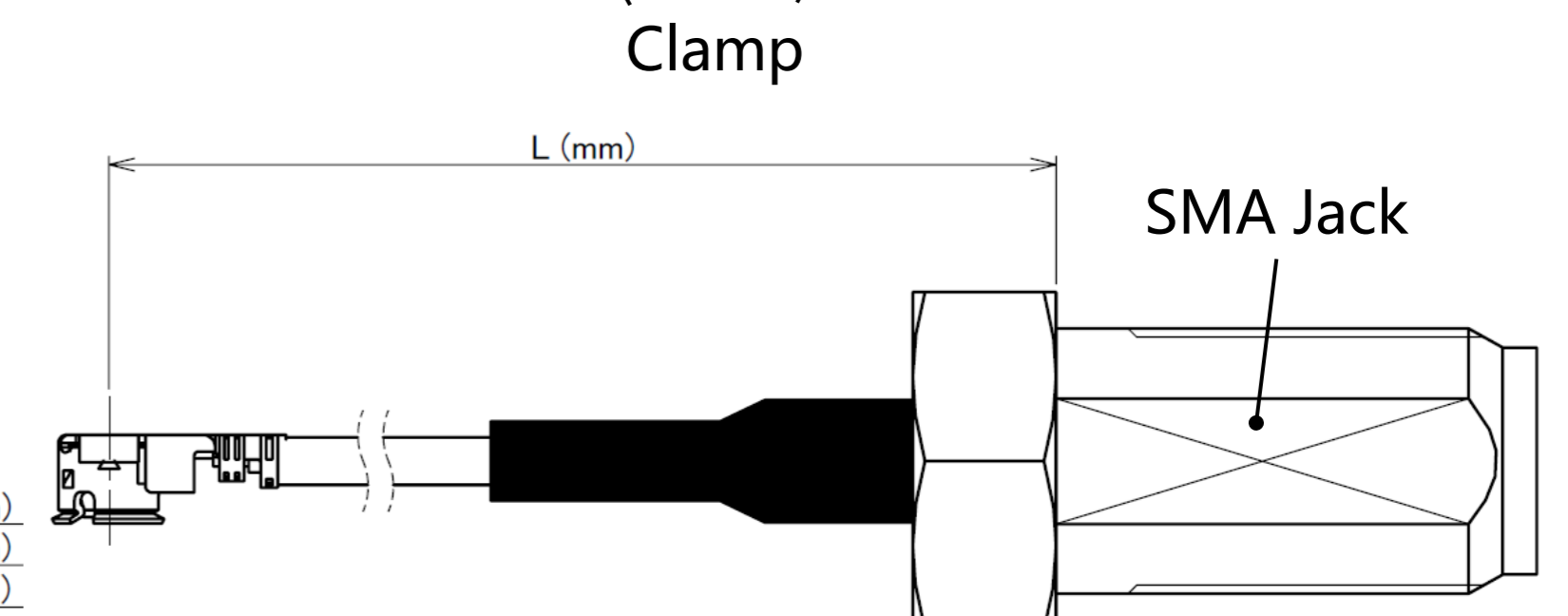
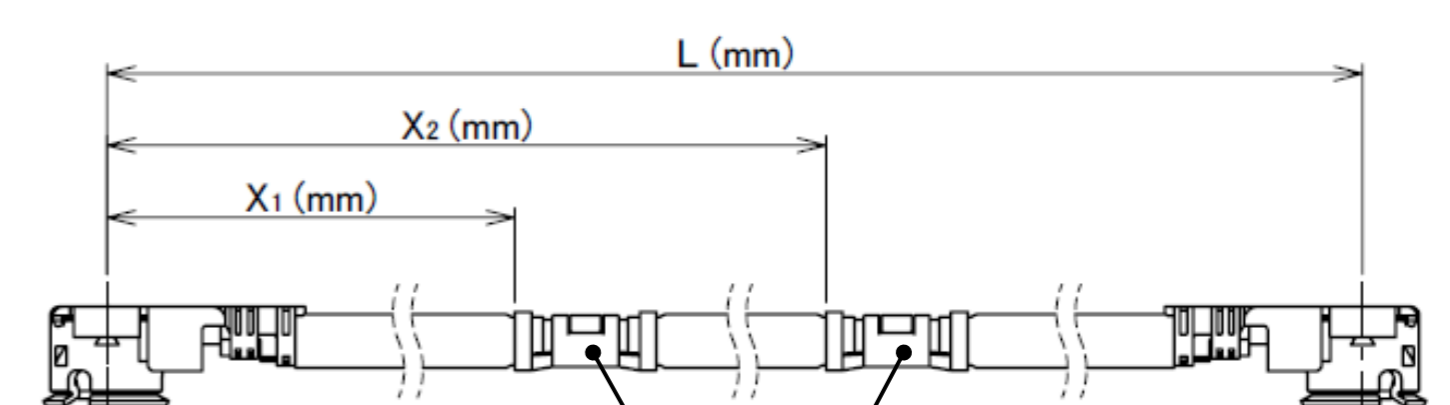
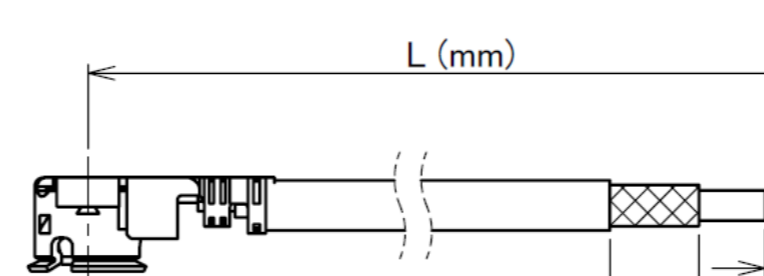
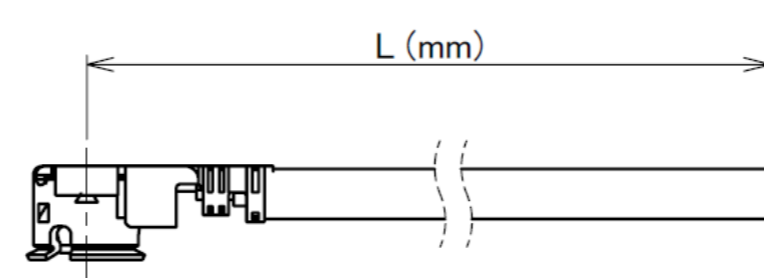
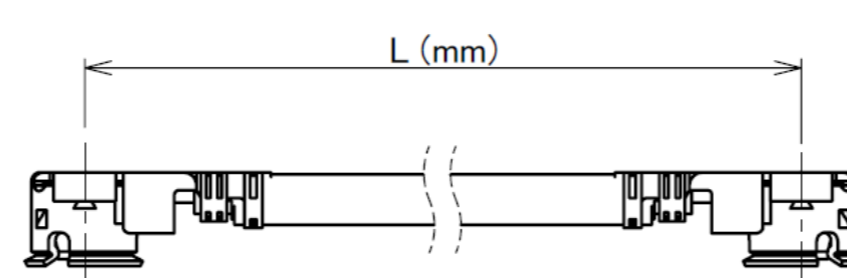

Component Parts Details

MHF®-SW23 PLUG

Recommended P/N	20851-001R
PART No.	20851-001R

Offered as harness only.

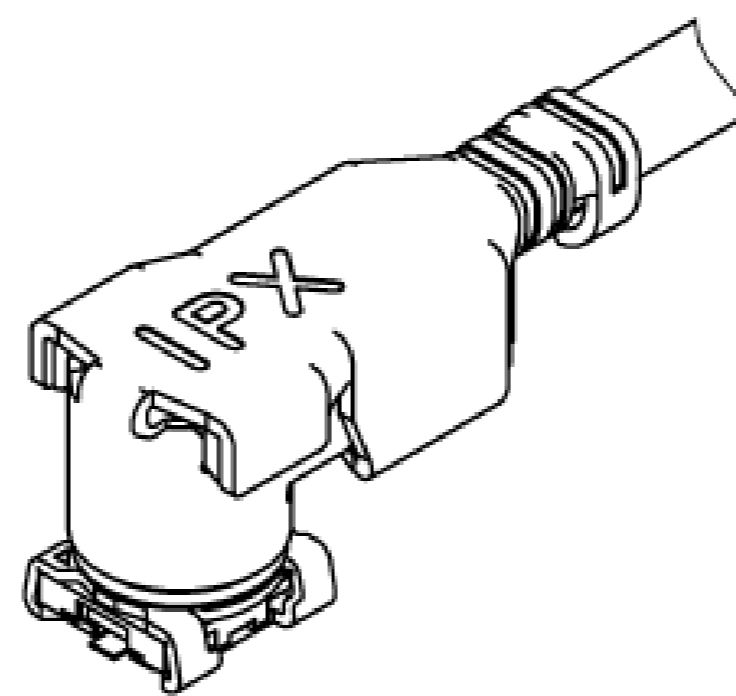
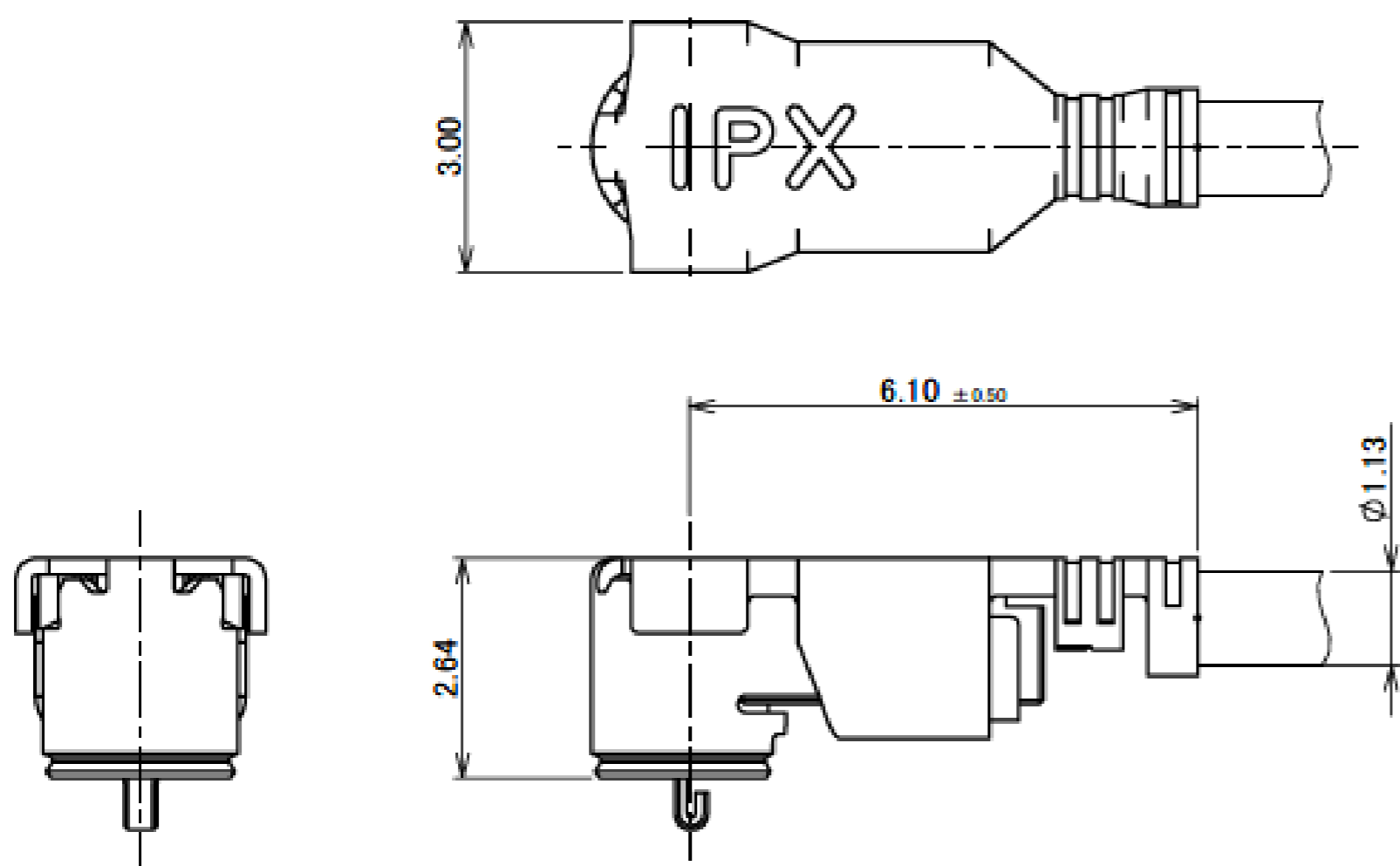
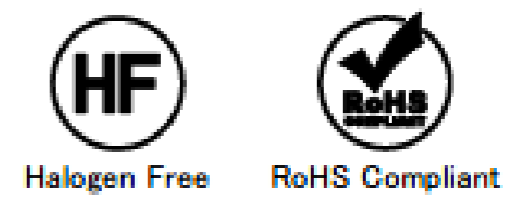

NOTES
 1. MATING AND UNMATING INSTRUCTION
 1-1. MATING
 MATE THE CONNECTOR VERTICALLY AS MUCH AS POSSIBLE, ADJUSTING THE MATING AXIS OF PLUG AND SWITCH. DO NOT SLANT MATE.
 1-2. UNMATING
 USE THE MATING AND UNMATING TOOL (PART NO. 91396-0001) AS THE FOLLOWING DRAWING, AND PULL PLUG TO VERTICAL DIRECTION AS DIRECTLY AS POSSIBLE.
 2. PERMISSIBLE LOAD OF CABLE AT MATING.

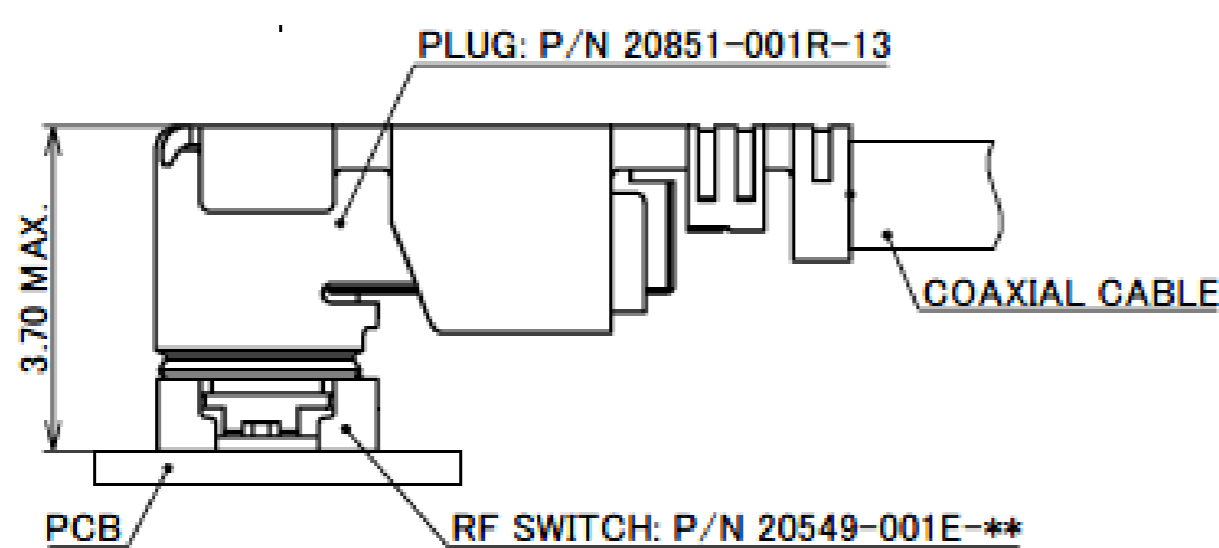
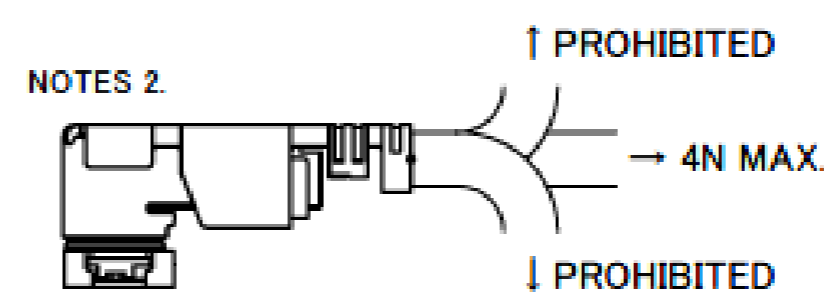
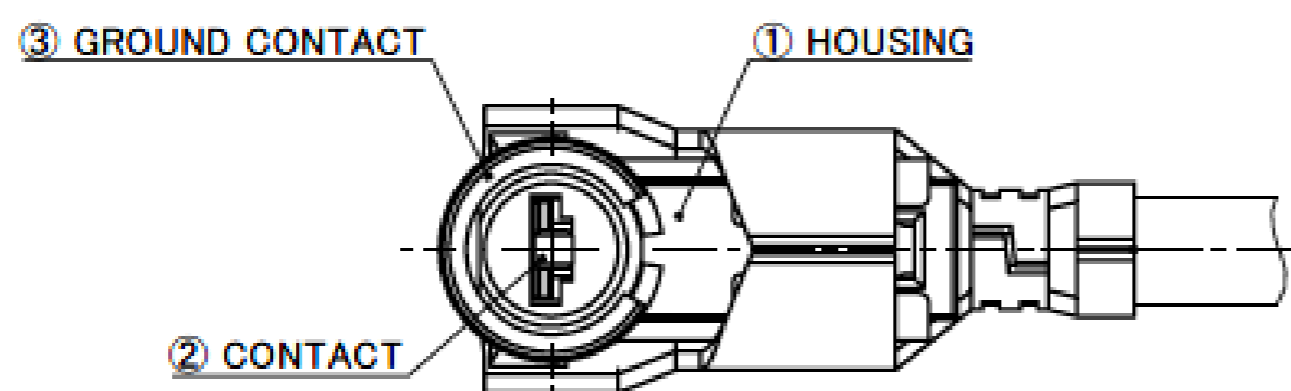
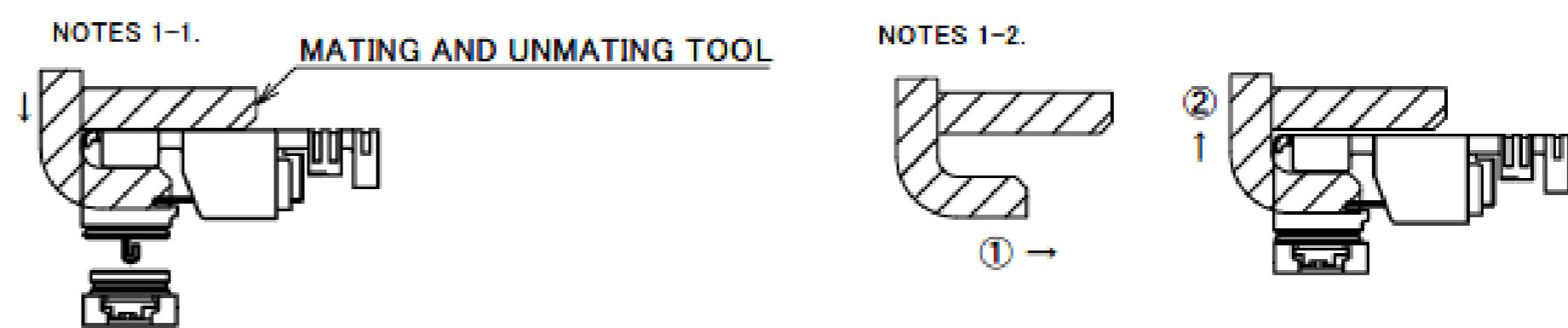

MATING CONDITION

NO.	DESCRIPTION	MATERIAL	FINISH, REMARKS
3	GROUND CONTACT	PHOSPHOR BRONZE	Au OVER Ni
2	CONTACT	PHOSPHOR BRONZE	Au OVER Ni
1	HOUSING	LCP	UL94V-0, BLACK

MHF®-SW23 PLUG

ITEMS	SPECIFICATION
APPLICABLE CONNECTOR PART No.	20549-001E-**
RATING FREQUENCY	DC~9 GHz
OPERATING TEMPERATURE	233~358 K (-40°C~+85°C)
OPERATING HUMIDITY	90% MAX.(NON-CONDENSING)
VSWR (MATED WITH SMA ADAPTER No. 91183-0001)	1.40 MAX. AT 0.3~3 GHz 1.60 MAX. AT 3~6 GHz 2.00 MAX. AT 6~9 GHz
MAIN CONTACT RESISTANCE	INITIAL : 100 mohm MAX. / AFTER TEST : 100 mohm MAX.
GROUND CONTACT RESISTANCE	INITIAL : 100 mohm MAX. / AFTER TEST : 100 mohm MAX.
INSULATION RESISTANCE	INITIAL : 1000 Mohm MIN. / AFTER TEST : 10 Mohm MIN.
DIELECTRIC WITHSTANDING VOLTAGE	AC 200 V 1min
DURABILITY	30 CYCLES
UNMATING FORCE (INITIAL / AFTER TEST)	5 N MIN. / 3 N MIN.
CRIMP STRENGTH	10 N MIN.
PRODUCT SPECIFICATION	PRS-2522
TEST REPORT	TR-18076
PACKING STANDARD	PST-19024
INSTRUCTION MANUAL	HIM-18020
APPEARANCE CRITERIA No.	QLS-A***

Rev.2

Accessories for MHF®-SW23 PLUG

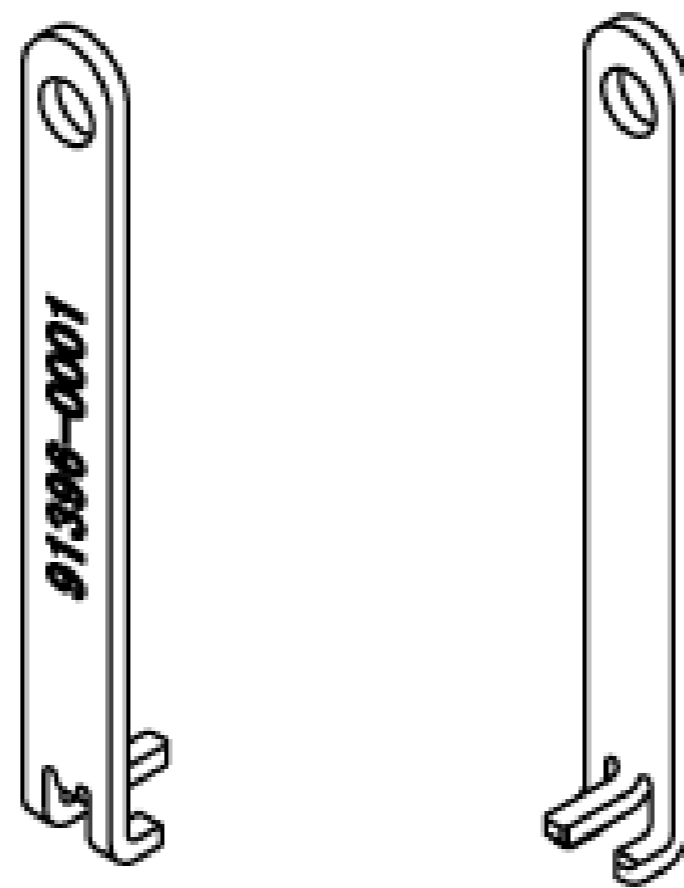

MHF-SW23 PLUG MATING AND UNMATING TOOL
PART NO. 91396-0001

Rev.2

Custom Connectors Available

 RF Connectors

MHF® series

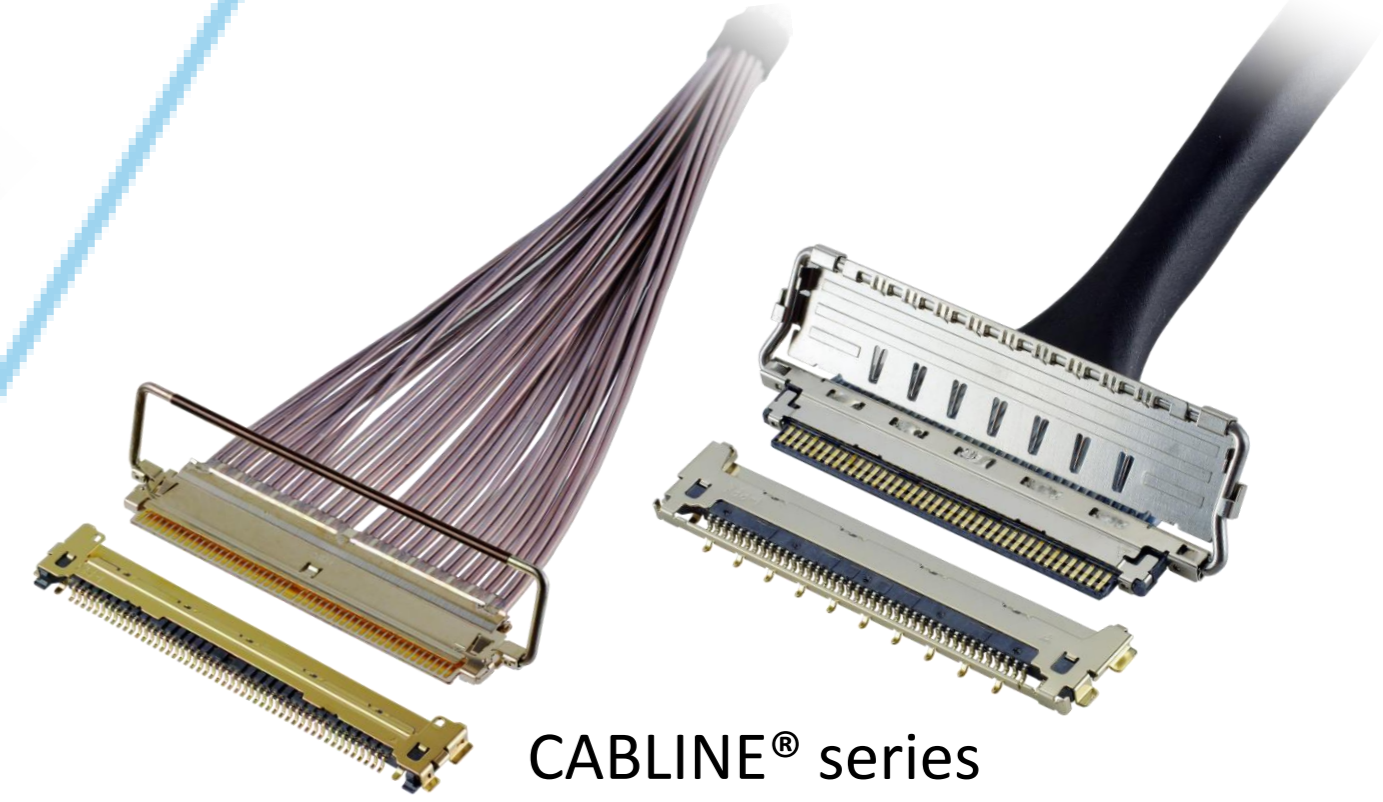

CABLINE® series



Micro-coaxial/Twinax Connectors



Wire-to-Board Connectors/Terminals

AP series



ISH® series

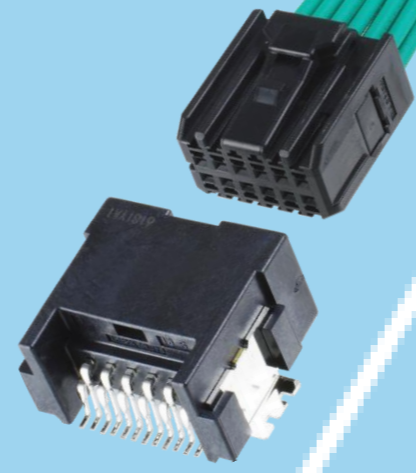

NOVASTACK® series



Board-to-Board Connectors



I/O Connectors

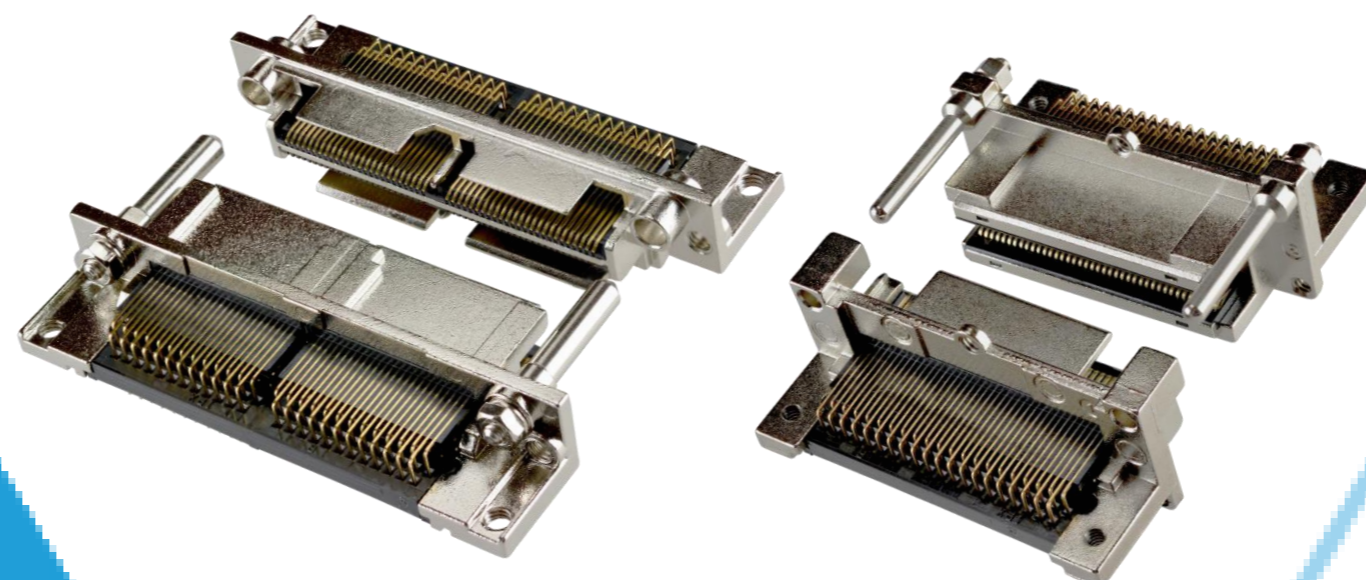

MINIDOCK™ series

MINIFLEX® series

EVAFLEX® series

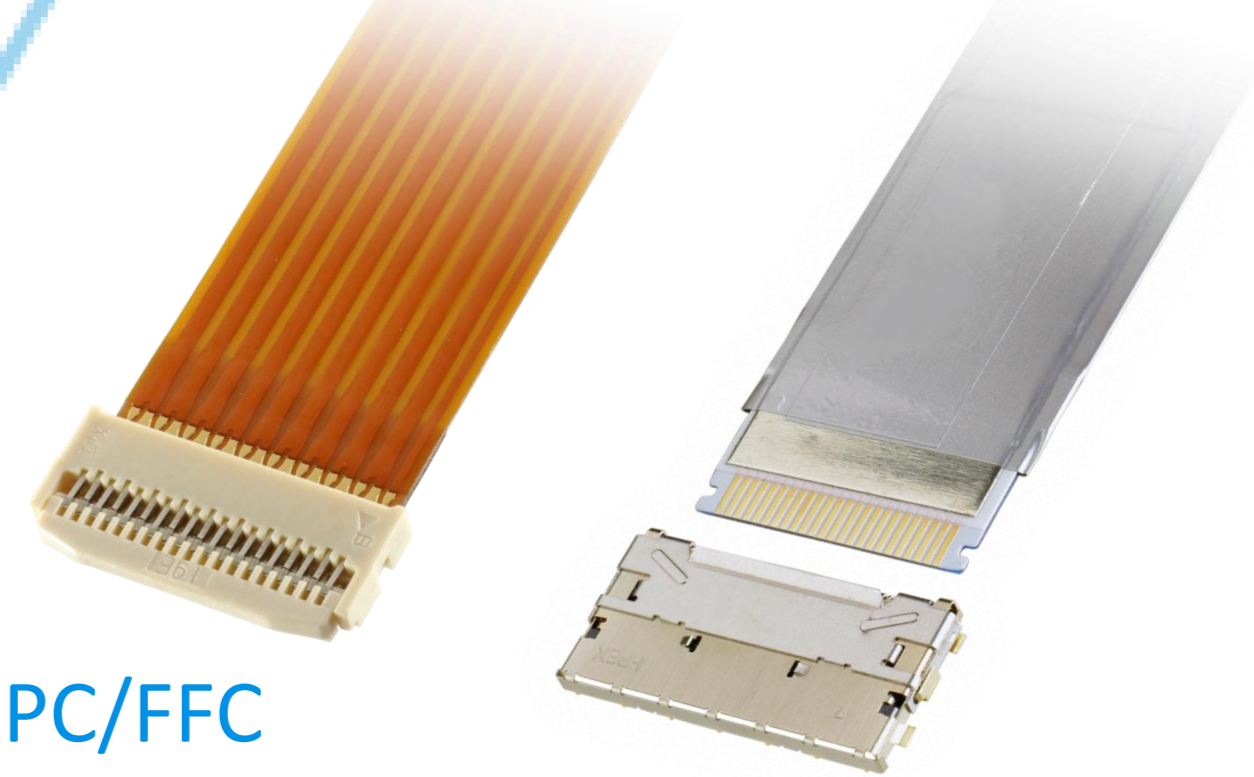

FPC/FFC Connectors



Inquiry



I-PEX, MHF, CABLINE, NOVASTACK, ISH, IARPB, MINIFLEX, EVAFLEX, MINIDOCK and ZenShield are registered trademarks of I-PEX Inc. Please note that the contents in the catalog might be changed without prior notification. I-PEX Inc. assumes no responsibility for any inaccuracies or obligation to update information on these documents. Please be sure to read and understand the latest "Precautions for Use" and "Instruction Manual" before you use our products. We shall not be responsible for any defects, damages or troubles in case you use our products without following the precautions for use. Please feel free to contact our sales representatives when you use our products for any applications that require very high reliability and safety, or that relate to human life (ex. nuclear power control, aerospace, transportation, medical equipment, safety equipment etc.).

Contact your sales representative or more detailed information.

www.i-pex.com

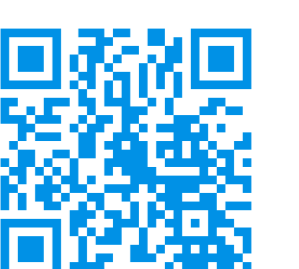

I-PEX

© I-PEX Inc. 2025
All rights reserved