

PART No.	Pos	A	B	C	D	E	F	PART No.	CONDUCTIVITY TYPE	QTY. IN REEL	APPLICABLE POSITION NUMBER												
								20709-0**E-##-□	(##)	(□)	(**)												
								20709-0**E	NORMAL(NONE)	20,000(NONE)	-	-	-	-	-	-	34	40	50	-			
20709-010E-##-□	10	1.40	3.92	3.75	2.70	4.10	-	20709-0**E-00-M	NORMAL(00)	5,000(M)	-	-	-	-	-	-	34	40	50	-			
20709-014E-##-□	14	2.10	4.62	4.45	3.40	4.80	-	20709-0**E-01	HIGH(01)	20,000(NONE)	10	14	18	20	24	30	34	40	50	60			
20709-018E-##-□	18	2.80	5.32	5.15	4.10	5.50	-	20709-0**E-01-M	HIGH(01)	5,000(M)	10	14	18	20	24	30	34	40	50	60			
20709-020E-##-□	20	3.15	5.67	5.50	4.45	5.85	-																
20709-024E-##-□	24	3.85	6.37	6.20	5.15	6.55	-																
20709-030E-##-□	30	4.90	7.42	7.25	6.20	7.60	-																
20709-034E-##-□	34	5.60	8.12	7.95	6.90	8.30	-																
20709-040E-##-□	40	6.65	9.17	9.00	7.95	9.35	-																
20709-050E-##-□	50	8.40	10.92	10.75	9.70	11.10	-																
20709-060E-##-□	60	10.15	12.67	12.50	11.45	12.85	2.10																



Halogen Free



RoHS Compliant

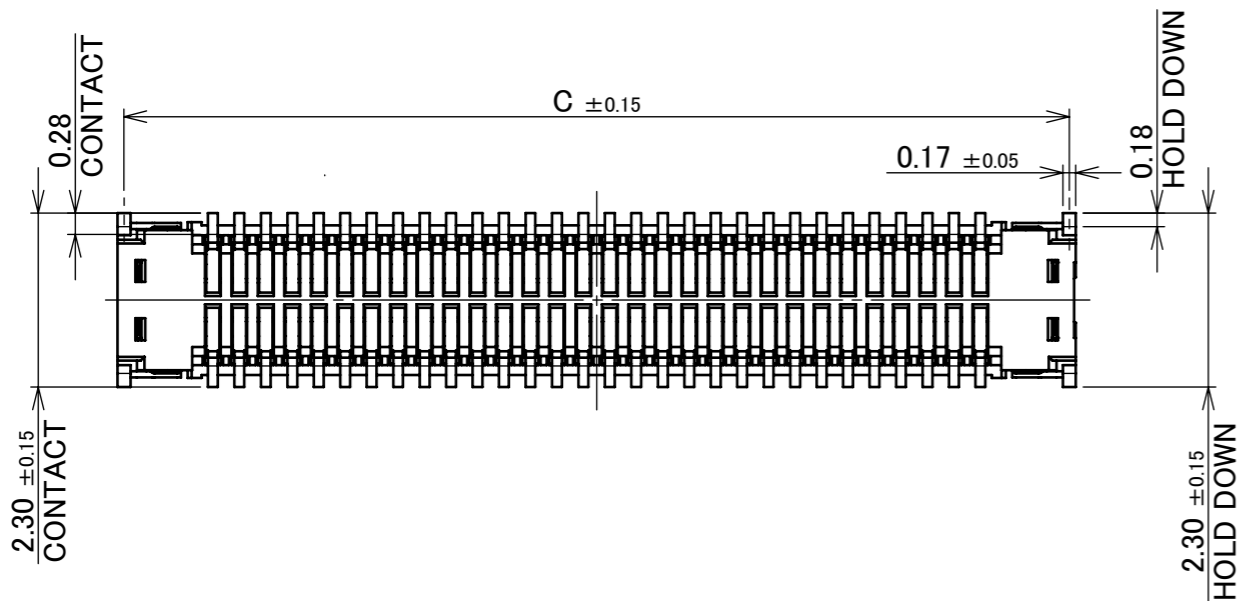
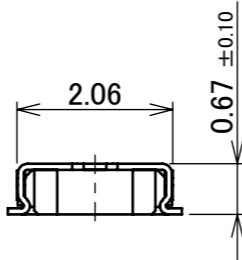
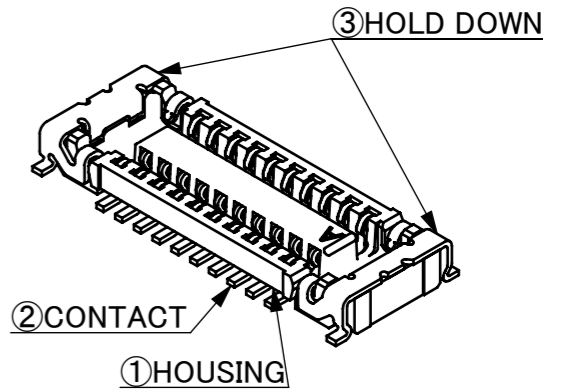
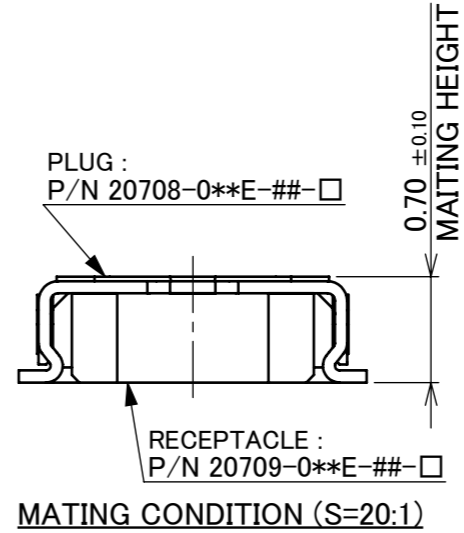
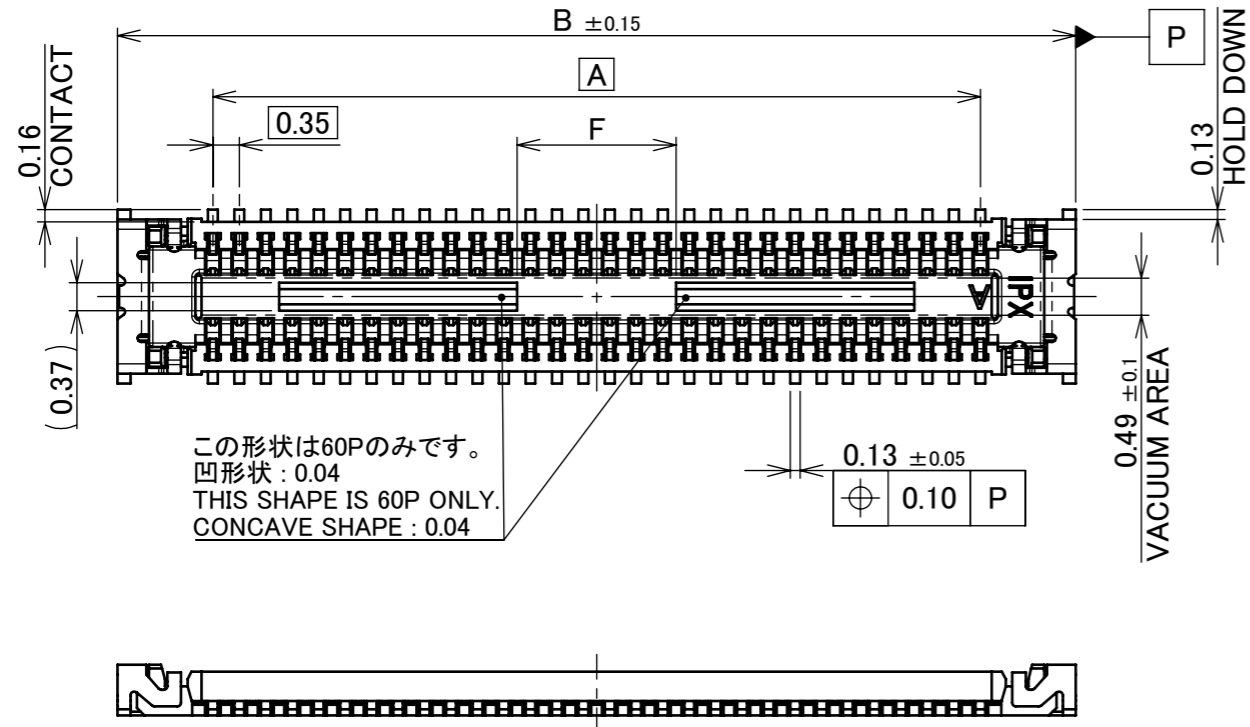

NO.	DISCRIPTION	MATERIAL	FINISH , REMARKS
3	HOLD DOWN	CORSON ALLOY	ALL OVER Ni 1.27 μm MIN. CONTACT PART Au 0.1 μm MIN./ SOLDERING PART Au 0.01 μm MIN.
2	CONTACT	PHOSPHOR BRONZE P/N : 20709-0**E CORSON ALLOY P/N : 20709-0**E-00-M	ALL OVER Ni 1.27 μm MIN. CONTACT PART Au 0.1 μm MIN./ SOLDERING PART Au 0.01 μm MIN.
1	HOUSING	LCP	UL94V-0, BEIGE

REV.	ECN	BY	DATE	APP.	APP.	CHK.	DATE	DATE	ANGLE	±2°	6 OVER 30 MAX.	±0.3	PROJECTION	SERIES No.	CUSTOMER COPY
15	Z230376	M.H	2023/03/30	Y.H					6 MAX.	±0.2	30 OVER 120 MAX.	±0.5	①	R2	
14	Z220204	K.W	2022/02/28	Y.H											
13	Z190514	R.S	2019/04/12	TAK											
12	Z180678	R.H	2018/05/28	TAK	DWG.										
11	Z171526	Y.B	2017/12/27	TAK		T.Hirakawa	2015/08/15								
10	Z171285	T.F	2017/11/08	TAK											
REV.	ECN	BY	DATE	APP.	APP.	CHK.	DATE	DATE	ANGLE	±2°	6 OVER 30 MAX.	±0.3	PROJECTION	SERIES No.	CUSTOMER COPY
REVISION RECORD										E.Kawabe		DWG. No. 20709		SCALE 10:1	
												TITLE NOVASTACK® 35-P RECEPTACLE ASS'Y		UNIT mm	
												SIZE A3		SHEET 1/6	
												REV. 15			

ITEMS	SPECIFICATION	
	NORMAL CONDUCTIVITY	HIGH CONDUCTIVITY
APPLICABLE CONNECTOR PART No.	20708-0**E-**	
RATING VOLTAGE	50V AC (r.m.s) / DC	
RATING AMPERAGE (FOR SIGNAL CONTACT)	0.3A AC/DC (PER CONTACT PIN), 12.0A AC/DC(TOTAL)	0.3A AC/DC (PER CONTACT PIN), 12.0A AC/DC(TOTAL) 1.0A AC/DC (PER CONTACT OF UP TO 8 PINS)
RATING AMPERAGE (FOR POWER CONTACT)	2.0A AC/DC (PER CONTACT PIN), 4.0A AC/DC(TOTAL)	
OPERATING TEMPERATURE	233~358K(-40°C~+85°C)	
OPERATING HUMIDITY	85% MAX.(NON-CONDENSING)	
CONTACT RESISTANCE (FOR SIGNAL CONTACT)	INITIAL : 80mohm MAX. / AFTER TEST : \triangle 20mohm MAX.	INITIAL : 30mohm MAX. / AFTER TEST : \triangle 20mohm MAX.
CONTACT RESISTANCE (FOR POWER CONTACT)	INITIAL : 80mohm MAX. / AFTER TEST : \triangle 20mohm MAX.	INITIAL : 30mohm MAX. / AFTER TEST : \triangle 20mohm MAX.
INSULATION RESISTANCE	INITIAL : 1,000Mohm MIN. / AFTER TEST : 500Mohm MIN.	
DIELECTRIC WITHSTANDING VOLTAGE	AC200V 1min	
DURABILITY	20 CYCLES	
MATING FORCE (INITIAL)	1.0 N/Pin MAX.	~28P 2.0 N/Pin MAX. 30P~ 1.0 N/Pin MAX.
UNMATING FORCE (AFTER TEST)	0.15 N/Pin MIN.	~28P 0.30 N/Pin MIN. 30P~ 0.15 N/Pin MIN.
COPLANARITY	0.08 MAX.	
PRODUCT SPECIFICATION	PRS-2101	PRS-2334
TEST REPORT	TR-15069	TR-16143
PACKING STANDARD	PST-15077 (20K/REEL) PST-17039 (5K/REEL)	
INSTRUCTION MANUAL	HIM-15014	
APPEARANCE CRITERIA No.	QLS-A***	

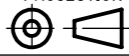
ANGLE	$\pm 2^\circ$	6 OVER 30 MAX.	± 0.3	PROJECTION 	SERIES No. R2	CUSTOMER COPY		
6 MAX.	± 0.2	30 OVER 120 MAX.	± 0.5					
GENERAL TOLERANCE.				TITLE NOVASTACK® 35-P RECEPTACLE ASS'Y	SCALE	I-PEX		
DWG.	DATE							
CHK.								
APP.								
DWG. No.	20709			SIZE	SHEET	REV.		
				A3	2/6	15		

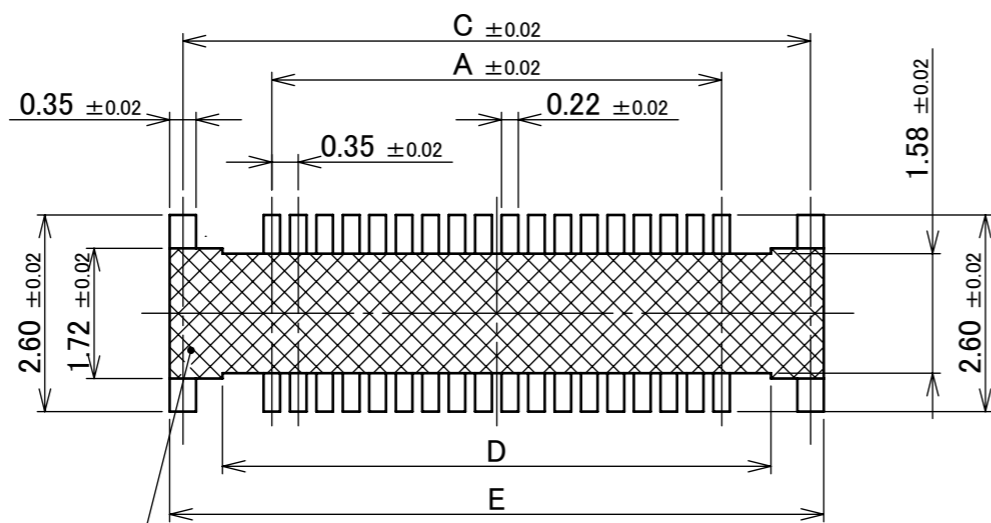

半田上がり防止の為、半田付けをしないで下さい。
 パターンを設けるときは、レジストを設けて下さい。
 MUST BE NOT SOLDERING AREA FOR PREVENT FROM SOLDER WICKING.
 MUST BE RESIST COATING ON THE PATTERN.

RECOMMENDED PATTERN LAYOUT

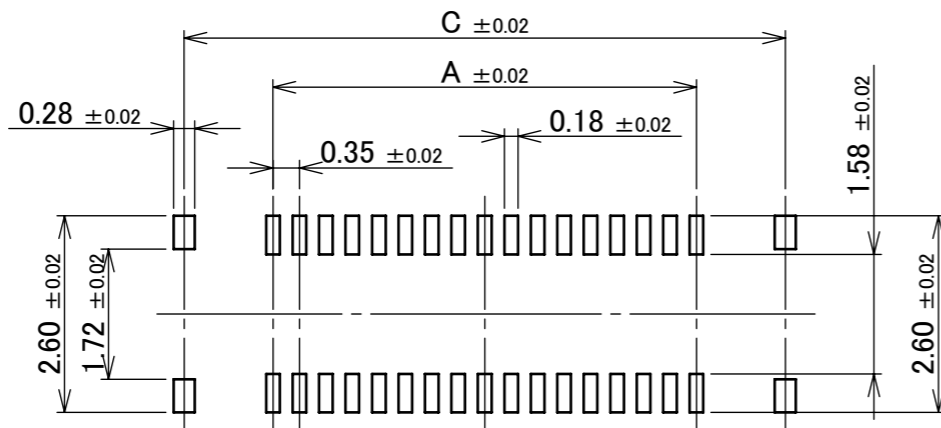

RECOMMENDED METAL MASK LAYOUT
 THICKNESS : 0.10 mm

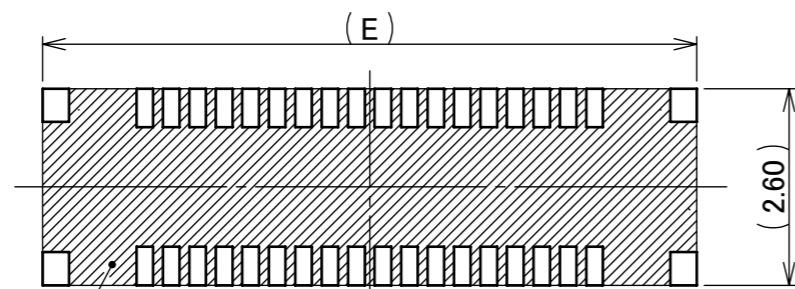

NOTE. 1

NOTES.
 1. THIS AREA CANNOT MOUNT ANOTHER COMPONENTS.

ホールドダウンを電源用としてご使用の場合は、
 両パットを図のように繋げて下さい。
 PAD IS CONNECTED LIKE FIGURE WHEN HOLD DOWN
 IS USED FOR POWER SUPPLY.

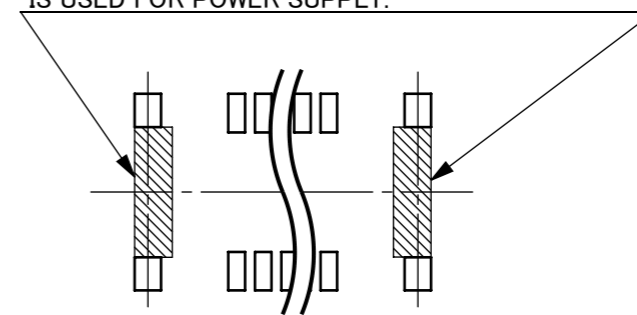

HOLD DOWN PAD LAYOUT
 USED FOR POWER SUPPLY

ANGLE	±2°	6 OVER 30 MAX.	±0.3	PROJECTION 	SERIES No. R2	CUSTOMER COPY			
	6 MAX.	±0.2	30 OVER 120 MAX.						±0.5
GENERAL TOLERANCE.				TITLE		SCALE			
DWG.	DATE			NOVASTACK® 35-P RECEPTACLE ASS'Y		5:1			
CHK.						UNIT			
APP.						mm			
				DWG. No.	20709	SIZE	SHEET	REV.	
						A3	3/6	15	

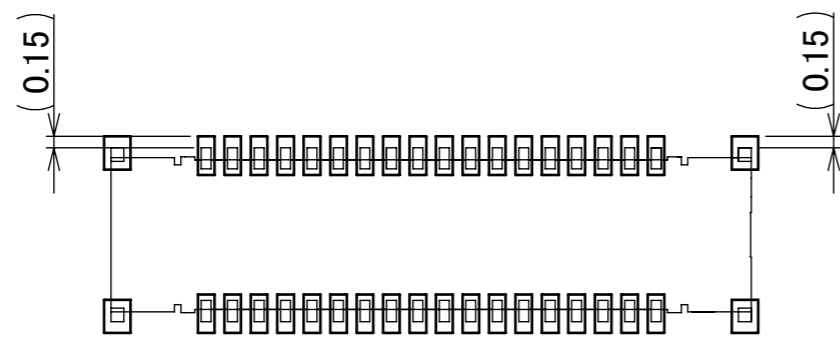

CONNECTOR ON RECOMMENDED FOOTPRINT PATTERN

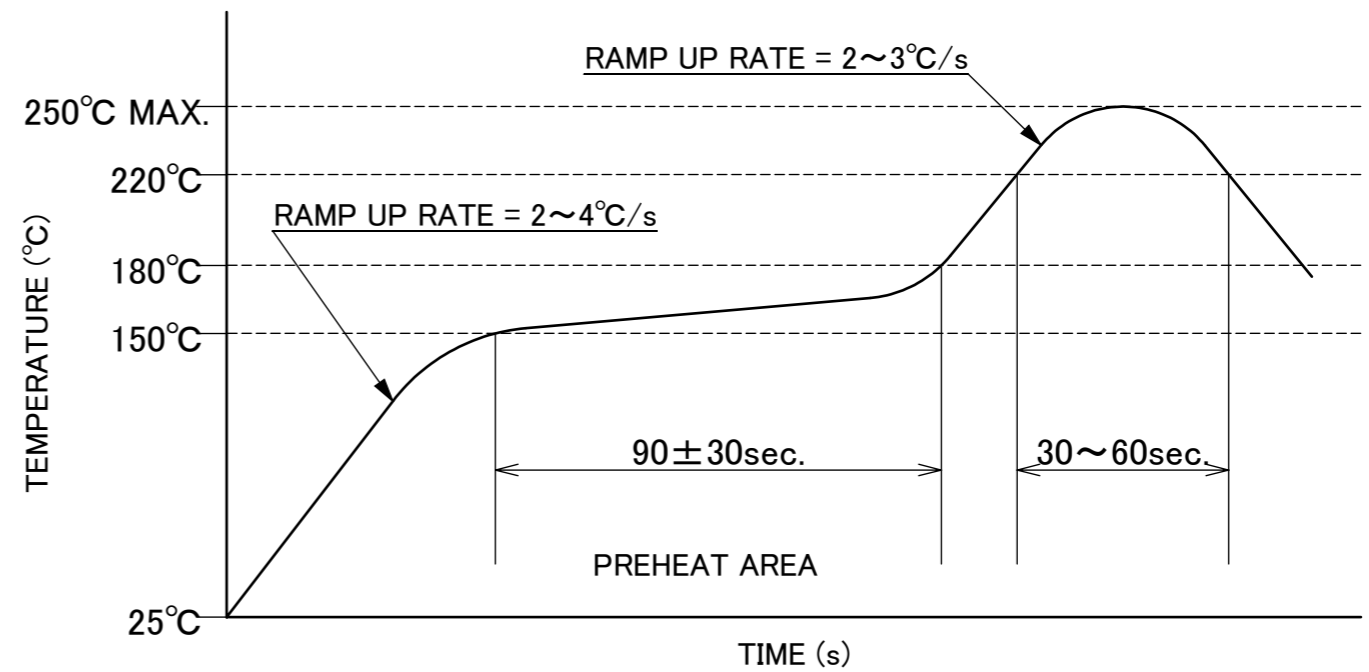

REFLOW TEMPERATURE PROFILE
 SENJU METAL INDUSTRY CO., LTD. : M705-SHF(Sn96.5 Ag3.0 Cu0.5)

ANGLE	±2°	6 OVER 30 MAX.	±0.3	PROJECTION 	SERIES No. R2	CUSTOMER COPY			
6 MAX.	±0.2	30 OVER 120 MAX.	±0.5						
GENERAL TOLERANCE.				TITLE		SCALE			
DWG.	DATE			NOVASTACK® 35-P RECEPTACLE ASS'Y		10:1			
CHK.						UNIT			
APP.						mm			
				DWG. No.	20709	SIZE	SHEET	REV.	
						A3	4/6	15	

PART NO.	Pos.	G	H	QTY. PER EMBOSS REEL (PIECES / REEL)	QTY. PER PACKING CARTON (REELS / CARTON)
20709-0**E-##	10~14P	12	5.5	20,000 / REEL	20,000 × 9 REELS = 180,000
	16~36P	16	7.5		20,000 × 7 REELS = 140,000
	38~70P	24	11.5		20,000 × 5 REELS = 100,000

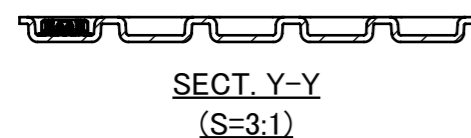
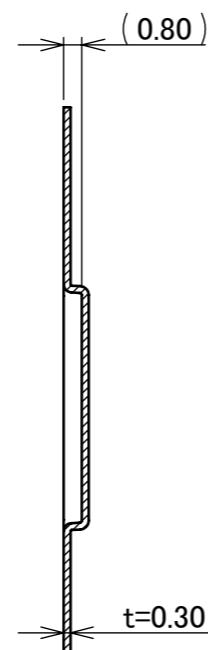
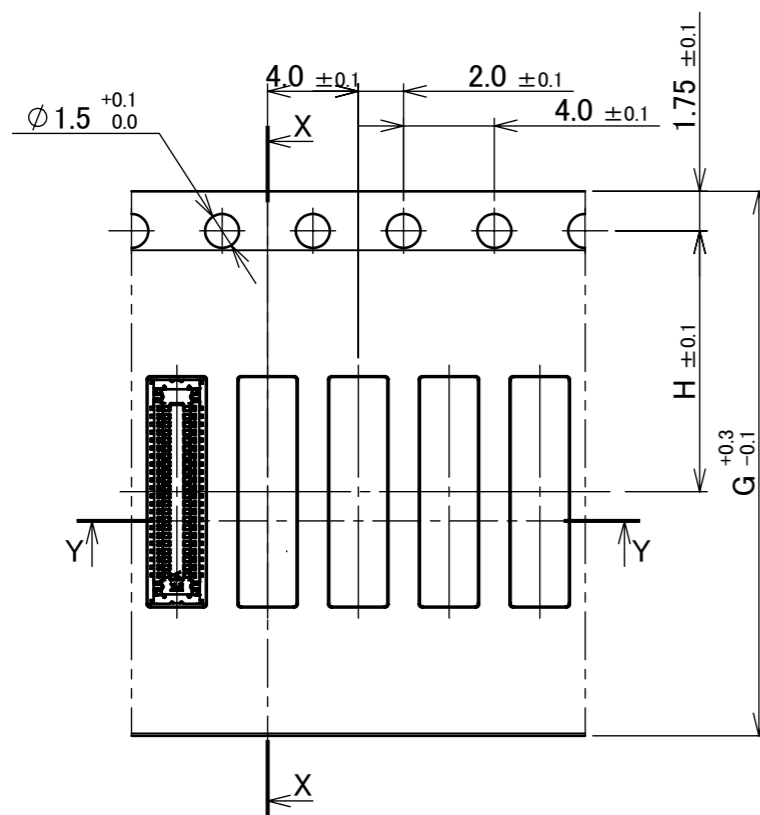
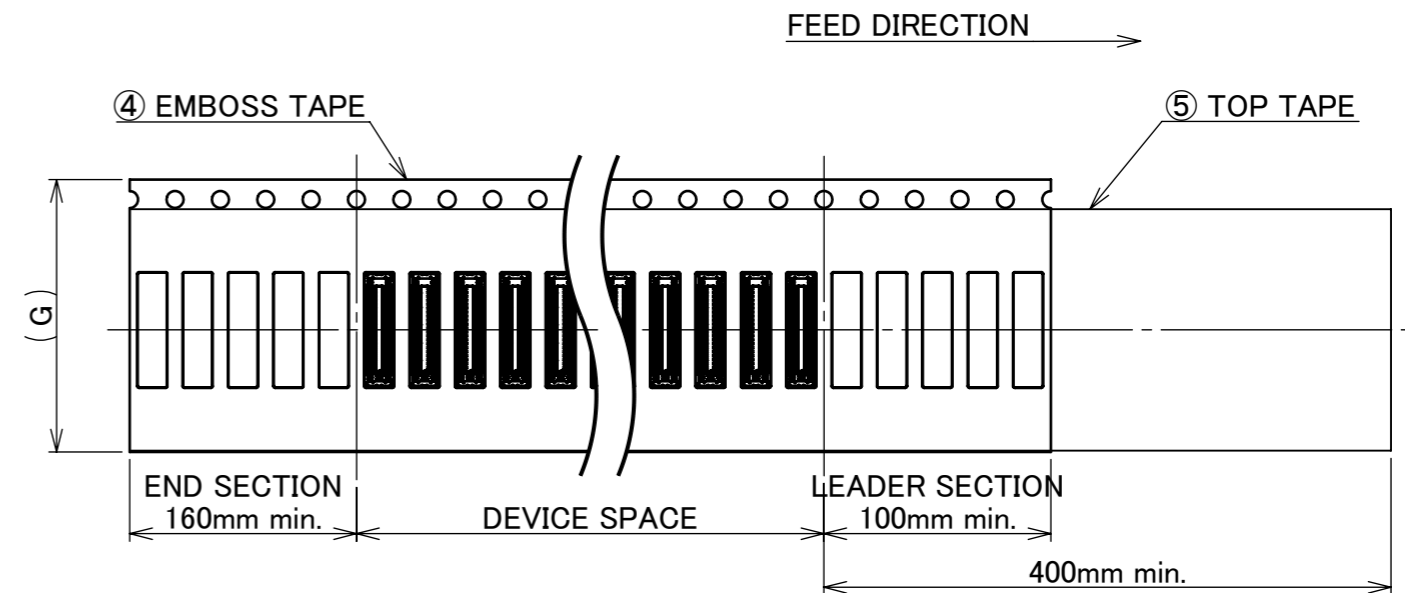
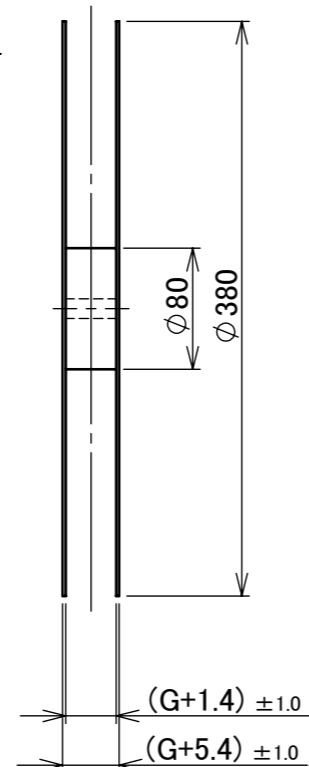
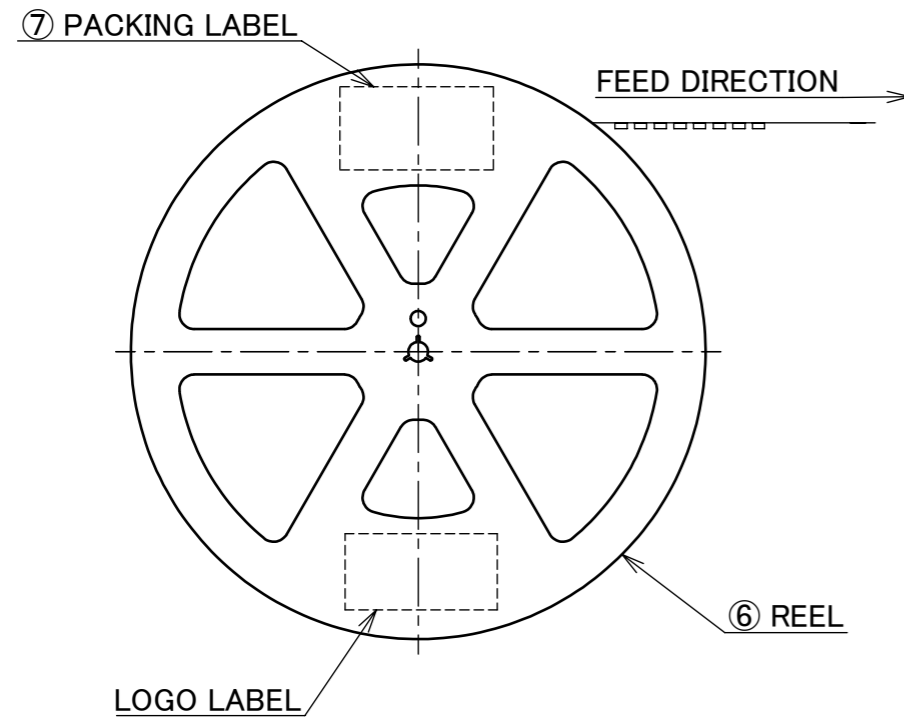

- NOTES.
- TAPING SPECIFICATION FOLLOWS JIS C 0806 (IEC 60286-3).
 - MAKE EMPTY SECTION OF LEADER AND END ON EACH END OF THE TAPE.
 - TOP TAPE SHALL NOT STICK OUT FROM EMBOSS TAPE.
 - TOP TAPE SHALL NOT COVER FEED HOLE.

NO.	DISCRIPTION	MATERIAL	FINISH , REMARKS
7	PACKING LABEL	-	-
6	REEL	PS	ANTI-STATIC TYPE BLACK
5	TOP TAPE	PET t=0.062 TRANSPARENCY	ANTI-STATIC TYPE
4	EMBOSS TAPE	TRANSPARENCY	ANTI-STATIC TYPE

ANGLE	±2°	6 OVER 30 MAX.	±0.3	PROJECTION	SERIES No.	CUSTOMER COPY			
6 MAX.	±0.2	30 OVER 120 MAX.	±0.5		R2				
GENERAL TOLERANCE.				TITLE	NOVASTACK® 35-P RECEPTACLE ASS'Y		SCALE	1:X	
DWG.	DATE					UNIT	mm		
CHK.						SIZE	SHEET	5/6	REV.
APP.				DWG. No.	20709	A3			15

PART NO.	Pos.	J	K	QTY. PER EMBOSS REEL (PIECES / REEL)	QTY. PER PACKING CARTON (REELS / CARTON)
20709-0**E-##-M	10~14P	12	5.5	5,000 / REEL	5,000 × 9 REELS = 45,000
	16~36P	16	7.5		5,000 × 7 REELS = 35,000
	38~70P	24	11.5		5,000 × 5 REELS = 25,000

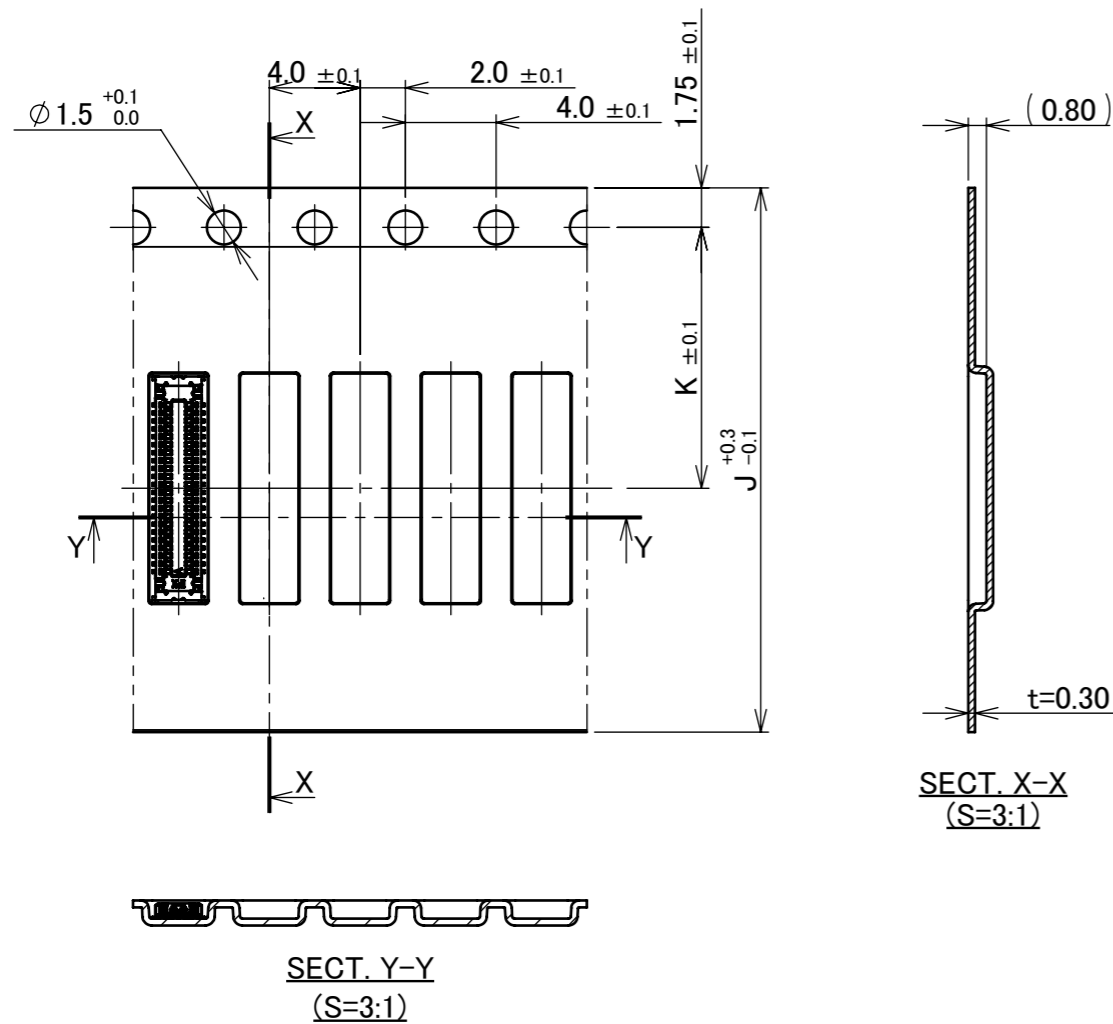
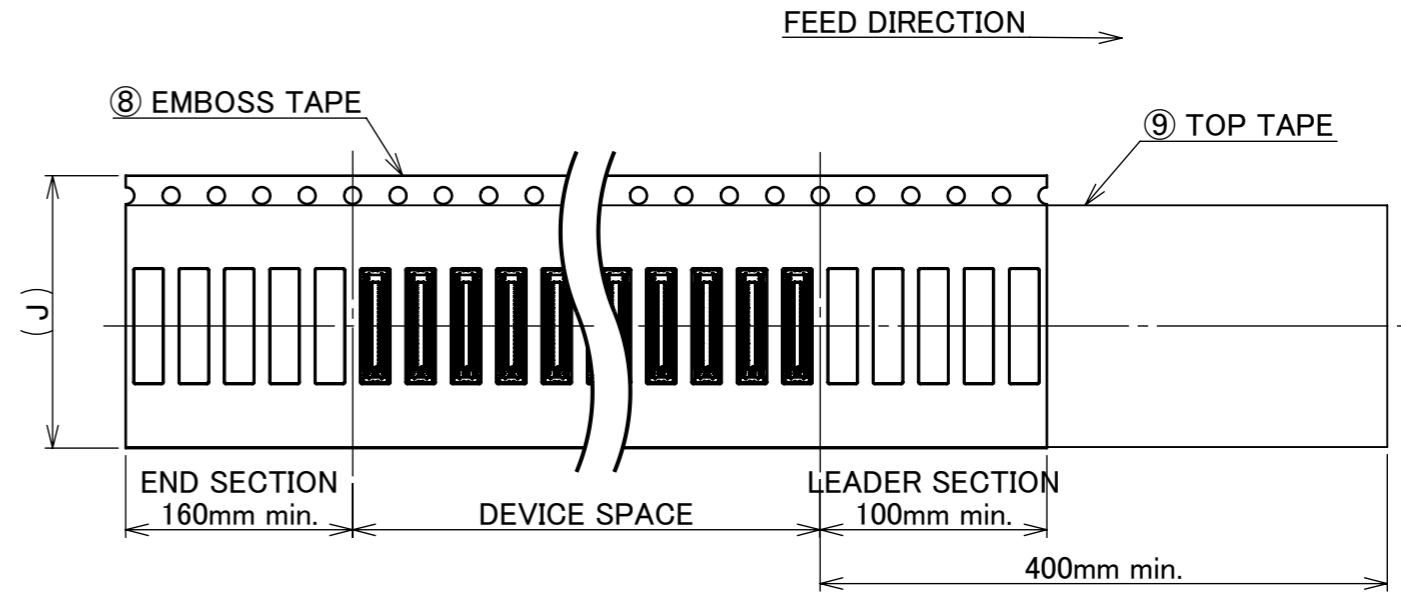
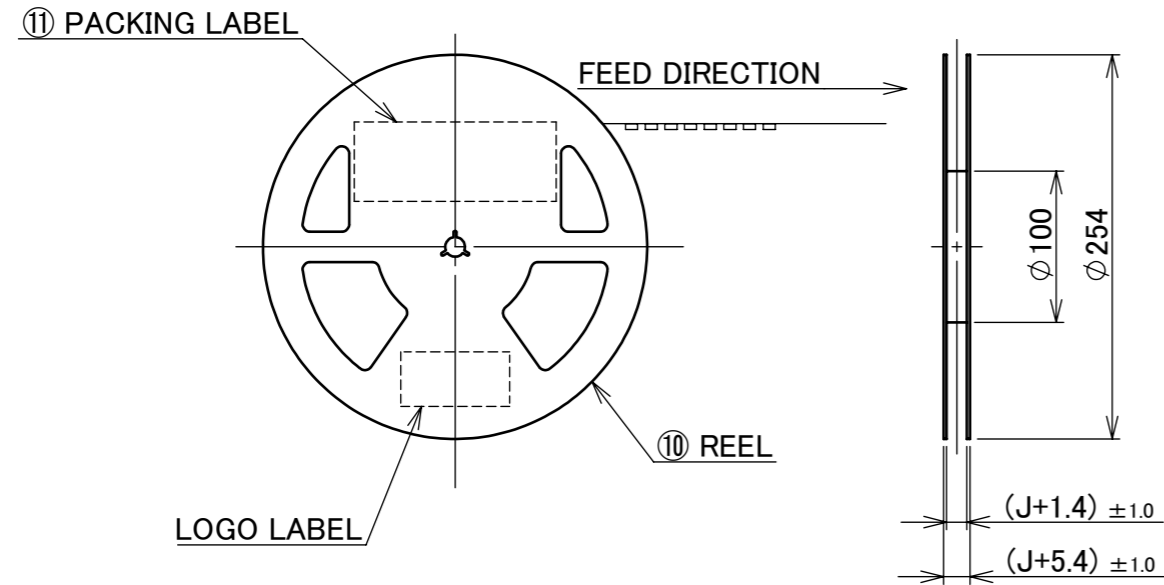

- NOTES.
- TAPING SPECIFICATION FOLLOWS JIS C 0806 (IEC 60286-3).
 - MAKE EMPTY SECTION OF LEADER AND END ON EACH END OF THE TAPE.
 - TOP TAPE SHALL NOT STICK OUT FROM EMBOSS TAPE.
 - TOP TAPE SHALL NOT COVER FEED HOLE.

NO.	DISCRIPTION	MATERIAL	FINISH , REMARKS
11	PACKING LABEL	-	-
10	REEL	PS	ANTI-STATIC TYPE BLACK
9	TOP TAPE	PET t=0.062 TRANSPARENCY	ANTI-STATIC TYPE
8	EMBOSS TAPE	TRANSPARENCY	ANTI-STATIC TYPE

ANGLE	±2°	6 OVER 30 MAX.	±0.3	PROJECTION	SERIES No.	CUSTOMER COPY				
6 MAX.	±0.2	30 OVER 120 MAX.	±0.5		R2	<div style="text-align: center;"> </div>				
GENERAL TOLERANCE.				TITLE	SCALE				<div style="text-align: center;"> </div>	
DWG.	DATE		NOVASTACK® 35-P RECEPTACLE ASS'Y	1:X						
CHK.				UNIT						
APP.			DWG. No.	20709	mm	SIZE	SHEET	REV.		
						A3	6/6	15		