

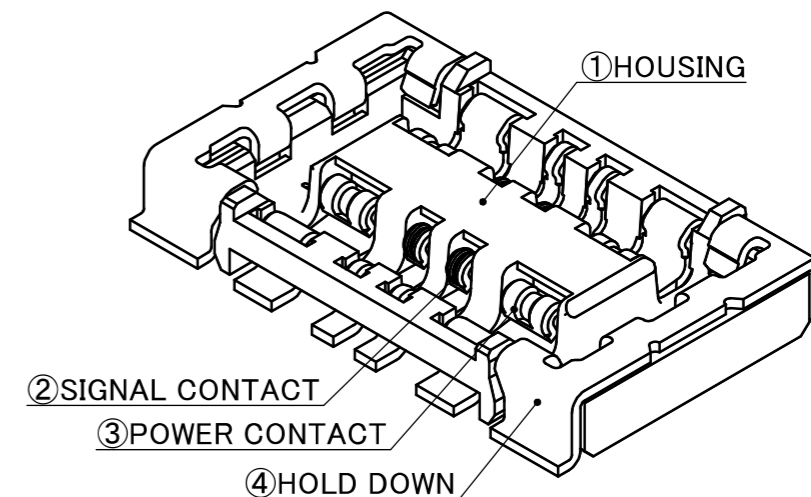

Halogen Free

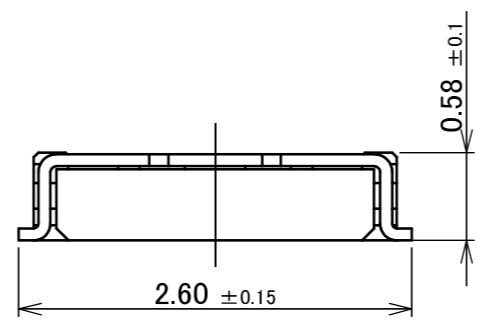

RoHS Compliant

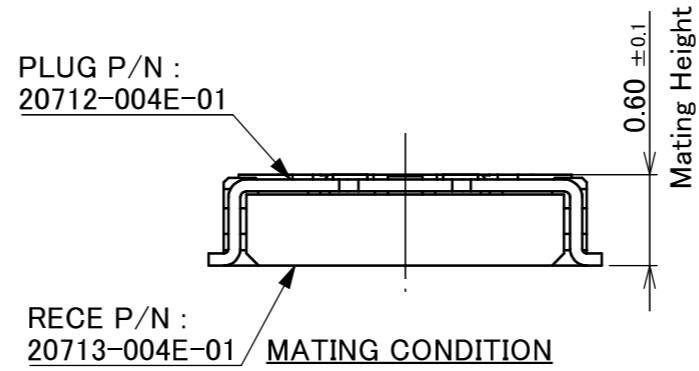
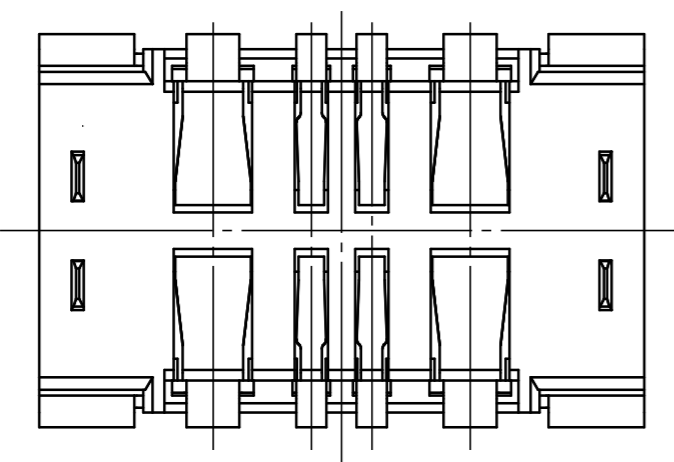
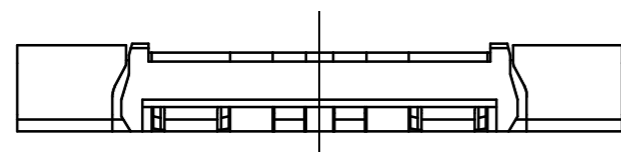
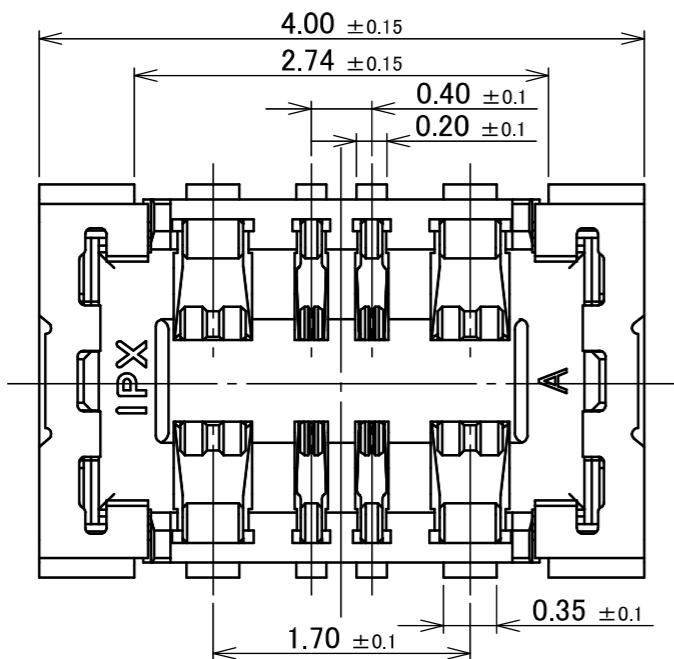

4	HOLD DOWN	PHOSPHOR BRONZE	ALL OVER Ni 1.27 μm MIN. SOLDERING PART Au 0.01 μm MIN.
3	POWER CONTACT	CORSON ALLOY	ALL OVER Ni 1.27 μm MIN. CONTACT PART Au 0.05 μm MIN./ SOLDERING PART Au 0.02 μm MIN.
2	SIGNAL CONTACT	CORSON ALLOY	ALL OVER Ni 1.27 μm MIN. CONTACT PART Au 0.05 μm MIN./ SOLDERING PART Au 0.02 μm MIN.
1	HOUSING	LCP	UL94V-0, BLACK
NO.	DISCRIPTION	MATERIAL	FINISH , REMARKS

				ANGLE	±2°	6 OVER 30 MAX.	±0.3	PROJECTION	SERIES No.	CUSTOMER COPY		
4	ZC00643	S.Abe	2026/05/01	S.S	6 MAX.	±0.2	30 OVER 120 MAX.	⊕	R4			
3	Z220205	K.W	2022/02/28	Y.H	GENERAL TOLERANCE.				TITLE NOVASTACK® -B RECEPTACLE ASS'Y	SCALE	I-PEX	
2	Z180691	R.H	2018/05/30	TAK	DWG.	DATE		20:1				
1	Z161155	H.I	2016/09/15	Y.S	H.Ikari	2016/08/09		UNIT				
0	Z160990	H.I	2016/08/09	CHK.				mm				
REV.	ECN	BY	DATE	APP.	APP.			DWG. No.	20713	SIZE	SHEET	REV.
REVISION RECORD					Y.Shimada					A3	1/5	4

ITEMS	SPECIFICATION
APPLICABLE CONNECTOR PART No.	20712-004E-0*
RATING VOLTAGE	50V AC (PER CONTACT PIN)
RATING AMPERAGE (FOR SIGNAL CONTACT)	1.0A AC/DC (PER CONTACT PIN)/ 4.0A AC/DC(TOTAL)
RATING AMPERAGE (FOR POWER CONTACT)	6.0A AC/DC (PER CONTACT PIN)/ 24.0A AC/DC(TOTAL)
OPERATING TEMPERATURE	233~358K(-40°C~+85°C)
OPERATING HUMIDITY	85% MAX.(NON-CONDENSING)
CONTACT RESISTANCE (FOR SIGNAL CONTACT)	INITIAL : 40mohm MAX. / AFTER TEST : \triangleleft 20mohm MAX.
CONTACT RESISTANCE (FOR POWER CONTACT)	INITIAL : 20mohm MAX. / AFTER TEST : \triangleleft 20mohm MAX.
INSULATION RESISTANCE	INITIAL : 1,000Mohm MIN. / AFTER TEST : 100Mohm MIN.
DIELECTRIC WITHSTANDING VOLTAGE	AC250V 1min
DURABILITY	30 CYCLES
MATING FORCE (INITIAL / AFTER TEST)	40N MAX.
UNMATING FORCE (INITIAL / AFTER TEST)	INITIAL: 10N MIN. AFTER TEST: 7N MIN.
COPLANARITY	0.08 MAX.
PRODUCT SPECIFICATION	PRS-2284
TEST REPORT	TR-16098
PACKING STANDARD	PST-15123 (20K/REEL) PST-16057 (5K/REEL)
INSTRUCTION MANUAL	HIM-16033
APPEARANCE CRITERIA No.	QLS-A***

ANGLE	$\pm 2^\circ$	6 OVER 30 MAX.	± 0.3	PROJECTION 	SERIES No. R4	CUSTOMER COPY	
6 MAX.	± 0.2	30 OVER 120 MAX.	± 0.5				
GENERAL TOLERANCE.				TITLE NOVASTACK® -B RECEPTACLE ASS'Y	SCALE	I-PEX	
DWG.	DATE						
CHK.							
APP.							
DWG. No.	20713			UNIT mm	SIZE A3	SHEET 2/5	REV. 4

MASK THICKNESS	A
t=0.08	2.90
t=0.1	2.74
t=0.12	2.64

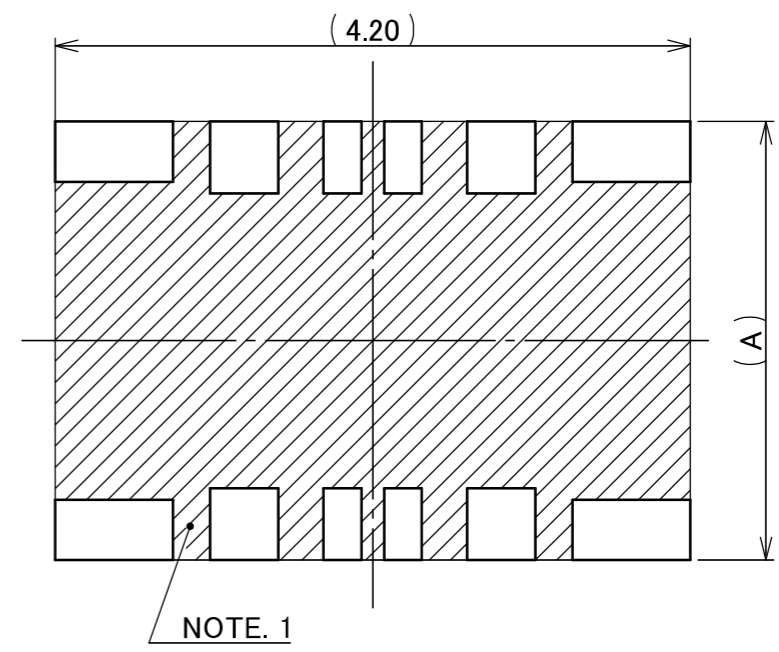
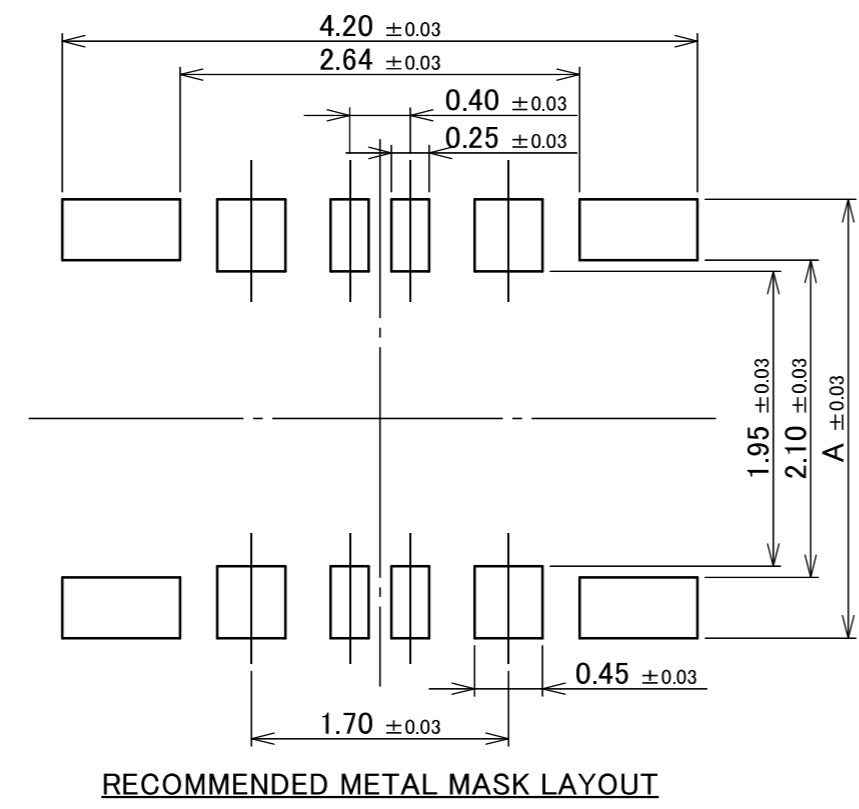
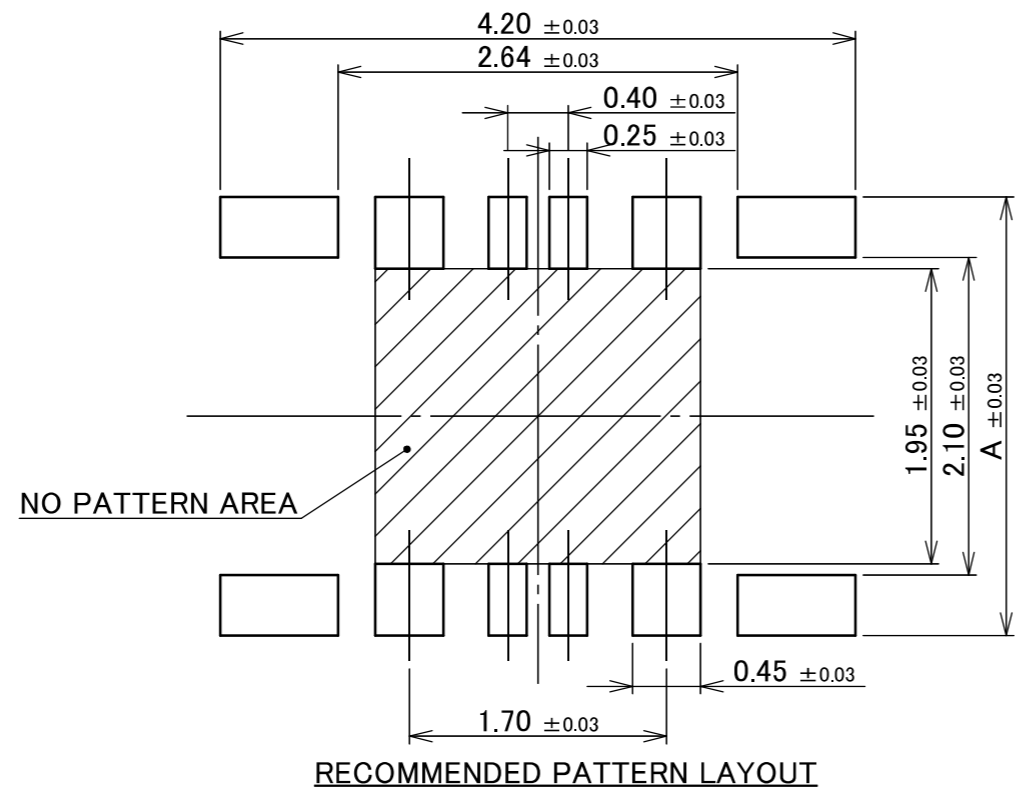

NOTES.
1. THIS AREA CANNOT MOUNT ANOTHER COMPONENTS.

ANGLE	±2°	6 OVER 30 MAX.	±0.3	PROJECTION	SERIES No.	CUSTOMER COPY	
6 MAX.	±0.2	30 OVER 120 MAX.	±0.5		R4	I-PEX	
GENERAL TOLERANCE.				TITLE	SCALE	REV.	
DWG.	DATE			NOVASTACK® -B RECEPTACLE ASS'Y	20:1	4	
CHK.					UNIT	I-PEX	
APP.				DWG. No.	mm	SIZE	SHEET
				20713	A3	3/5	4

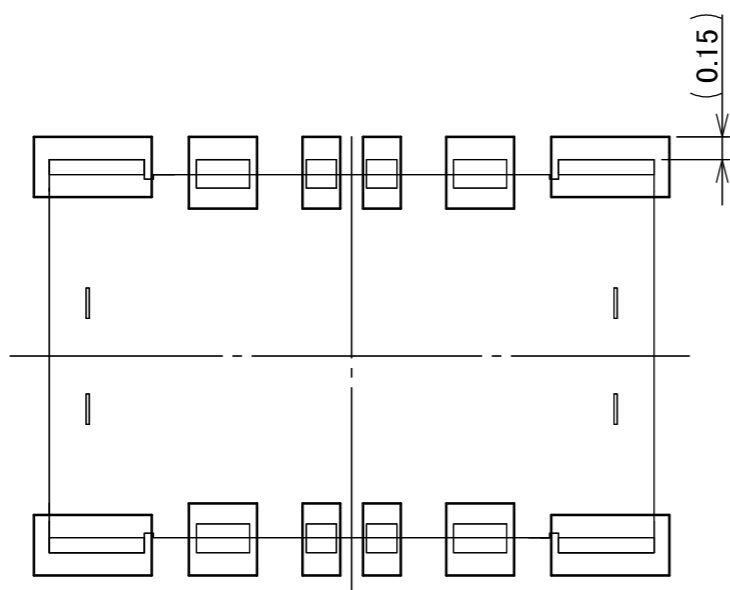

CONNECTOR ON RECOMMENDED FOOTPRINT PATTERN

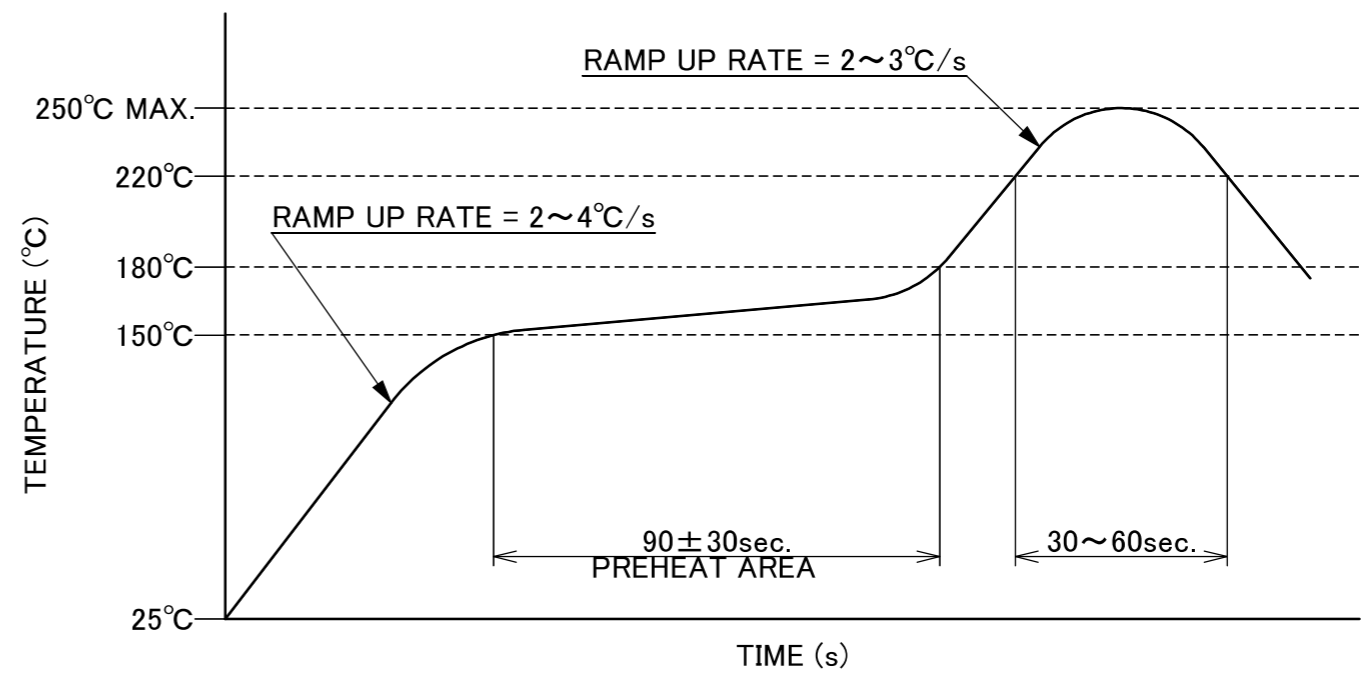

REFLOW TEMPERATURE PROFILE
 SENJU METAL INDUSTRY CO., LTD. : M705-SHF(Sn96.5 Ag3.0 Cu0.5)

ANGLE	±2°	6 OVER 30 MAX.	±0.3	PROJECTION 	SERIES No. R4	CUSTOMER COPY			
6 MAX.	±0.2	30 OVER 120 MAX.	±0.5			SCALE 20:1	I-PEX		
GENERAL TOLERANCE.				TITLE NOVASTACK® -B RECEPTACLE ASS'Y		UNIT mm			
DWG.	DATE			DWG. No. 20713		SIZE A3	SHEET 4/5	REV. 4	
CHK.									
APP.									

PART NO.	B	C	QTY. PER EMBOSS REEL (PIECES / REEL)	QTY. PER PACKING CARTON (REELS / CARTON)
20713-004E-01	80	380	20,000 / REEL	20,000 × 8 REELS = 160,000

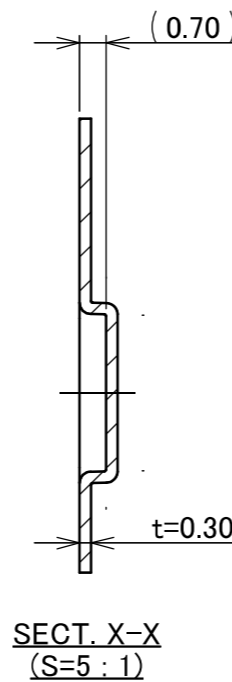
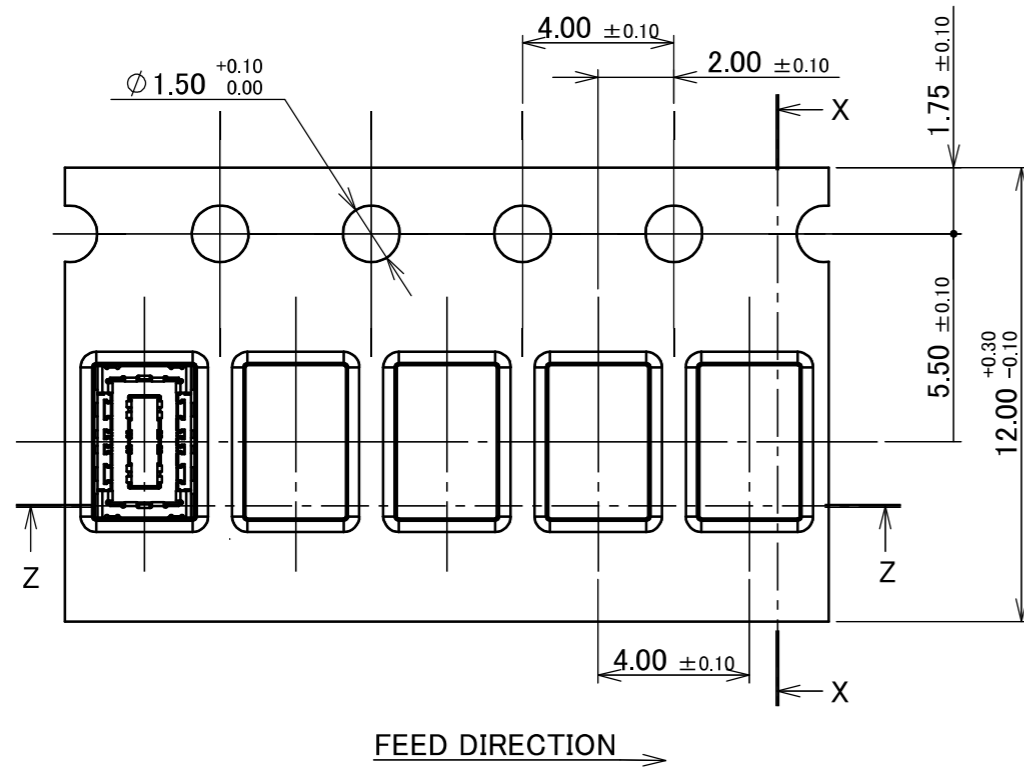
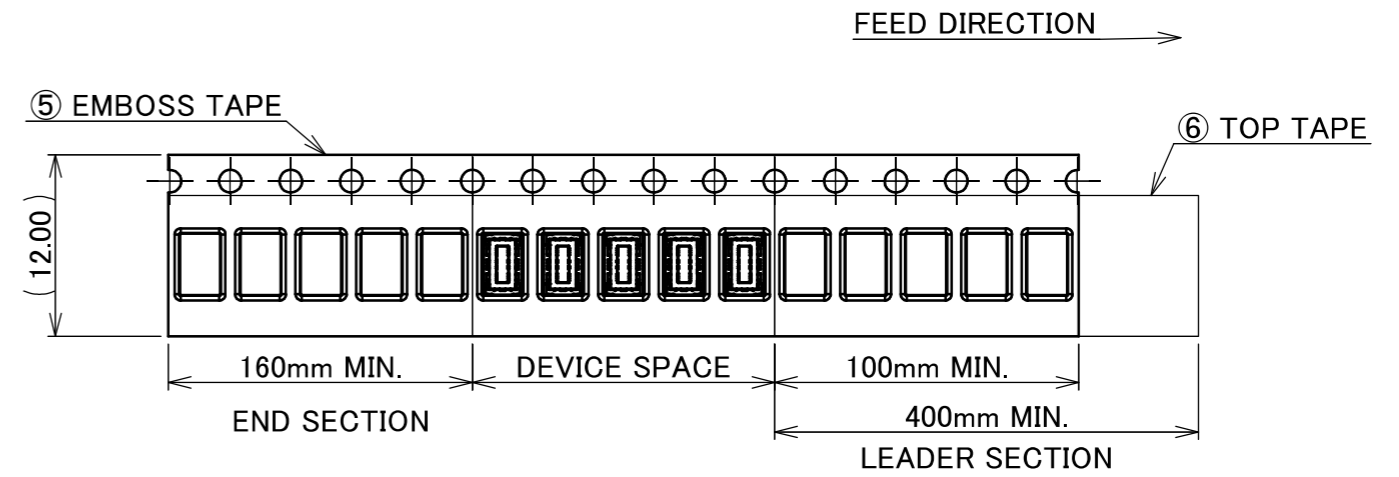
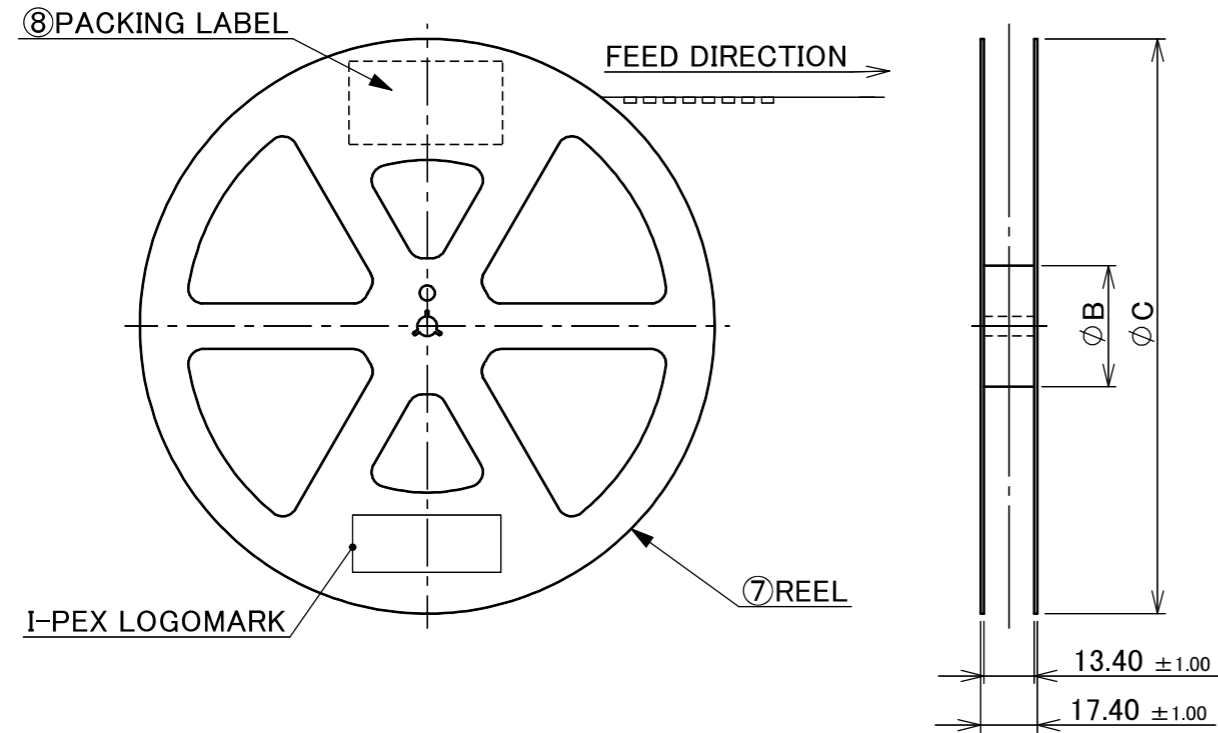

- NOTES.
- TAPING SPECIFICATION FOLLOWS JIS C 0806 (IEC 60286-3).
 - MAKE EMPTY SECTION OF LEADER AND END ON EACH END OF THE TAPE.
 - TOP TAPE SHALL NOT STICK OUT FROM EMBOSS TAPE.
 - TOP TAPE SHALL NOT COVER FEED HOLE.

NO.	DESCRIPTION	MATERIAL	FINISH, REMARKS
8	PACKING LABEL	-	-
7	REEL	PS	ANTI-STATIC TYPE BLACK
6	TOP TAPE	PET t=0.062 TRANSPARENCY	ANTI-STATIC TYPE
5	EMBOSS TAPE	PS TRANSPARENCY	ANTI-STATIC TYPE

ANGLE	±2°	6 OVER 30 MAX.	±0.3	PROJECTION R4	SERIES No. R4	CUSTOMER COPY
6 MAX.	±0.2	30 OVER 120 MAX.	±0.5			
GENERAL TOLERANCE.				TITLE NOVASTACK® -B RECEPTACLE ASS'Y	SCALE 1:X	UNIT mm
DWG.	DATE					
CHK.						
APP.						
DWG. No. 20713				SIZE A3	SHEET 5/5	REV. 4