

Recommended P/N 20713-004E-01

PART No.	Q'ty/REEL
20713-004E-01	20K
20713-004E-02	5K

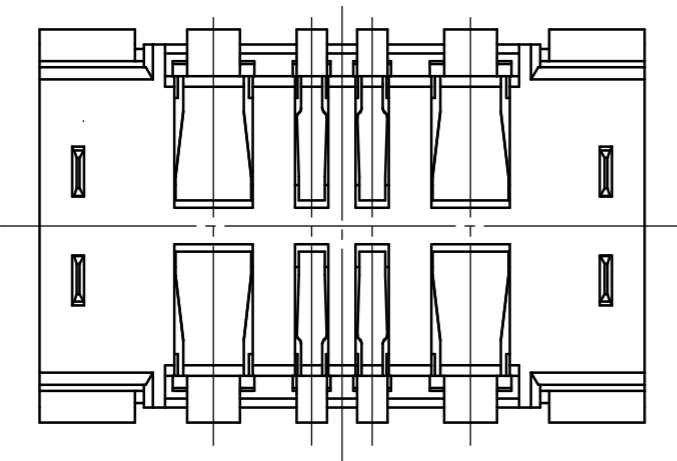
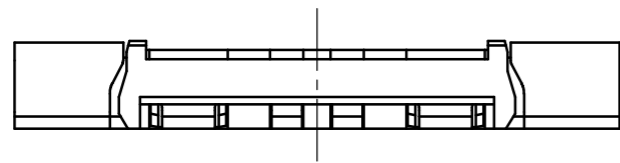
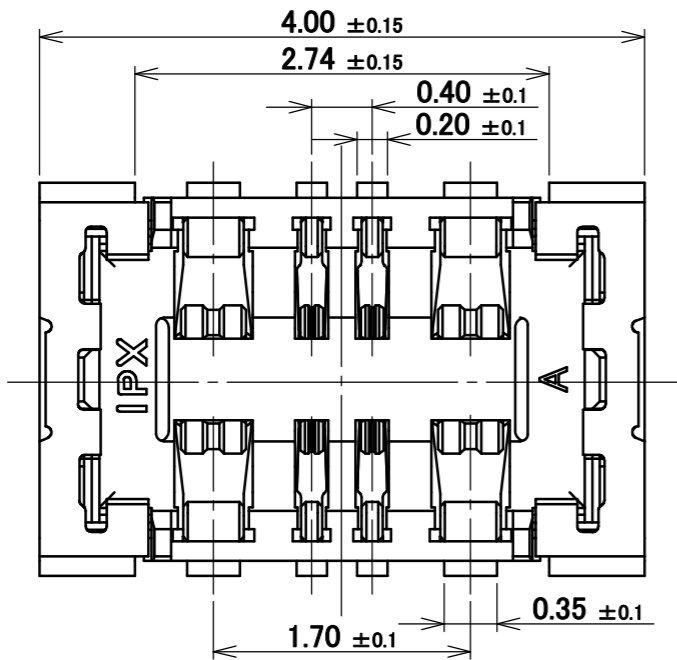

PLUG P/N :  
20712-004E-01

RECE P/N :  
20713-004E-01 MATING CONDITION

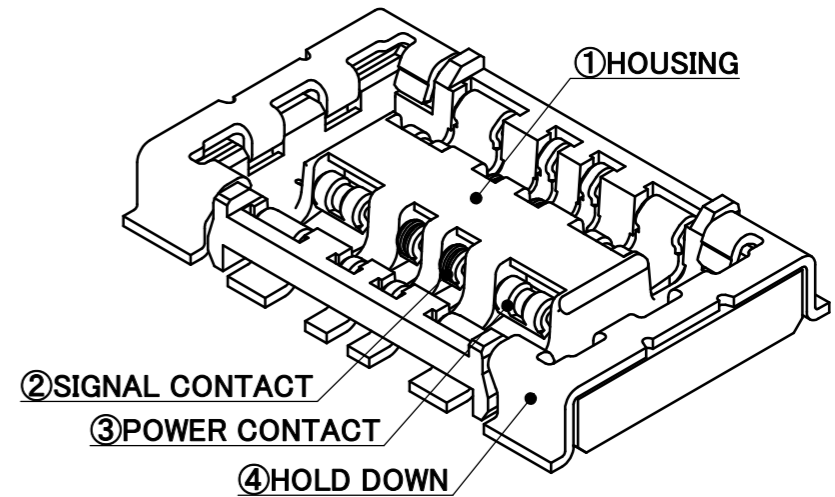
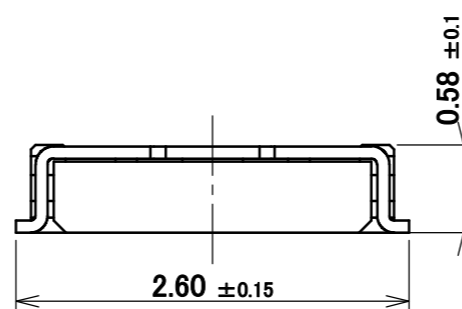
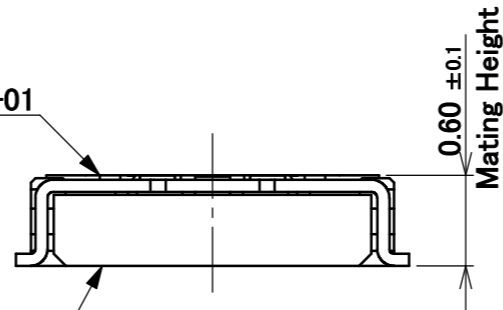

4	HOLD DOWN	PHOSPHOR BRONZE	ALL OVER Ni 1.27 μm MIN. SOLDERING PART Au 0.01 μm MIN.
3	POWER CONTACT	CORSON ALLOY	ALL OVER Ni 1.27 μm MIN. CONTACT PART Au 0.05 μm MIN./ SOLDERING PART Au 0.02 μm MIN.
2	SIGNAL CONTACT	CORSON ALLOY	ALL OVER Ni 1.27 μm MIN. CONTACT PART Au 0.05 μm MIN./ SOLDERING PART Au 0.02 μm MIN.
1	HOUSING	LCP	UL94V-0, BLACK
NO.	DISCRIPTION	MATERIAL	FINISH , REMARKS

					ANGLE	±2°	6 OVER 30 MAX.	±0.3	PROJECTION	SERIES No.	CUSTOMER COPY
					6 MAX.	±0.2	30 OVER 120 MAX.	±0.5		R3	
					GENERAL TOLERANCE.				TITLE	SCALE	I-PEX
2	Z180691	R.H	May/30/'18	TAK	DWG.	DATE	NOVASTACK®-B		20:1		
1	Z161155	H.I	Sept./15/'16	Y.S	H.Ikari	2016/08/09	RECE		UNIT		
0	Z160990	H.I	Aug./09/'16		CHK.	DATE			mm		
REV.	ECN	BY	DATE	APP.	APP.	DATE	DWG. No.	20713	SIZE	SHEET 1/5	REV. 2
REVISION RECORD					Y.Shimada	2016/08/10			A3		

ITEMS	SPECIFICATION
RATING VOLTAGE	50V AC (PER A CONTACT)
RATING AMPERAGE (FOR SIGNAL CONTACT)	1.0A AC/DC (PER A CONTACT)/ 4.0A AC/DC(TOTAL)
RATING AMPERAGE (FOR POWER CONTACT)	6.0A AC/DC (PER A CONTACT)/ 24.0A AC/DC(TOTAL)
OPERATING TEMPERATURE	233~358K(-40°C~+85°C)
OPERATING HUMIDITY	85% MAX.(NON-CONDENSING)
CONTACT RESISTANCE (FOR SIGNAL CONTACT)	INITIAL : 40mohm MAX. / AFTER TEST : $\Delta$ 20mohm MAX.
CONTACT RESISTANCE (FOR POWER CONTACT)	INITIAL : 20mohm MAX. / AFTER TEST : $\Delta$ 20mohm MAX.
INSULATION RESISTANCE	INITIAL : 1,000Mohm MIN. / AFTER TEST : 100Mohm MIN.
DIELECTRIC WITHSTANDING VOLTAGE	AC250V 1min
DURABILITY	30 CYCLES
MATING FORCE (INITIAL / AFTER TEST)	40N MAX.
UNMATING FORCE (INITIAL / AFTER TEST)	INITIAL: 10N MIN. AFTER TEST: 7N MIN.
COPLANARITY	0.08 MAX.
PRODUCT SPECIFICATION	PRS-2284
TEST REPORT	TR-16098
PACKING STANDARD	PST-15123 (20K/REEL) PST-16057 (5K/REEL)
INSTRUCTION MANUAL	HIM-16033

ANGLE	$\pm 2^\circ$	6 OVER 30 MAX.	$\pm 0.3$	PROJECTION 	SERIES No. <b>R3</b>	CUSTOMER COPY	
6 MAX.	$\pm 0.2$	30 OVER 120 MAX.	$\pm 0.5$				
GENERAL TOLERANCE.				TITLE <b>NOVASTACK®-B RECE</b>	SCALE <b>20:1</b>	<b>I-PEX</b>	
DWG.	DATE						
CHK.	DATE						
APP.	DATE						
				DWG. No.	<b>20713</b>	SIZE <b>A3</b>	SHEET <b>2/5</b> REV. <b>2</b>

MASK THICKNESS	A
t=0.08	2.90
t=0.1	2.74
t=0.12	2.64

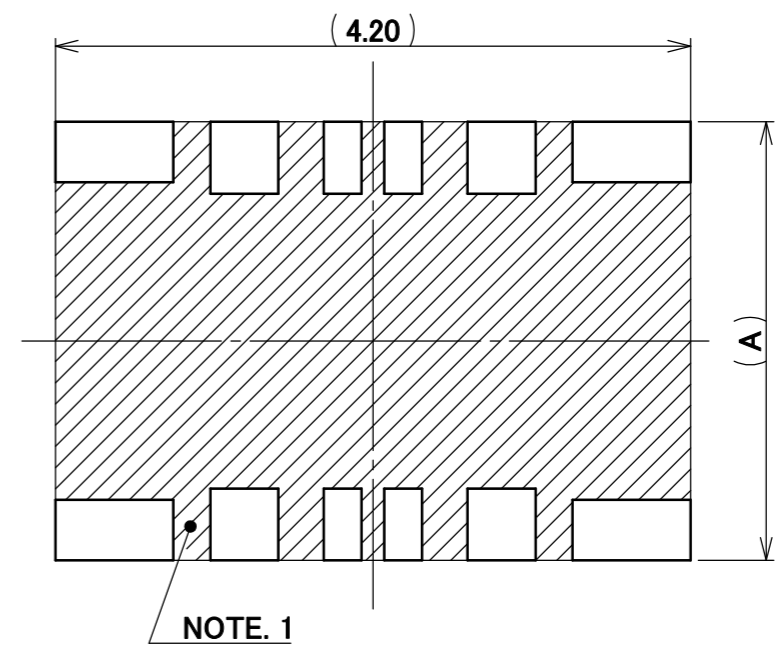
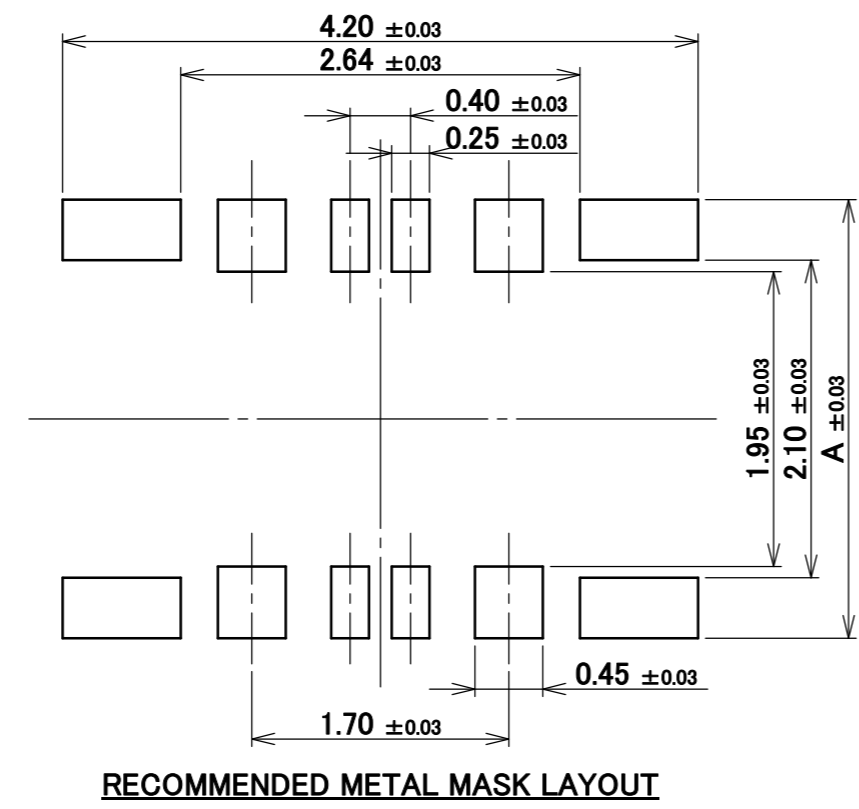
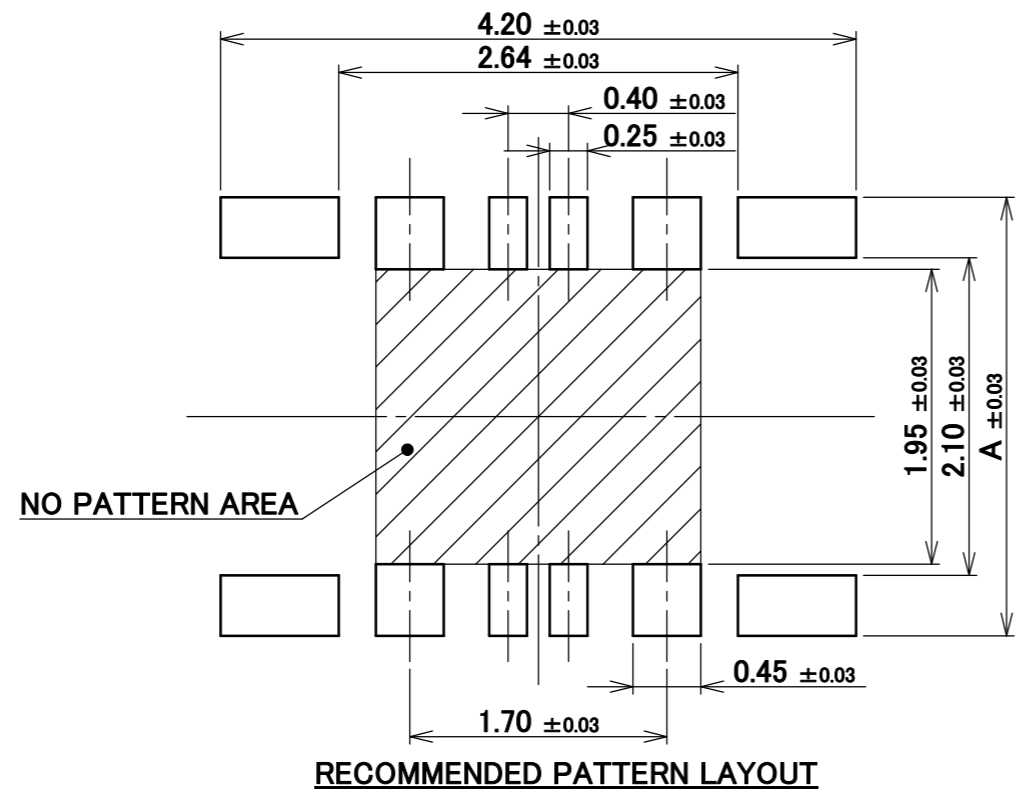

NOTES.  
1. THIS AREA CANNOT MOUNT ANOTHER COMPONENTS.

ANGLE	±2°	6 OVER 30 MAX.	±0.3	PROJECTION	SERIES No.	CUSTOMER COPY
	6 MAX.	±0.2	30 OVER 120 MAX.	±0.5	R3	
GENERAL TOLERANCE.				TITLE	SCALE	I-PEX
DWG.	DATE	NOVASTACK®-B RECE		20:1		
CHK.	DATE			UNIT		
APP.	DATE			mm		
				DWG. No.	SIZE	SHEET 3/5 REV. 2
				20713	A3	

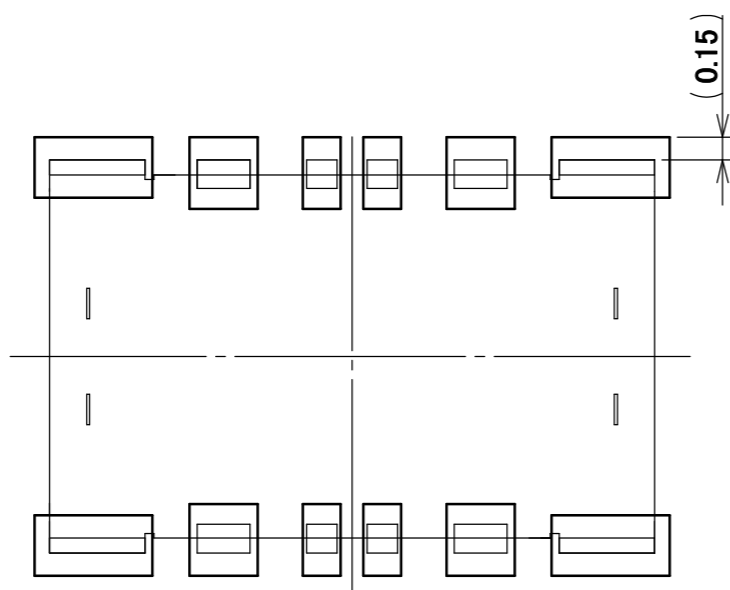

**CONNECTOR ON RECOMMENDED FOOTPRINT PATTERN**

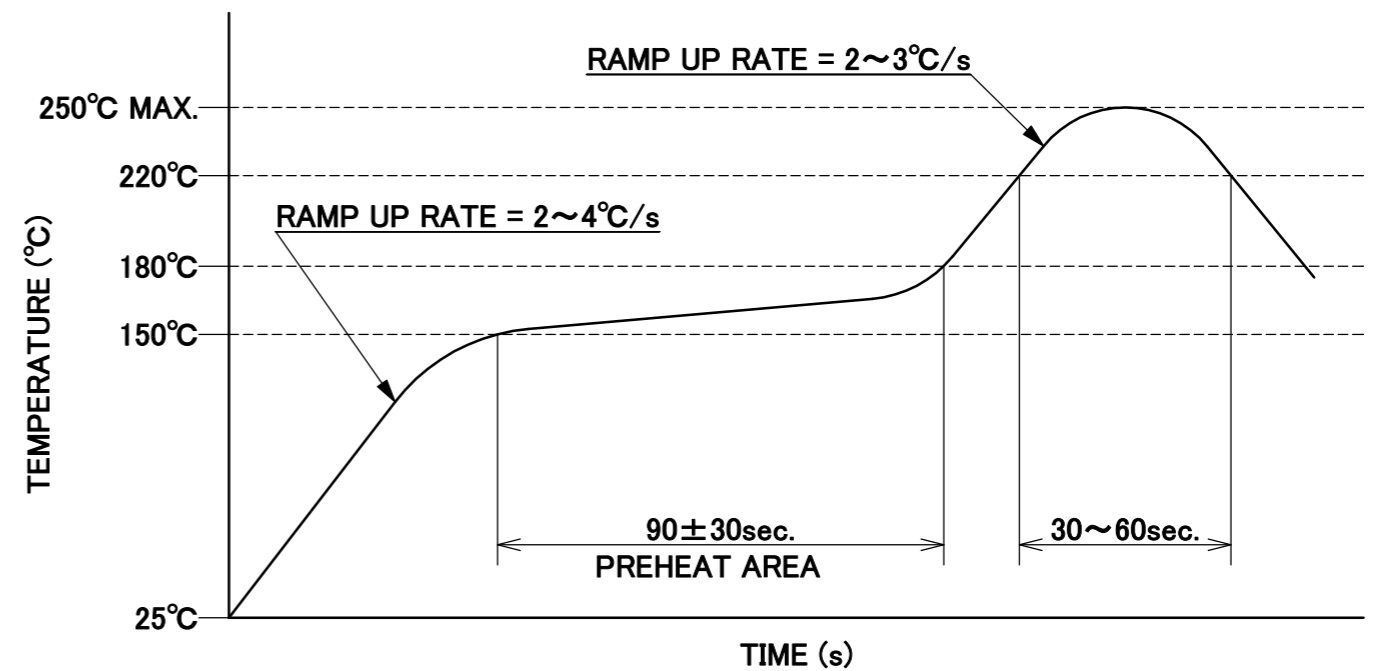

**REFLOW TEMPERATURE PROFILE**  
**SENJU METAL INDUSTRY CO., LTD. : M705-SHF(Sn96.5 Ag3.0 Cu0.5)**

ANGLE	±2°	6 OVER 30 MAX.	±0.3	PROJECTION ⊕	SERIES No. R3	CUSTOMER COPY	
6 MAX.	±0.2	30 OVER 120 MAX.	±0.5				
GENERAL TOLERANCE.				TITLE		SCALE	I-PEX
DWG.	DATE			NOVASTACK®-B RECE		20:1	
CHK.	DATE					UNIT	
APP.	DATE					mm	
				DWG. No.	20713	SIZE	
						A3	SHEET 4/5 REV. 2

PART NO.	B	C	QTY. PER EMBOSS REEL (PIECES / REEL)	QTY. PER PACKING CARTON (REELS / CARTON)
20713-004E-01	80	380	20,000 / REEL	20,000 × 8 REELS = 160,000
20713-004E-02	100	254	5,000 / REEL	5,000 × 8 REELS = 40,000

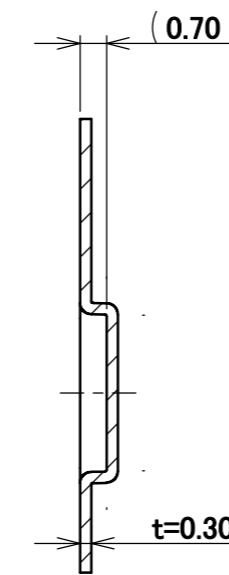
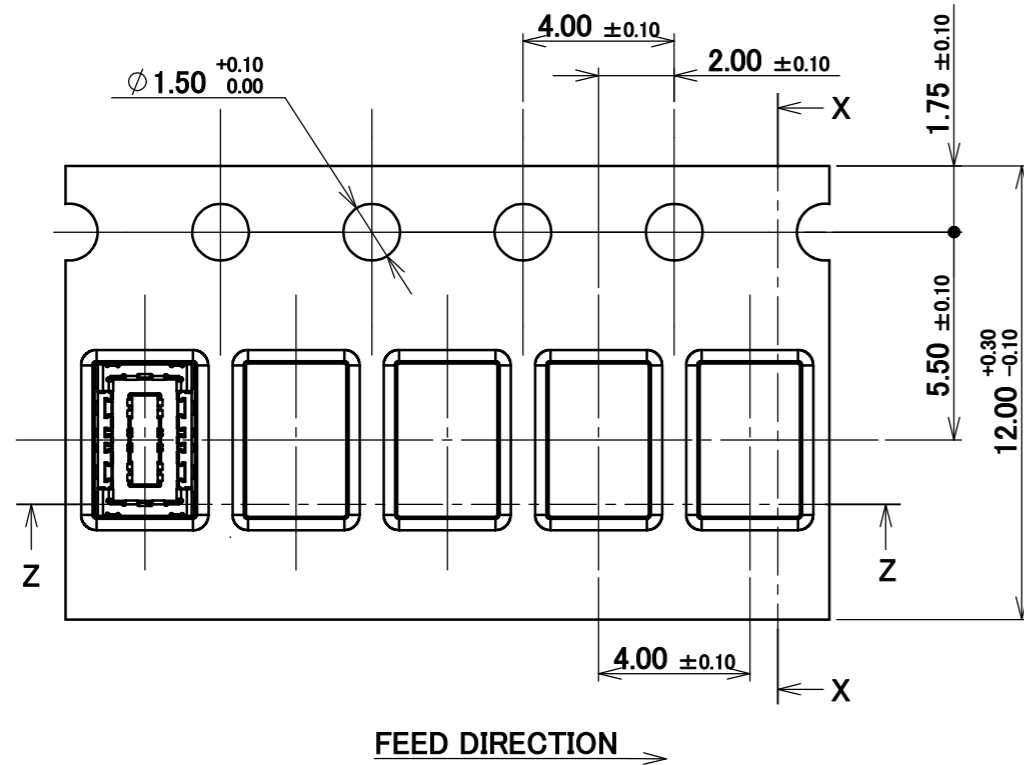
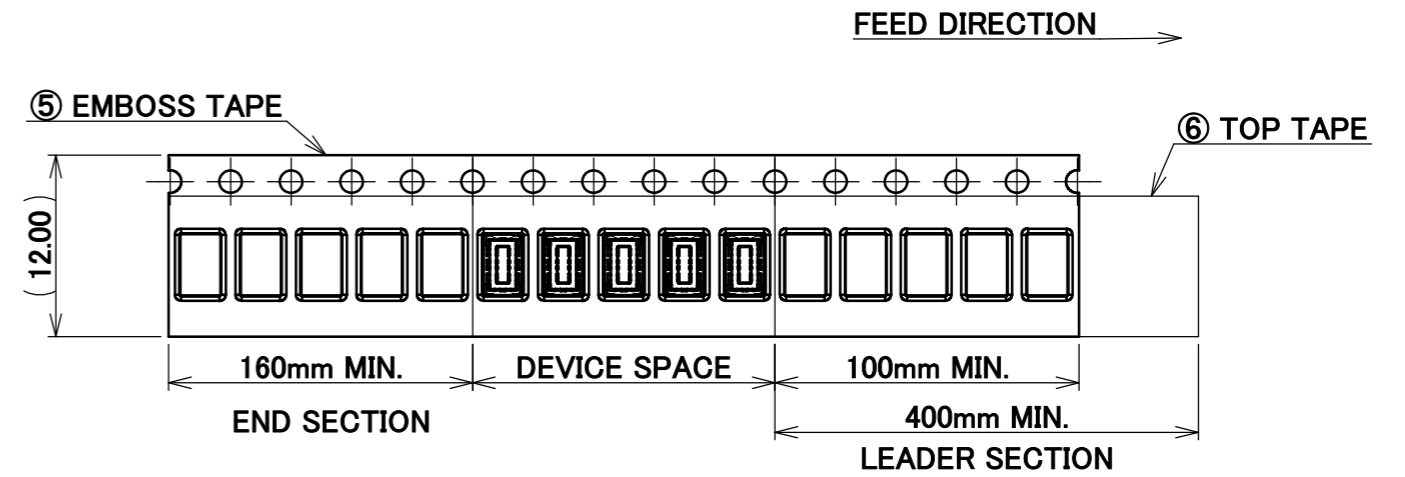
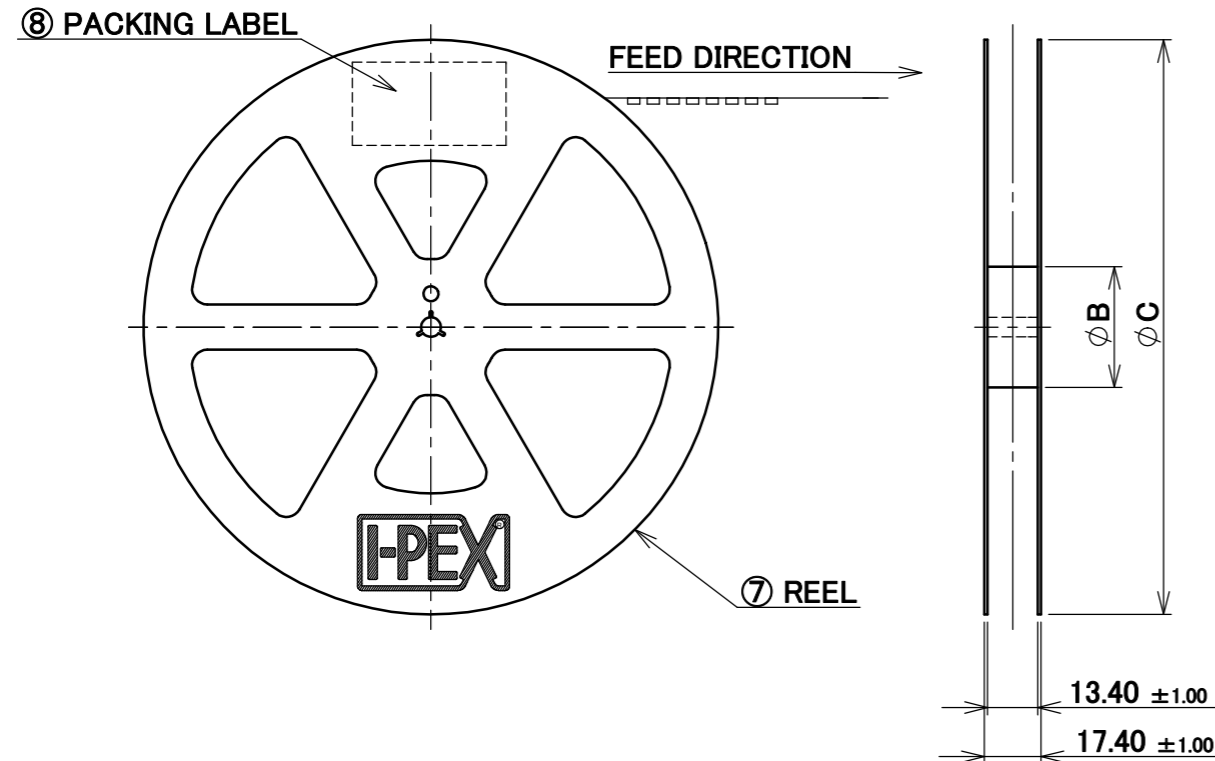

SECT. X-X  
(S=5:1)

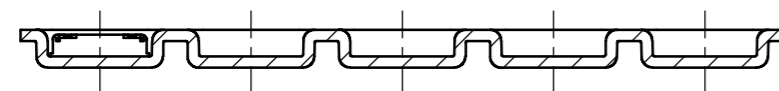

SECT. Z-Z  
(S=5:1)

NOTES.

- TAPING SPECIFICATION FOLLOWS JIS C 0806 (IEC 60286-3).
- MAKE EMPTY SECTION OF LEADER AND END ON EACH END OF THE TAPE.
- TOP TAPE SHALL NOT STICK OUT FROM EMBOSS TAPE.
- TOP TAPE SHALL NOT COVER FEED HOLE.

NO.	DESCRIPTION	MATERIAL	FINISH, REMARKS
8	PACKING LABEL	-	-
7	REEL	PS	ANTI-STATIC TYPE BLACK
6	TOP TAPE	PET t=0.062 TRANSPARENCY	ANTI-STATIC TYPE
5	EMBOSS TAPE	PS TRANSPARENCY	ANTI-STATIC TYPE

ANGLE	±2°	6 OVER 30 MAX.	±0.3	PROJECTION	SERIES No.	CUSTOMER COPY
6 MAX.	±0.2	30 OVER 120 MAX.	±0.5		R3	
GENERAL TOLERANCE.				TITLE	SCALE 1:X UNIT mm SIZE A3 SHEET 5/5 REV. 2	
DWG.	DATE			NOVASTACK®-B RECE		
CHK.	DATE					
APP.	DATE			DWG. No. 20713		