

PART NO.

3186-0001



Halogen Free



RoHS Compliant

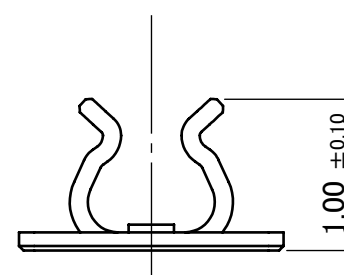
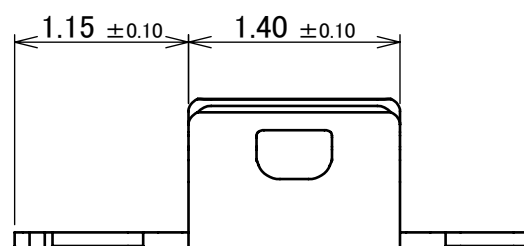
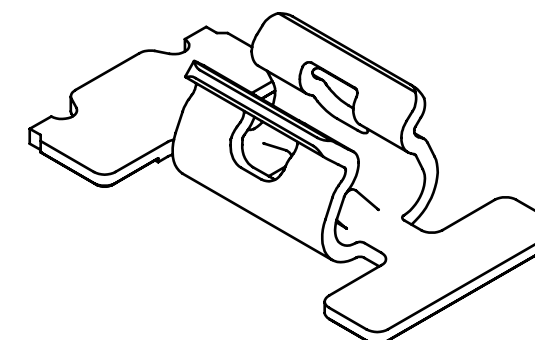
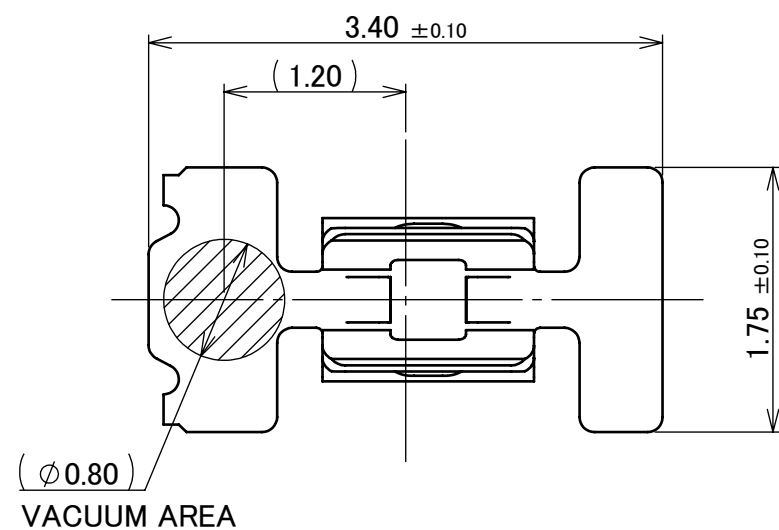

1	MP-A03	PHOSPHOR BRONZE	CONTACT PART Sn 2.00 μm MIN. OVER Ni 1.00 μm MIN. SOLDERING PART Sn 1.00 μm MIN. OVER Ni 0.50 μm MIN.
NO.	DESCRIPTION	MATERIAL	FINISH , REMARKS

					ANGLE	±2°	6 OVER 30 MAX.	±0.3	PROJECTION	SERIES No.	CUSTOMER COPY		
4	Z231552	H.T	2024/01/11	Yufu	6 MAX.	±0.2	30 OVER 120 MAX.	±0.5		R0	SCALE	I-PEX	
3	Z230873	Y.I	2023/07/28	M.T	GENERAL TOLERANCE.				TITLE		20:1		
2	Z211214	H.T	2021/10/05	M.T	DWG.	DATE			MP-A03		UNIT		
1	Z180786	S.K	2018/09/20	Ken	S.Suzuki	2015/05/11					mm		
0	Z150503	S.S	2015/05/11		CHK.	T.Uchida					SIZE	SHEET	REV.
REV.	ECN	BY	DATE	APP.	APP.				DWG. No.	3186	A3	1/5	4
REVISION RECORD					T.Takano								

ITEMS	SPECIFICATION
APPLICABLE CONNECTOR PART No.	•CABLE CLAMP (3mm) FOR Φ 0.64 COAXIAL CABLE (P/N: 2918-0302) •CABLE CLAMP (6mm) FOR Φ 0.64 COAXIAL CABLE (P/N: 2918-0602)
OPERATING TEMPERATURE	233~358K(-40°C~+85°C)
OPERATING HUMIDITY	85% MAX.(NON-CONDENSING)
CONTACT RESISTANCE	INITIAL : 70mohm MAX. / AFTER TEST : 70mohm MAX.
DURABILITY	5 CYCLES
MATING FORCE (INITIAL / AFTER TEST)	INITIAL : 25N MAX. / AFTER TEST : 25N MAX.
UNMATING FORCE (INITIAL / AFTER TEST)	INITIAL : 3N MIN. / AFTER TEST : 2N MIN.
PRODUCT SPECIFICATION	PRS-2130
TEST REPORT	TR-15085
PACKING STANDARD	PST-15081
INSTRUCTION MANUAL	HIM-15029
APPEARANCE CRITERIA No.	QLS-A***

ANGLE	$\pm 2^\circ$	6 OVER 30 MAX.	± 0.3	PROJECTION 	SERIES No. R0	CUSTOMER COPY		
6 MAX.	± 0.2	30 OVER 120 MAX.	± 0.5					
GENERAL TOLERANCE.				TITLE MP-A03	SCALE	I-PEX		
DWG.	DATE				-			
CHK.					UNIT			
APP.					mm			
				DWG. No.	3186	SIZE	SHEET	REV.
					A3	2/5	4	

① Φ0.64 COAXIAL CABLE WITH 3mm CABLE CLAMP (P/N : 2918-0302)

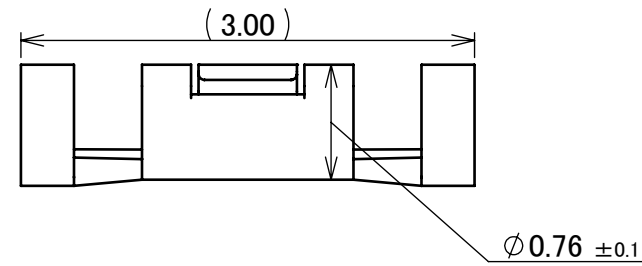

② Φ0.64 COAXIAL CABLE WITH 6mm CABLE CLAMP (P/N : 2918-0602)

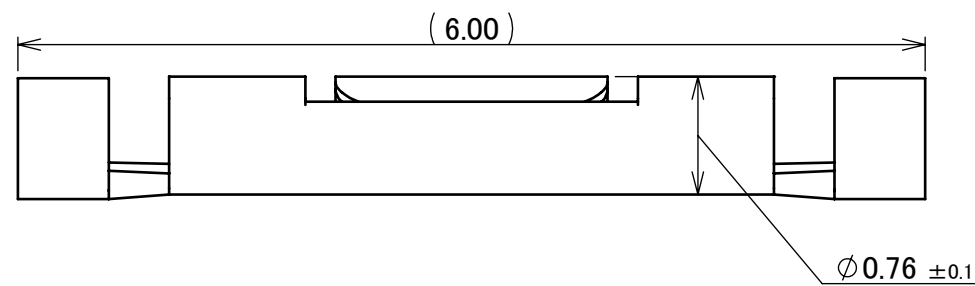

APPLICABLE CABLE

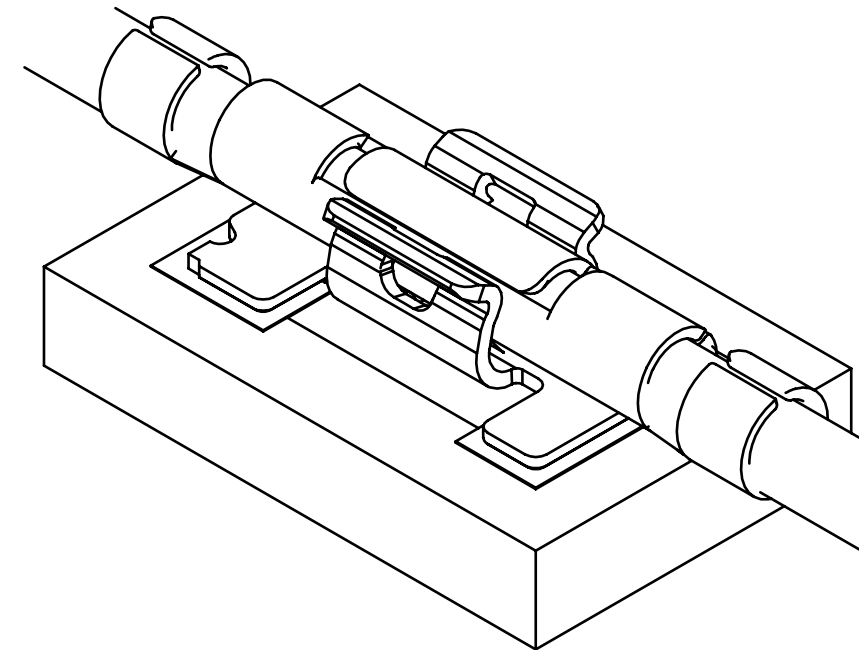
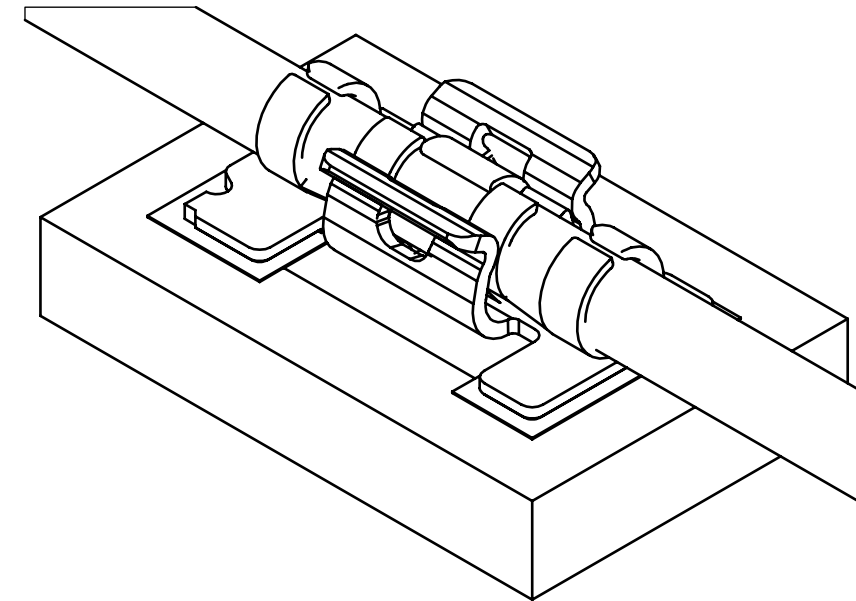

MATING CONDITION

NOTE.
1. ONLY A SIMILAR CABLE IS REPLACEABLE.

ANGLE	±2°	6 OVER 30 MAX.	±0.3	PROJECTION ⊕	SERIES No. R0	CUSTOMER COPY					
6 MAX.	±0.2	30 OVER 120 MAX.	±0.5								
GENERAL TOLERANCE.				TITLE MP-A03		SCALE 20:1	I-PEX				
DWG.	DATE			DWG. No.		UNIT mm					
CHK.				3186		SIZE A3				SHEET 3/5	REV. 4
APP.											

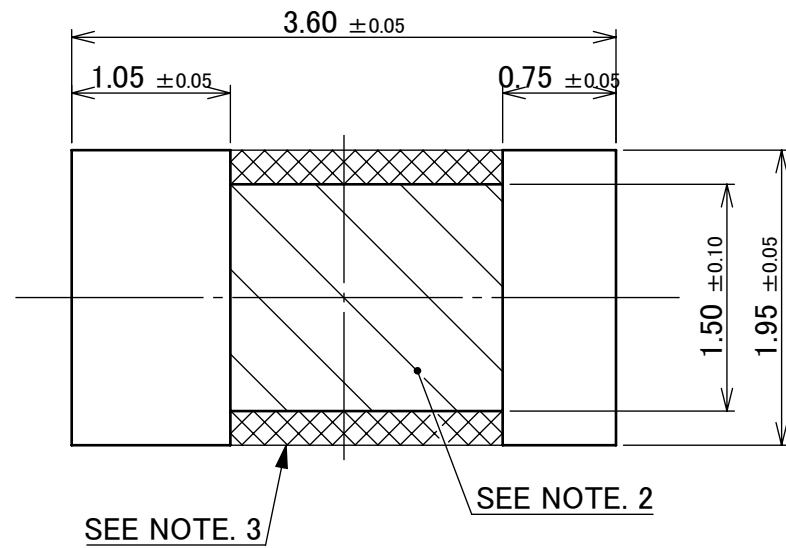

RECOMMENDED FOOTPRINT PATTERN

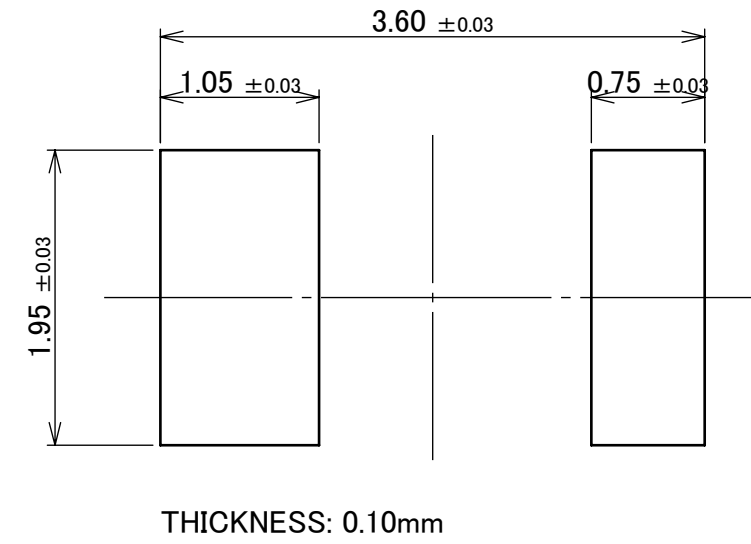

METAL MASK

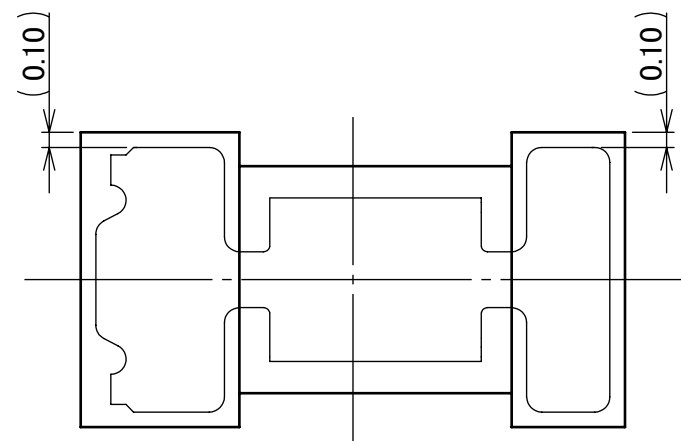

CONNECTOR ON RECOMMENDED FOOTPRINT PATTERN

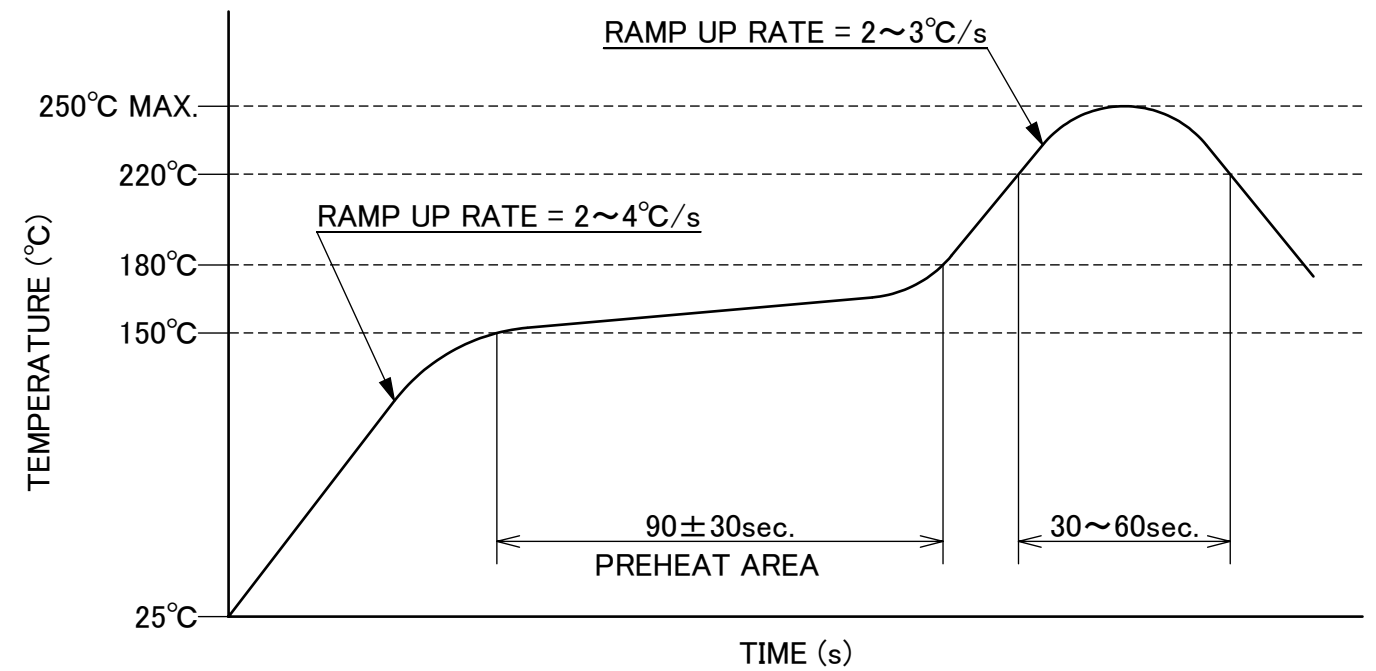

REFLOW TEMPERATURE PROFILE
SENJU METAL INDUSTRY CO., LTD. : M705-SHF(Sn96.5 Ag3.0 Cu0.5)

- NOTES.
2. NO GROUND, SIGNAL, AND RESIST IN THIS AREA.
3. DO NOT MOUNT ANOTHER COMPONENT IN THIS AREA.

ANGLE	±2°	6 OVER 30 MAX.	±0.3	PROJECTION ⊕	SERIES No. R0	CUSTOMER COPY	
	6 MAX.	±0.2	30 OVER 120 MAX.				
GENERAL TOLERANCE.				TITLE		SCALE	I-PEX
DWG.	DATE			MP-A03		20:1	
CHK.						UNIT	
APP.				DWG. No.		mm	SIZE
				3186		A3	
						4/5	REV.
							4

PART NO.	QTY. PER EMBOSS REEL (PIECES / REEL)	QTY. PER PACKING CARTON (REELS / CARTON)
3186-0001	10,000 / REEL	10 REELS / CARTON = 100,000

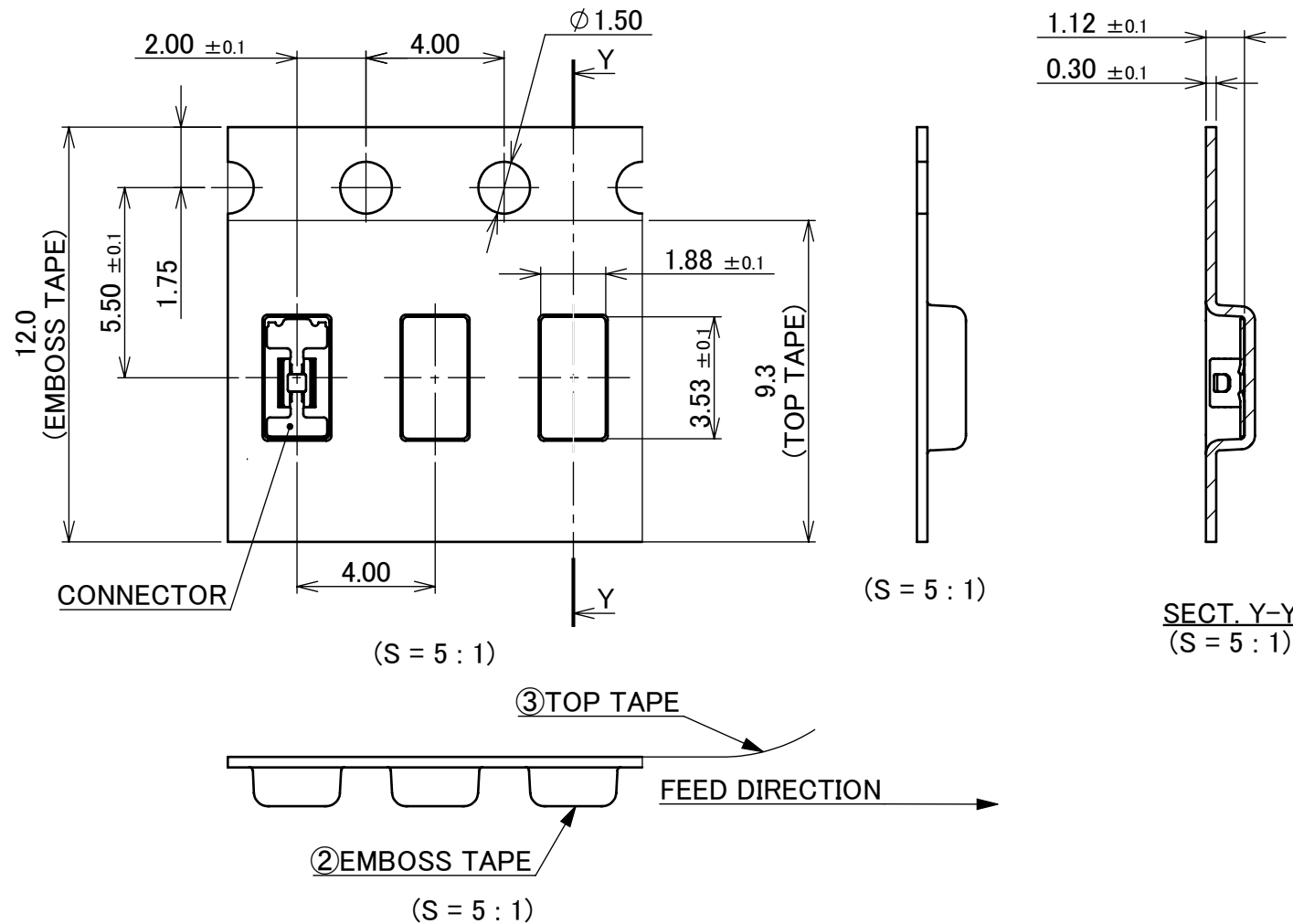
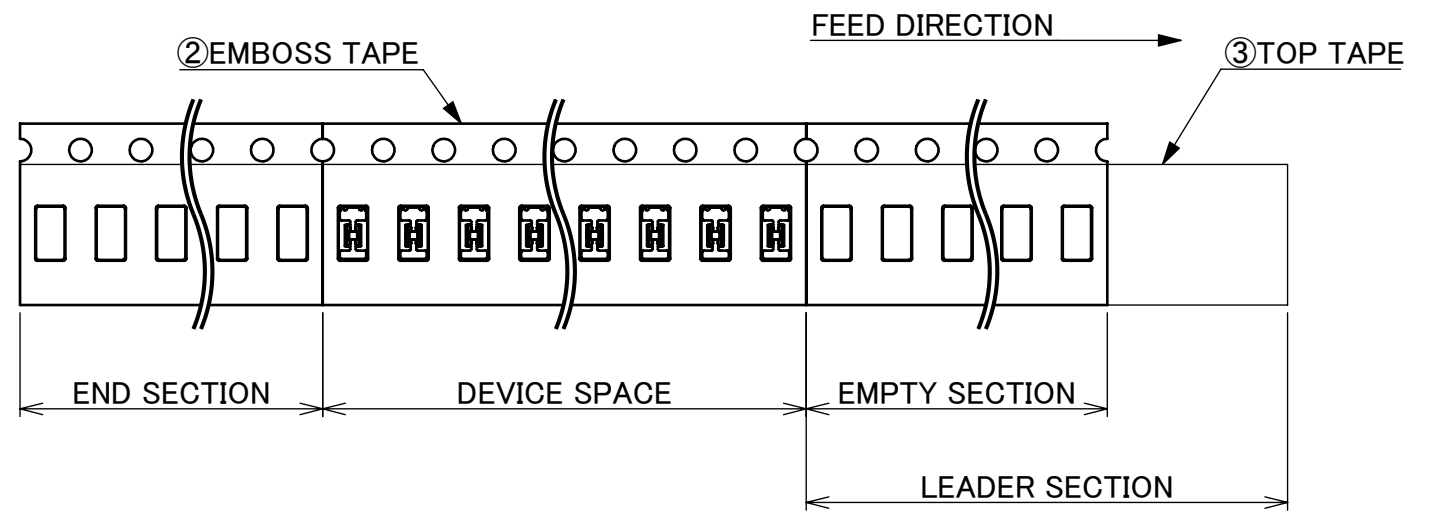
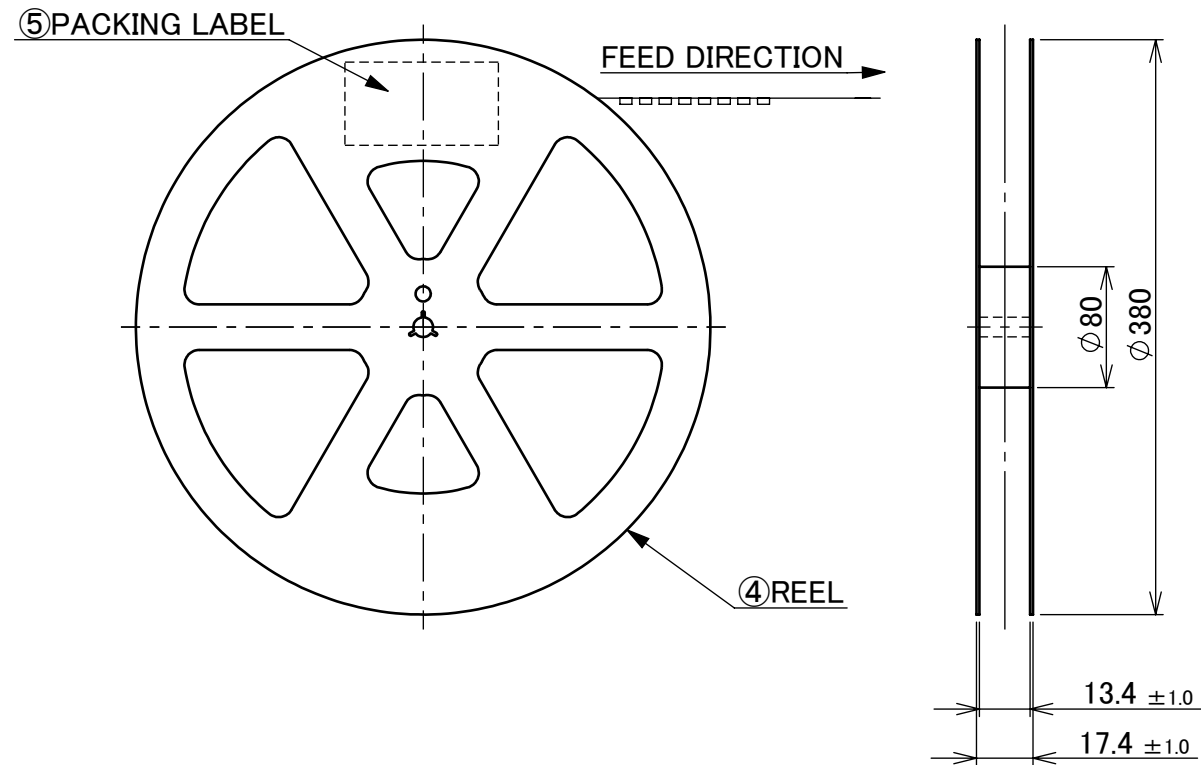

NOTES.

- TAPING SPECIFICATION FOLLOWS JIS C 0806 (IEC 60286-3).
- MAKE EMPTY SECTION OF LEADER AND END ON EACH END OF THE TAPE.
- TOP TAPE SHALL NOT STICK OUT FROM EMBOSS TAPE.
- TOP TAPE SHALL NOT COVER FEED HOLE.

NO.	DESCRIPTION	MATERIAL	FINISH, REMARKS
5	PACKING LABEL	-	-
4	REEL	PS	ANTI-STATIC TYPE BLACK
3	TOP TAPE	PET t=0.062 TRANSPARENCY	ANTI-STATIC TYPE
2	EMBOSS TAPE	PS t=0.3 TRANSPARENCY	

ANGLE	±2°	6 OVER 30 MAX.	±0.3	PROJECTION ⊕	SERIES No. R0	CUSTOMER COPY		
	6 MAX.	±0.2	30 OVER 120 MAX.					
GENERAL TOLERANCE.				TITLE	I-PEX			
DWG.	DATE			MP-A03				
CHK.					SCALE	1:X		
APP.					UNIT			
				DWG. No.	3186	SIZE	SHEET	REV.
						A3	5/5	4