

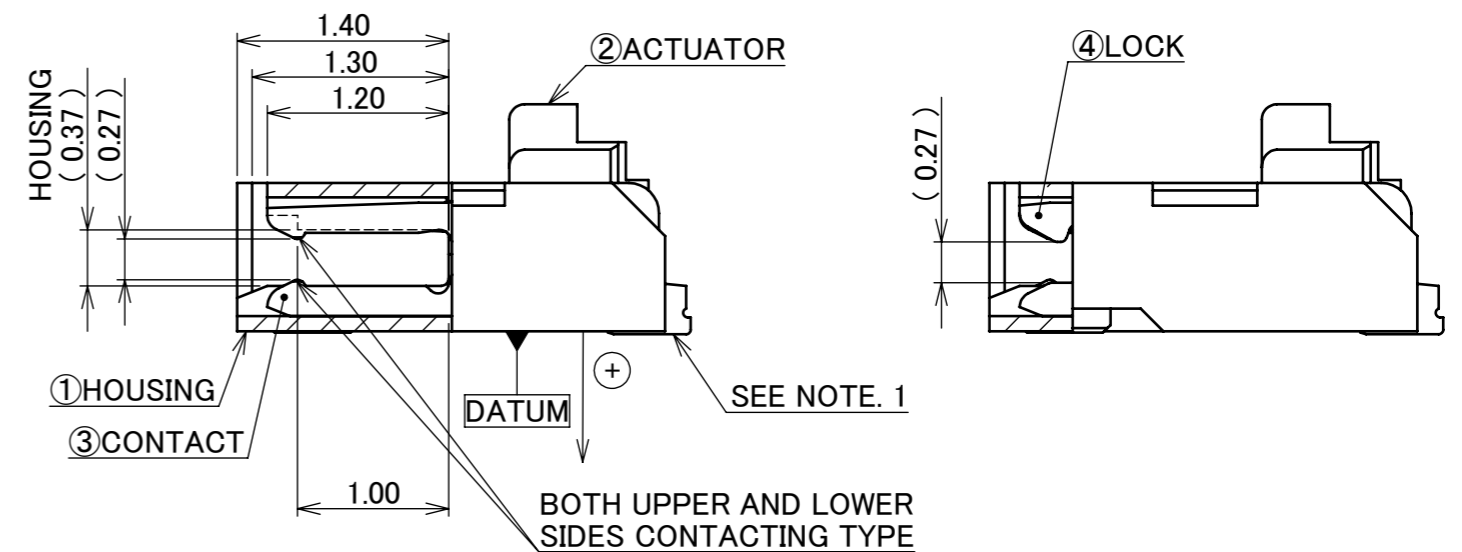

PART No.	POS.	A	B	C	D	E	F	G
20600-004E-01	4	1.50	2.50	4.70	3.80	2.80	3.56	4.15
20600-006E-01	6	2.50	3.50	5.70	4.80	3.80	4.56	5.15
20600-008E-01	8	3.50	4.50	6.70	5.80	4.80	5.56	6.15
20600-010E-01	10	4.50	5.50	7.70	6.80	5.80	6.56	7.15
20600-012E-01	12	5.50	6.50	8.70	7.80	6.80	7.56	8.15
20600-014E-01	14	6.50	7.50	9.70	8.80	2.80	8.56	9.15
20600-016E-01	16	7.50	8.50	10.70	9.80	3.80	9.56	10.15
20600-018E-01	18	8.50	9.50	11.70	10.80	4.80	10.56	11.15
20600-020E-01	20	9.50	10.50	12.70	11.80	5.80	11.56	12.15
◆20600-022E-01	22	10.50	11.50	13.70	12.80	6.80	12.56	13.15
20600-024E-01	24	11.50	12.50	14.70	13.80	7.80	13.56	14.15
◆20600-026E-01	26	12.50	13.50	15.70	14.80	8.80	14.56	15.15
◆20600-028E-01	28	13.50	14.50	16.70	15.80	9.80	15.56	16.15

◆MARK MEANS NOT AVAILABLE.

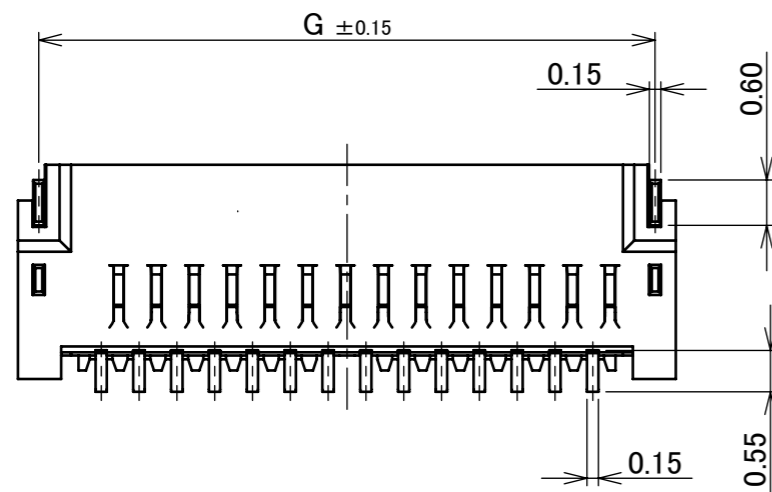
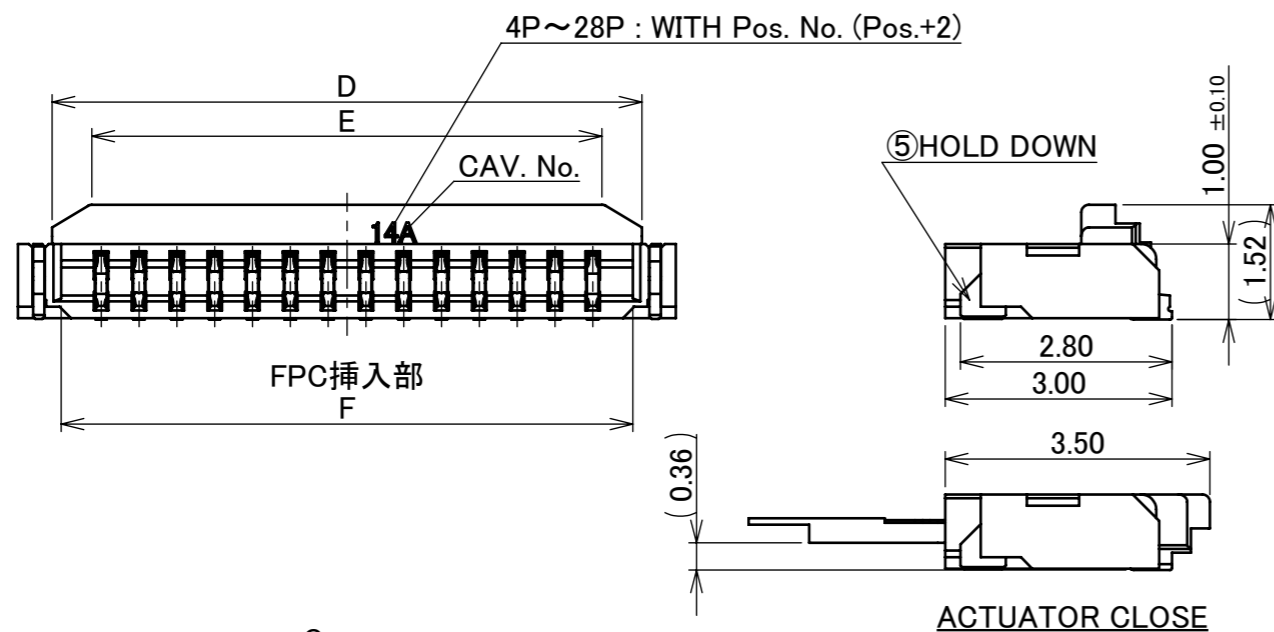
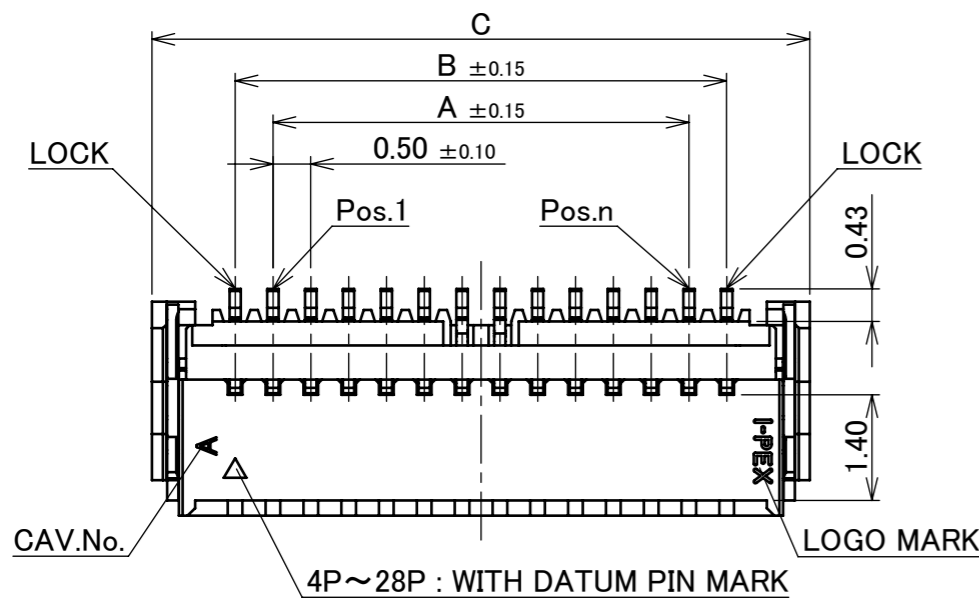

NO.	DISCRIPTION	MATERIAL	FINISH, REMARKS
5	HOLD DOWN	PHOSPHOR BRONZE	Sn 2~6 μm MIN.OVER Ni 1.0 μm MIN.
4	LOCK	PHOSPHOR BRONZE	Au 0.03 μm MIN. OVER Ni 1.0 μm MIN.
3	CONTACT	PHOSPHOR BRONZE	CONTACT AREA : Au 0.1 μm MIN. OVER Ni 1.0 μm MIN. SOLDERING AREA : Au 0.03 μm MIN. OVER Ni 1.0 μm MIN.
2	ACTUATOR	LCP	UL94V-0, BEIGE
1	HOUSING	LCP	UL94V-0, BEIGE

CAUTION VISIT OUR WEBSITE FOR LATEST VERSIONS OF INSTRUCTION MANUAL NO. HIM-12019 TO HANDLE THE PRODUCT PROPERLY AND SAFELY.

NOTES
1. CONTACT TAIL IS PROJECTION FROM HOUSING IN THE + DIRECTION. (0~0.06)

REV.	ECN	BY	DATE	APP.	APP.	PROJECTION	SERIES No.	TITLE	SCALE	SHEET	REV.
9	Z210671	M.M	June/23/'21	H.I	ANGLE ±2°	6 OVER 30 MAX. ±0.3	R2	MINIFLEX® 5-BFN II LK03	10:1	1/5	9
8	Z200582	M.M	June/05/'20	Y.S	6 MAX. ±0.2	30 OVER 120 MAX. ±0.5					
7	Z191264	R.F	Sept./30/'19	H.I	GENERAL TOLERANCE.						
6	Z181426	K.T	Nov./01/'18	Y.S	DWG. Y.Nakamura	DATE 2013/11/20					
5	Z181192	K.T	Sept/12/'18	Y.S	CHK.						
4	Z160876	H.A	July/16/'15	Y.S	J.Tateishi						
REVISION RECORD					E.Kawabe	DWG. No. 20600					

ITEMS	SPECIFICATION
RATING VOLTAGE	50V AC (PER CONTACT)
RATING AMPERAGE	0.5A DC (PER CONTACT) 7.0A DC (PER CONNECTOR)
OPERATING TEMPERATURE	233~398K(-40°C~125°C)
OPERATING HUMIDITY	80% MAX.(NON-CONDENSING)
CONTACT RESISTANCE	INITIAL : 40mohm MAX. / AFTER TEST : \angle 20mohm MAX.
INSULATION RESISTANCE	100Mohm MIN.
DIELECTRIC WITHSTANDING VOLTAGE	AC200V 1min
DURABILITY	20TH CYCLES
ACTUATOR LOCKING FORCE (INITIAL / 20TH CYCLES)	INITIAL/ 20TH CYCLES : 0.6N(61gf) \times (n + 2) MAX.
ACTUATOR UNLOCKING FORCE (INITIAL / 20TH CYCLES)	INITIAL/ 20TH CYCLES : 0.05N(5gf) \times (n + 2) MIN.
FPC RETENTION FORCE (INITIAL / AFTER TEST)	INITIAL : 0.15N(15gf) \times n + 2.0N MIN. / AFTER TEST : 0.15N(15gf) \times n + 1.0N MIN.
COPLANARITY	0.08 MAX.
PRODUCT SPECIFICATION	PRS-1841
TEST REPORT	TR-14132
PACKING STANDARD	PST-13031
INSTRUCTION MANUAL	HIM-12019
APPEARANCE CRITERIA No.	QLS-A***

※ "n" IS THE NUMBER OF PIN

ANGLE	$\pm 2^\circ$	6 OVER 30 MAX.	± 0.3	PROJECTION 	SERIES No. R2	CUSTOMER COPY		
6 MAX.	± 0.2	30 OVER 120 MAX.	± 0.5			SCALE	I-PEX	
GENERAL TOLERANCE.				TITLE	UNIT	SIZE		SHEET
DWG.	DATE			MINIFLEX® 5-BFN II LK03	mm			
CHK.				DWG. No.	REV.	9		
APP.				20600				

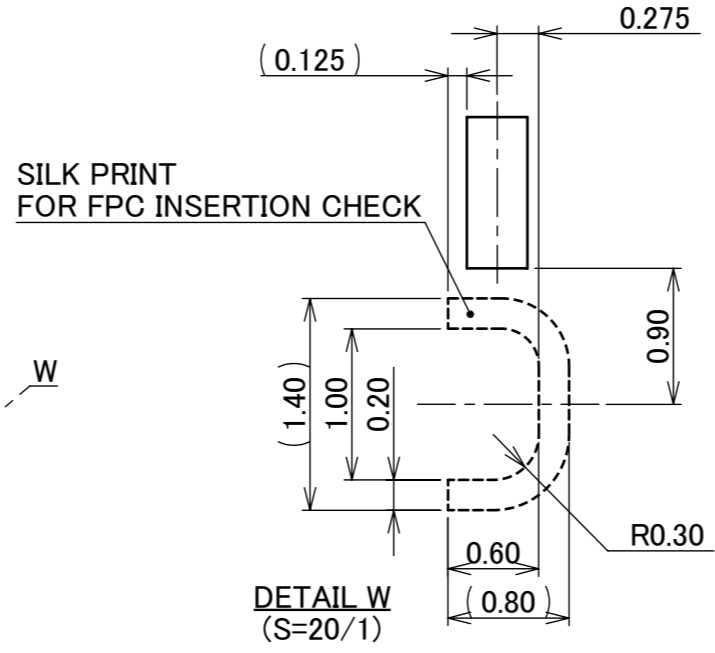
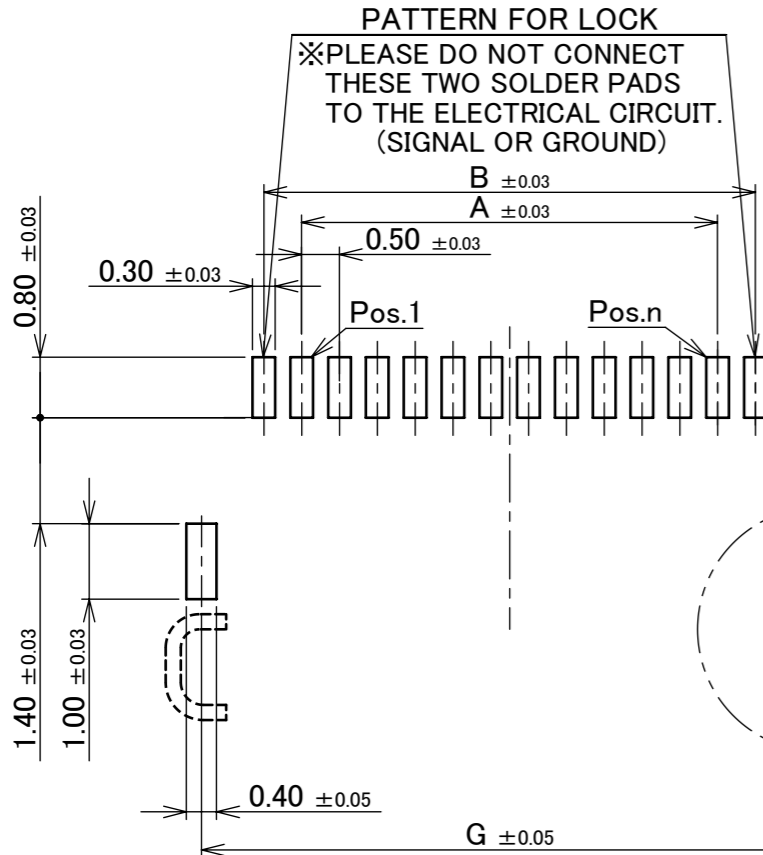

RECOMMENDED PCB LAYOUT & METAL MASK LAYOUT
METAL MASK THICKNESS : t=0.12mm

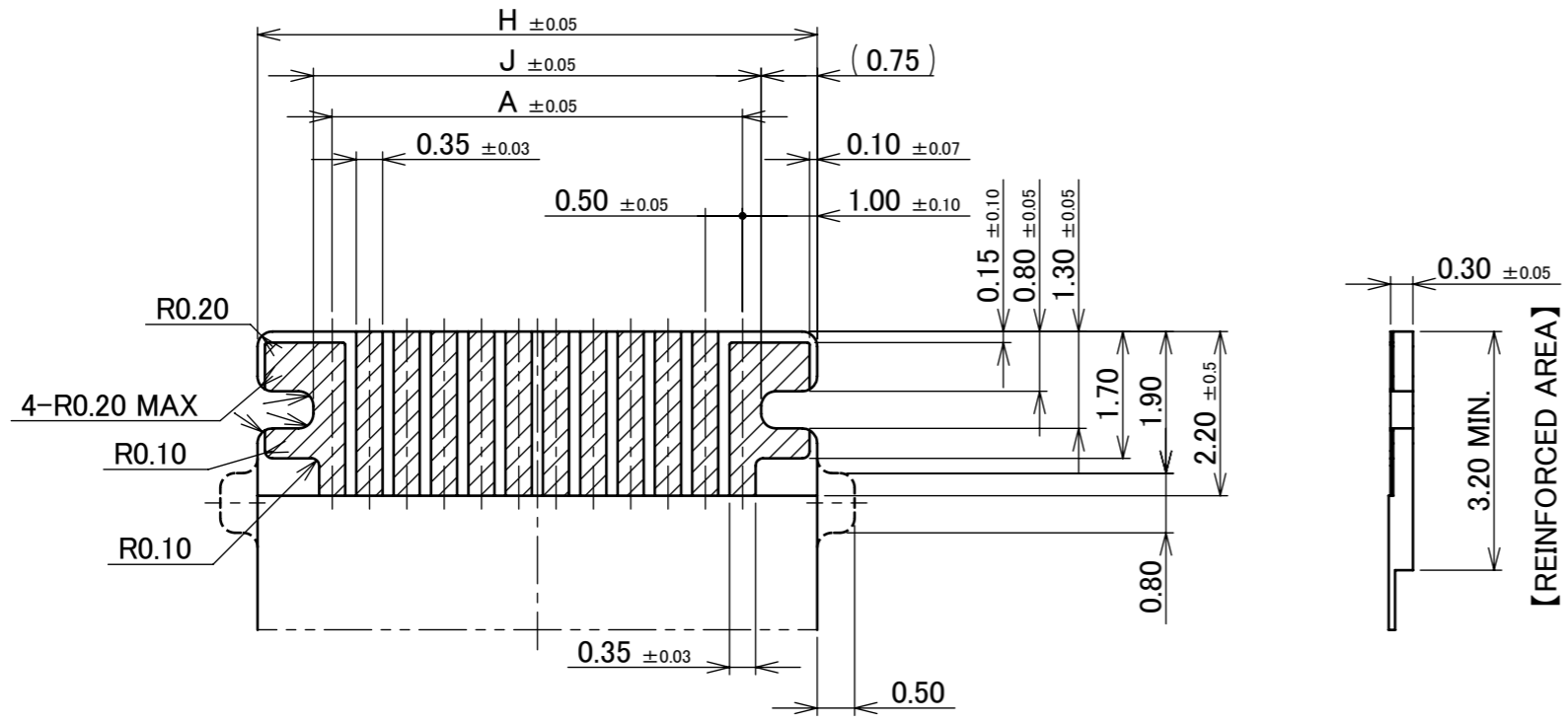

RECOMMENDED FPC LAYOUT

PART No.	POS.	A	B	G	H	J
20600-004E-01	4	1.50	2.50	4.15	3.50	2.00
20600-006E-01	6	2.50	3.50	5.15	4.50	3.00
20600-008E-01	8	3.50	4.50	6.15	5.50	4.00
20600-010E-01	10	4.50	5.50	7.15	6.50	5.00
20600-012E-01	12	5.50	6.50	8.15	7.50	6.00
20600-014E-01	14	6.50	7.50	9.15	8.50	7.00
20600-016E-01	16	7.50	8.50	10.15	9.50	8.00
20600-018E-01	18	8.50	9.50	11.15	10.50	9.00
20600-020E-01	20	9.50	10.50	12.15	11.50	10.00
◆20600-022E-01	22	10.50	11.50	13.15	12.50	11.00
20600-024E-01	24	11.50	12.50	14.15	13.50	12.00
◆20600-026E-01	26	12.50	13.50	15.15	14.50	13.00
◆20600-028E-01	28	13.50	14.50	16.15	15.50	14.00

◆MARK MEANS NOT AVAILABLE.

- NOTES**
- 2.MATERIAL
 - COVER FILM : PI
 - CONDUCTOR : COPPER(RARE)
 - BASE FILM : PI
 - STIFFENER : PI
 - ADHESIVE : THERMOSETTING ADHESIVE
 - 3.FINISH
 - Au OVER Ni PLATING.

ANGLE	$\pm 2^\circ$	6 OVER 30 MAX.	± 0.3	PROJECTION	SERIES No.	CUSTOMER COPY		
	6 MAX.	± 0.2	30 OVER 120 MAX.	± 0.5	R2			
GENERAL TOLERANCE.				TITLE	SCALE		I-PEX	
DWG.	DATE			MINIFLEX® 5-BFN II	10:1	UNIT		
CHK.				LK03	mm			
APP.				DWG. No.	20600	SIZE	SHEET	REV.
						A3	3/5	9

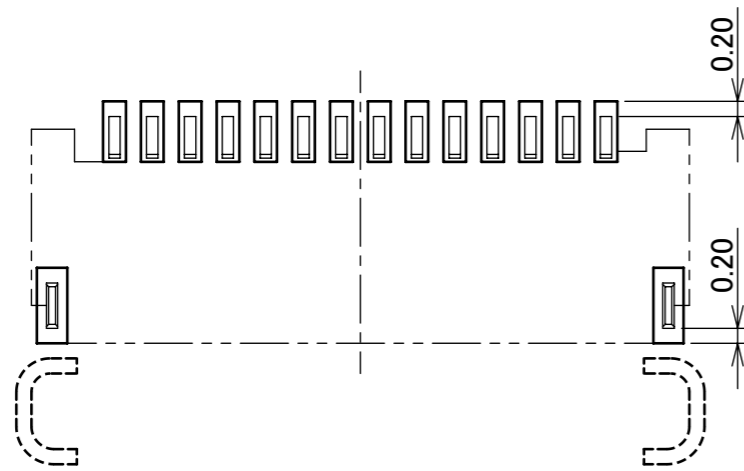

CONNECTOR ON RECOMMENDED FOOTPRINT PATTERN

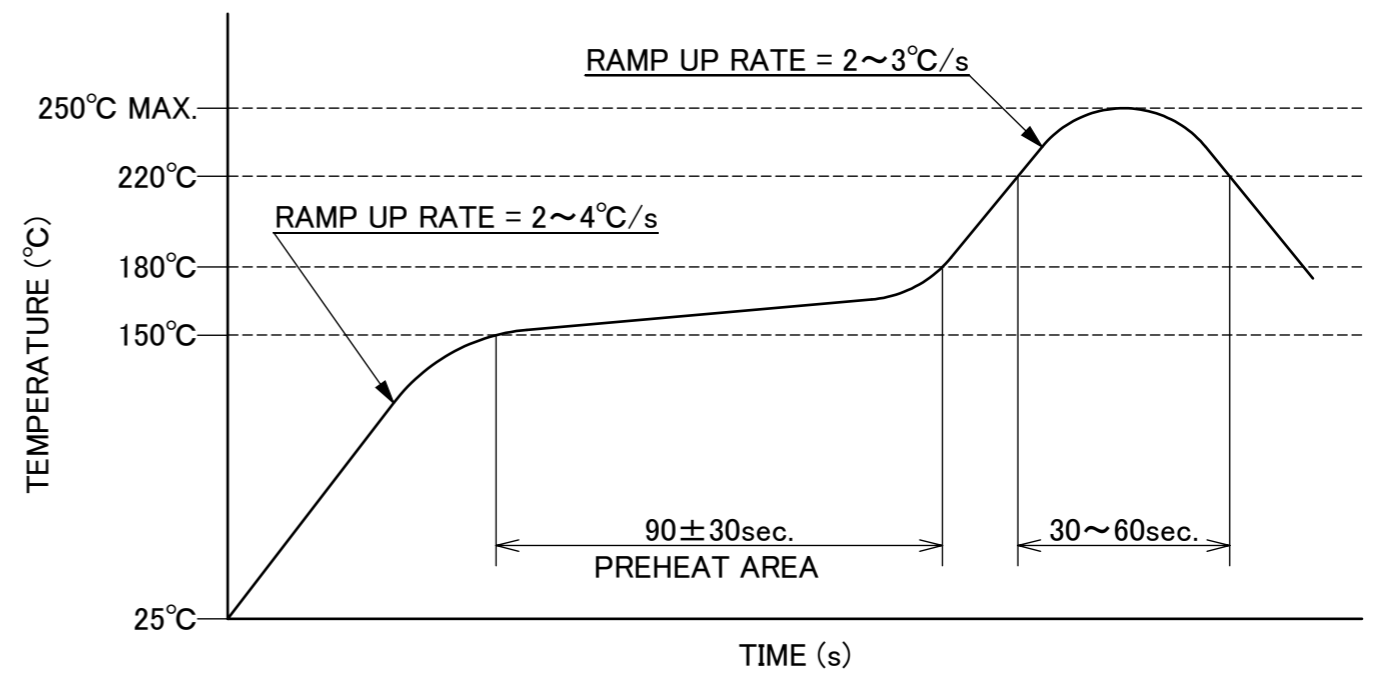

REFLOW TEMPERATURE PROFILE
 SENJU METAL INDUSTRY CO., LTD. : M705-SHF(Sn96.5 Ag3.0 Cu0.5)

ANGLE	±2°	6 OVER 30 MAX.	±0.3	PROJECTION 	SERIES No. R2	CUSTOMER COPY		
6 MAX.	±0.2	30 OVER 120 MAX.	±0.5					
GENERAL TOLERANCE.				TITLE MINIFLEX® 5-BFN II LK03	SCALE 10:1	UNIT I-PEX		
DWG.	DATE							
CHK.								
APP.								
				DWG. No.	20600	SIZE A3	SHEET 4/5	REV. 9

PART No.	K	L	M	N	P	Q	QTY. PER EMBOSS REEL (PIECES / REEL)	QTY. PER PACKING CARTON (REELS / CARTON)
20600-004E-01	12.0	9.5	5.5	5.0	3.5	3.0	5000 PIECES / REEL	8 REELS / CARTON (40000 PIECES / CARTON)
20600-006E-01	16.0	13.5	7.5	6.0	4.5	4.0	5000 PIECES / REEL	7 REELS / CARTON (35000 PIECES / CARTON)
20600-008E-01				7.0	5.5	5.0		
20600-010E-01				8.0	6.5	6.0		
20600-012E-01	24.0	21.5	11.5	9.0	7.5	7.0	5000 PIECES / REEL	5 REELS / CARTON (25000 PIECES / CARTON)
20600-014E-01				10.0	8.5	8.0		
20600-016E-01				11.0	9.5	9.0		
20600-018E-01				12.0	10.5	10.0		
20600-020E-01				13.0	11.5	11.0		
◆20600-022E-01				14.0	12.5	12.0		
20600-024E-01				15.0	13.5	13.0		
◆20600-026E-01	16.0	14.5	14.0					
◆20600-028E-01	17.0	15.5	15.0					

◆MARK MEANS NOT AVAILABLE.

NOTES.

- TAPING SPECIFICATION FOLLOWS JIS C 0806 (IEC 60286-3).
- MAKE EMPTY SECTION OF LEADER AND END ON EACH END OF THE TAPE.
- TOP TAPE SHALL NOT STICK OUT FROM EMBOSS TAPE.
- TOP TAPE SHALL NOT COVER FEED HOLE.

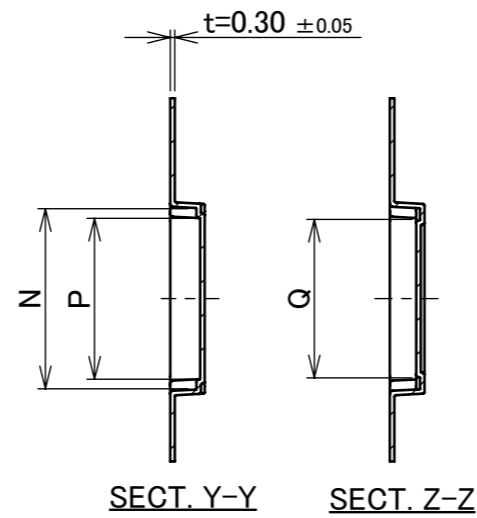
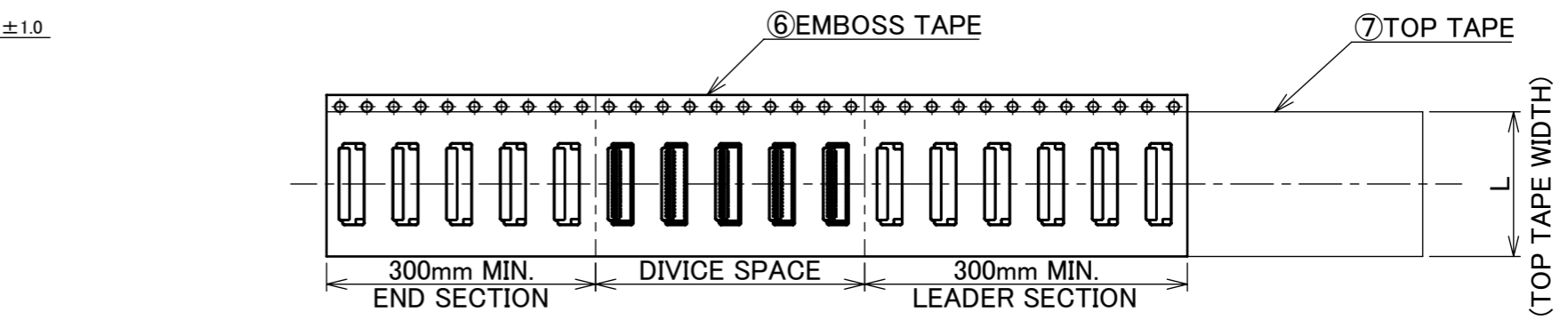
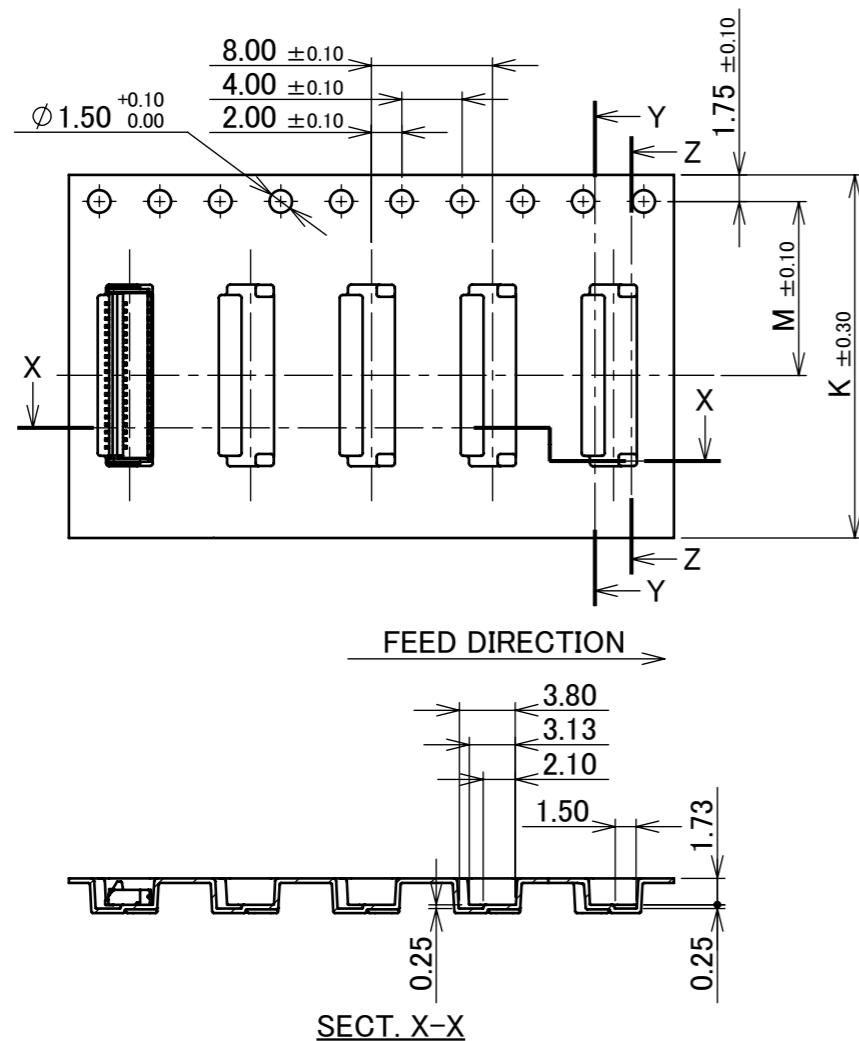
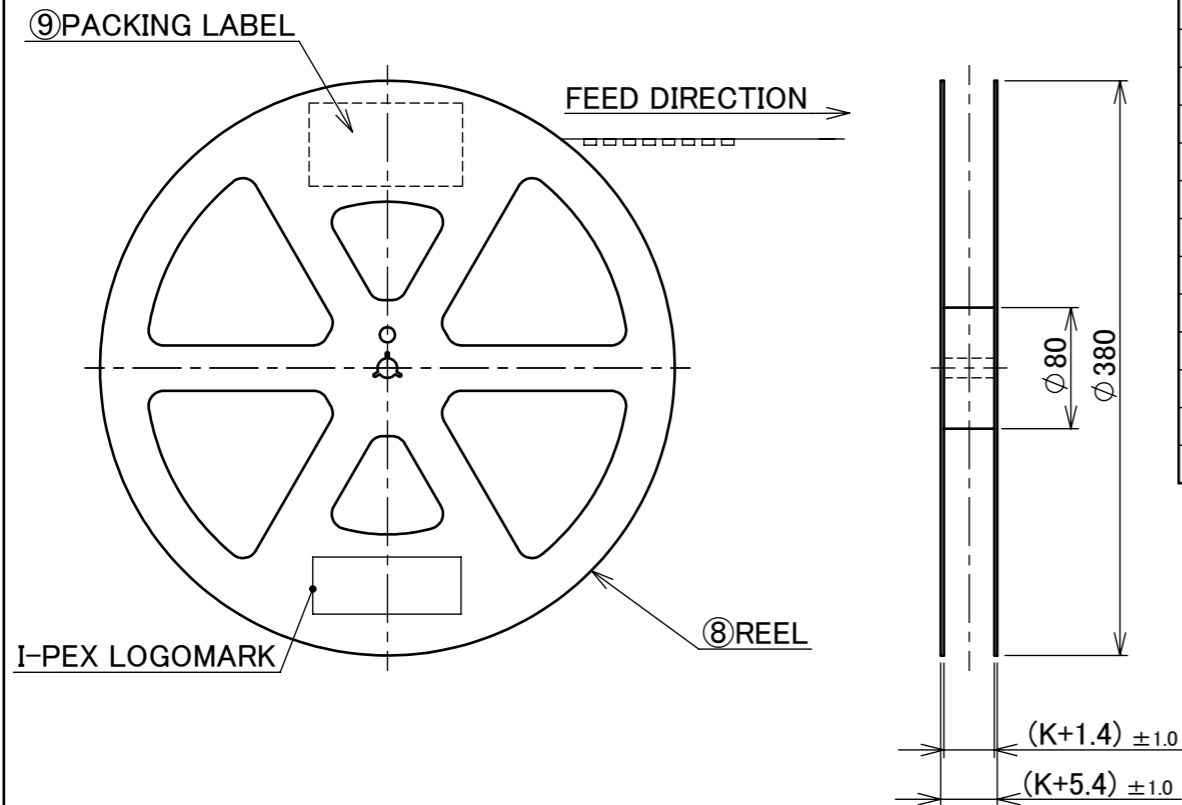

NO.	DISCRIPTION	MATERIAL	FINISH , REMARKS
9	PACKING LABEL	-	-
8	REEL	PS	BLACK
7	TOP TAPE	PET t=0.062 TRANSPARENCY	ANTI-STATIC TYPE HEAT WELDING TYPE
6	EMBOSS TAPE	PS t=0.3 TRANSPARENCY	ANTI-STATIC TYPE

ANGLE	±2°	6 OVER 30 MAX.	±0.3	PROJECTION ⊕	SERIES No. R2	CUSTOMER COPY
6 MAX.	±0.2	30 OVER 120 MAX.	±0.5			
GENERAL TOLERANCE.				TITLE MINIFLEX® 5-BFN II LK03	SCALE 1:X	UNIT mm
DWG.	DATE					
CHK.						
APP.						
DWG. No. 20600				SIZE A3	SHEET 5/5	REV. 9