

PART NO.
30001-**-0T-**-F

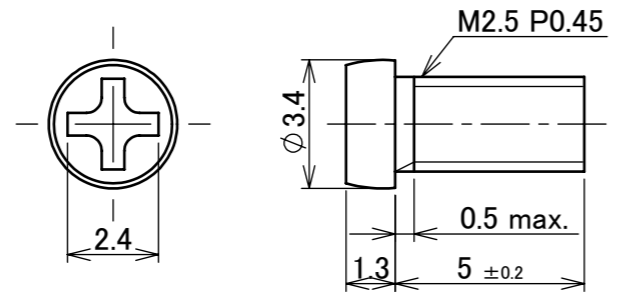

RoHS Compliant

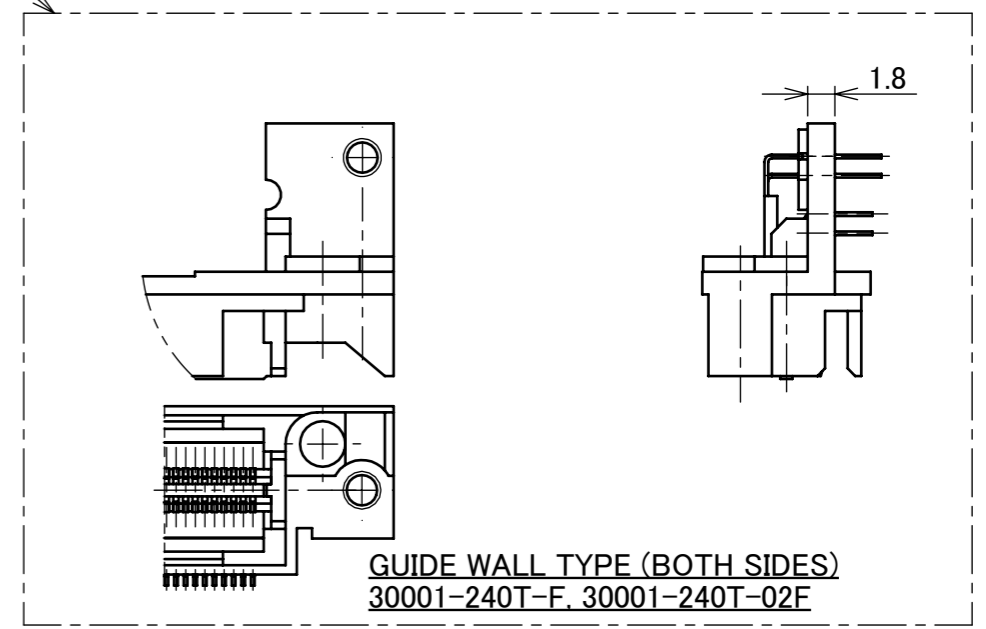
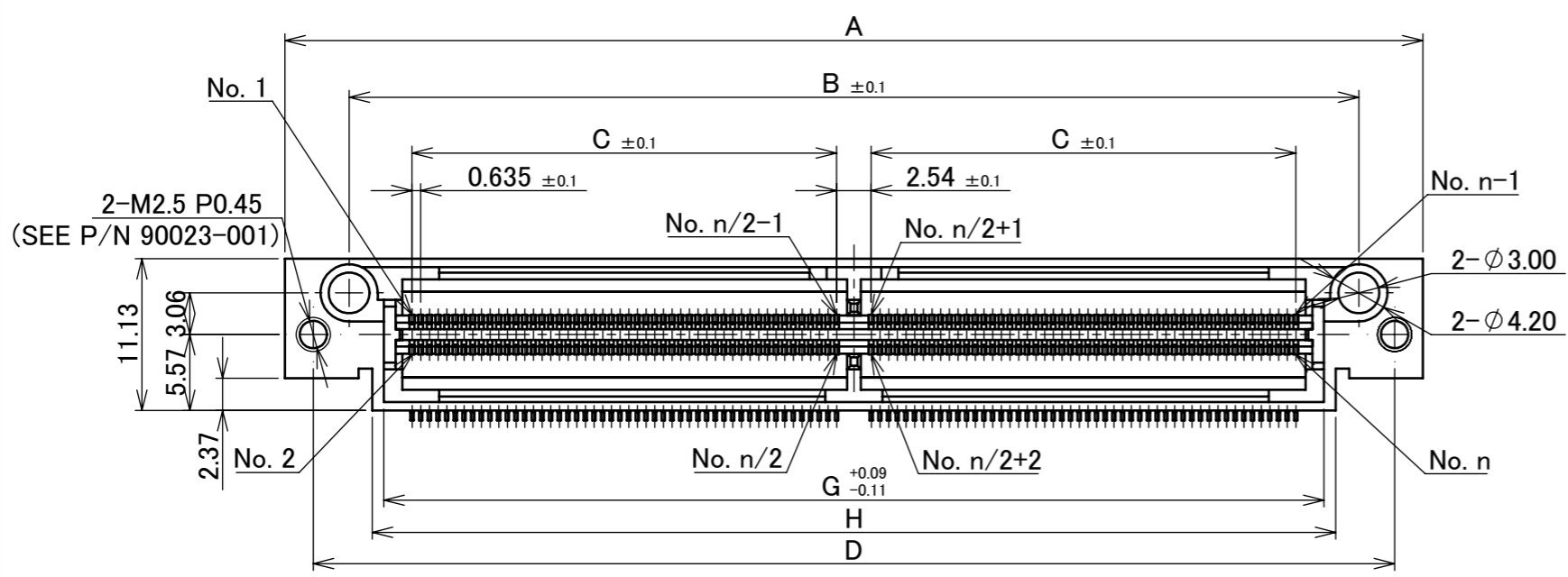
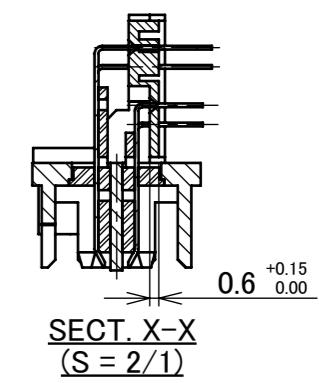
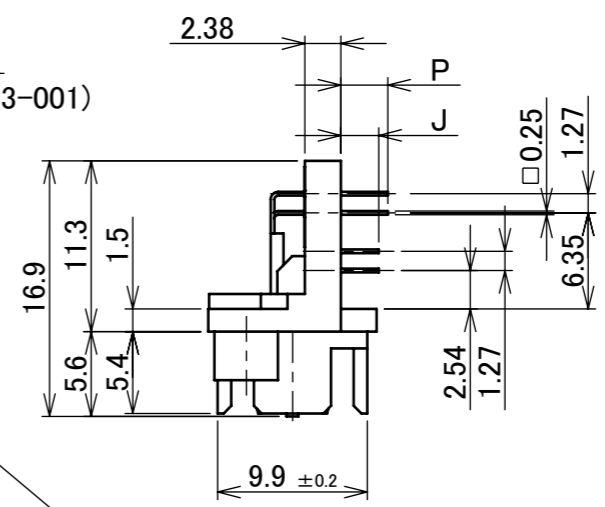
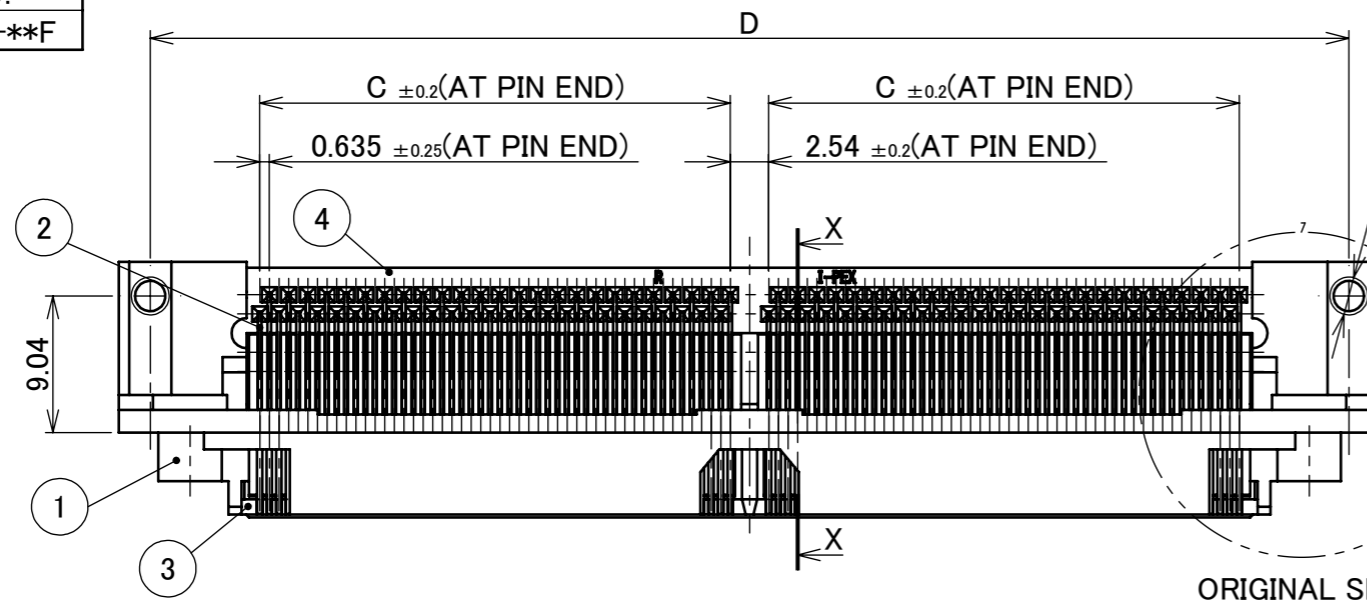

4	LOCATOR PLATE	PA	BLACK UL94V-0
3	PLUG INSULATOR	PPS	BLACK UL94V-0
2	PLUG CONTACT	COPPER ALLOY	ALL OVER Ni 1.27 μm MIN. CONTACT PART Au 0.05 μm MIN.
1	PLUG SHELL	Zn ALLOY	Ni PLATING
NO.	DISCRIPTION	MATERIAL	FINISH , REMARKS
34	Z230123 M.H Feb./22/'23 Y.H	ANGLE ±2° 6 OVER 30 MAX. ±0.3	PROJECTION SERIES No. R11 CUSTOMER COPY
33	Z220241 M.H Mar./18/'22 Y.H	6 MAX. ±0.2 30 OVER 120 MAX. ±0.5	
32	Z191328 IMI Oct./01/'19 Y.S	GENERAL TOLERANCE.	
31	Z190602 IMI May/06/'19 TAK	DWG. DATE E.Kawabe 1994/06/27	
30	Z180831 R.H June/27/'18 TAK	CHK. -	
29	Z170967 R.H Aug./23/'17 M.T	APP. Y.Fukuda	TITLE MINIDOCK CONNECTOR RIGHT ANGLE PLUG
REV.	ECN BY DATE APP.	DWG. No. 30001	SCALE 2:1 UNIT mm SIZE A3 SHEET 1/7 REV. 34
REVISION RECORD			

30001-**-0T-**-F
 NONE: WITHOUT SCREW
 01, 02: WITH SCREW
 03: WITH DUST COVER/WITHOUT SCREW
 EXAMPLE
 POS.10 : 100P
 24 : 240P
 NOTES
 1. CONNECTOR TO BE MATED: 30002, 30006, 30007, 30009

PART No.
30001-120T-03F

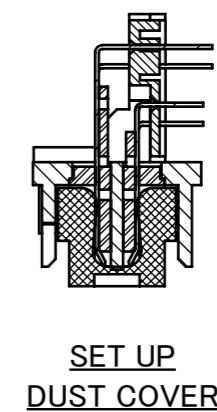
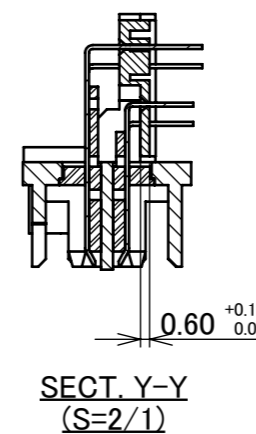
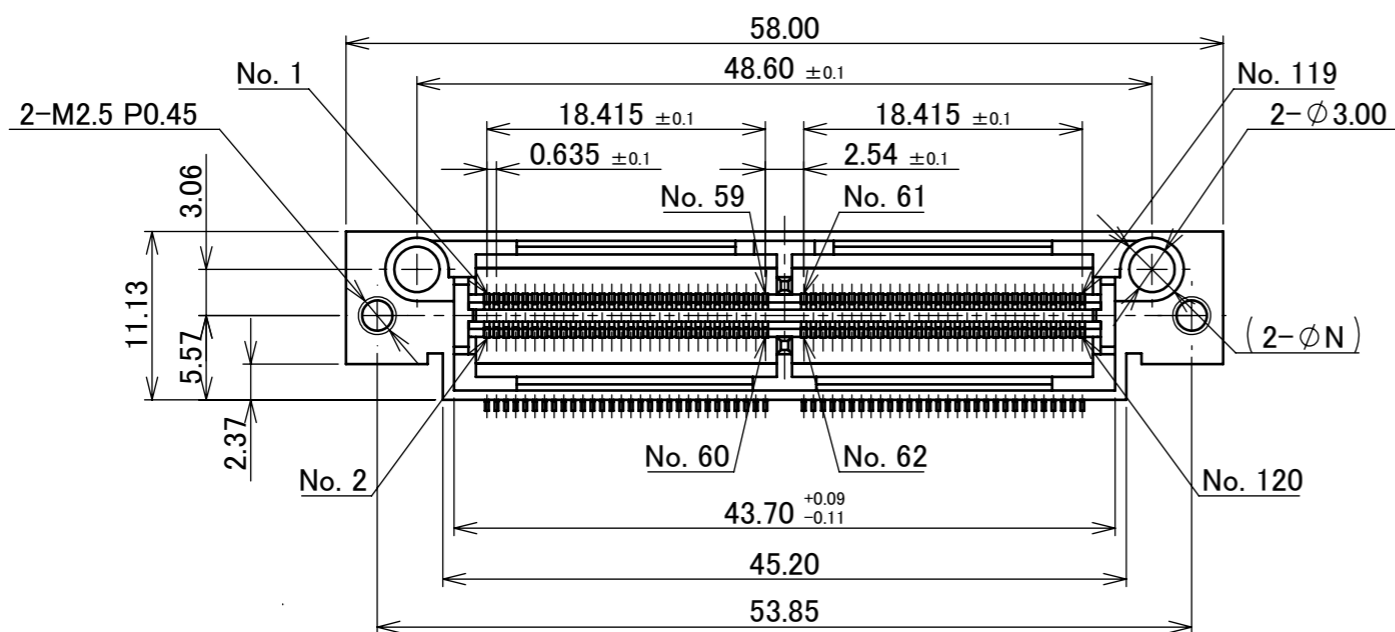
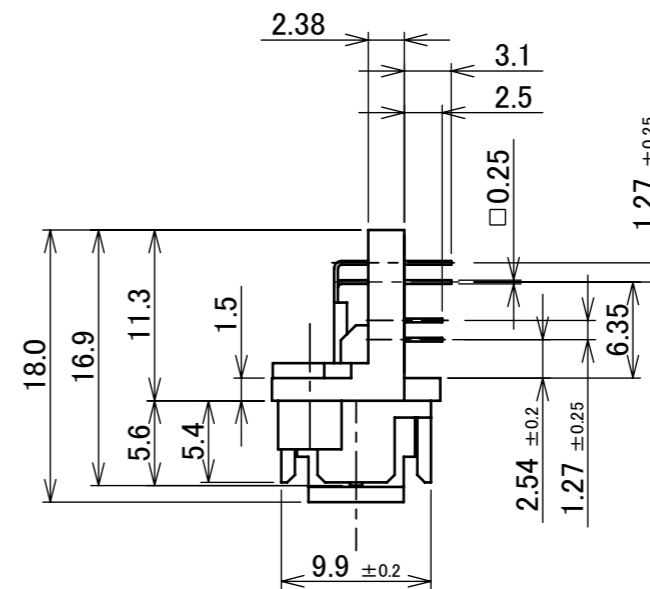
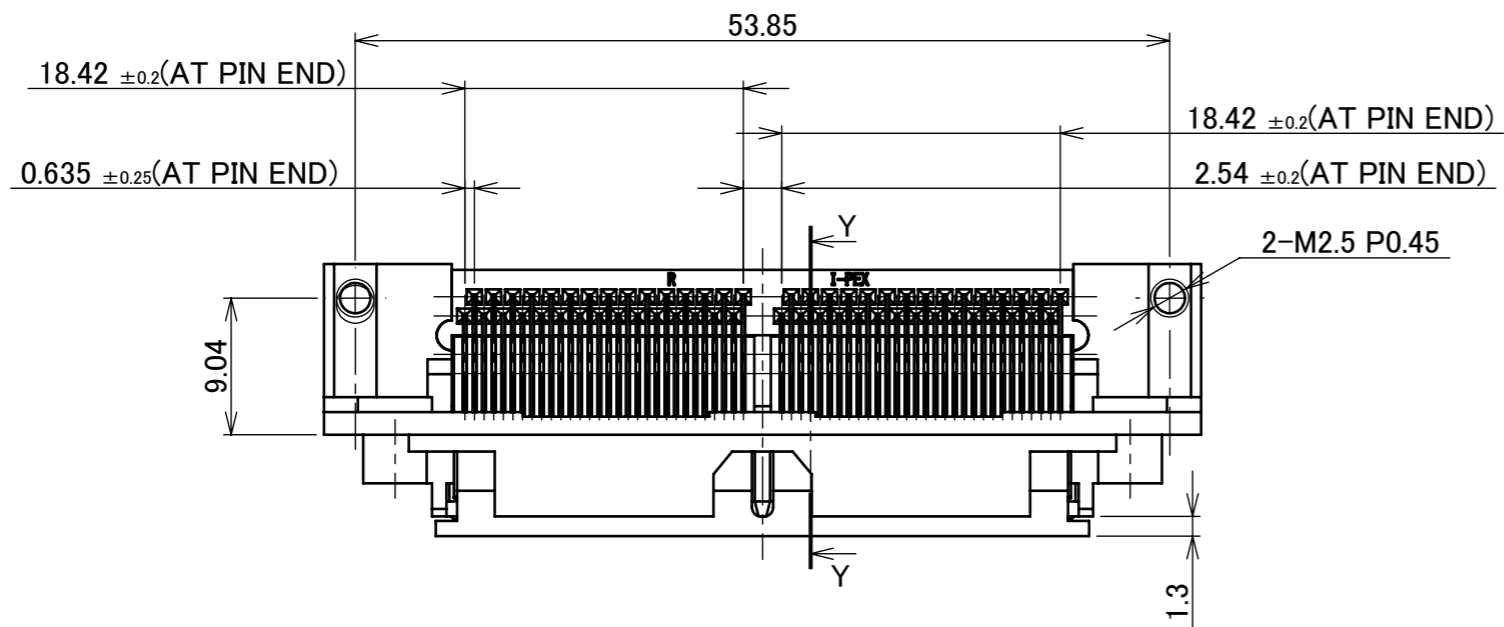

ANGLE	±2°	6 OVER 30 MAX.	±0.3	PROJECTION	SERIES No.	CUSTOMER COPY		
				⊕	R11			
6 MAX.	±0.2	30 OVER 120 MAX.	±0.5	TITLE		SCALE	I-PEX	
GENERAL TOLERANCE.				MINIDOCK		2:1		
DWG.	DATE			CONNECTOR		UNIT		
CHK.				RIGHT ANGLE PLUG		mm		
APP.				DWG. No.	30001	SIZE	SHEET	REV.
						A3	2/7	34

ITEMS	SPECIFICATION
RATING VOLTAGE	250V AC (PER CONTACT PIN)
RATING AMPERAGE (FOR CONTACT)	0.5A AC/DC (PER CONTACT PIN)
OPERATING TEMPERATURE	208~358K(-65°C~+85°C)
OPERATING HUMIDITY	85% MAX.(NON-CONDENSING)
CONTACT RESISTANCE (FOR CONTACT)	INITIAL : 70mohm MAX. / AFTER TEST : \triangle 25mohm MAX.
INSULATION RESISTANCE	INITIAL : 10,000Mohm MIN. / AFTER TEST : 1,000Mohm MIN.
DIELECTRIC WITHSTANDING VOLTAGE	AC500V 1min
DURABILITY	5,000 CYCLES
MATING FORCE (INITIAL)	0.9N/pos. MAX.
UNMATING FORCE (AFTER TEST)	0.059N/pos. MIN.
COPLANARITY	-
PRODUCT SPECIFICATION	PRS-1011
TEST REPORT	TR-9020
PACKING STANDARD	300-014
INSTRUCTION MANUAL	-
APPEARANCE CRITERIA No.	QLS-A***

ANGLE	$\pm 2^\circ$	6 OVER 30 MAX.	± 0.3	PROJECTION 	SERIES No. R11	CUSTOMER COPY		
6 MAX.	± 0.2	30 OVER 120 MAX.	± 0.5					
GENERAL TOLERANCE.				TITLE MINIDOCK CONNECTOR RIGHT ANGLE PLUG	SCALE	I-PEX		
DWG.	DATE							
CHK.								
APP.								
				DWG. No.	30001	SIZE	SHEET	REV.
						A3	3/7	34

PART No.	POS.	A	B	C	D	G	H	P	J	K	L	SCREW	DUST COVER	NOTE
30001-100T-F	100P	51.65	42.25	15.24	47.50	37.35	38.85	2.5	2.1	47.52	37.55	WITHOUT SCREW	WITHOUT DUST COVER	-
30001-120T-F	120P	58.00	48.60	18.415	53.85	43.70	45.20	3.1	2.5	53.85	43.90			GUIDE WALL TYPE
30001-240T-F	240P	96.10	86.70	37.465	91.95	81.80	83.30			2.5	2.1	47.52		37.55
30001-100T-01F	100P	51.65	42.25	15.24	47.50	37.35	38.85	3.1	2.5	53.85	43.90	GUIDE WALL TYPE		
30001-120T-01F	120P	58.00	48.60	18.415	53.85	43.70	45.20			2.5	2.1	47.52	37.55	-
30001-240T-02F	240P	96.10	86.70	37.465	91.95	81.80	83.30	3.1	2.5	91.95	82.00	WITHOUT SCREW	WITH DUST COVER	-
30001-120T-03F	120P	58.00	48.60	18.415	53.85	43.70	45.20			2.5	2.1	47.52		37.55

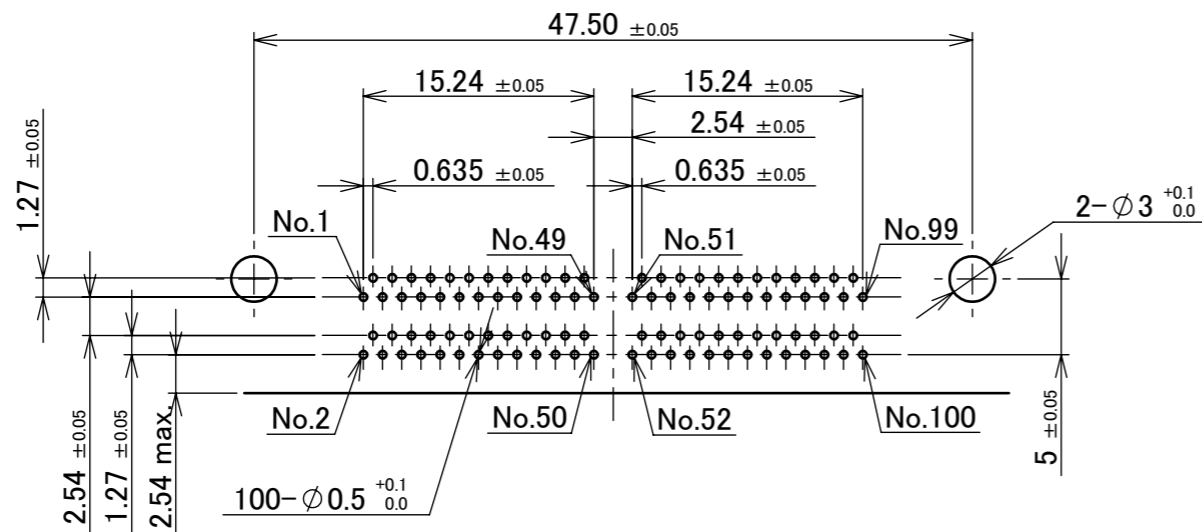

RECOMMENDED FOOTPRINT PATTERN $t=1.6 \pm 0.1$ (100P ONLY)

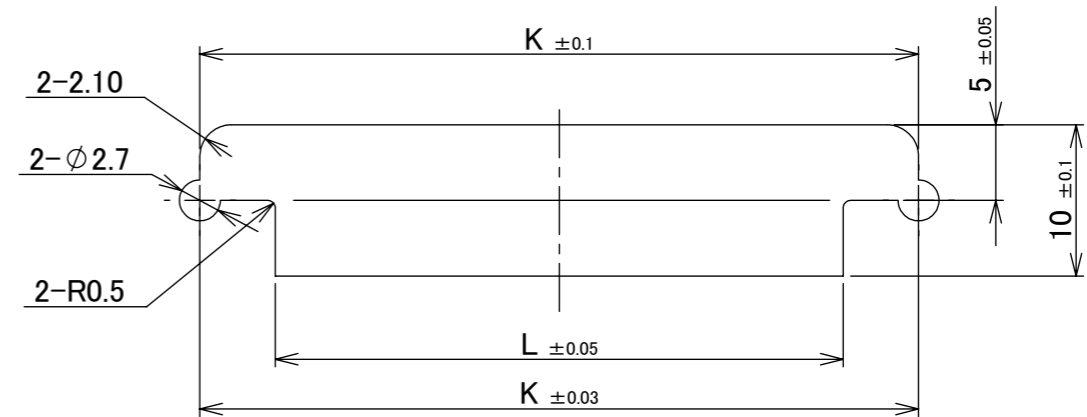

RECOMMENDED OPENING FOR MOUNTING BRACKET

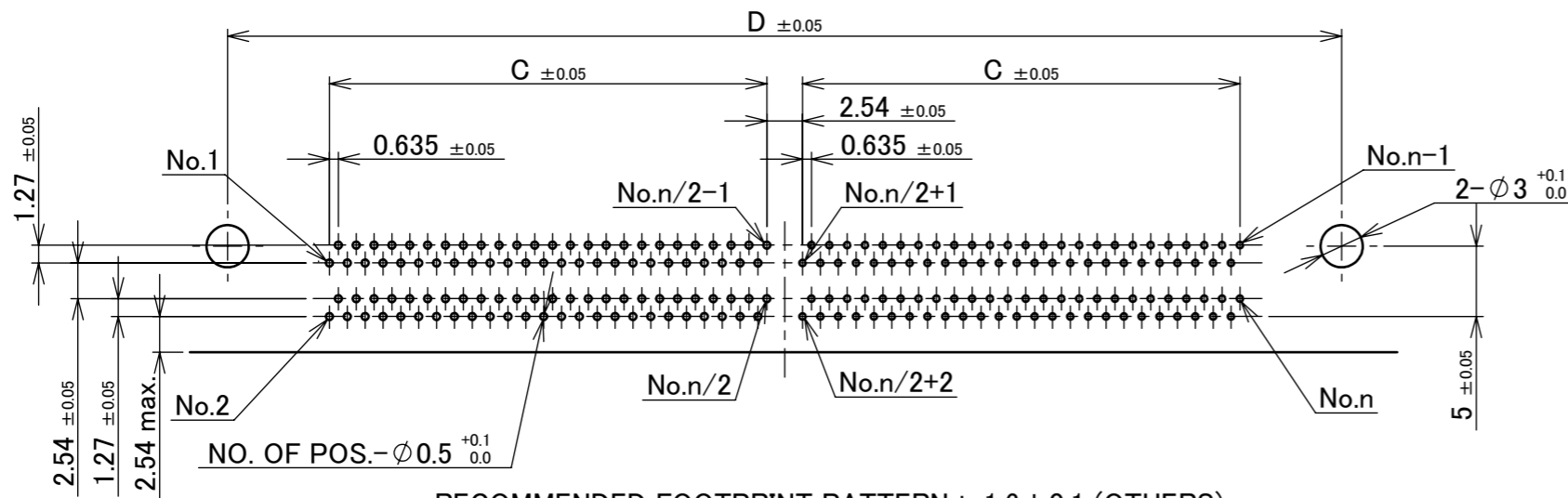

RECOMMENDED FOOTPRINT PATTERN $t=1.6 \pm 0.1$ (OTHERS)

ANGLE	$\pm 2^\circ$	6 OVER 30 MAX.	± 0.3	PROJECTION	SERIES No.	CUSTOMER COPY	
6 MAX.	± 0.2	30 OVER 120 MAX.	± 0.5		R11	I-PEX	
GENERAL TOLERANCE.				TITLE	SCALE	REV.	
DWG.	DATE			MINIDOCK CONNECTOR RIGHT ANGLE PLUG	2:1	34	
CHK.					UNIT	4/7	
APP.					mm	34	
				DWG. No.	SIZE	SHEET	REV.
				30001	A3	4/7	34

PART NO.	Pos.	QTY./ TRAY	QTY./ SHIPPING CARTON	QTY./ PACKING CARTON
30001-240T-F	240P	21	21 × 4 = 84	84 × 4 = 336
30001-240T-02F				

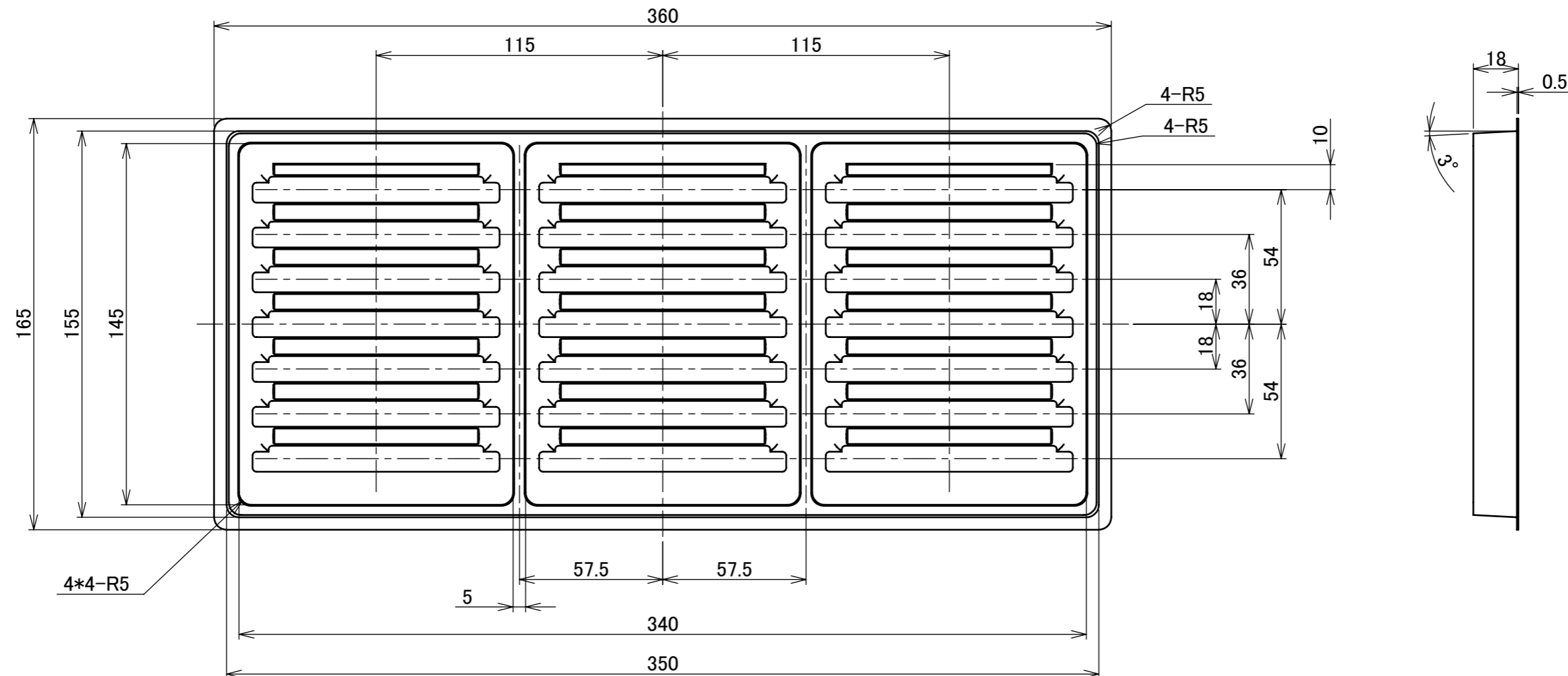

NO.	DISCRIPTION	MATERIAL	FINISH , REMARKS
6	TRAY	PVC	-
ANGLE	±2° 6 OVER 30 MAX.	±0.3	PROJECTION SERIES No. R11 CUSTOMER COPY
6 MAX.	±0.2 30 OVER 120 MAX.	±0.5	
GENERAL TOLERANCE.		TITLE	SCALE
DWG.	DATE	MINIDOCK CONNECTOR RIGHT ANGLE PLUG	1:X
CHK.			UNIT mm
APP.		DWG. No. 30001	SIZE SHEET A3 5/7
			REV. 34

PART NO.	Pos.	QTY./ TRAY	QTY./ SHIPPING CARTON	QTY./PACKING CARTON
30001-120T-F	120P	28	28 × 4 = 112	112 × 4 = 448
30001-120T-0*F				

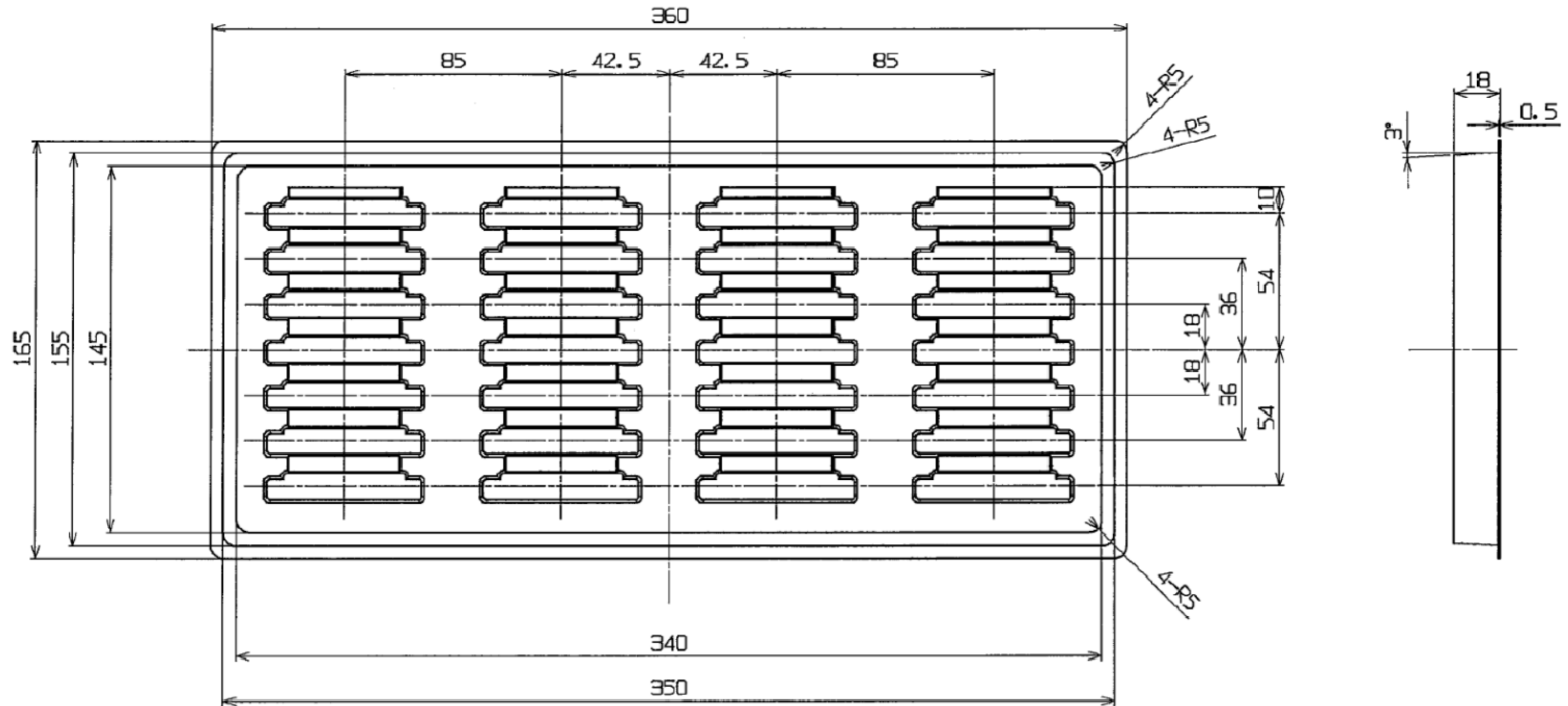

5	TRAY	PVC	-
NO.	DISCRIPTION	MATERIAL	FINISH , REMARKS
ANGLE	±2° 6 OVER 30 MAX.	±0.3	PROJECTION SERIES No. R11 CUSTOMER COPY
6 MAX.	±0.2 30 OVER 120 MAX.	±0.5	
GENERAL TOLERANCE.		TITLE	
DWG.	DATE	MINIDOCK CONNECTOR RIGHT ANGLE PLUG	
CHK.		SCALE 1:X UNIT mm	
APP.		DWG. No. 30001	SIZE SHEET REV. A3 6/7 34

PART NO.	Pos.	QTY./ TRAY	QTY./ SHIPPING CARTON	QTY./ PACKING CARTON
30001-100T-F	100P	35	35 × 4 = 140	140 × 4 = 560
30001-100T-01F				

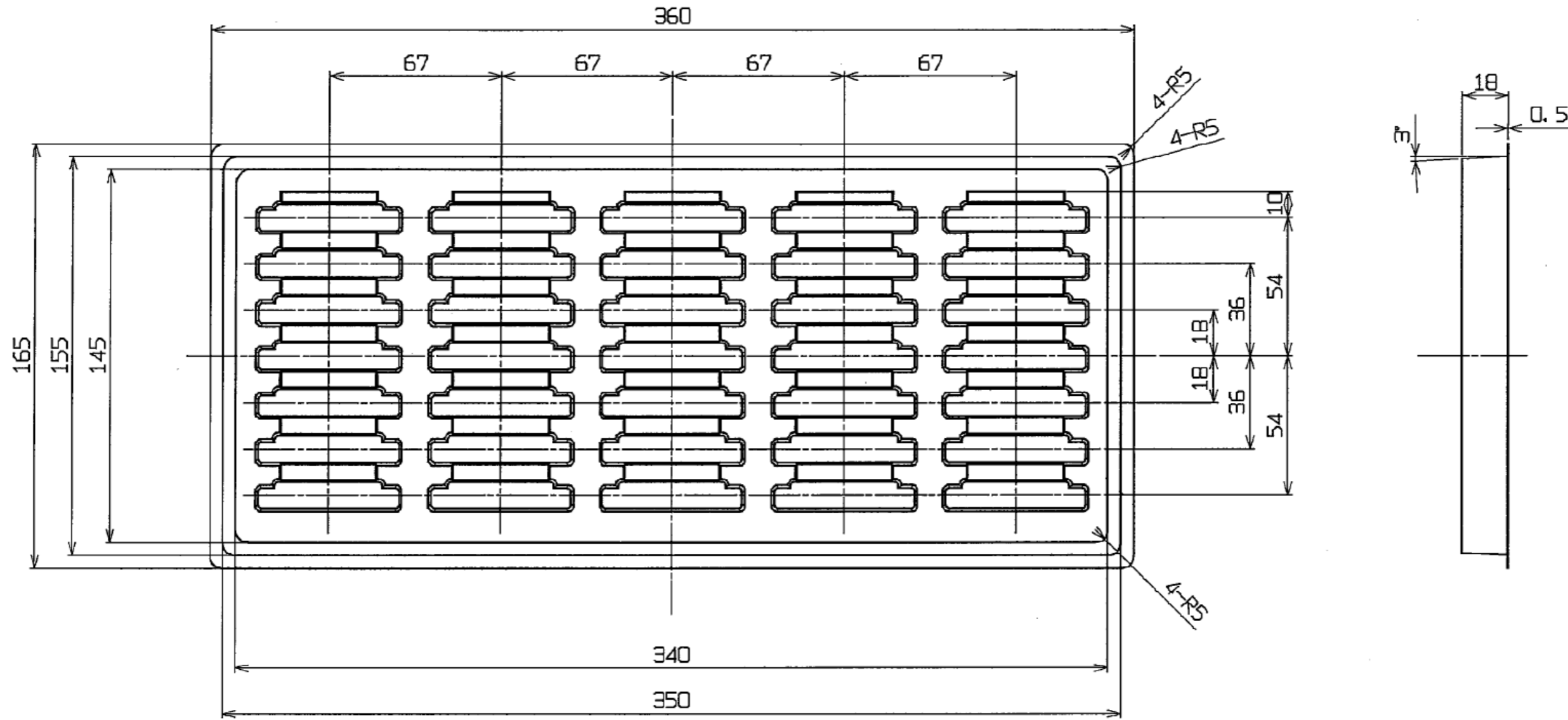

7	TRAY	PVC	-
NO.	DISCRIPTION	MATERIAL	FINISH , REMARKS
ANGLE	±2° 6 OVER 30 MAX.	±0.3	PROJECTION ⊕ ▽ SERIES No. R11 CUSTOMER COPY
6 MAX.	±0.2 30 OVER 120 MAX.	±0.5	
GENERAL TOLERANCE.		TITLE	
DWG.	DATE	MINIDOCK CONNECTOR RIGHT ANGLE PLUG	
CHK.		SCALE 1:X UNIT mm	
APP.		DWG. No. 30001	SIZE SHEET REV. A3 7/7 34