

PART No.
20441-001E-01

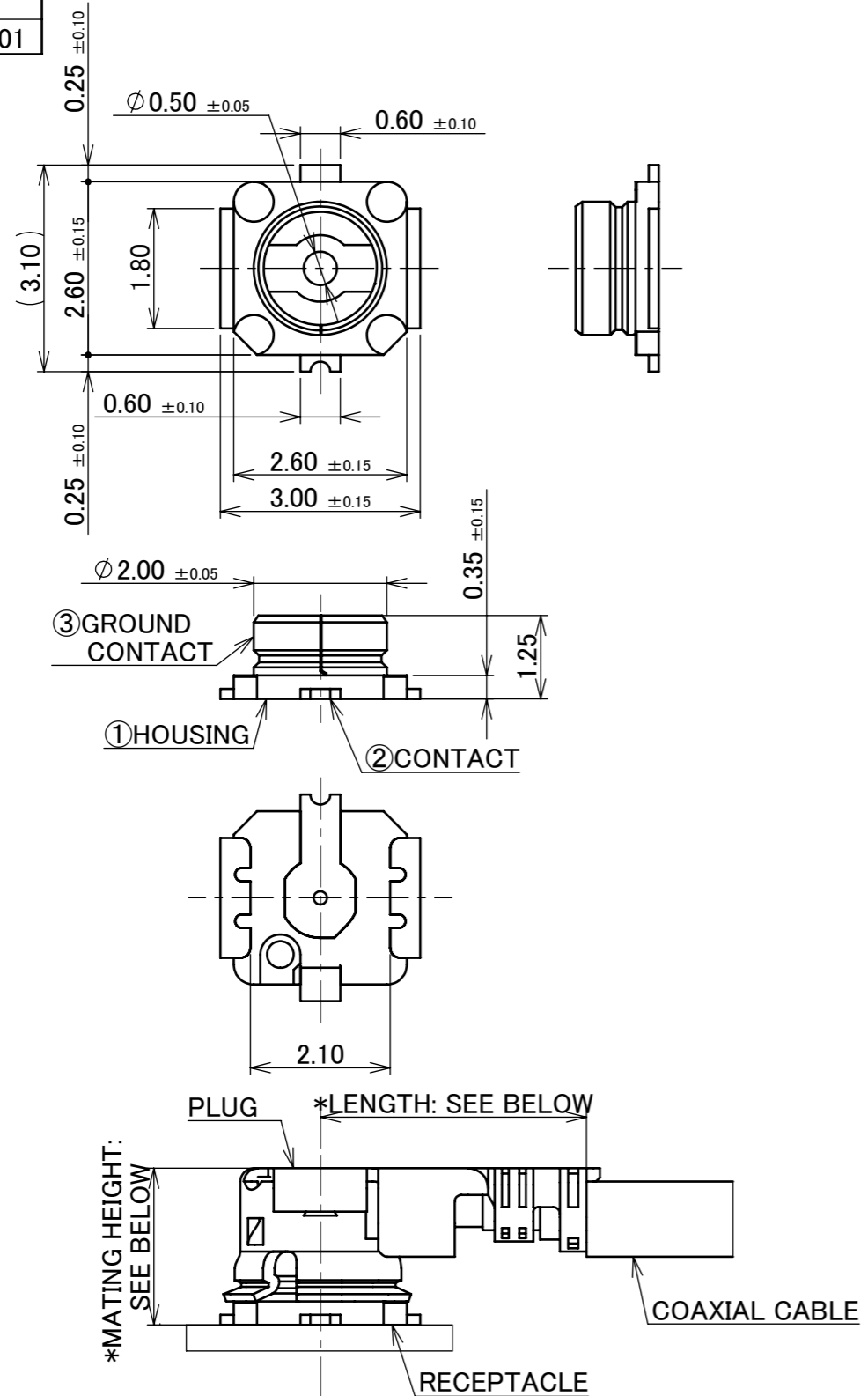

- NOTES.
- APPLICABLE CONNECTOR PART NUMBER:
 MHF I PLUG
 20278-112R-**
 20351-1**R-37
 20670-001R-**
 20767-001R-20
 MHF II PLUG
 20311-011R-**
 20686-001R-08
 - COPLANARITY: 0.1mm MAX.
 - THIS IS "Pb-FREE" CONNECTOR.

3	GROUND CONTACT	PHOSPHOR BRONZE	ALL OVER Ni 1.00 μm MIN. CONTACT PART Au 0.03 μm MIN. SOLDERING PART Au 0.03 μm MIN.
2	CONTACT	BRASS	ALL OVER Ni 1.00 μm MIN. CONTACT PART Au 0.10 μm MIN. SOLDERING PART Au 0.03 μm MIN.
1	HOUSING	LCP	UL94V-0, BLACK
NO.	DISCRIPTION	MATERIAL	FINISH , REMARKS

*LENGTH: 4.0±0.4 AT PLUG PART NO. 20670-001R-08, 20670-001R-13, 20670-001R-32
 4.7±0.4 AT PLUG PART NO. 20670-001R-18, 20670-001R-37
 5.6 AT PLUG PART NO. 20767-001R-20 (REFERENCE DIMENSION)
 3.8±0.3 AT PLUG PART NO. 20686-001R-08, 20311-011R-**
 *MATING HEIGHT: 2.5 MAX. AT PLUG PART NO. 20670-001R-**
 (2.9 MAX. AT MHF I LK LOCKED CONDITION)
 3.0 MAX. AT PLUG PART NO. 20767-001R-20
 2.0±0.1 AT PLUG PART NO. 20686-001R-08, 20311-011R-**

7	Z231442	K.T	2023/12/04	Y.H	ANGLE	±2°	6 OVER 30 MAX.	±0.3	PROJECTION ⊕	SERIES No. R4	CUSTOMER COPY
6	Z231116	Y.I	2023/09/15	Y.H	6 MAX.	±0.2	30 OVER 120 MAX.	±0.5			
5	Z200262	TOI	2020/03/05	Y.H	GENERAL TOLERANCE.				TITLE MHF® I/II RECEPTACLE (4 PADS TYPE)	SCALE	I-PEX
4	Z181513	M.N	2018/12/10	Ken	DWG.	DATE		2007/07/10		10:1	
3	Z150615	Tad	2015/06/04	Tom	K.Oobayashi		CHK.			UNIT	
2	Z12194	H.M	2012/03/15	E.K	APP.			2007/07/18		mm	
REV.	ECN	BY	DATE	APP.	APP.	DWG. No.			20441	SIZE	SHEET
REVISION RECORD						E.Kawabe	2007/07/18		A3	1/6	7

ITEMS	SPECIFICATION				
RECOMMENDED APPLICABLE CONNECTOR PART NO.	20278-001R-** (MHF I PLUG 1.80, 1.32, 1.13, 0.81)	20351-001R-** (MHF I PLUG 1.37)	20670-001R-** (MHF I PLUG Ni TOP 1.80, 1.37, 1.32, 1.13, 0.81)	20767-001R-20 (MHF I PLUG 2.00)	20686-001R-08 (MHF II PLUG Ni TOP 0.81)
RATING VOLTAGE	60 V AC (R.M.S)				
RATING FREQUENCY	DC~9GHz				
OPERATING TEMPERATURE	233~363K (-40°C~+90°C)				
VSWR (MATED WITH SMA ADAPTER PART No.90193-002)	RECEPTACLE: 1.30 MAX. AT 0.1~3 GHz, 1.40 MAX. AT 3~6 GHz, 1.80 MAX. AT 6~9 GHz				
MAIN CONTACT RESISTANCE	INITIAL : 20 mohm MAX. AFTER TEST : 25 mohm MAX.		INITIAL : 20 mohm MAX. AFTER TEST : Δ R 20 mohm MAX.		
GROUND CONTACT RESISTANCE	INITIAL : 10 mohm MAX. AFTER TEST : 15 mohm MAX.		INITIAL : 20 mohm MAX. AFTER TEST : Δ R 100 mohm MAX.		
INSULATION RESISTANCE	INITIAL: 500 Mohm MIN. / AFTER TEST: 100 Mohm MIN.				
DIELECTRIC WITHSTANDING VOLTAGE	200 V AC, 1 MINUTE				
DURABILITY	30 CYCLES				
UNMATING FORCE (INITIAL / AFTER TEST)	INITIAL: 5 N MIN. AFTER TEST: 3 N MIN.			INITIAL: 4 N MIN. AFTER TEST: 2 N MIN.	
PRODUCT SPECIFICATION	PRS-1676	PRS-1726	PRS-2105	PRS-2490	PRS-2106
TEST REPORT	TR-12044	TR-12096	TR-15059	TR-18041	TR-15060
PACKING STANDARD	300-596				
INSTRUCTION MANUAL	HIM-10002		HIM-17017		HIM-12010
APPEARANCE CRITERIA No.	QLS-A***				

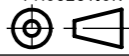
ANGLE	$\pm 2^\circ$	6 OVER 30 MAX.	± 0.3	PROJECTION 	SERIES No. R4	CUSTOMER COPY			
6 MAX.	± 0.2	30 OVER 120 MAX.	± 0.5						
GENERAL TOLERANCE.				TITLE MHF® I/II RECEPTACLE (4 PADS TYPE)	SCALE	I-PEX			
DWG.	DATE				-				
CHK.					UNIT				mm
APP.					SIZE				A3
				DWG. No.	20441				

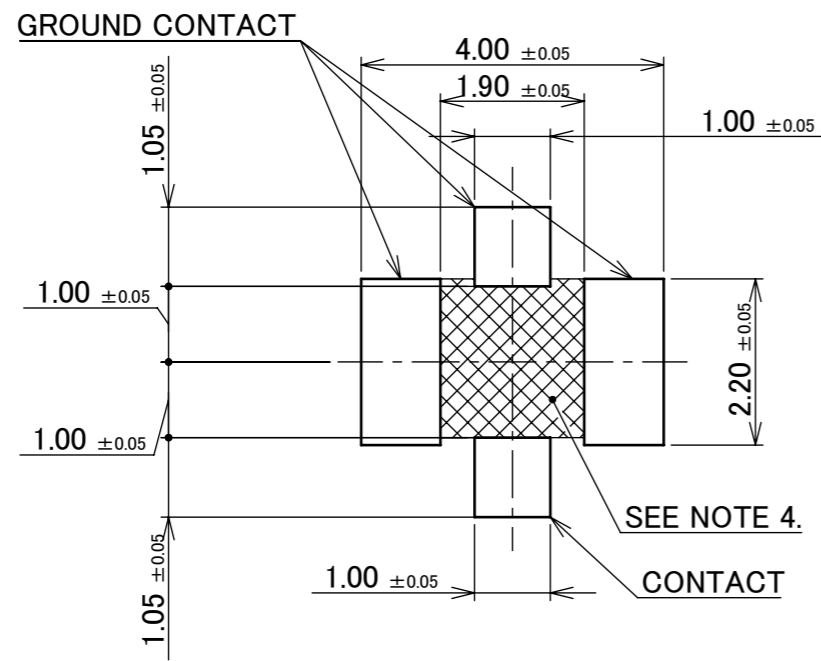

RECOMMENDED FOOTPRINT PATTERN

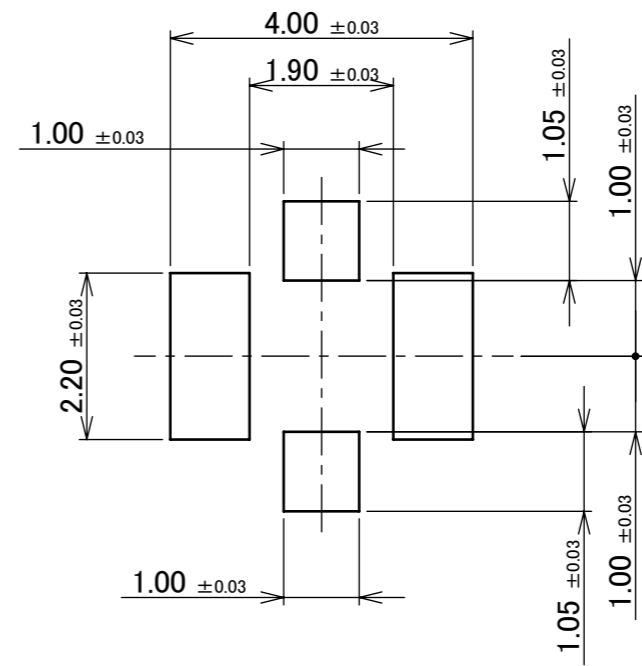

MASK THICKNESS: $t = 0.12$

METAL MASK

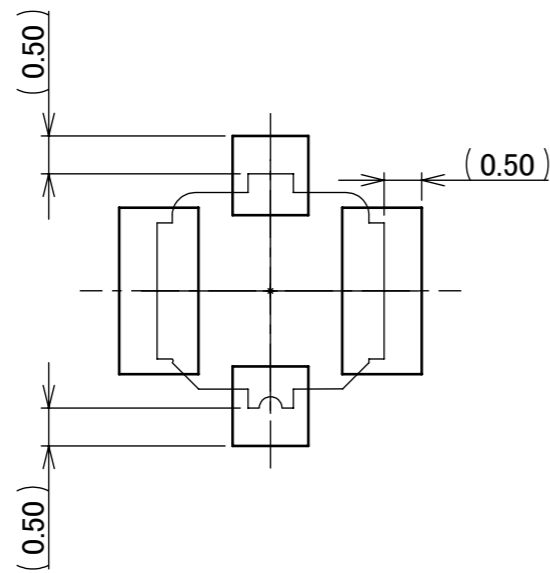

CONNECTOR ON RECOMMENDED FOOTPRINT PATTERN

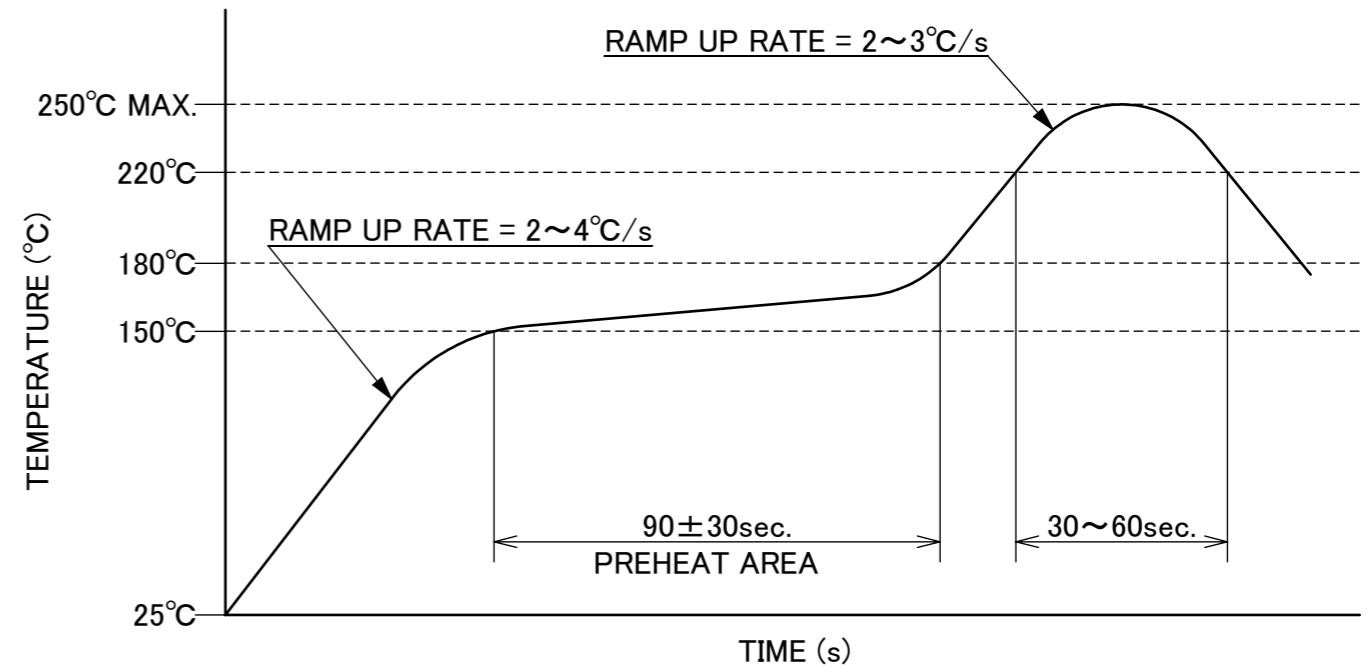

REFLOW TEMPERATURE PROFILE
SENJU METAL INDUSTRY CO., LTD. : M705-SHF(Sn96.5 Ag3.0 Cu0.5)

NOTE
4. NO GROUND, SIGNAL, RESIST IN THIS AREA.

ANGLE	$\pm 2^\circ$	6 OVER 30 MAX.	± 0.3	PROJECTION 	SERIES No. R4	CUSTOMER COPY			
	6 MAX.	± 0.2	30 OVER 120 MAX.						± 0.5
GENERAL TOLERANCE.				TITLE		SCALE	I-PEX		
DWG.	DATE			MHF® I/II RECEPTACLE (4 PADS TYPE)		10:1			
CHK.						UNIT			
APP.				DWG. No. 20441		mm			
						SIZE	SHEET	REV.	
						A3	3/6	7	

COMPONENT PLACEMENT PROHIBITED AREA FOR MHF I/II RECEPTACLE MATED WITH MHF I LK HARNESS REQUIRED AREA FOR RECOMMENDED JIG TO OPERATE

SINGLE CONNECTOR LAYOUT

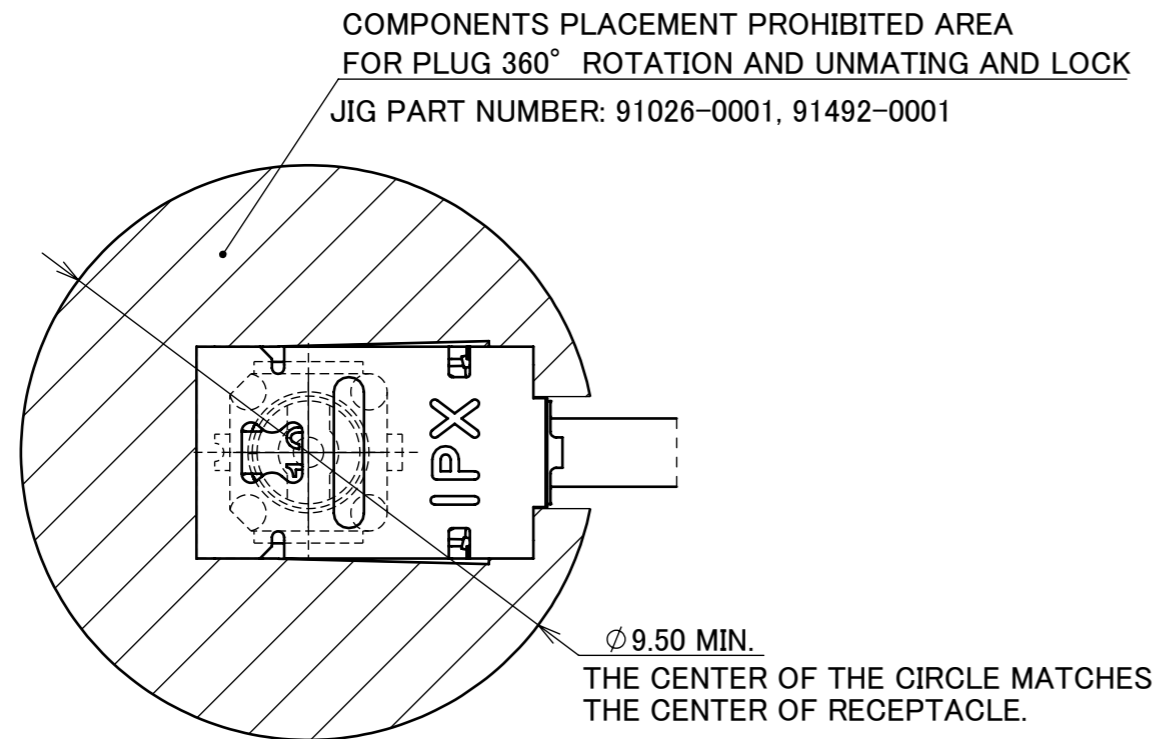

MATING AND LOCK CONDITION
WITH MHF I LK HARNESS

MULTIPLE CONNECTORS LAYOUT

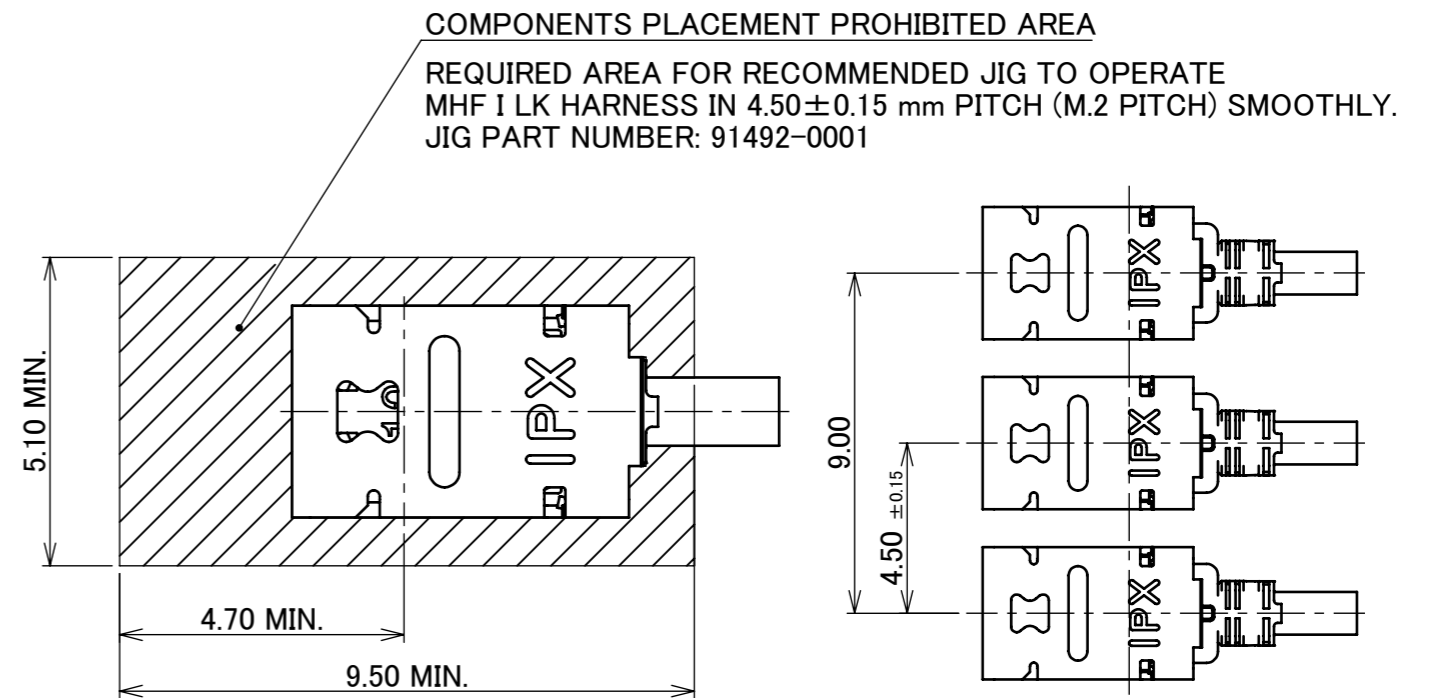

MATING AND LOCK CONDITION
WITH MHF I LK HARNESS NARROW PITCH

MHF I LK HARNESS UNLOCK CONDITION
NARROW PITCH DIMENSIONS
(S = 5 : 1)

ANGLE	±2°	6 OVER 30 MAX.	±0.3	PROJECTION ⊕	SERIES No. R4	CUSTOMER COPY		
6 MAX.	±0.2	30 OVER 120 MAX.	±0.5					
GENERAL TOLERANCE.				TITLE MHF® I/II RECEPTACLE (4 PADS TYPE)	SCALE 8:1	UNIT I-PEX		
DWG.	DATE							
CHK.								
APP.								
				DWG. No.	20441	SIZE A3	SHEET 4/6	REV. 7

PART NO.	QTY. PER EMBOSS REEL (PIECES / REEL)	QTY. PER PACKING CARTON (REELS / CARTON)
20441-001E-01	5,000 / REEL	8 REELS / CARTON = 40,000 PIECES

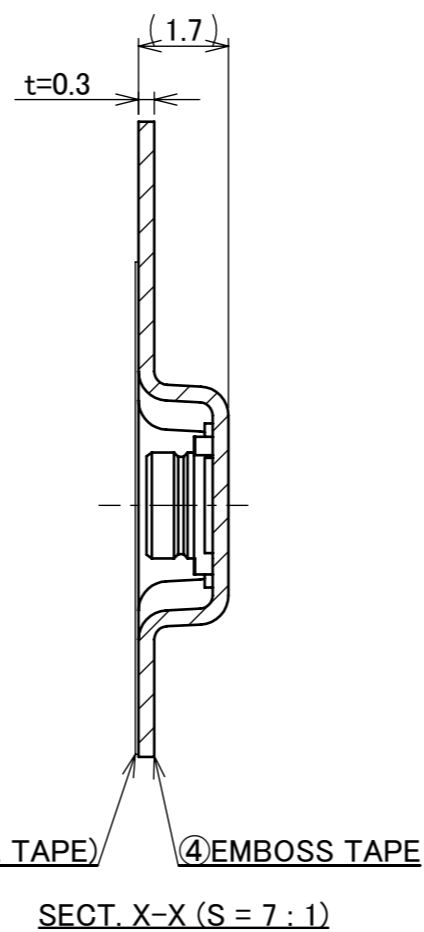
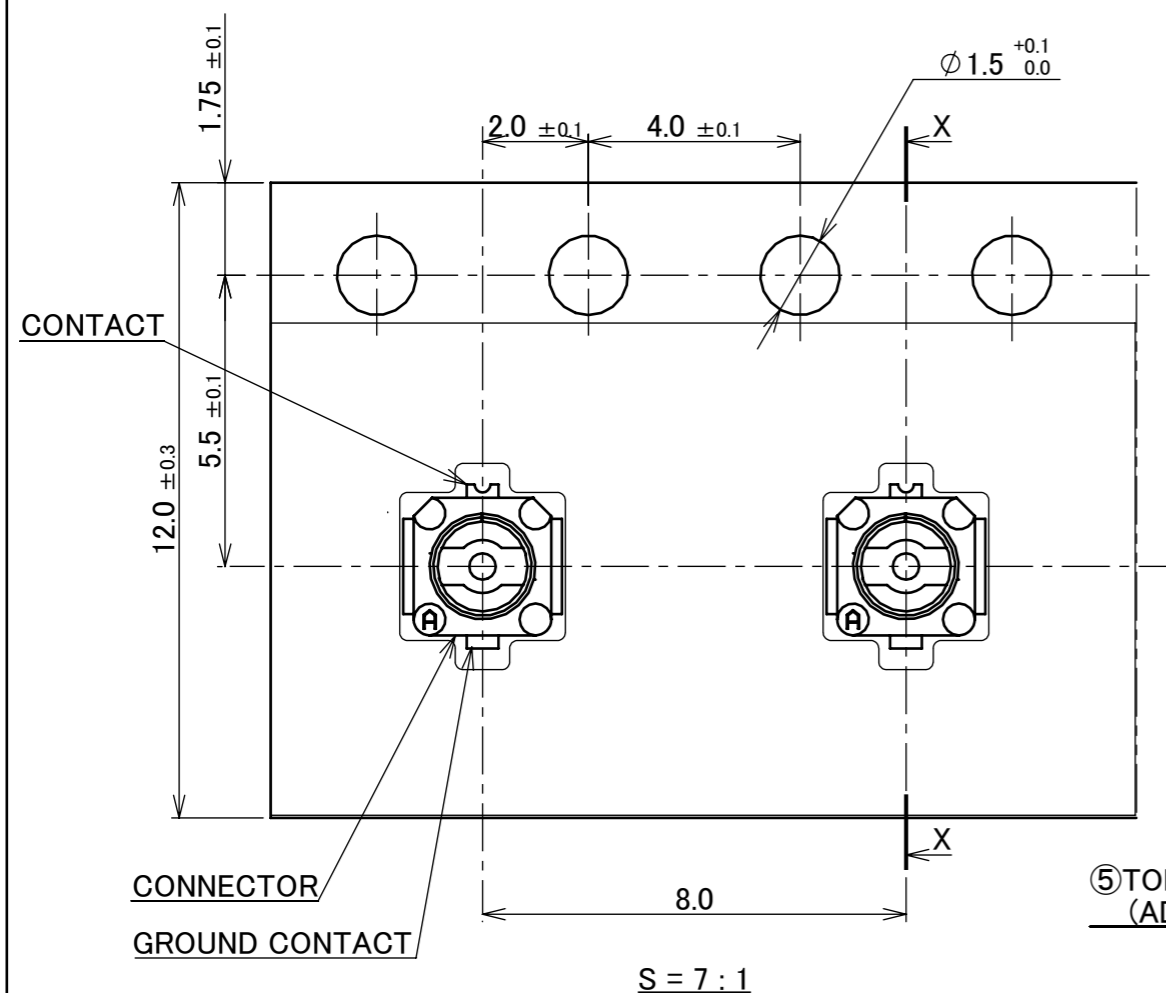
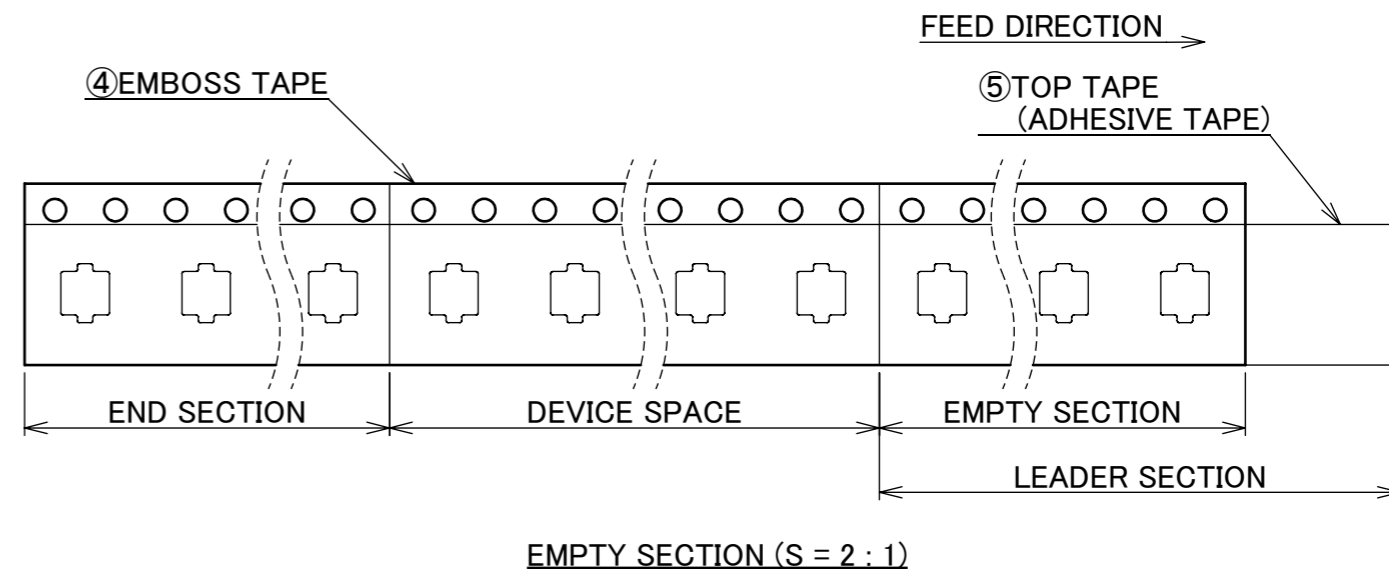
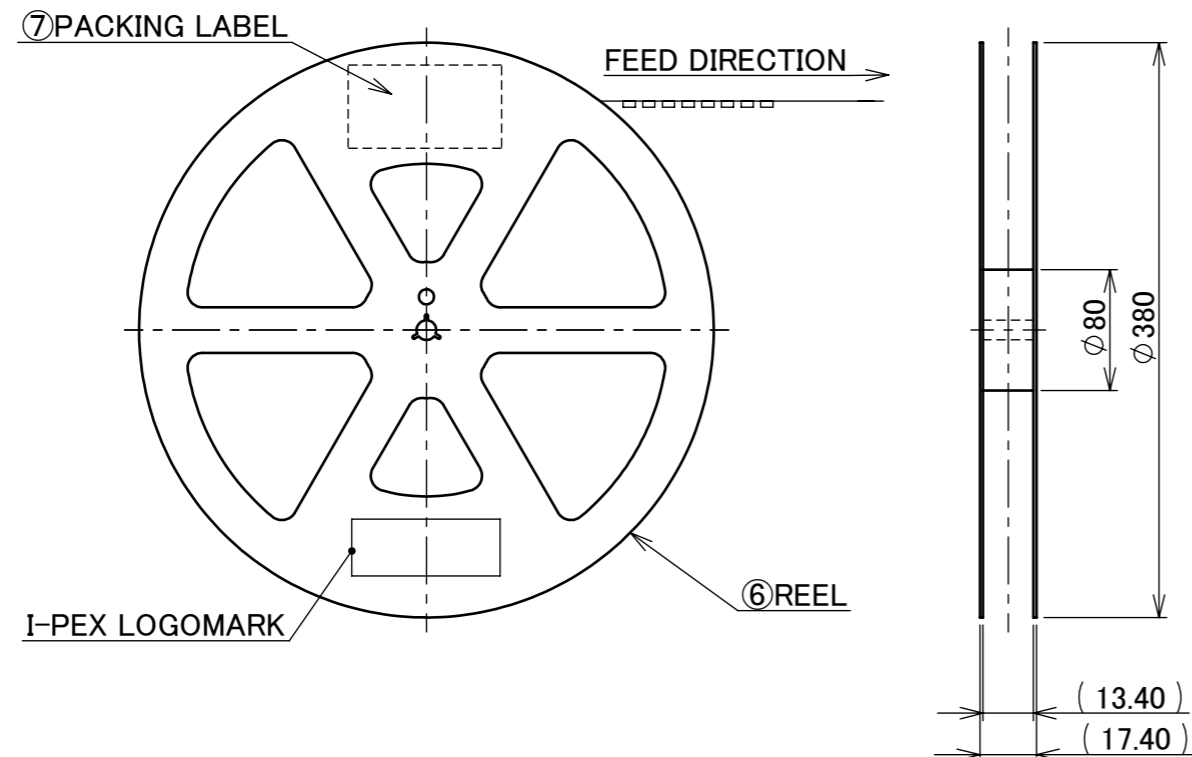

- NOTES.
- TAPING SPECIFICATION FOLLOWS JIS C 0806 (IEC 60286-3).
 - MAKE EMPTY SECTION OF LEADER AND END ON EACH END OF THE TAPE.
 - TOP TAPE SHALL NOT STICK OUT FROM EMBOSS TAPE.
 - TOP TAPE SHALL NOT COVER FEED HOLE.

NO.	DESCRIPTION	MATERIAL	FINISH , REMARKS
7	PACKING LABEL	-	-
6	REEL	PS	-
5	TOP TAPE	PET	-
4	EMBOSS TAPE	PS, t=0.3	-

ANGLE	±2°	6 OVER 30 MAX.	±0.3	PROJECTION ⊕	SERIES No. R4	CUSTOMER COPY
6 MAX.	±0.2	30 OVER 120 MAX.	±0.5			
GENERAL TOLERANCE.				TITLE	SCALE	I-PEX
DWG.	DATE			MHF® I/II RECEPTACLE (4 PADS TYPE)	1:X	
CHK.					UNIT mm	
APP.		DWG. No.	20441	SIZE	SHEET	REV.
				A3	5/6	7

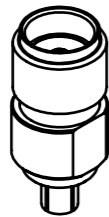

MHF I SMA ADAPTER
PART NO. 90193-002

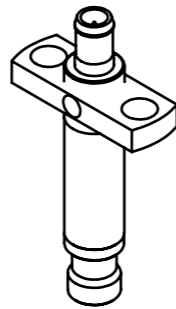

MHF I RECEPTACLE HIGH CYCLE N45 C ADAPTER
PART NO. 90575-0001

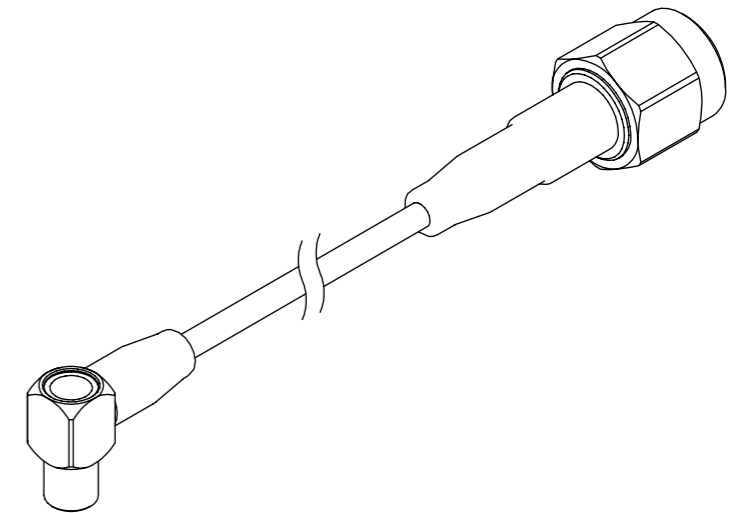

MHF SERIES N45 C TO SMA ADAPTER CABLE
PART NO. 90577-****

* 90575-0001 AND 90577-**** SHOULD BE USED TOGETHER.

ANGLE	±2°	6 OVER 30 MAX.	±0.3	PROJECTION ⊕	SERIES No. R4	CUSTOMER COPY			
6 MAX.	±0.2	30 OVER 120 MAX.	±0.5						
GENERAL TOLERANCE.				TITLE		SCALE	I-PEX		
DWG.	DATE			MHF® I/II RECEPTACLE (4 PADS TYPE)		2:1			
CHK.						UNIT			
APP.				DWG. No.		mm			
				20441		SIZE	SHEET	REV.	
						A3	6/6	7	