

Recommended P/N 20670-001R-**-**

PART NO.
20670-001R-08
20670-001R-13
20670-001R-32

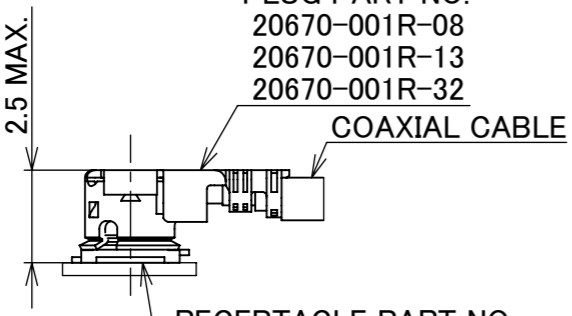
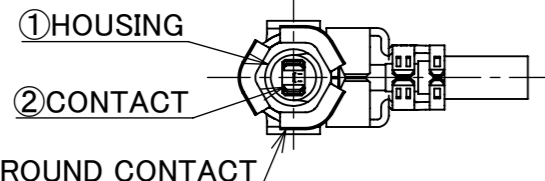
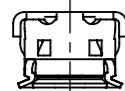
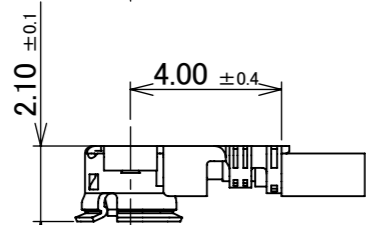
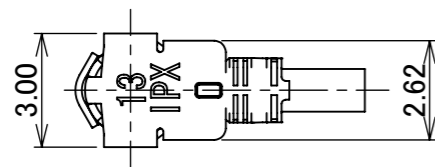

PLUG PART NO.
20670-001R-08
20670-001R-13
20670-001R-32

RECEPTACLE PART NO.
20279-001E-**-**
20431-001E-01
20441-001E-01

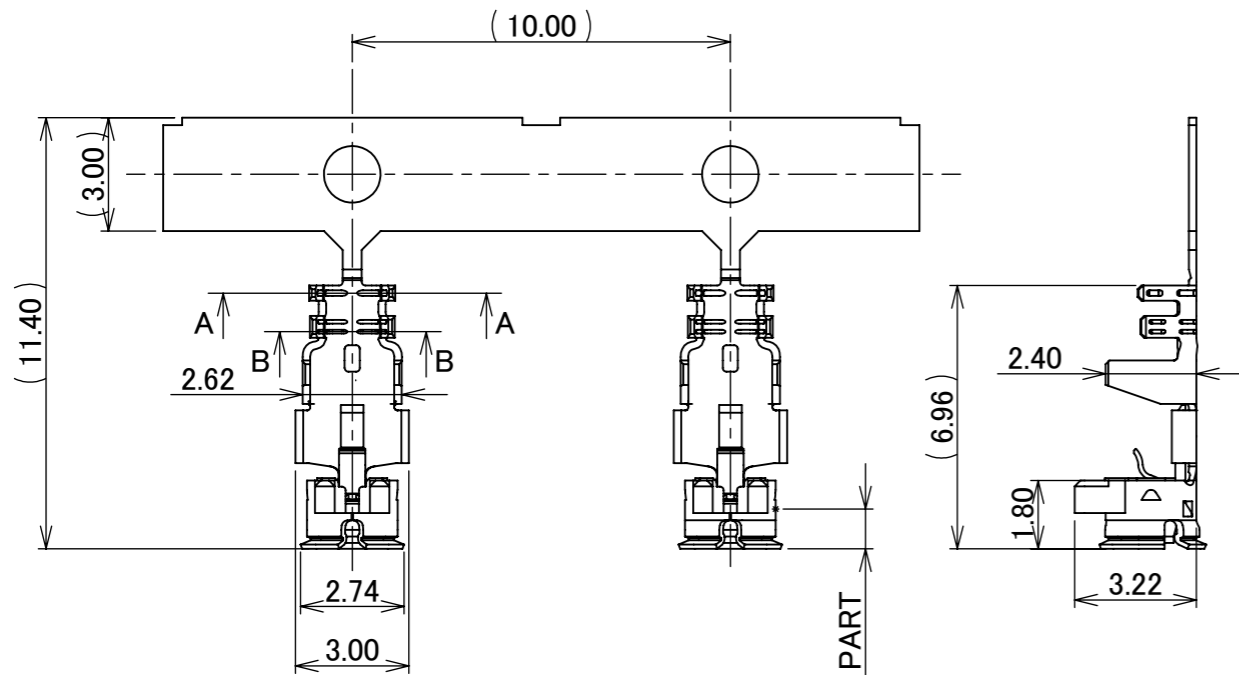

PART NO. 20670-001R-08
20670-001R-13
20670-001R-32
FOR SEMI AUTO TERMINATION MACHINE

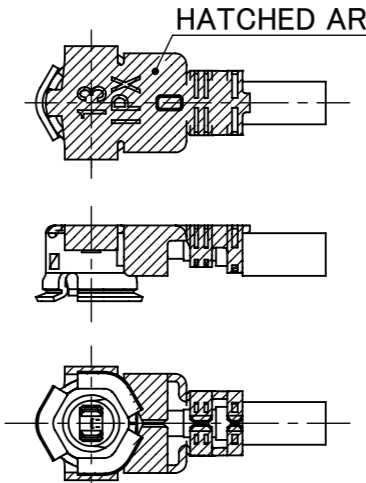
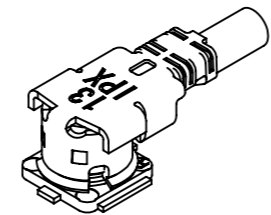

HATCHED AREA: Ni PLATING AREA



NOTES

- APPLICABLE CONNECTOR:
20279-001E-**-**
20431-001E-01
20441-001E-01
- PERMISSIBLE LOAD OF CABLE AT MATING
- MATING AND UNMATING INSTRUCTION
 - MATING
MAKE THE CONNECTOR VERTICALLY AS MUCH AS POSSIBLE, ADJUSTING THE MATING AXIS OF PLUG AND RECEPTACLE.
 - UNMATING
 - IN CASE OF UNMATING BY PULLING TOOL (PART NO. 90192-001): USE THE PULLING TOOL AS THE FOLLOWING DRAWING, AND PULL PLUG TO VERTICAL DIRECTION AS DIRECTLY AS POSSIBLE.
 - IN CASE OF UNMATING DIRECTLY BY HAND: CATCH THE CATCHING AREA OF PLUG, AND PULL PLUG TO VERTICAL DIRECTION AS DIRECTLY AS POSSIBLE.
 - CRIMP OVER STANDARDS OF OUTER CONDUCTOR
STANDARDS: LESS THAN 10% FROM TOTAL NUMBERS OF OUTER CONDUCTOR.
(NUMBERS OF OUTER CONDUCTOR'S CRIMP OVER FROM OUTER CONDUCTOR'S BARREL)
 - CAUTION ABOUT HEAT SHRINKAGE TUBES
PLEASE BE CAREFUL NOT TO MELT HOUSING WHEN USING HEAT SHRINKAGE TUBES.
IT WILL CAUSE OPEN CIRCUIT.
- THIS IS "Pb-FREE" CONNECTOR.

NOTE 2.

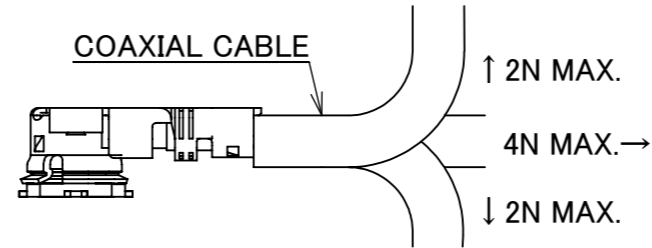

NOTE 3-2-1.

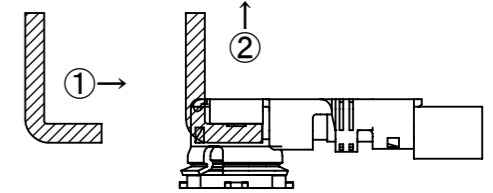

NOTE 3-2-2.

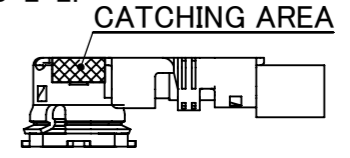

NO.	DESCRIPTION	MATERIAL	FINISH , REMARKS
3	GROUND CONTACT	PHOSPHOR BRONZE	ALL OVER Ni 1.00 μm MIN. CONTACT PART Au 0.02 μm MIN. [Ni PLATING AREA] Ni ONLY
2	CONTACT	PHOSPHOR BRONZE	ALL OVER Ni 1.00 μm MIN. CONTACT PART Au 0.03 μm MIN.
1	HOUSING	PBT	UL94V-0, BLACK

5	Z200262	TOI	2020/03/05	Y.H	ANGLE	±2°	6 OVER 30 MAX.	±0.3	PROJECTION ⊕	SERIES No. R1	CUSTOMER COPY		
4	Z191013	Haji	2019/08/01	Y.S	6 MAX.	±0.2	30 OVER 120 MAX.	±0.5					
3	Z190485	Y.F	2019/04/08	TAK	GENERAL TOLERANCE.			TITLE MHF® I PLUG NI TOP TYPE (1.80, 1.37, 1.32, 1.13, 0.81)	SCALE	I-PEX			
2	Z181428	M.N	2018/11/01	Ken	DWG.	T.Yayoshi	DATE		2015/08/18		5:1		
1	Z171048	Y.I	2017/10/13	Ken	CHK.	K.Yotsutani	DATE	2015/08/20	UNIT				
0	Z150889	Tad	2015/08/15		APP.	T.Takano	DATE	2015/08/20	mm				
REV.	ECN	BY	DATE	APP.	APP.	T.Takano	DATE	2015/08/20	DWG. No.	20670	SIZE	SHEET	REV.
REVISION RECORD										20670	A3	1/8	5

PART No.
20670-001R-18

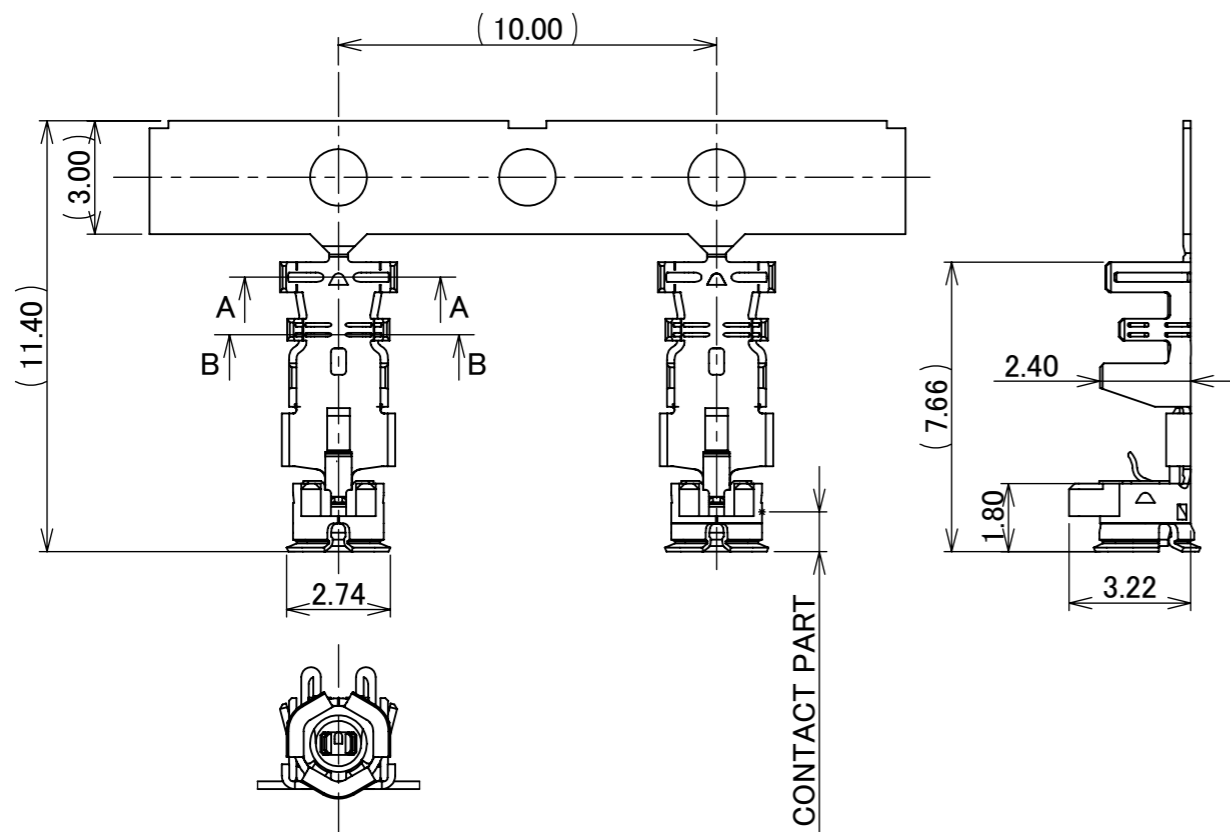
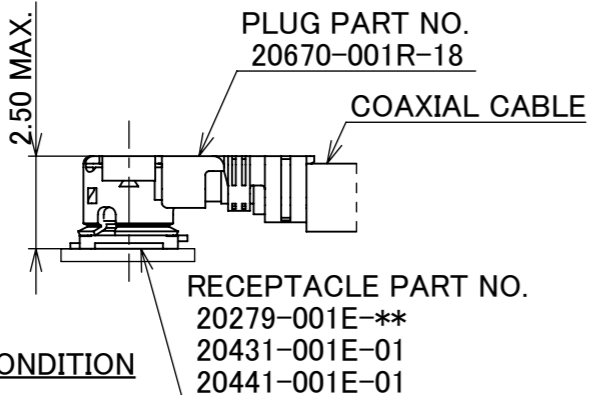
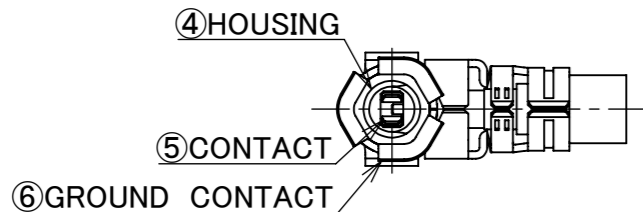
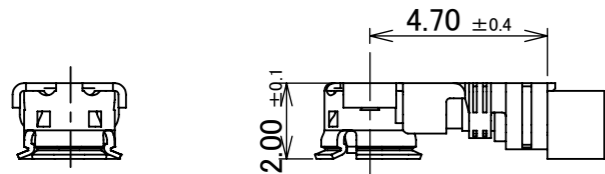
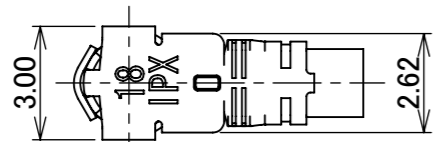

PART NO. 20670-001R-18
FOR SEMI AUTO TERMINATION MACHINE

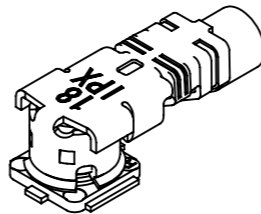

NOTES

5. APPLICABLE CONNECTOR:
20279-001E-**
20431-001E-01
20441-001E-01
6. PERMISSIBLE LOAD OF CABLE AT MATING
7. MATING AND UNMATING INSTRUCTION
- 7-1. MATING
MAKE THE CONNECTOR VERTICALLY AS MUCH AS POSSIBLE, ADJUSTING THE MATING AXIS OF PLUG AND RECEPTACLE.
- 7-2. UNMATING
- 7-2-1. IN CASE OF UNMATING BY PULLING TOOL (PART NO. 90192-001): USE THE PULLING TOOL AS THE FOLLOWING DRAWING, AND PULL PLUG TO VERTICAL DIRECTION AS DIRECTLY AS POSSIBLE.
- 7-2-2. IN CASE OF UNMATING DIRECTLY BY HAND: CATCH THE CATCHING AREA OF PLUG, AND PULL PLUG TO VERTICAL DIRECTION AS DIRECTLY AS POSSIBLE.
- 7-3. CRIMP OVER STANDARDS OF OUTER CONDUCTOR
STANDARDS: LESS THAN 10% FROM TOTAL NUMBERS OF OUTER CONDUCTOR.
(NUMBERS OF OUTER CONDUCTOR'S CRIMP OVER FROM OUTER CONDUCTOR'S BARREL)
- 7-4. CAUTION ABOUT HEAT SHRINKAGE TUBES
PLEASE BE CAREFUL NOT TO MELT HOUSING WHEN USING HEAT SHRINKAGE TUBES.
8. THIS IS "Pb-FREE" CONNECTOR.

HATCHED AREA: Ni PLATING AREA

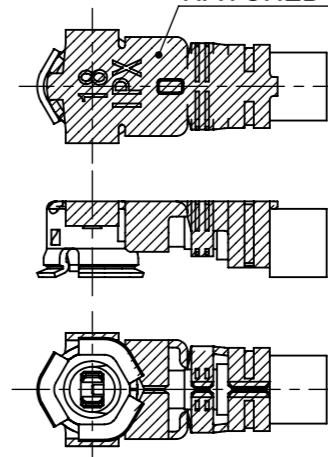

NOTE 6.

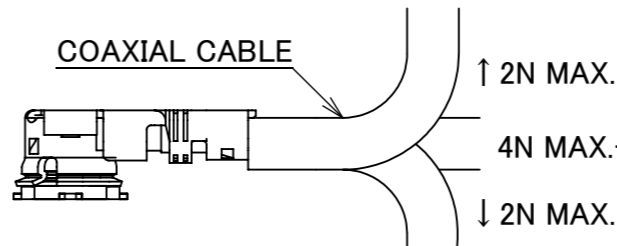

NOTE 7-2-1.

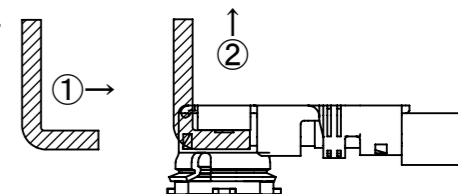

NOTE 7-2-2.

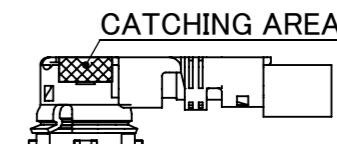

NO.	DESCRIPTION	MATERIAL	FINISH, REMARKS
6	GROUND CONTACT	PHOSPHOR BRONZE	ALL OVER Ni 1.00 μm MIN. CONTACT PART Au 0.02 μm MIN. [Ni PLATING AREA] Ni ONLY
5	CONTACT	PHOSPHOR BRONZE	ALL OVER Ni 1.00 μm MIN. CONTACT PART Au 0.03 μm MIN.
4	HOUSING	PBT	UL94V-0, BLACK

REV.	ECN	BY	DATE	APP.	APP.	DATE	PROJECTION	SERIES No.	CUSTOMER COPY	
REVISION RECORD					ANGLE	±2°	6 OVER 30 MAX.	±0.3	R1	CUSTOMER COPY
					6 MAX.	±0.2	30 OVER 120 MAX.	±0.5		
					GENERAL TOLERANCE.			TITLE	SCALE	
					DWG.	DATE				MHF® I PLUG NI TOP TYPE (1.80, 1.37, 1.32, 1.13, 0.81)
					CHK.	DATE		UNIT	I-PEX	
					APP.	DATE				mm
					DWG. No.	20670		SIZE	SHEET	
					A3	2/8		REV.		
							20670		5	

PART No.
20670-001R-37

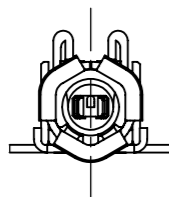
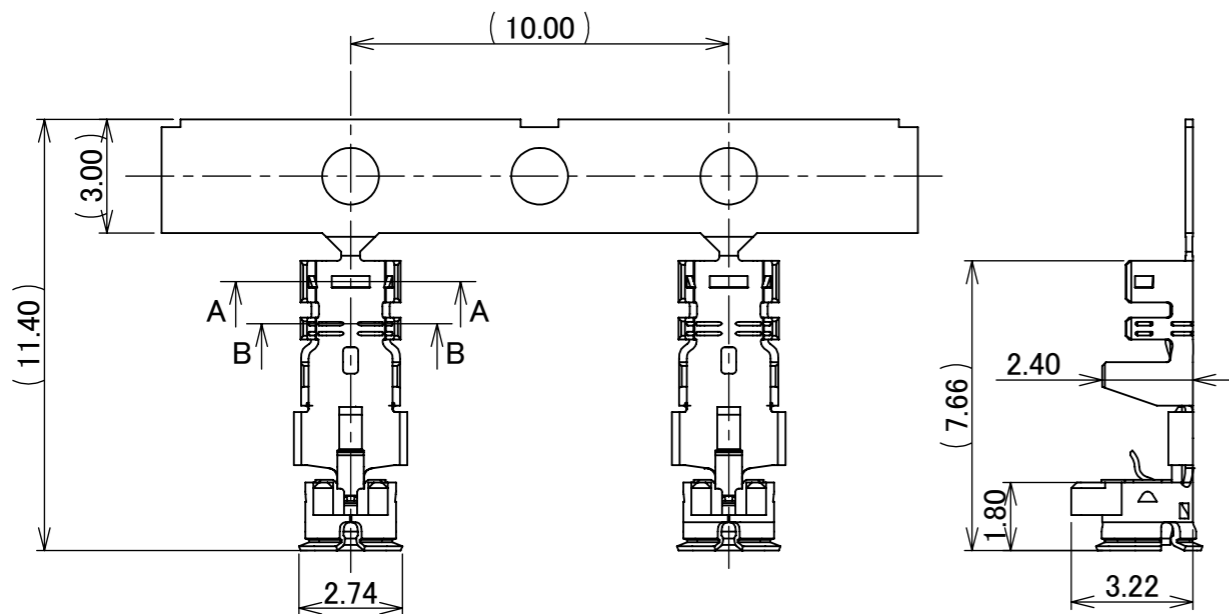
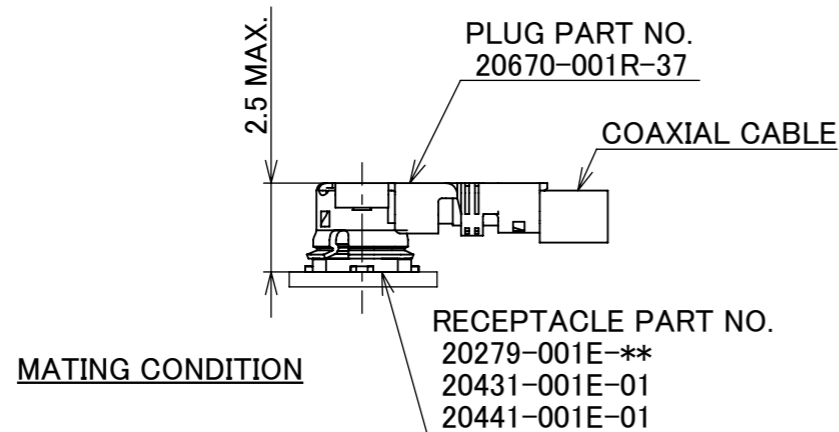
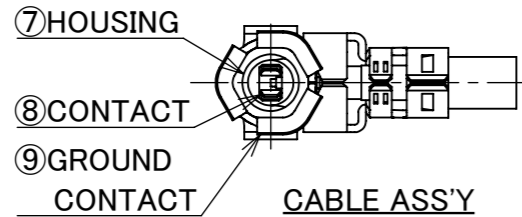
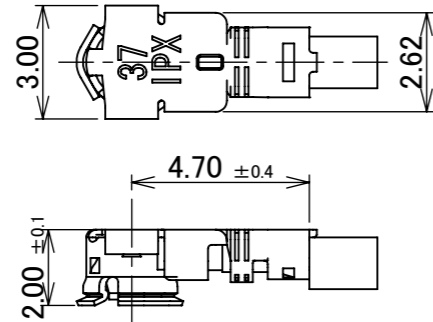
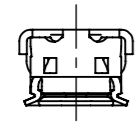

PART NO. 20670-001R-37
FOR SEMI AUTO TERMINATION MACHINE

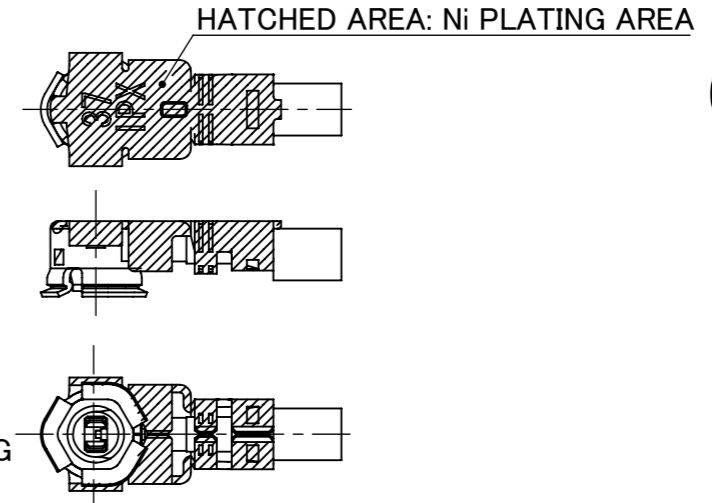
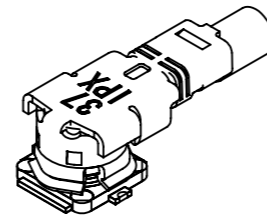

NOTES

9. APPLICABLE CONNECTOR:

- 20279-001E-**
- 20431-001E-01
- 20441-001E-01

10. PERMISSIBLE LOAD OF CABLE AT MATING

11. MATING AND UNMATING INSTRUCTION

11-1. MATING

MAKE THE CONNECTOR VERTICALLY AS MUCH AS POSSIBLE, ADJUSTING THE MATING AXIS OF PLUG AND RECEPTACLE.

11-2. UNMATING

11-2-1. IN CASE OF UNMATING BY PULLING TOOL (PART NO. 90192-001): USE THE PULLING TOOL AS THE FOLLOWING DRAWING, AND PULL PLUG TO VERTICAL DIRECTION AS DIRECTLY AS POSSIBLE.

11-2-2. IN CASE OF UNMATING DIRECTLY BY HAND: CATCH THE CATCHING AREA OF PLUG, AND PULL PLUG TO VERTICAL DIRECTION AS DIRECTLY AS POSSIBLE.

11-3. CRIMP OVER STANDARDS OF OUTER CONDUCTOR

STANDARDS: LESS THAN 10% FROM TOTAL NUMBERS OF OUTER CONDUCTOR.

(NUMBERS OF OUTER CONDUCTOR'S CRIMP OVER FROM OUTER CONDUCTOR'S BARREL)

11-4. CAUTION ABOUT HEAT SHRINKAGE TUBES

PLEASE BE CAREFUL NOT TO MELT HOUSING WHEN USING HEAT SHRINKAGE TUBES.

IT WILL CAUSE OPEN CIRCUIT.

12. THIS IS "Pb-FREE" CONNECTOR.

NOTE 10.

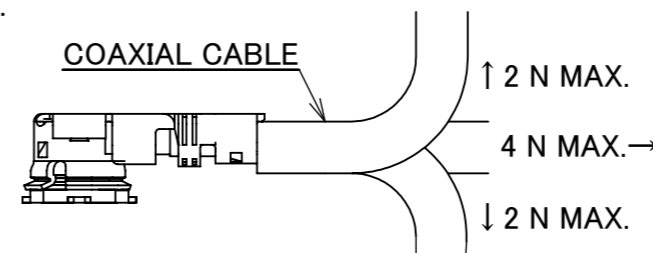

NOTE 11-2-1. PULLING TOOL PART NO. 90192-001

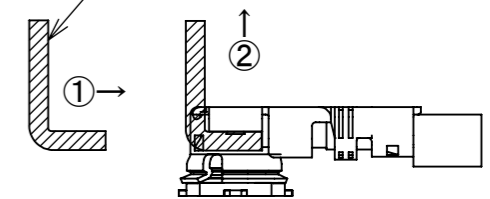

NOTE 11-2-2. CATCHING AREA

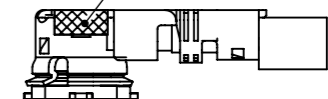

NO.	DESCRIPTION	MATERIAL	FINISH , REMARKS
9	GROUND CONTACT	PHOSPHOR BRONZE	ALL OVER Ni 1.00 μm MIN. CONTACT PART Au 0.02 μm MIN. [Ni PLATING AREA] Ni ONLY
8	CONTACT	PHOSPHOR BRONZE	ALL OVER Ni 1.00 μm MIN. CONTACT PART Au 0.03 μm MIN.
7	HOUSING	PBT	UL94V-0, BLACK

REVISION RECORD					ANGLE	±2°	6 OVER 30 MAX.	±0.3	PROJECTION ⊕	SERIES No. R1	CUSTOMER COPY		
						6 MAX.	±0.2	30 OVER 120 MAX.			±0.5	TITLE MHF® I PLUG NI TOP TYPE (1.80, 1.37, 1.32, 1.13, 0.81)	SCALE 5:1
REV.	ECN	BY	DATE	APP.	DWG.	DATE	CHK.	DATE	DWG. No.	20670	SIZE A3	SHEET 3/8	REV. 5

ITEMS	SPECIFICATION
RECOMMENDED APPLICABLE CONNECTOR PART No.	20279-001E-**
RATING VOLTAGE	60 V AC (R.M.S)
RATING FREQUENCY	DC~9GHz
OPERATING TEMPERATURE	233~363 K (-40°C~+90°C)
VSWR	1.3 MAX. AT 0.1~3 GHz, 1.5 MAX. AT 3~6 GHz, 1.9 MAX. AT 6~9 GHz
MAIN CONTACT RESISTANCE	INITIAL: 20 mohm MAX. / AFTER TEST: Δ R 20 mohm MAX.
GROUND CONTACT RESISTANCE	INITIAL: 20mohm MAX. / AFTER TEST: Δ R 100 mohm MAX.
INSULATION RESISTANCE	INITIAL: 500 Mohm MIN. / AFTER TEST: 100 Mohm MIN.
DIELECTRIC WITHSTANDING VOLTAGE	200 V AC, 1 MINUTE
DURABILITY	30 CYCLES
UNMATING FORCE (INITIAL / AFTER TEST)	5 N MIN. / 3 N MIN.
CRIMP STRENGTH	20670-001R-08, 20670-001R-13, 20670-001R-32: 10 N MIN. 20670-001R-18, 20670-001R-37: 15 N MIN.
PRODUCT SPECIFICATION	PRS-2105
TEST REPORT	TR-15059
PACKING STANDARD	300-233
INSTRUCTION MANUAL	HIM-10002
APPEARANCE CRITERIA No.	QLS-A***

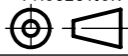
ANGLE	$\pm 2^\circ$	6 OVER 30 MAX.	± 0.3	PROJECTION 	SERIES No. R1	CUSTOMER COPY			
6 MAX.	± 0.2	30 OVER 120 MAX.	± 0.5						
GENERAL TOLERANCE.				TITLE MHF® I PLUG NI TOP TYPE (1.80, 1.37, 1.32, 1.13, 0.81)	SCALE	I-PEX			
DWG.	DATE				10:1				
CHK.					UNIT				mm
APP.					SIZE				A3
				DWG. No.	20670	SHEET	4/8	REV.	5

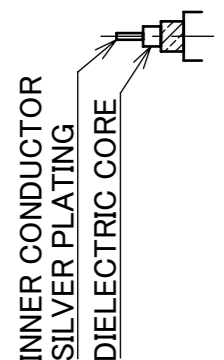
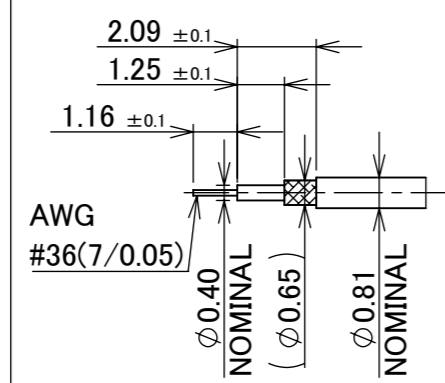
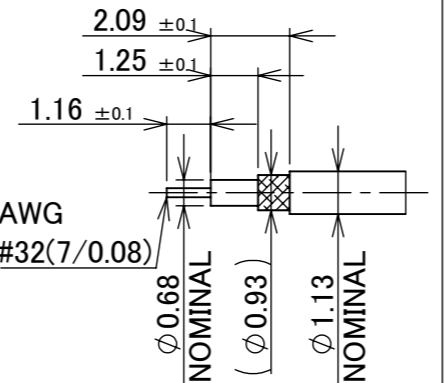
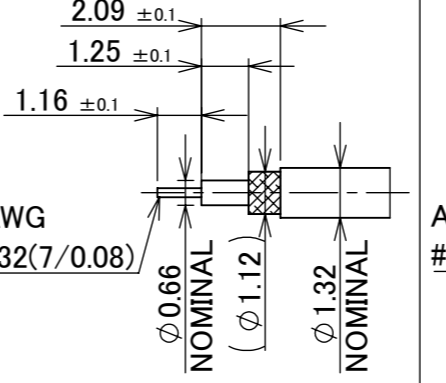
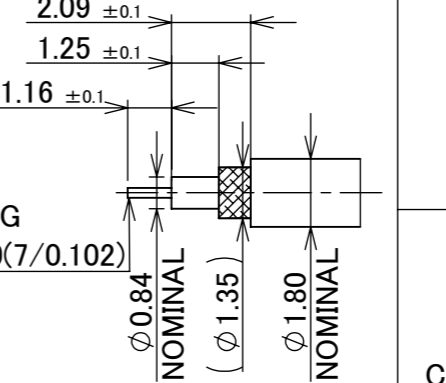
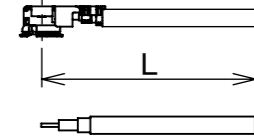
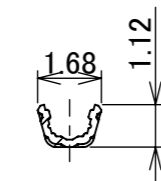
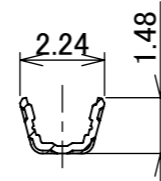
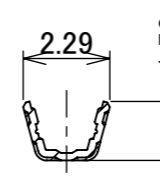
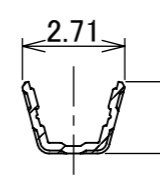
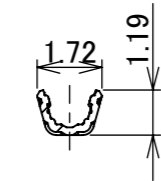
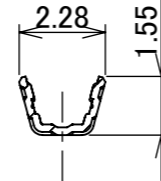
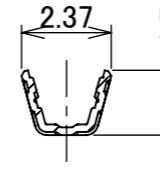
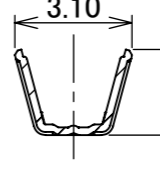
PART NO.	20670-001R-08	20670-001R-13	20670-001R-32	20670-001R-18	CABLE CUT LENGTH
APPLICABLE CABLE NOMINAL DIMENSION 	 <p>*SEE NOTE 14.</p>	 <p>*SEE NOTE 14.</p>	 <p>*SEE NOTE 14.</p>	 <p>*SEE NOTE 14.</p>	
BRAIDED SHIELD OF OUTER CONDUCTOR	SINGLE	SINGLE	DOUBLE	SINGLE	
PART NO. OF SEMI AUTO TERMINATION MACHINE	90213-008C	90213-013C	90213-032C	90232-018	
SECT. B-B					
SECT. A-A					
CRIMP HEIGHT	CH-1	1.34~1.40	1.34~1.40	1.34~1.40	1.34~1.40
	CH-2	0.76~0.84	1.06~1.14	1.20~1.30	1.41~1.49
	CH-3	0.85~0.97	1.15~1.35	1.26~1.46	1.70~1.80

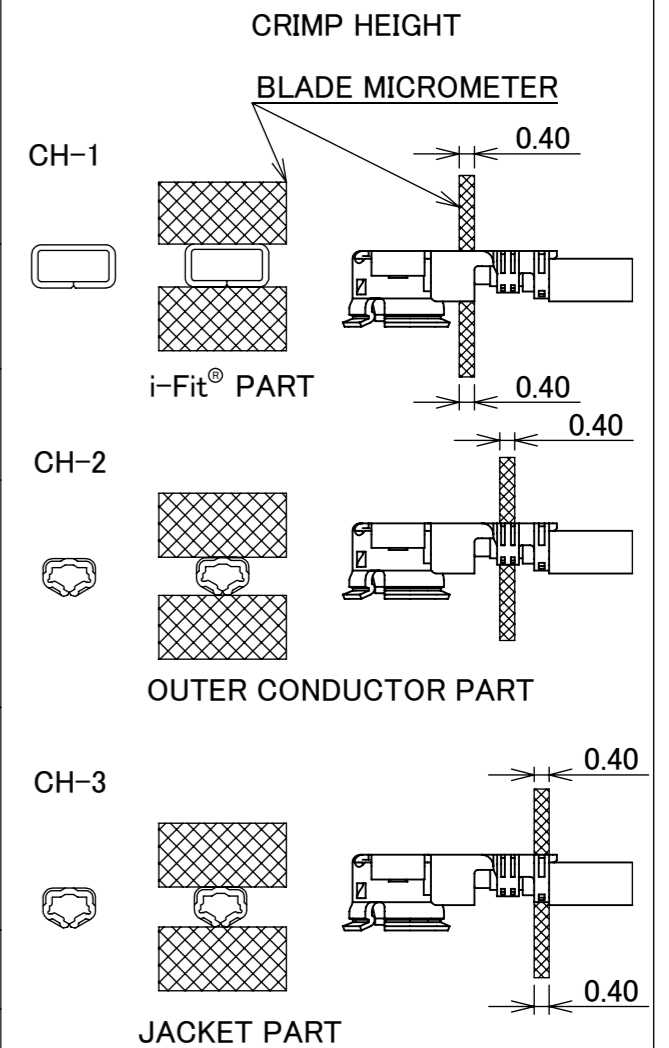

NOTE
13. MUST NOT USE SOLDER COATED INNER CONDUCTOR AND OUTER CONDUCTOR.

ANGLE	±2°	6 OVER 30 MAX.	±0.3	PROJECTION 	SERIES No. R1	CUSTOMER COPY	
	6 MAX.	±0.2	30 OVER 120 MAX.				
GENERAL TOLERANCE.				TITLE	SCALE	I-PEX	
DWG.	DATE			MHF® I PLUG NI TOP TYPE (1.80, 1.37, 1.32, 1.13, 0.81)	5:1		
CHK.					UNIT mm		
APP.				DWG. No. 20670	SIZE A3	SHEET 5/8	REV. 5

PART NO.		20670-001R-37		CABLE CUT LENGTH	
APPLICABLE CABLE NOMINAL DIMENSION					
INNER CONDUCTOR SILVER PLATING DIELECTRIC CORE		*SEE NOTE 15.		CRIMP HEIGHT	
BRAIDED SHIELD OF OUTER CONDUCTOR		SINGLE		BLADE MICROMETER	
PART NO. OF SEMI AUTO TERMINATION MACHINE		90232-037		CH-1	
SECT. B-B					
SECT. A-A					
CRIMP HEIGHT	CH-1	1.34 ~ 1.40			
	CH-2	1.36 ~ 1.42			
	CH-3	1.28 ~ 1.34			

NOTE
14. MUST NOT USE SOLDER COATED INNER CONDUCTOR AND OUTER CONDUCTOR.

ANGLE	±2°	6 OVER 30 MAX.	±0.3	PROJECTION	SERIES No.	CUSTOMER COPY
	6 MAX.	±0.2	30 OVER 120 MAX.	±0.5	R1	
GENERAL TOLERANCE.				TITLE	SCALE	I-PEX
DWG.	DATE			MHF® I	10:1	
CHK.				PLUG NI TOP TYPE	UNIT	
APP.				(1.80, 1.37, 1.32, 1.13, 0.81)	mm	
				DWG. No.	SIZE	SHEET
				20670	A3	6/8
					REV.	5

PART NO.	A	QTY. PER EMBOSS REEL (PIECES / REEL)	QTY. PER PACKING CARTON (REELS / CARTON)
20670-001R-**-**	20.0	2,500 / REEL	4 REELS / CARTON = 10,000 PIECES

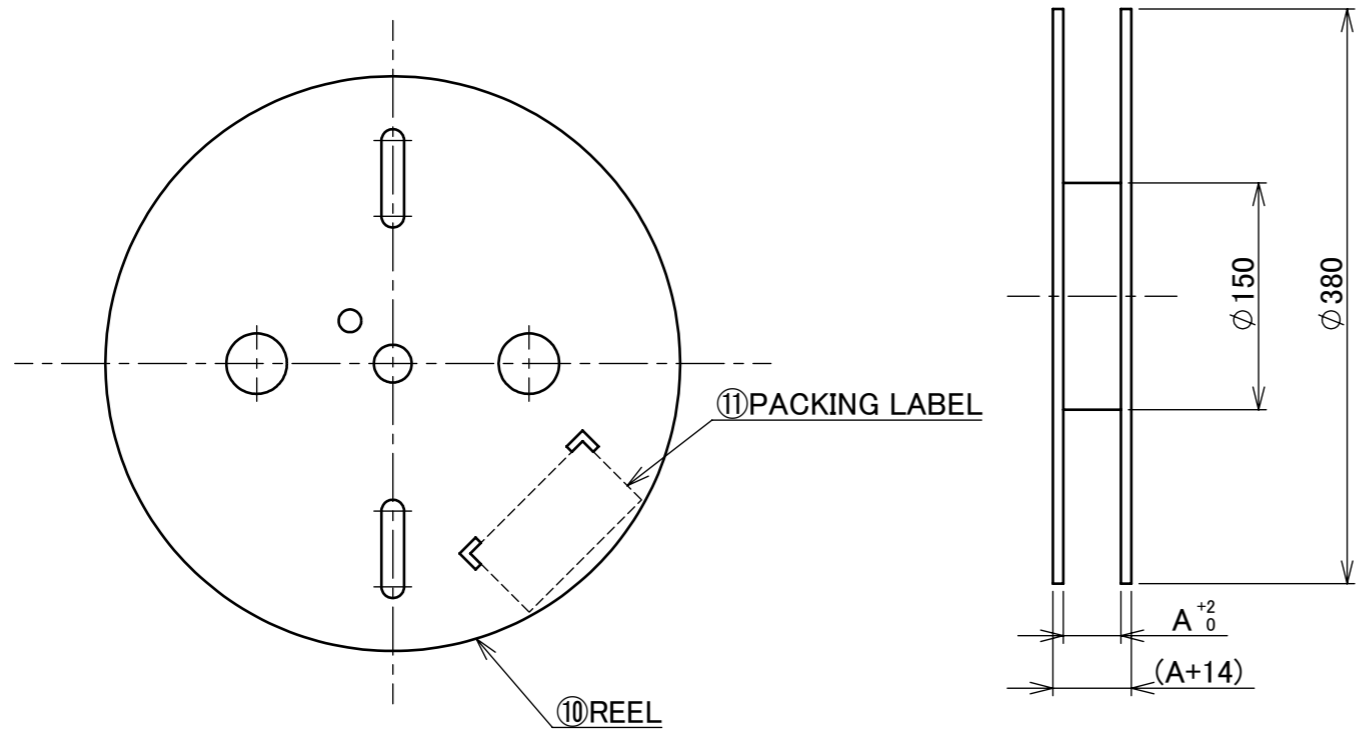

11	PACKING LABEL	-	-
10	REEL	CB	-
NO.	DISCRIPTION	MATERIAL	FINISH , REMARKS

ANGLE	$\pm 2^\circ$	6 OVER 30 MAX.	± 0.3	PROJECTION 	SERIES No. R1	CUSTOMER COPY
6 MAX.	± 0.2	30 OVER 120 MAX.	± 0.5			
GENERAL TOLERANCE.				TITLE MHF® I PLUG NI TOP TYPE (1.80, 1.37, 1.32, 1.13, 0.81)	SCALE 10:1 UNIT mm	I-PEX
DWG.	DATE					
CHK.						
APP.						
DWG. No. 20670				SIZE A3	SHEET 7/8	REV. 5

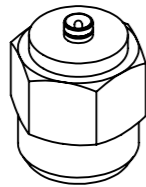

MHF I/II SMA ADAPTOR
PART NO. 90193-001

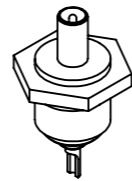

MHF I/II PLUG INSPECTION CONNECTOR
PART NO. 90194-001



FRONT SIDE BACK SIDE
MHF I/II PULLING TOOL
PART NO. 90192-001

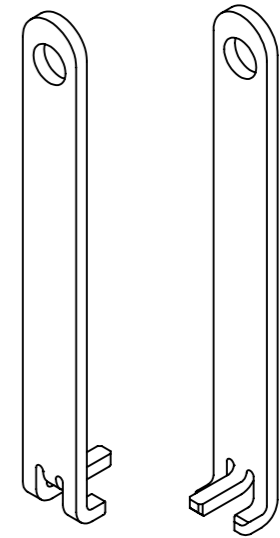

FRONT SIDE BACK SIDE
MHF I PUSHING AND PULLING TOOL
PART NO. 90224-001

ANGLE	±2°	6 OVER 30 MAX.	±0.3	PROJECTION ⊕	SERIES No. R1	CUSTOMER COPY			
6 MAX.	±0.2	30 OVER 120 MAX.	±0.5						
GENERAL TOLERANCE.				TITLE		SCALE	I-PEX		
DWG.	DATE			MHF® I PLUG NI TOP TYPE (1.80, 1.37, 1.32, 1.13, 0.81)		2:1			
CHK.						UNIT			
APP.				DWG. No. 20670		mm			
						SIZE	SHEET	REV.	
						A3	8/8	5	