

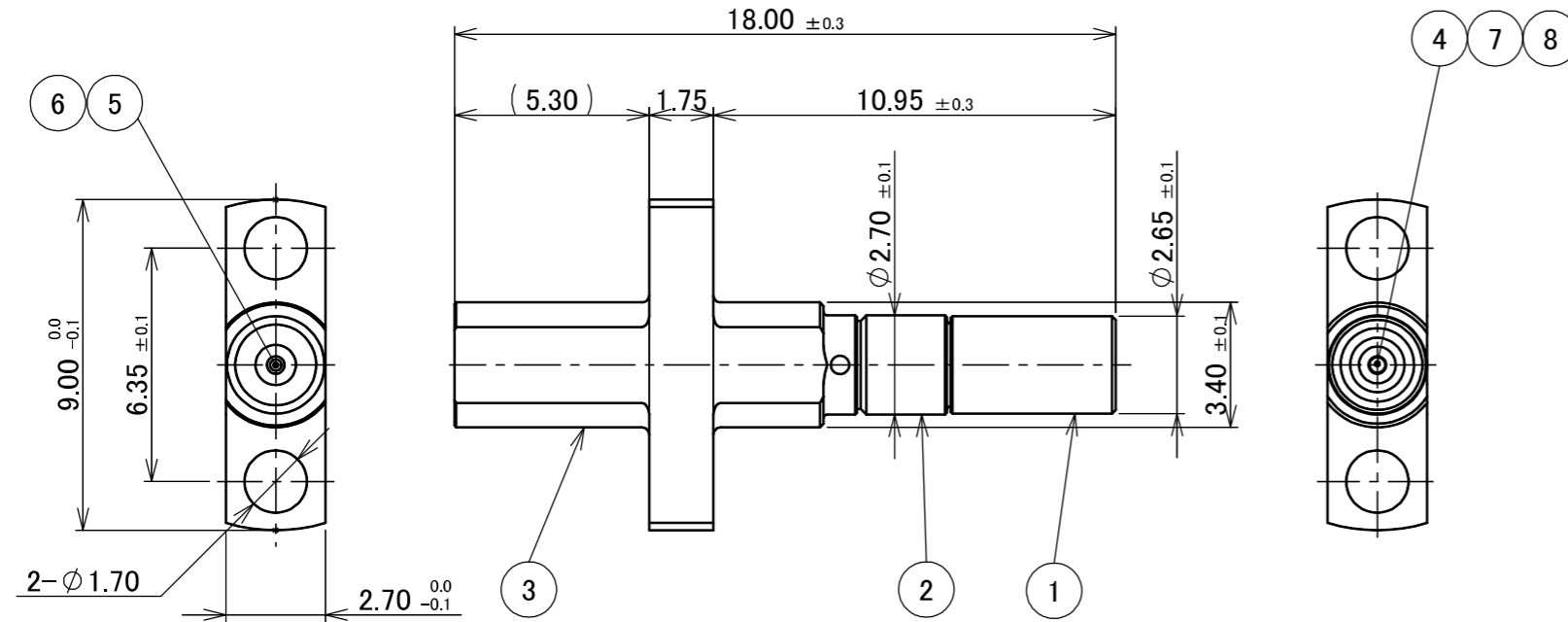

Halogen Free



RoHS Compliant



【USE IMAGE WITH 91197-300*】
(S = 2 : 1)

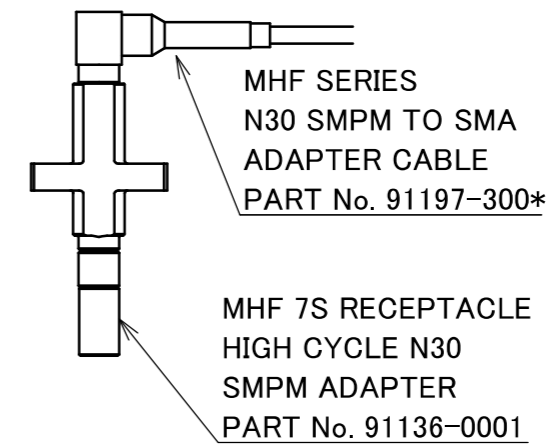
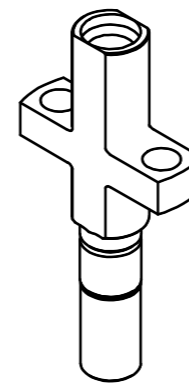
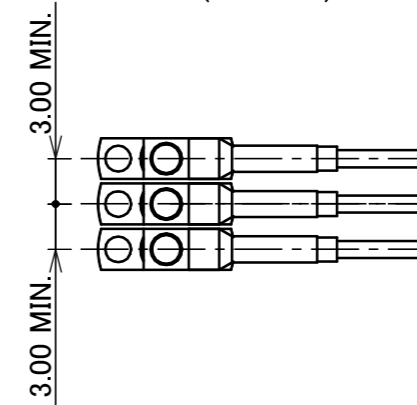

NOTE

1. AXIAL MISALIGNMENT DISTANCE: 0.25mm MAX.

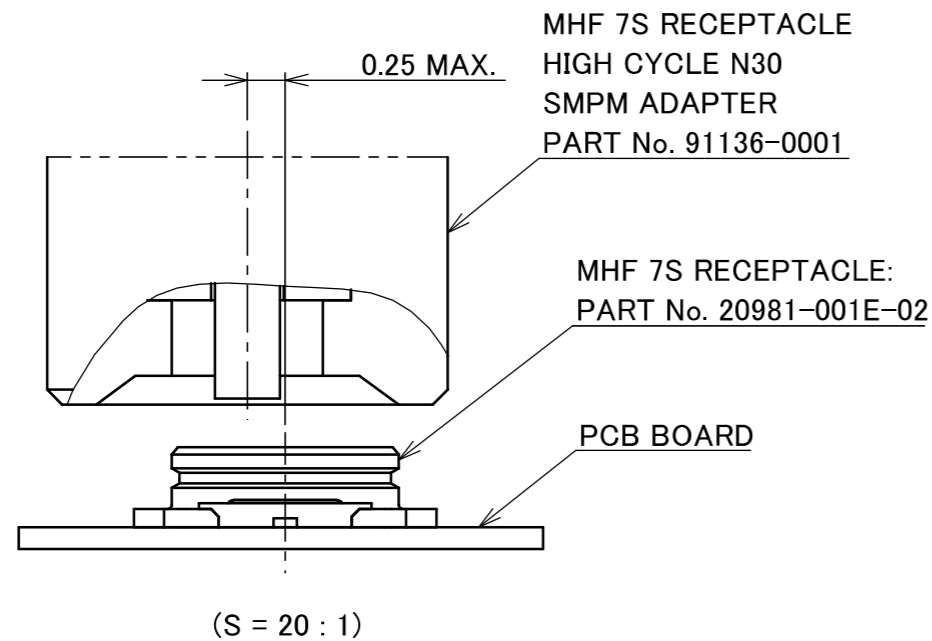

NO.	DESCRIPTION	MATERIAL	FINISH , REMARKS							
8	PROBE PIN	BERYLLIUM COPPER	Au PLATING ,OVER Ni PLATING							
7	PROBE SOCKET	BERYLLIUM COPPER	Au PLATING ,OVER Ni PLATING							
6	SMPM CONTACT	BERYLLIUM COPPER	Au PLATING ,OVER Ni PLATING							
5	INSULATOR B	PTFE	-							
4	INSULATOR A	PTFE	-							
3	FLANGE	-	-							
2	BODY	-	-							
1	OUTER CONTACT	-	-							
REVISION RECORD		GENERAL TOLERANCE.		PROJECTION	SERIES No.	CUSTOMER COPY				
2	ZC00219	TOI	2025/10/31	Yufu	ANGLE	±2°	6 OVER 30 MAX. ±0.3	MHF® 7S RECEPTACLE HIGH CYCLE N30 SMPM ADAPTER	SCALE 5:1 UNIT mm	I-PEX
1	Z221243	K.M	2022/11/08	Y.H	6 MAX. ±0.2	30 OVER 120 MAX. ±0.5	TITLE R0			
0	Z221200	K.W	2022/10/27	-	CHK. K.Yufu	APP. Y.Hashimoto				
REV.	ECN	BY	DATE	APP.	DWG. No.	91136	SIZE A3	SHEET 1/2	REV. 2	

ITEMS	SPECIFICATION
RECOMMENDED APPLICABLE CONNECTOR PART No.	MHF 7S RECEPTACLE P/N: 20981-001E-02 MHF SERIES N30 SMPM TO SMA ADAPTER CABLE P/N: 91197-300*
RATED FREQUENCY	300kHz TO 15.0GHz
OPERATING TEMPERATURE	243 TO 343 K (-30°C TO +70°C)
VSWR (MATED WITH 20981-001E-02)	1.40 MAX. AT 300kHz-3.0GHz, 1.50 MAX. AT 3.0GHz-6.0GHz, 1.60MAX. AT 6.0GHz-9.0GHz, 2.00MAX. AT 9.0GHz-15.0GHz
INSULATION RESISTANCE	500 Mohm MIN. AT DC 100V
DIELECTRIC WITHSTANDING VOLTAGE	AC 100V 1min
DURABILITY	10,000 CYCLES
PRODUCT SPECIFICATION	PRS-2803
TEST REPORT	TR-22036
INSTRUCTION MANUAL	HIM-22018
APPEARANCE CRITERIA No.	QLS-A***

ANGLE	±2°	6 OVER 30 MAX.	±0.3	PROJECTION 	SERIES No. R0	CUSTOMER COPY		
6 MAX.	±0.2	30 OVER 120 MAX.	±0.5					
GENERAL TOLERANCE.				TITLE MHF® 7S RECEPTACLE HIGH CYCLE N30 SMPM ADAPTER	SCALE -	I-PEX		
DWG.	DATE							
CHK.								
APP.								
				DWG. No.	91136	SIZE	SHEET	REV.
						A3	2/2	2