

* 1.3 MAX. AT 20668-001R-13, 20714-001R-81
 * 1.0 MAX. AT 20711-001R-81

MATING CONDITION

NOTES

1. APPLICABLE CONNECTOR

- 20567-001R-81
- 20615-00*R-48
- 20668-001R-13
- 20669-001R-81
- 20711-001R-81
- 20714-001R-81

2. COPLANARITY: 0.1mm MAX.

3. THIS IS "Pb-FREE" CONNECTOR.

4. PRECAUTIONS FOR CABLE POSITION

[PART NO. 20567-001R-81, 20615-00*R-48]

THE PLUG SHALL NOT BE PLACED WITHIN 50 DEGREES ANGLE FROM CENTER OF THE SIGNAL CONTACT.

TILT THE PLUG AT LEAST 50 DEGREES FROM THE CENTER OF A SIGNAL CONTACT.

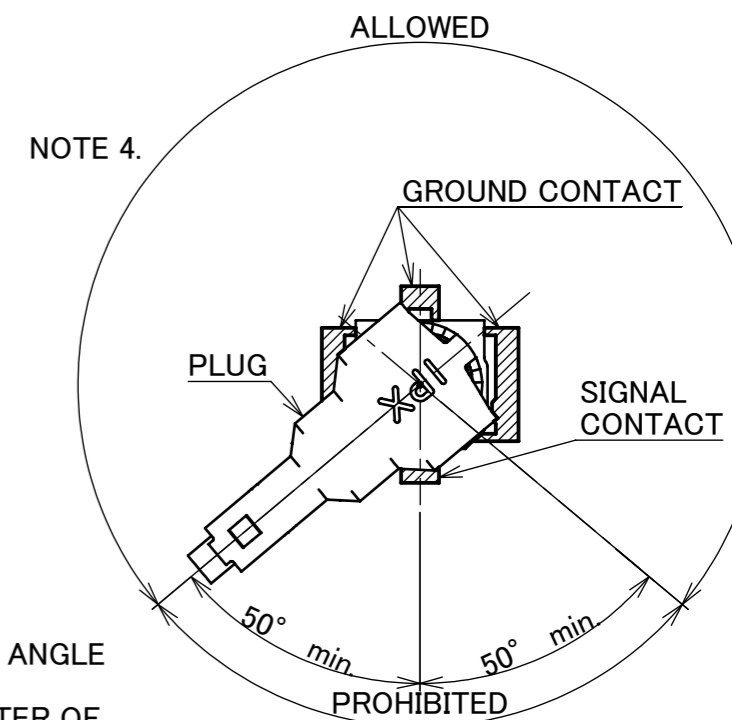

3	GROUND CONTACT	PHOSPHOR BRONZE	ALL OVER Ni 1.00 μm MIN. CONTACT PART Au 0.01 μm MIN. UNDER PLATE Pd-Ni 0.02 μm MIN. SOLDERING PART Au 0.01 μm MIN. UNDER PLATE Pd-Ni 0.02 μm MIN.
2	CONTACT	BRASS	ALL OVER Ni 1.00 μm MIN. CONTACT PART Au 0.1 μm MIN. SOLDERING PART Au 0.03 μm MIN.
1	HOUSING	LCP	UL94V-0, BLACK
NO.	DESCRIPTION	MATERIAL	FINISH, REMARKS

7	Z210267	TOI	2021/03/16	M.T	ANGLE	±2°	6 OVER 30 MAX.	±0.3	PROJECTION ⊕	SERIES No. R6	CUSTOMER COPY	
6	Z180766	M.N	2018/09/14	Ken	6 MAX.	±0.2	30 OVER 120 MAX.	±0.5				
5	Z180428	M.N	2018/03/30	Ken	GENERAL TOLERANCE.				TITLE MHF® 5 RECEPTACLE	SCALE 20:1	UNIT I-PEX	
4	Z150479	H.T	2015/05/25	Tom	DWG.	DATE		2012/12/07				
3	Z141459	Y.H	2014/12/22	Tom	H.Kon	DATE						2012/12/07
2	Z140264	Y.H	2014/03/24	Tom	CHK.	DATE		2012/12/07				
REV.	ECN	BY	DATE	APP.	APP.	DATE			DWG. No.	20566	SIZE A3	SHEET 1/5
REVISION RECORD					T.Takano	2012/12/07						

ITEMS	SPECIFICATION		
RECOMMENDED APPLICABLE CONNECTOR PART No.	20668-001R-13	20711-001R-81 (CABLE AWG#36 ϕ 0.81)	20714-001R-81
RATING VOLTAGE	60 V AC (R.M.S)		
RATING FREQUENCY	DC~12 GHz		
OPERATING TEMPERATURE	233~363 K (-40°C~+90°C)		
VSWR	1.3 MAX. AT DC~3 GHz, 1.4 MAX. AT 3~6 GHz, 1.5 MAX. AT 6~12 GHz		
MAIN CONTACT RESISTANCE	INITIAL: 20 mohm MAX. / AFTER TEST: Δ R 20 mohm MAX.		
GROUND CONTACT RESISTANCE	INITIAL: 20 mohm MAX. / AFTER TEST: Δ R 100 mohm MAX.		
INSULATION RESISTANCE	INITIAL: 500 Mohm MIN. / AFTER TEST: 100 Mohm MIN.		
DIELECTRIC WITHSTANDING VOLTAGE	200 V AC, 1 MINUTE		
DURABILITY	30 CYCLES		
UNMATING FORCE (INITIAL / AFTER TEST)	INITIAL: 5 N MIN. AFTER TEST: 3 N MIN.	INITIAL: 4 N MIN. AFTER TEST: 2 N MIN.	INITIAL: 5 N MIN. AFTER TEST: 3 N MIN.
PRODUCT SPECIFICATION	PRS-2192	PRS-2108	PRS-2236
TEST REPORT	TR-16003	TR-15062	TR-16049
PACKING STANDARD	PST-12036		
INSTRUCTION MANUAL	HIM-16014	HIM-16013	HIM-16014
APPEARANCE CRITERIA No.	QLS-A***		

ANGLE	$\pm 2^\circ$	6 OVER 30 MAX.	± 0.3	PROJECTION 	SERIES No. R6	CUSTOMER COPY		
6 MAX.	± 0.2	30 OVER 120 MAX.	± 0.5					
GENERAL TOLERANCE.				TITLE MHF [®] 5 RECEPTACLE	SCALE	I-PEX		
DWG.	DATE				-			
CHK.					UNIT			
APP.					mm			
				DWG. No.	20566	SIZE	SHEET	REV.
						A3	2/5	7

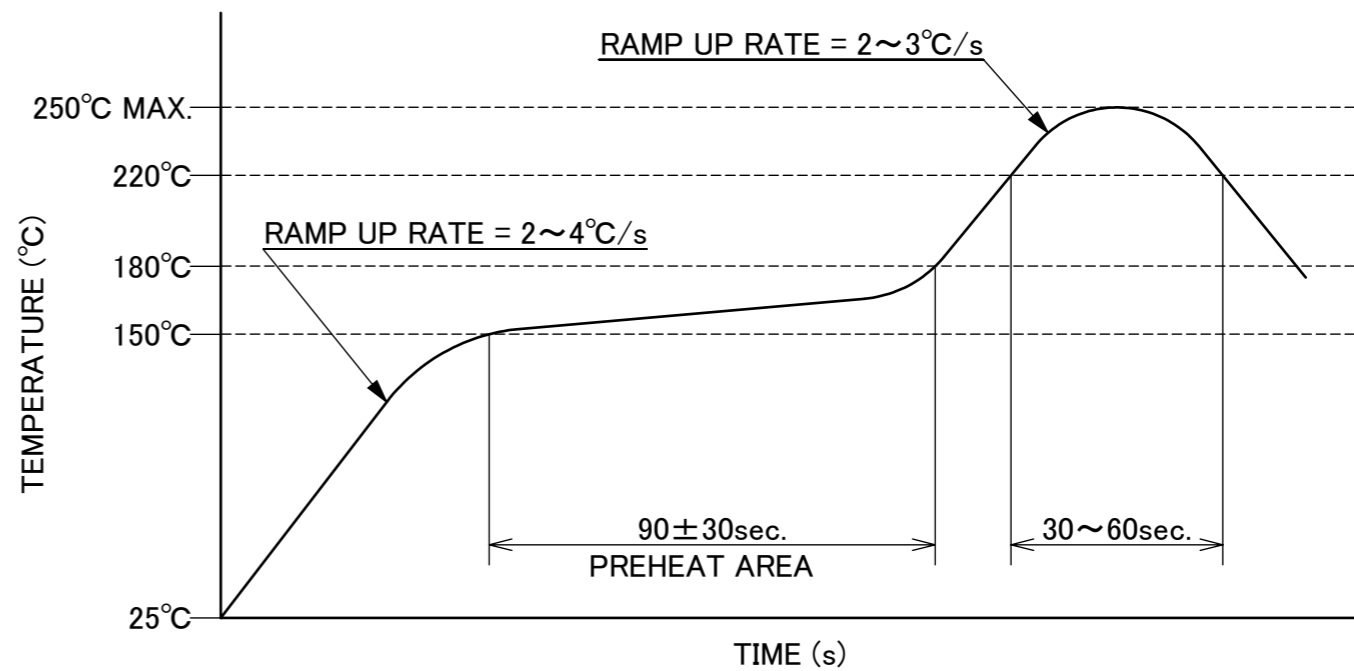
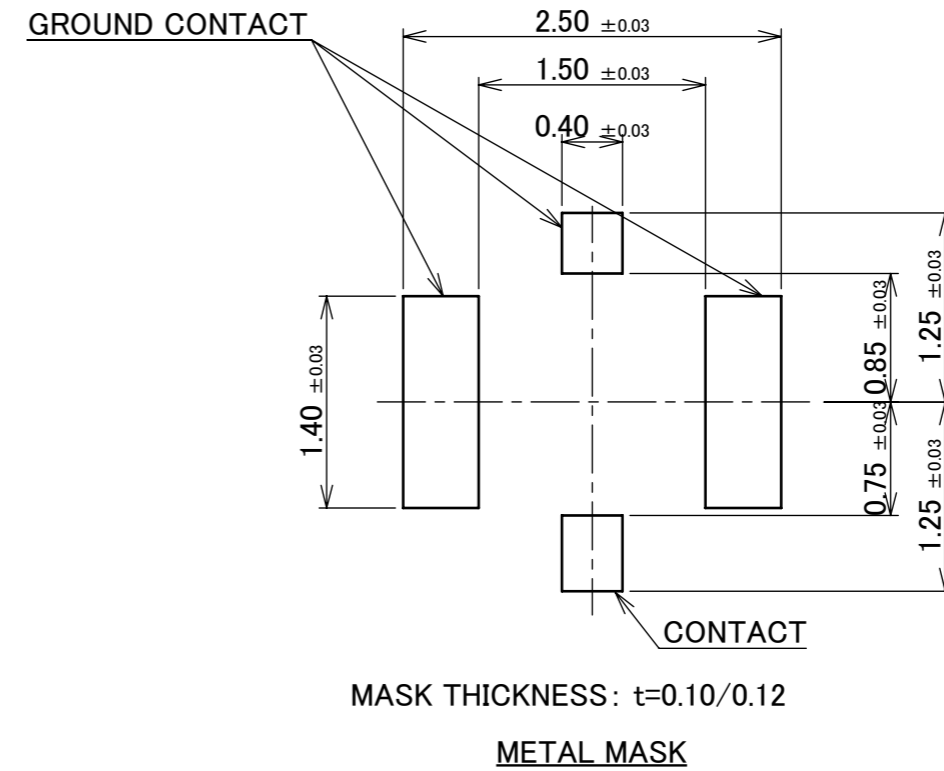
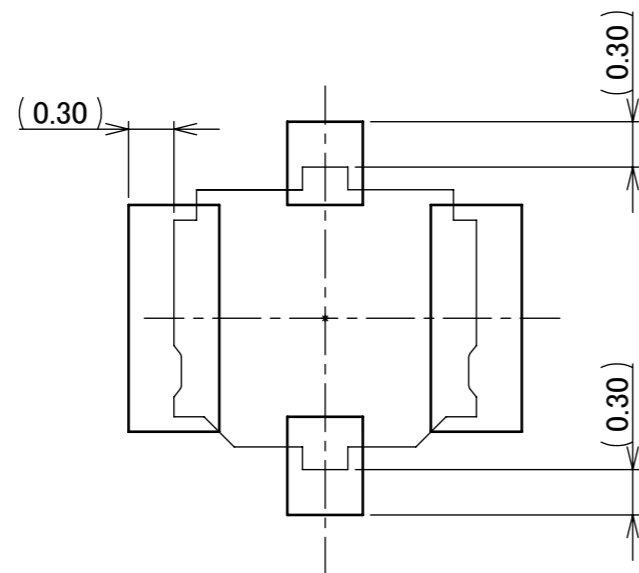
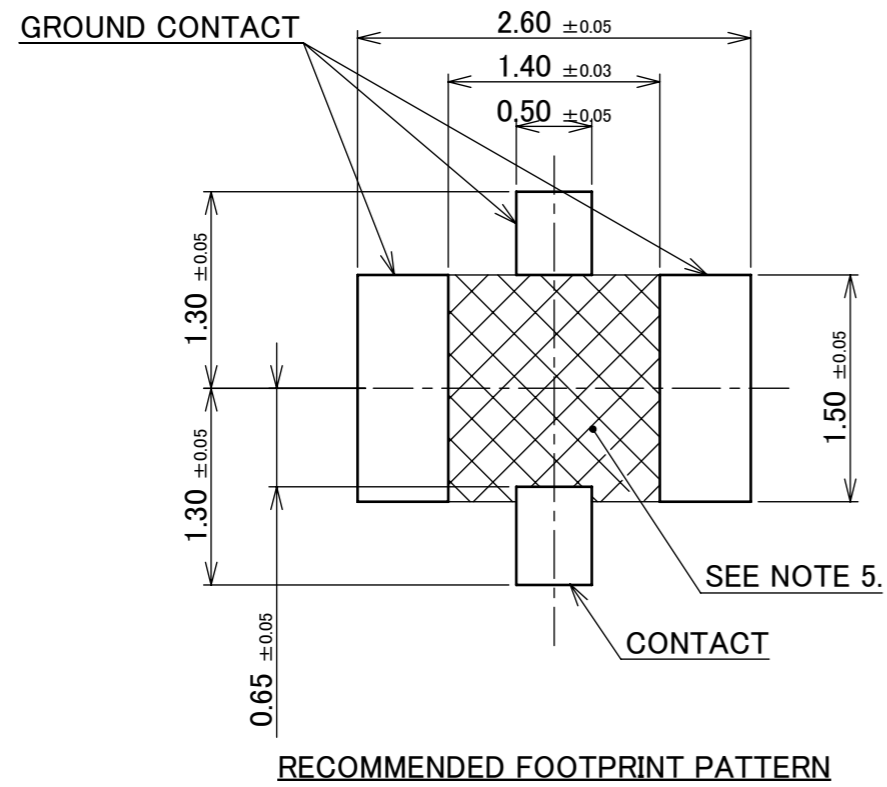

SENJU METAL INDUSTRY CO., LTD. : M705-SHF(Sn96.5 Ag3.0 Cu0.5)

NOTES.
5. CUT OUT PROHIBITION AREA

ANGLE	±2°	6 OVER 30 MAX.	±0.3	PROJECTION ⊕	SERIES No. R6	CUSTOMER COPY			
6 MAX.	±0.2	30 OVER 120 MAX.	±0.5						
GENERAL TOLERANCE.				TITLE		SCALE	I-PEX		
DWG.	DATE			MHF [®] 5 RECEPTACLE		20:1			
CHK.						UNIT			
APP.				DWG. No. 20566		mm			
						SIZE	SHEET	REV.	
						A3	3/5	7	

PART NO.	A	QTY. PER EMBOSS REEL (PIECES / REEL)	QTY. PER PACKING CARTON (REELS / CARTON)
20566-001E-01	12.0	10,000 / REEL	9 REELS / CARTON = 90,000 PIECES

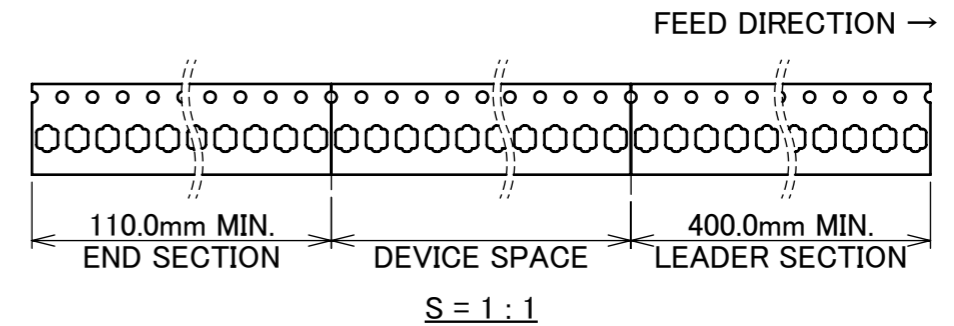
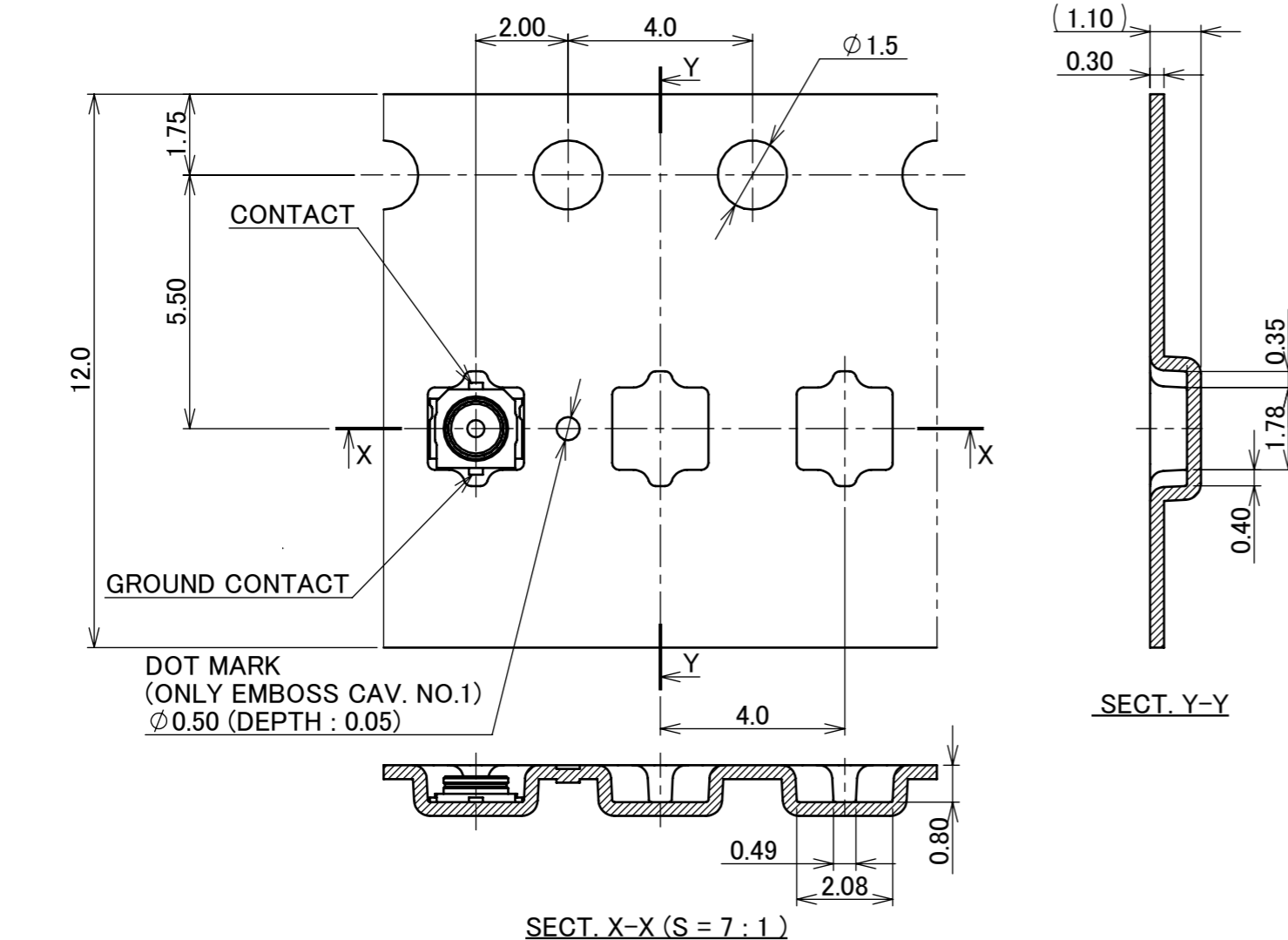
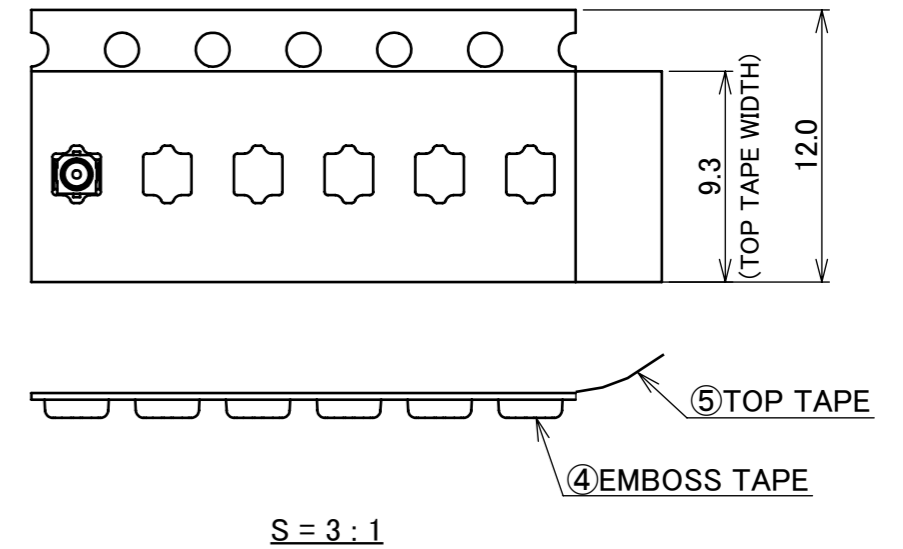
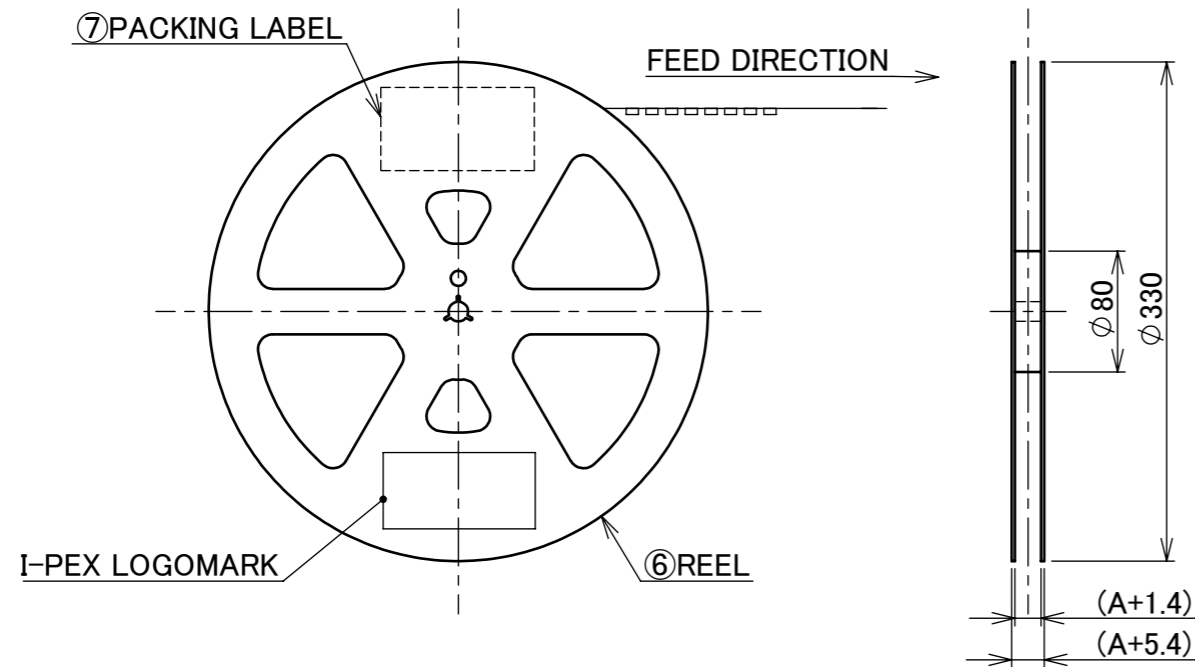

- NOTES.
6. TAPING SPECIFICATION FOLLOWS JIS C 0806 (IEC 60286-3).
7. MAKE EMPTY SECTION OF LEADER AND END ON EACH END OF THE TAPE.
8. TOP TAPE SHALL NOT STICK OUT FROM EMBOSS TAPE.
9. TOP TAPE SHALL NOT COVER FEED HOLE.

NO.	DESCRIPTION	MATERIAL	FINISH, REMARKS
7	PACKING LABEL	-	-
6	REEL	PS	HEAT ACTIVATED, ANTI-STATIC TYPE, WHITE
5	TOP TAPE	PET t=0.062	ANTI-STATIC TYPE or CONDUCTIVE
4	EMBOSS TAPE	PS t=0.3	-

ANGLE	±2°	6 OVER 30 MAX.	±0.3	PROJECTION ⊕	SERIES No. R6	CUSTOMER COPY		
6 MAX.	±0.2	30 OVER 120 MAX.	±0.5			SCALE -	UNIT mm	I-PEX
GENERAL TOLERANCE.				TITLE MHF [®] 5 RECEPTACLE		SIZE		
DWG.	DATE			DWG. No. 20566		A3		
CHK.								
APP.								



SMA ADAPTOR FOR MHF 5 PLUG
PART NO. 90543-0001



MHF 5 HIGH CYCLE PROBE
PART NO. 90690-0001

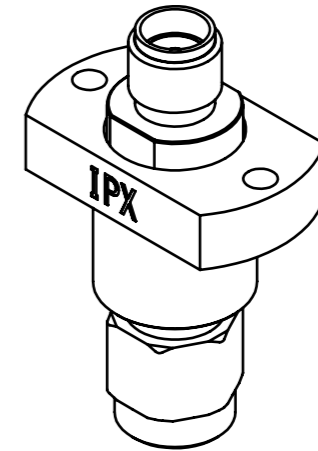

MHF 5 HIGH CYC ADAP BASE UNIT
PART NO. 90684-0001

* 90690-0001 AND 90684-0001 SHOULD BE USED TOGETHER.

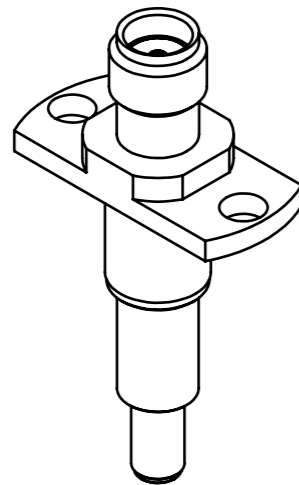

MHF 5 HIGH CYCLE ADAPTOR
PART NO. 90793-0001

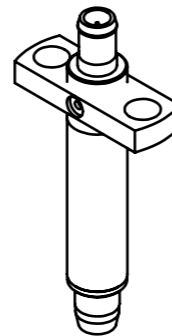

MHF 5 4.5MM HIGH CYCLE TEST PROBE LONG TYPE
PART NO. 90847-0001

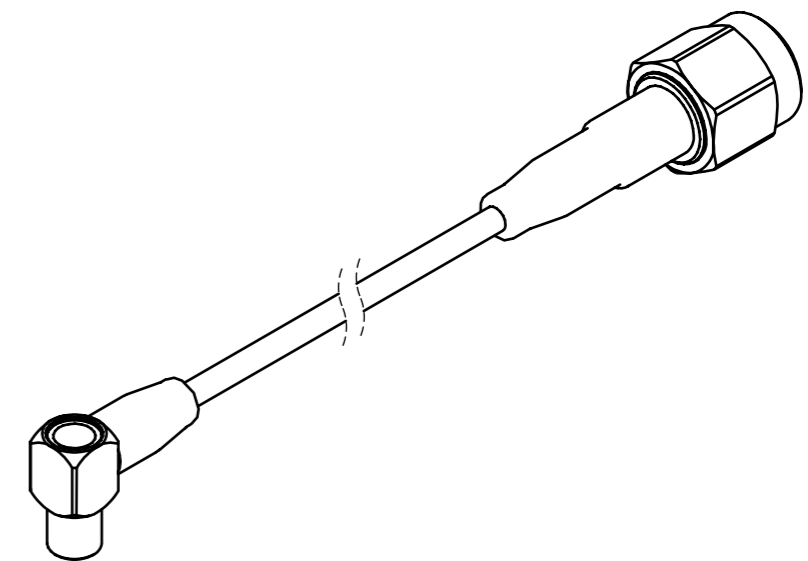

4.5MM HIGH CYCLE TEST PROBE CABLE ASS'Y
PART NO. 90577-****

* 90847-0001 AND 90577-**** SHOULD BE USED TOGETHER.

ANGLE	±2°	6 OVER 30 MAX.	±0.3	PROJECTION ⊕	SERIES No. R6	CUSTOMER COPY			
6 MAX.	±0.2	30 OVER 120 MAX.	±0.5						
GENERAL TOLERANCE.				TITLE		SCALE	I-PEX		
DWG.	DATE			MHF® 5 RECEPTACLE		2:1			
CHK.						UNIT			
APP.				DWG. No. 20566		mm			
						SIZE	SHEET	REV.	
						A3	5/5	7	