

| |
|---------------|
| PART No. |
| 20668-001R-13 |

Offered as harness only.

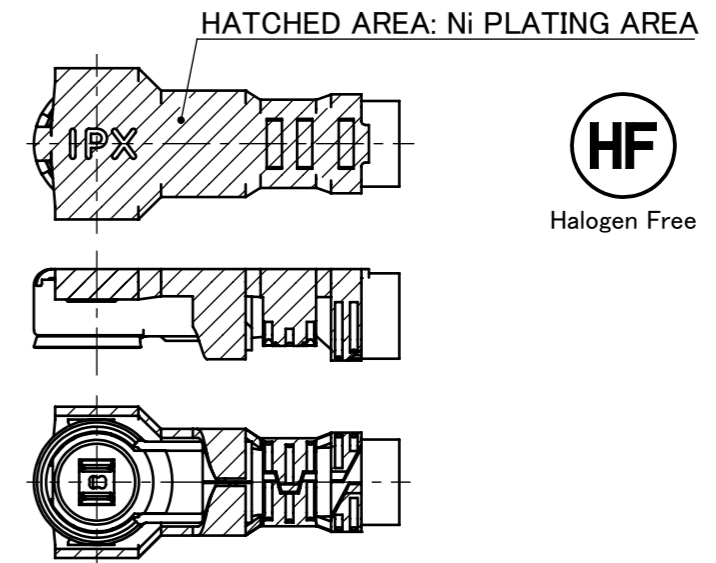
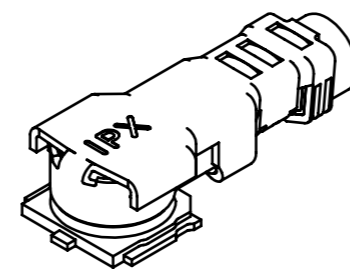
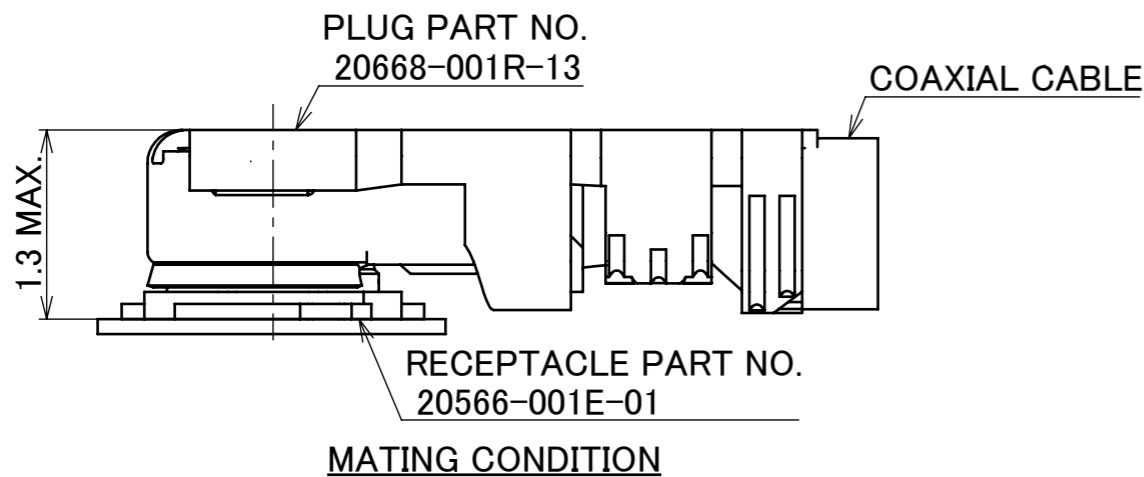
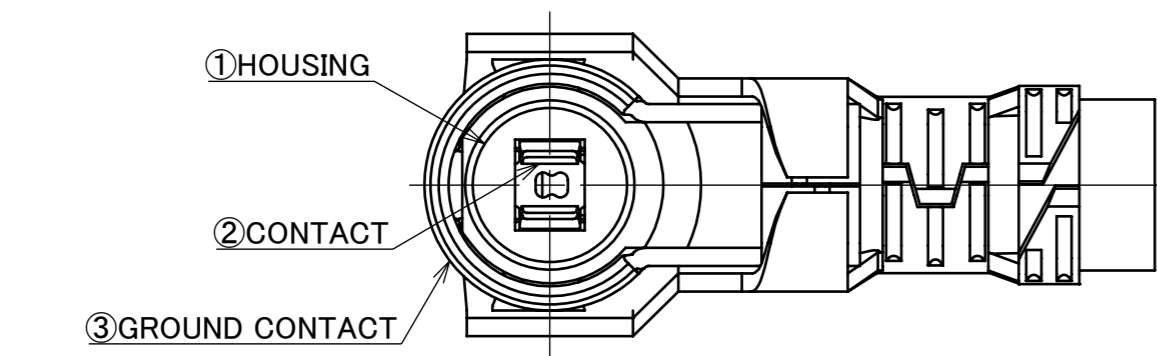
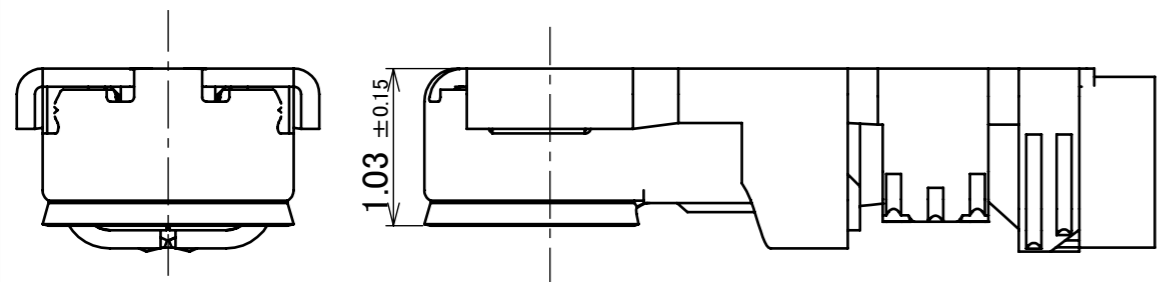
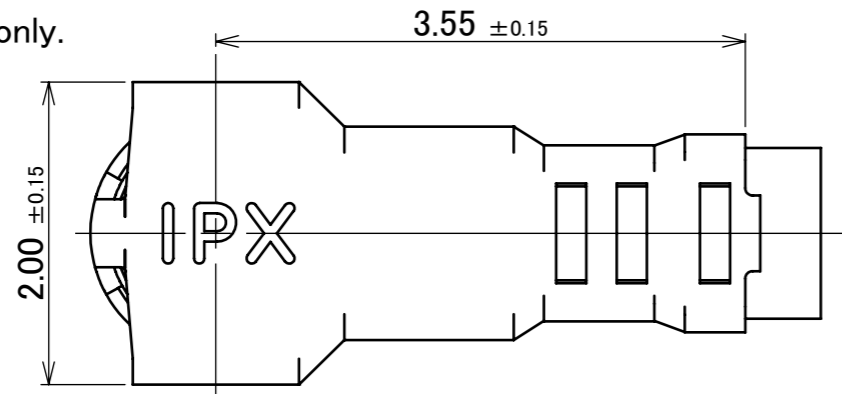

NOTES.

1. APPLICABLE CONNECTOR: 20566-001E-01
2. PERMISSIBLE LOAD OF CABLE AT MATING
3. MATING AND UNMATING INSTRUCTION
 - 3-1. MATING
MATE THE CONNECTOR VERTICALLY AS MUCH AS POSSIBLE, ADJUSTING THE MATING AXIS OF PLUG AND RECEPTACLE. DO NOT SLANT MATE.
 - 3-2. UNMATING
 - 3-2-1. IN CASE OF UNMATING BY PULLING TOOL (PART NO. 90612-0001)
USE THE PULLING TOOL AS THE FOLLOWING DRAWING, AND PULL PLUG TO VERTICAL DIRECTION AS DIRECTLY AS POSSIBLE.
 - 3-2-2. IN CASE OF UNMATING DIRECTLY BY HAND
CATCH THE CATCHING AREA OF PLUG, AND PULL PLUG TO VERTICAL DIRECTION AS DIRECTLY AS POSSIBLE.

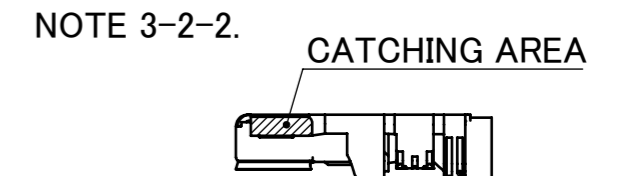
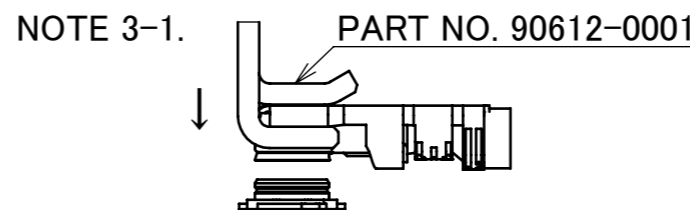
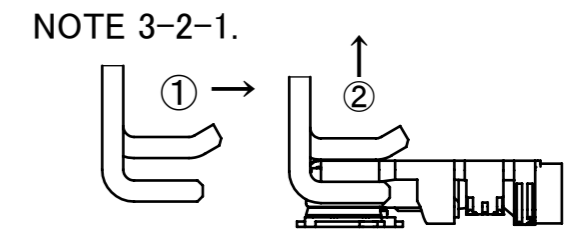
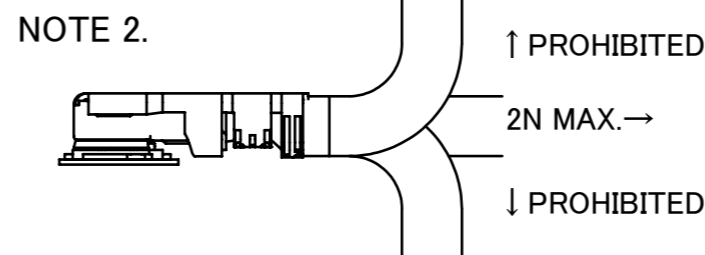

| NO. | DESCRIPTION | MATERIAL | FINISH , REMARKS |
|-----|----------------|-----------------|---|
| 3 | GROUND CONTACT | PHOSPHOR BRONZE | ALL OVER Ni 1.00 μm MIN. CONTACT PART Au 0.05 μm MIN. [Ni PLATING AREA] Ni ONLY |
| 2 | CONTACT | PHOSPHOR BRONZE | ALL OVER Ni 1.00 μm MIN. CONTACT PART Au 0.05 μm MIN. |
| 1 | HOUSING | LCP | UL94V-0, BLACK (GF 30%) |

| REV. | ECN | BY | DATE | APP. | APP. | CHK. | DATE | PROJECTION | SERIES No. | TITLE | SCALE | SHEET | REV. |
|-----------------|---------|-----|------------|------|--------------------|-------------|------------------|------------|------------|-------------------------------|-------|-------|------|
| 5 | Z240732 | TOI | 2024/06/10 | Yufu | ANGLE | ±2° | 6 OVER 30 MAX. | ±0.3 | R1 | MHF® 5L PLUG Ni TOP (1.13) | 20:1 | A3 | 5 |
| 4 | Z220704 | TSU | 2022/06/21 | Y.H | 6 MAX. | ±0.2 | 30 OVER 120 MAX. | ±0.5 | | | | | |
| 3 | Z190990 | K.T | 2019/07/30 | Y.S | GENERAL TOLERANCE. | | | | | | | | |
| 2 | Z181728 | M.N | 2018/12/27 | Ken | DWG. | Y.Imaji | DATE | 2016/01/20 | | | | | |
| 1 | Z180759 | M.N | 2018/09/14 | Ken | CHK. | Y.Hashimoto | | | | | | | |
| 0 | Z160045 | Y.I | 2016/01/20 | | APP. | K.Yotsutani | | | | | | | |
| REVISION RECORD | | | | | | | | | DWG. No. | 20668 | | 1/3 | |

| ITEMS | SPECIFICATION |
|--|--|
| RECOMMENDED APPLICABLE CONNECTOR PART No. | 20566-001E-01 |
| RATING VOLTAGE | 60 V AC (R.M.S) |
| RATING FREQUENCY | DC~15 GHz |
| OPERATING TEMPERATURE | 233~363K (-40°C~+90°C) |
| VSWR (MATED WITH SMA ADAPTER PART No. 90543-0001) | 1.30 MAX. AT 0.1~3 GHz, 1.40 MAX. AT 3~6 GHz, 1.50 MAX. AT 6~12 GHz, 1.60 MAX. AT 12~15 GHz |
| MAIN CONTACT RESISTANCE | INITIAL: 20 mohm MAX. / AFTER TEST: Δ R 20 mohm MAX. |
| GROUND CONTACT RESISTANCE | INITIAL: 20 mohm MAX. / AFTER TEST: Δ R 100 mohm MAX. |
| INSULATION RESISTANCE | INITIAL: 500 Mohm MIN. / AFTER TEST: 100 Mohm MIN. |
| DIELECTRIC WITHSTANDING VOLTAGE | 200 V AC, 1 MINUTE |
| DURABILITY | 30 CYCLES |
| UNMATING FORCE (INITIAL / AFTER TEST) | INITIAL: 5 N MIN. / AFTER TEST: 3 N MIN. |
| CRIMP STRENGTH | 10 N MIN. |
| PRODUCT SPECIFICATION | PRS-2192 |
| TEST REPORT | TR-16003 |
| INSTRUCTION MANUAL | HIM-16014 |
| APPEARANCE CRITERIA No. | QLS-A*** |

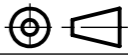
| | | | | | | | | |
|--------------------|---------------|------------------|-----------|---|------------------|---------------|--------------|-----------|
| ANGLE | $\pm 2^\circ$ | 6 OVER 30 MAX. | ± 0.3 | PROJECTION  | SERIES No. R1 | CUSTOMER COPY | | |
| 6 MAX. | ± 0.2 | 30 OVER 120 MAX. | ± 0.5 | | | | | |
| GENERAL TOLERANCE. | | | | TITLE MHF [®] 5L PLUG Ni TOP (1.13) | SCALE - | I-PEX | | |
| DWG. | DATE | | | | | | | |
| CHK. | | | | | | | | |
| APP. | | | | | | | | |
| | | | | DWG. No. | 20668 | SIZE A3 | SHEET 2/3 | REV. 5 |

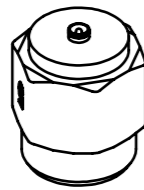

SMA ADAPTOR FOR MHF 5 PLUG
PART NO. 90543-0001

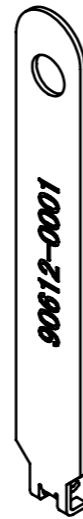

FRONT SIDE

MHF 5 PUSHING AND PULLING TOOL
PART NO. 90612-0001



BACK SIDE

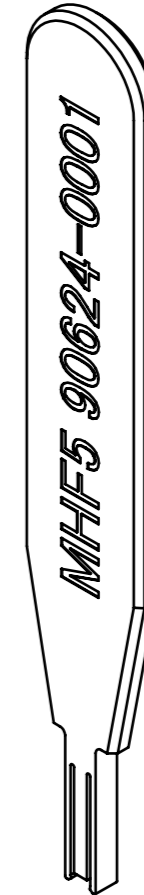

MHF 5 PUSHING TOOL
PART NO. 90624-0001

| | | | | | | | | |
|--------------------|------|------------------|------|--|------------------|----------------------|--------------|-----------|
| ANGLE | ±2° | 6 OVER 30 MAX. | ±0.3 | PROJECTION ⊕ | SERIES No. R1 | CUSTOMER COPY | | |
| 6 MAX. | ±0.2 | 30 OVER 120 MAX. | ±0.5 | | | | | |
| GENERAL TOLERANCE. | | | | TITLE MHF® 5L PLUG Ni TOP (1.13) | SCALE 2:1 | UNIT I-PEX | | |
| DWG. | DATE | | | | | | | |
| CHK. | | | | | | | | |
| APP. | | | | | | | | |
| | | | | DWG. No. | 20668 | SIZE A3 | SHEET 3/3 | REV. 5 |