

Recommended P/N 2574-0\*\*2

PART NO.	Pos.	A	B	C	D
2574-#20#	20	9.78	12.56	16.00	8.00 [= 4.0 × (3-1)]
2574-#30#	30	14.78	17.56	21.00	12.00 [= 4.0 × (4-1)]
2574-#40#	40	19.78	22.56	26.00	16.00 [= 4.0 × (5-1)]
2574-#50#	50	24.78	27.56	31.00	20.00 [= 4.0 × (6-1)]

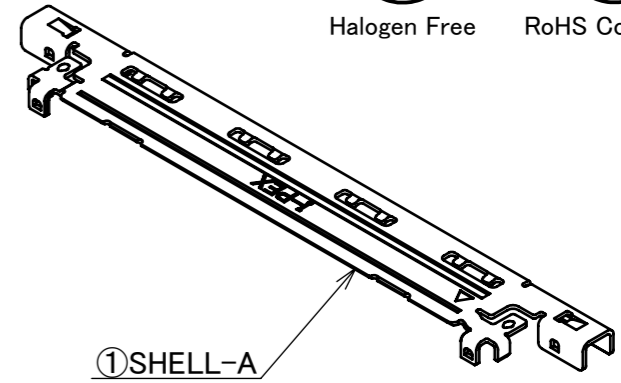

P/N:2574-#\*\*#  
 SEE TABLE.1  
 Pos.  
 0 : WITH DATUM MARK  
 1 : WITHOUT DATUM MARK



TOP VIEW

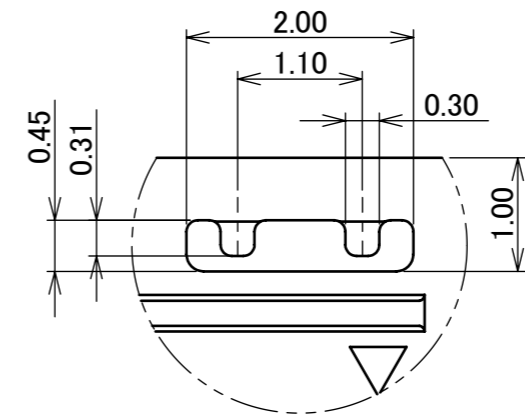
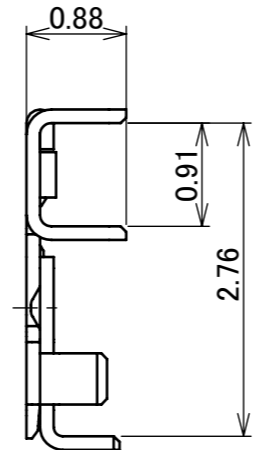
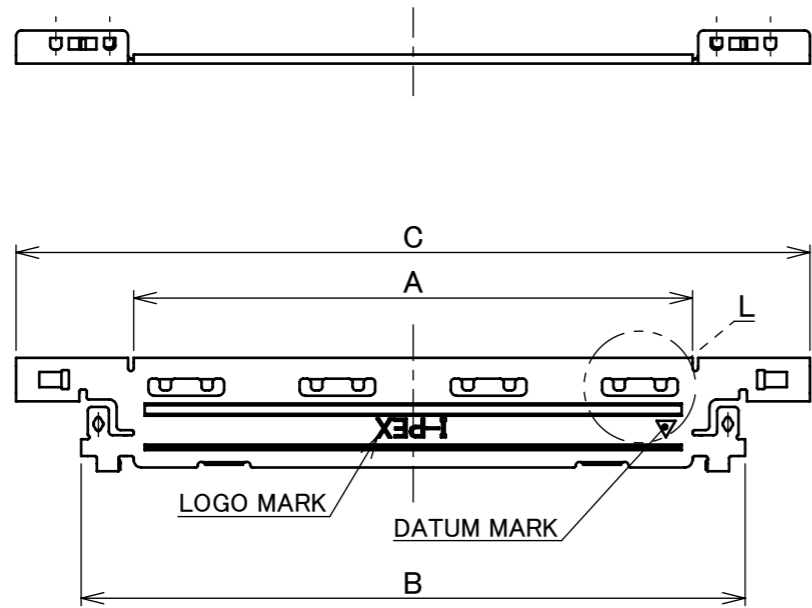

DETAIL L  
S= 15 : 1

BOTTOM VIEW

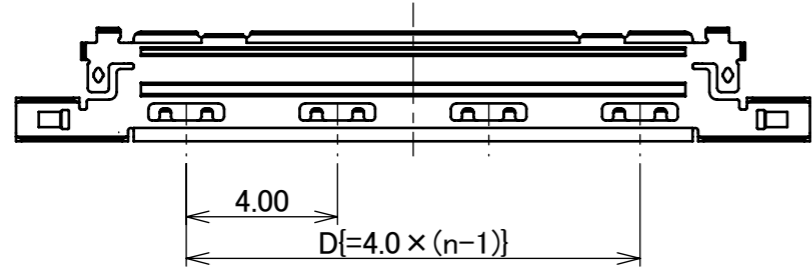

TABLE.1

PART NO.	SHELL-A FINISH
2574-***	TOP SIDE : Au 0.05 μm MIN. OVER Ni 1.00 μm MIN. BOTTOM SIDE : Au 0.015 μm MIN. OVER Ni 1.00 μm MIN.
2574-***2	TOP SIDE : Au 0.03 μm MIN. OVER Ni 1.00 μm MIN. BOTTOM SIDE : Ni 1.00 μm MIN. (THERE IS THE POSSIBILITY THAT Au ATTACHES RANDOMLY)

NO.	DISCRIPTION	MATERIAL	FINISH , REMARKS
1	SHELL A	PHOSPHOR BRONZE	SEE ABOVE TABLE.1

15	Z221440	T.Ono	Dec./20/'22	H.I	ANGLE	±2°	6 OVER 30 MAX.	±0.3	PROJECTION ⊕	SERIES No. R3	CUSTOMER COPY	
14	Z201153	T.Ono	Nov./05/'20	H.I	6 MAX.	±0.2	30 OVER 120 MAX.	±0.5				
13	Z191177	R.M	Sept./16/'19	H.I	GENERAL TOLERANCE.			TITLE CABLINE® -VS PLUG SHELL-A	SCALE 5:1	UNIT mm	I-PEX	
12	Z180941	A.K	July/18/'18	H.I	DWG.	DATE						
11	Z180796	A.K	June/20/'18	H.I	H.Ikari		2008/04/16					
10	Z151047	H.I	Sept./23.'15	Y.S	CHK.							
REV.	ECN	BY	DATE	APP.	APP.	E.Kawabe		DWG. No.	2574	SIZE	SHEET	REV.
REVISION RECORD								A3	1/2	15		

PATENT REGISTERED

PART NO.	E	F	QTY. PER EMBOSS REEL (PIECES / REEL)	QTY. PER PACKING CARTON (REELS / CARTON)	PACKING STANDARD
2574-#20#	30	23	5000 PIECES / REEL	3 REELS / CARTON = 15000	300-642
2574-#30#	35	28			
2574-#40#	40	33			
2574-#50#	45	38			

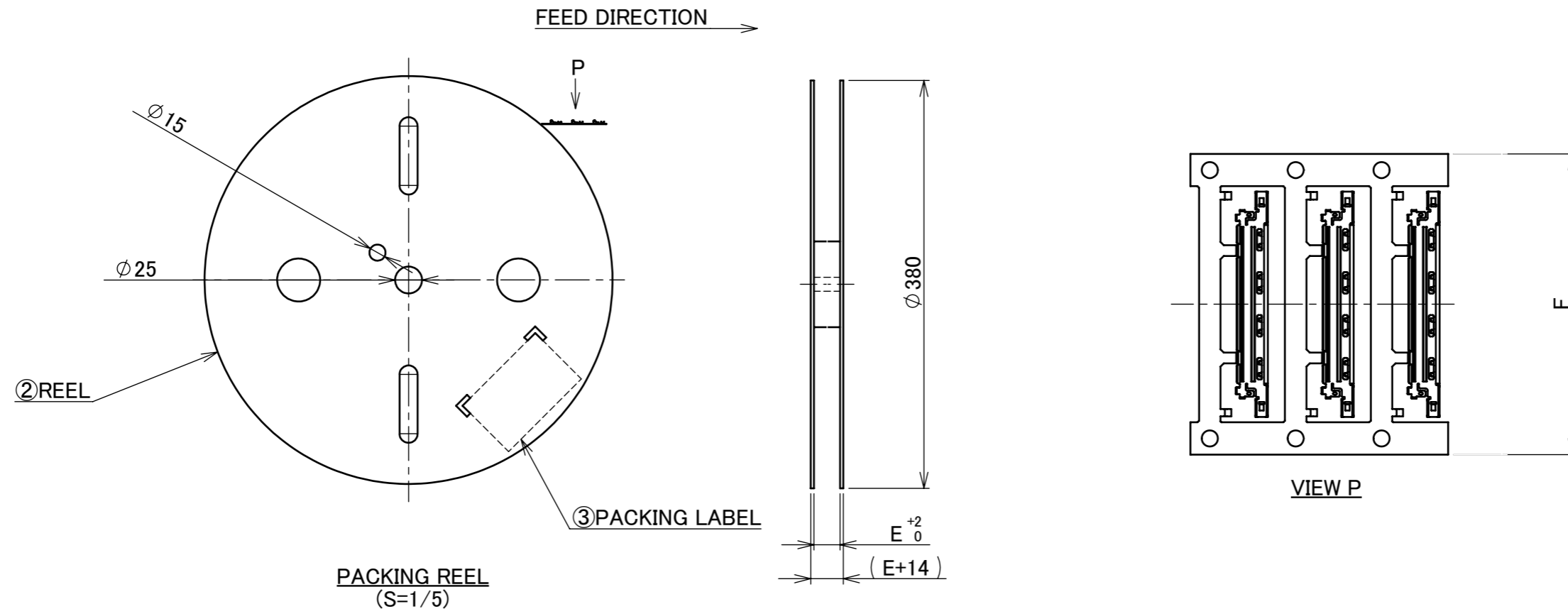

NO.	DISCRIPTION	MATERIAL	FINISH , REMARKS
3	PACKING LABEL	-	-
2	REEL	CARDBOARD	-

ANGLE	±2°	6 OVER 30 MAX.	±0.3	PROJECTION	SERIES No.	CUSTOMER COPY		
6 MAX.	±0.2	30 OVER 120 MAX.	±0.5		R3	<b>I-PEX</b> SCALE 5:1 UNIT mm SIZE A3 SHEET 2/2 REV. 15		
GENERAL TOLERANCE.								
DWG.	DATE							
CHK.								
APP.	DWG. No. 2574							