

Recommended P/N 3049-0**1

PART No.	A	B
3049-0301	19.30	17.56
3049-0401	24.30	22.56

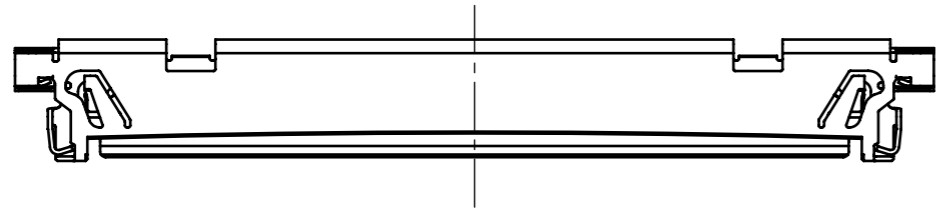
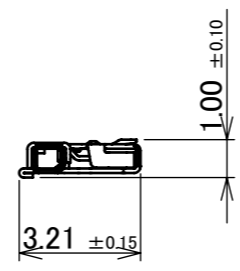
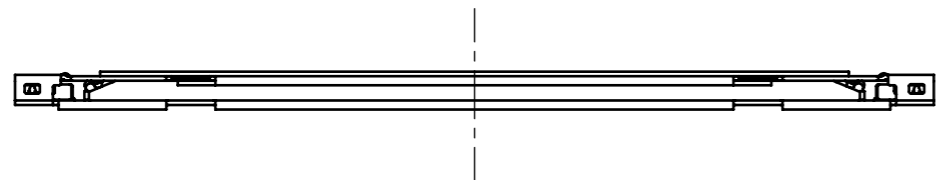
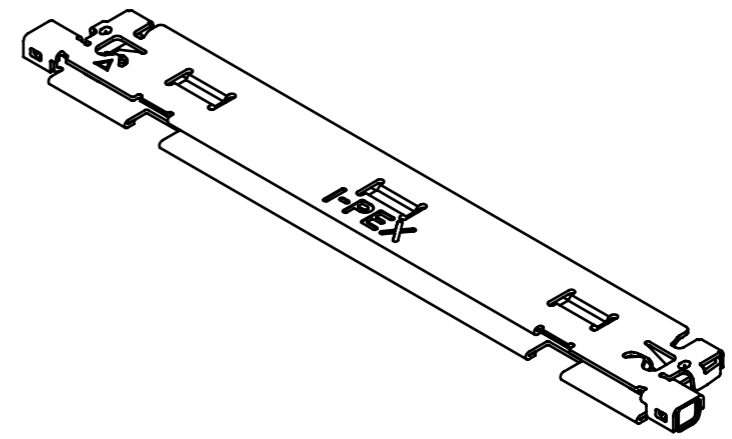
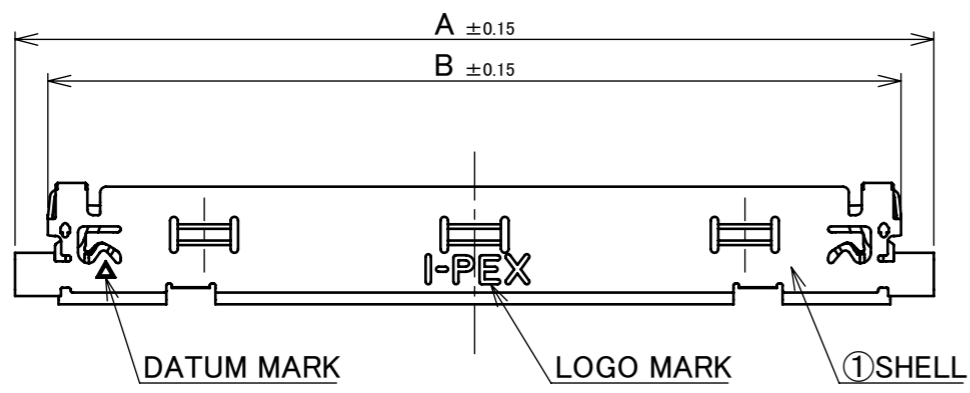
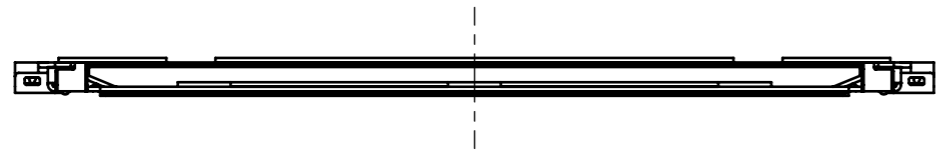

1	SHELL	PHOSPHOR BRONZE	ALL OVER Ni 1.00 μm MIN. CONTACT & SOLDERING AREA : Au 0.01 μm MIN.
NO.	DISCRIPTION	MATERIAL	FINISH , REMARKS

5	Z181328	Y.Sasa	Nov./19/'18	H.I	ANGLE	±2°	6 OVER 30 MAX.	±0.3	PROJECTION ⊕	SERIES No. R1	CUSTOMER COPY	
4	Z180898	Y.Sasa	Sept./13/'18	H.I	6 MAX.	±0.2	30 OVER 120 MAX.	±0.5				
3	Z141448	H.A	Dec./18/'14	E.K	GENERAL TOLERANCE.			TITLE	CABLINER [®] -VSF SHELL	SCALE 5:1 UNIT mm SIZE A3		
2	Z141273	H.A	Nov./07/'14	E.K	DWG.	DATE		2014/04/23				
1	Z141234	H.A	Oct./28/'14	E.K	CHK.	DATE						2014/04/24
0	Z140398	H.A	Apr./23/'14		APP.	DATE		2014/04/25				
REV.	ECN	BY	DATE	APP.	E.Kawabe		DATE		DWG. No.	3049	SHEET 1/5	REV. 5

POS.	A	B	C	D
30	19.30	17.56	14.50	15.30
40	24.30	22.56	19.50	20.30

FPC ASS'Y STATE

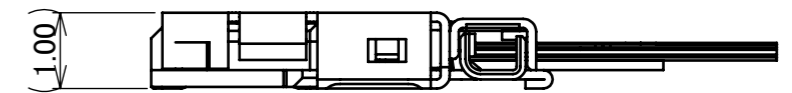
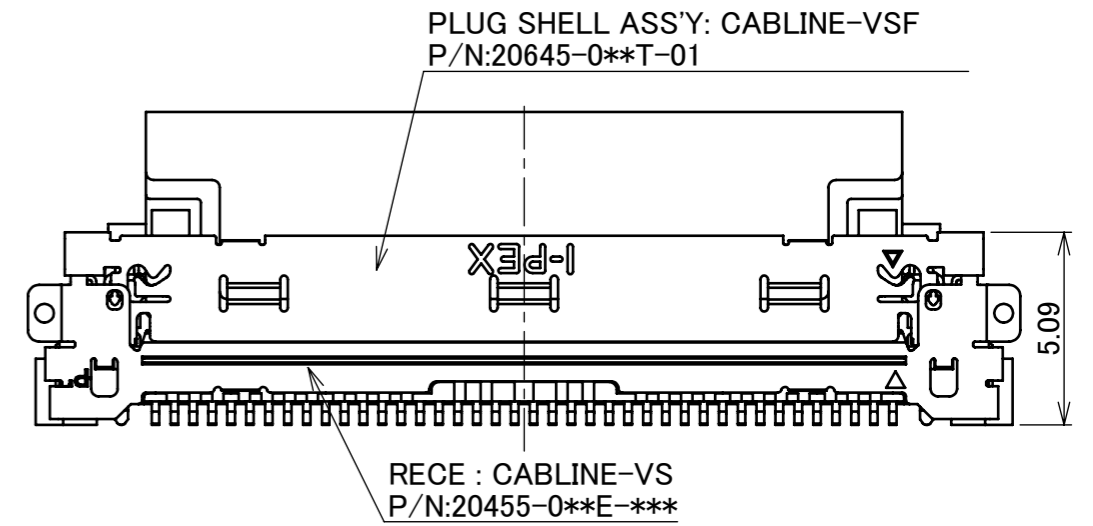
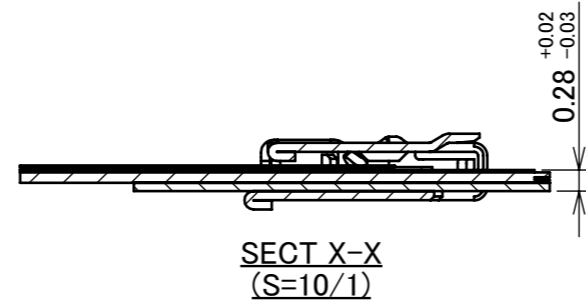
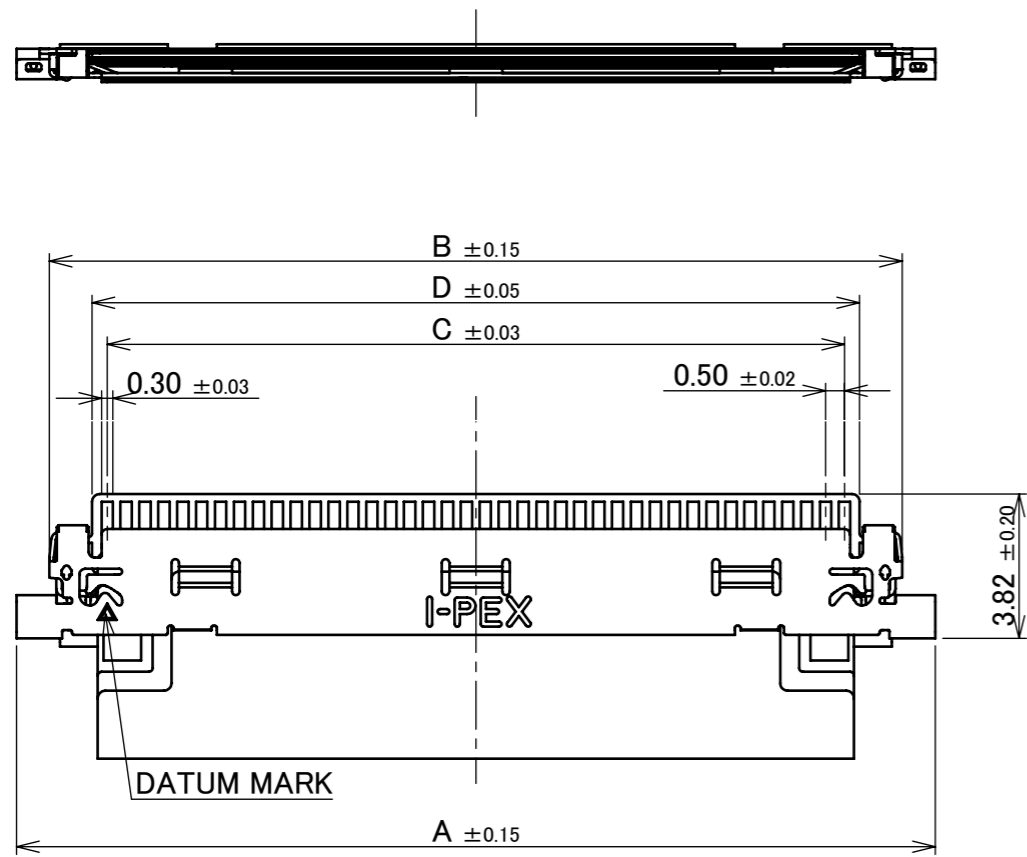

MATING CONDITION

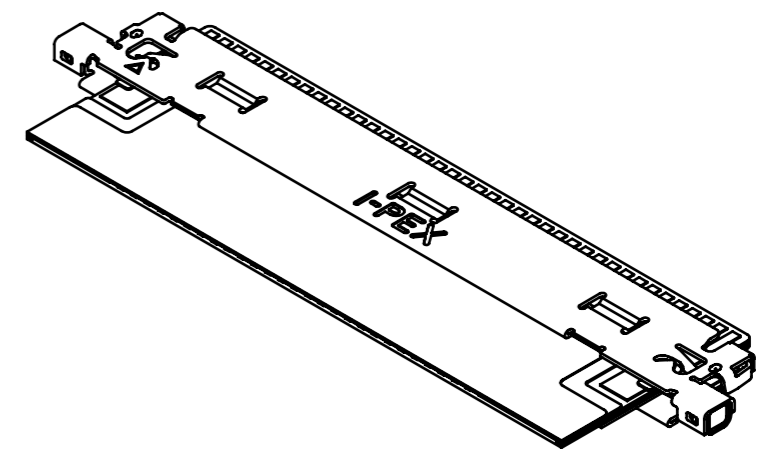
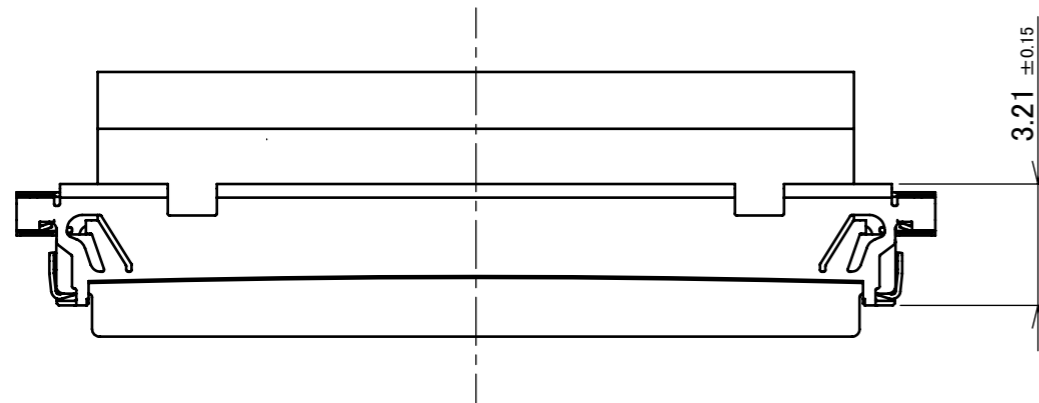
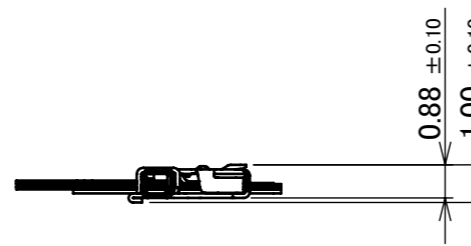
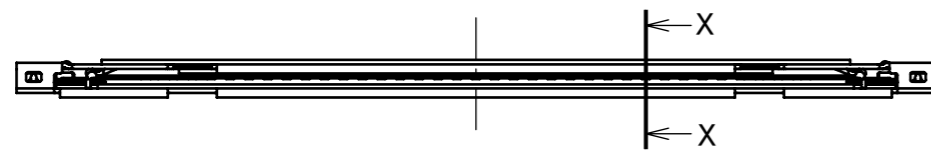

ANGLE	±2°	6 OVER 30 MAX.	±0.3	PROJECTION ⊕	SERIES No. R1	CUSTOMER COPY
	6 MAX.	±0.2	30 OVER 120 MAX.			
GENERAL TOLERANCE.				TITLE		SCALE
DWG.	DATE			CABLINE®-VSF SHELL		5:1
CHK.	DATE					UNIT
APP.	DATE			DWG. No. 3049		mm
						SIZE
						A3
						SHEET 2/5
						REV. 5



ITEMS	SPECIFICATION
RATING VOLTAGE	100V AC (PER CONTACT)
RATING AMPERAGE (FOR SIGNAL CONTACT)	0.3A AC/DC (PER CONTACT)
OPERATING TEMPERATURE	233~358K(-40°C~+85°C)
OPERATING HUMIDITY	85% MAX.(NON-CONDENSING)
CONTACT RESISTANCE (FOR SIGNAL CONTACT)	INITIAL : 60mohm MAX. / AFTER TEST : \triangleleft 40mohm MAX.
GROUND SHELL RESISTANCE	INITIAL : 60mohm MAX. / AFTER TEST : \triangleleft 40mohm MAX.
INSULATION RESISTANCE	INITIAL : 1000Mohm MIN. / AFTER TEST : 500Mohm MIN.
DIELECTRIC WITHSTANDING VOLTAGE	AC250V 1min
DURABILITY	30 CYCLES
MATING FORCE (INITIAL / AFTER TEST)	30P : 24.0N MAX. / 40P : 32.0N MAX.
UNMATING FORCE (INITIAL / AFTER TEST)	30P : 1.1N MIN. / 40P : 1.4N MIN.
PRODUCT SPECIFICATION	PRS-1878
TEST REPORT	TR-14095 (CABLINÉ-VS Receptacle : 20455-0**E-#2#) TR-17048 (CABLINÉ-VS Receptacle : 20455-0**E-#9#)
PACKING STANDARD	PST-13043
INSTRUCTION MANUAL	HIM-13010
ASSEMBLY MANUAL	ASM-13003

ANGLE	$\pm 2^\circ$	6 OVER 30 MAX.	± 0.3	PROJECTION 	SERIES No. R1	CUSTOMER COPY
6 MAX.	± 0.2	30 OVER 120 MAX.	± 0.5			
GENERAL TOLERANCE.				TITLE CABLINÉ [®] -VSF SHELL	SCALE 5:1 UNIT mm SIZE A3	
DWG.	DATE					
CHK.	DATE					
APP.	DATE					
				DWG. No.	3049	SHEET 3/5 REV. 5

POS.	C	D	E	F
30	14.50	15.30	17.20	15.00
40	19.50	20.30	22.20	20.00

RECOMMENDED FPC DIMENSION

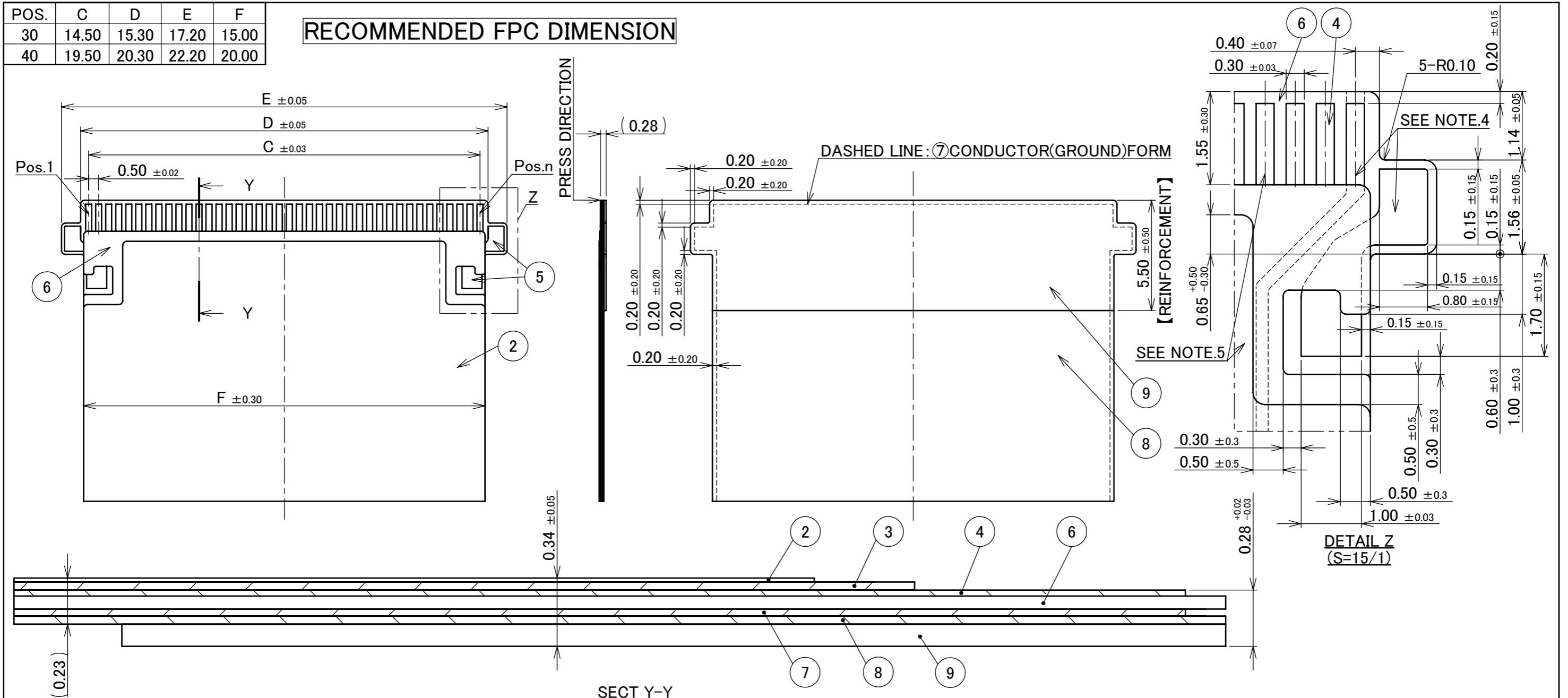

2	SHIELD FILM	-	-
3	INSULATOR	-	-
4	CONDUCTOR(SIGNAL)	Cu	Ni , Au
5	CONDUCTOR(GROUND)	Cu	Ni , Au
6	INSULATOR	-	-
7	CONDUCTOR(GROUND)	Cu	-
8	INSULATOR	-	-
9	REINFORCING TAPE	-	-
No.	DESCRIPTION	MATERIAL	PLATING

- NOTES.
- ADHESIVE SHOULD USE THERMOSETTING.
 - No.5: CONDUCTOR(GROUND) AND No.7: CONDUCTOR(GROUND) ARE CARRYING OUT THE ELECTRICAL CONNECTION.
 - No.2: SHIELD FILM AND No.7: CONDUCTOR(GROUND) ARE CARRYING OUT THE ELECTRICAL CONNECTION.
 - No.4: CONDUCTOR(SIGNAL) AND No.5,7: CONDUCTOR(GROUND) ARE NOT CONTACTING.
 - No.4: CONDUCTOR(SIGNAL) AND No.2: SHIELD FILM ARE NOT CONTACTING.

ANGLE	±2°	6 OVER 30 MAX.	±0.3	PROJECTION ⊕	SERIES No. R1	CUSTOMER COPY
	6 MAX.	±0.2	30 OVER 120 MAX.			
GENERAL TOLERANCE.				TITLE		SCALE
DWG.	DATE	CABLIN [®] -VSF SHELL		5:1		
CHK.	DATE	DWG. No.		UNIT		
APP.	DATE	3049		mm		
				SIZE		A3
				SHEET		4/5
				REV.		5

PART NO.	G	H	QTY. PER REEL (PIECES/ REEL)	QTY. PER PACKING CARTON (REELS / P CARTON)
3049-0301	35.00	29.00	5000 PIECES / REEL	3 REELS/ P CARTON = 15000
3049-0401	40.00	34.00		

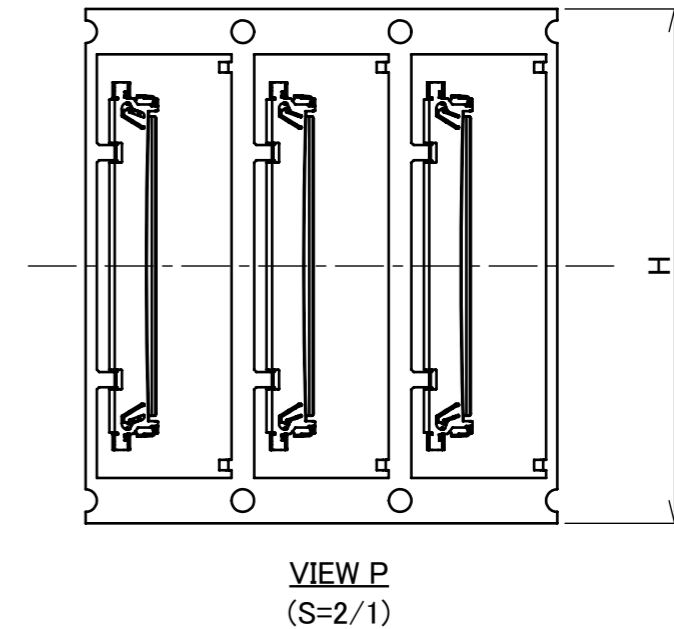
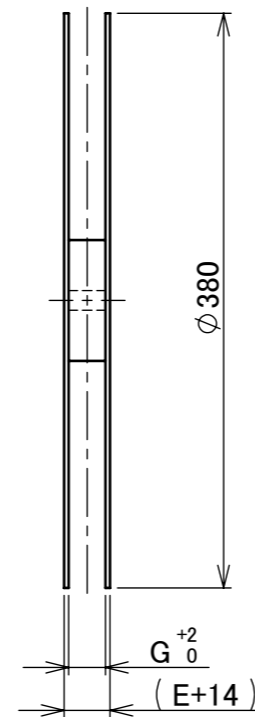
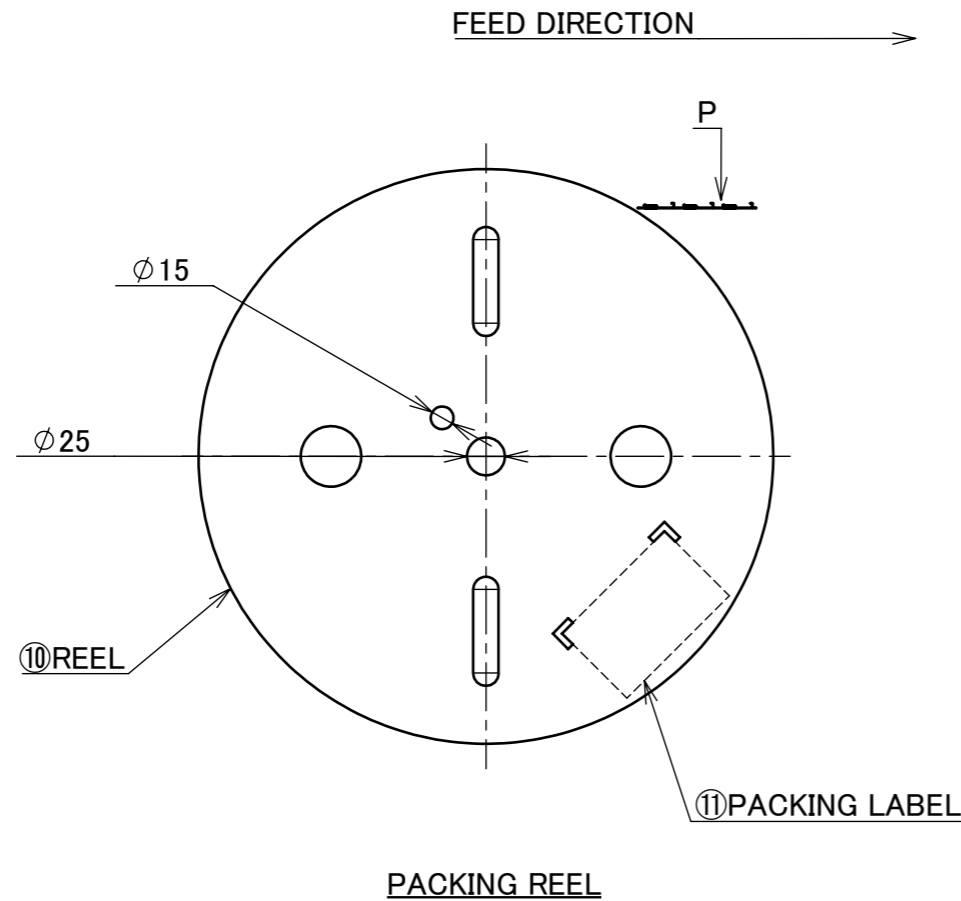

10	REEL	CARDBOARD	-
11	PACKING LABEL	-	-
NO.	DISCRIPTION	MATERIAL	FINISH , REMARKS

ANGLE	±2°	6 OVER 30 MAX.	±0.3	PROJECTION ⊕	SERIES No. R1	CUSTOMER COPY
6 MAX.	±0.2	30 OVER 120 MAX.	±0.5			
GENERAL TOLERANCE.				TITLE CABLIN [®] -VSF SHELL	SCALE 1:5	UNIT mm
DWG.	DATE					
CHK.	DATE					
APP.	DATE					
DWG. No. 3049				SIZE A3	SHEET 5/5	REV. 5