

Recommended P/N

2766-0**1

PART NO.	A	B
2766-0101	8.65	9.85
2766-0121	9.45	10.65
2766-0201	12.65	13.85
2766-0301	16.65	17.85
2766-0401	20.65	21.85
2766-0501	24.65	25.85
2766-0601	28.65	29.85

P/N: 2766-0 ** 1

POS.

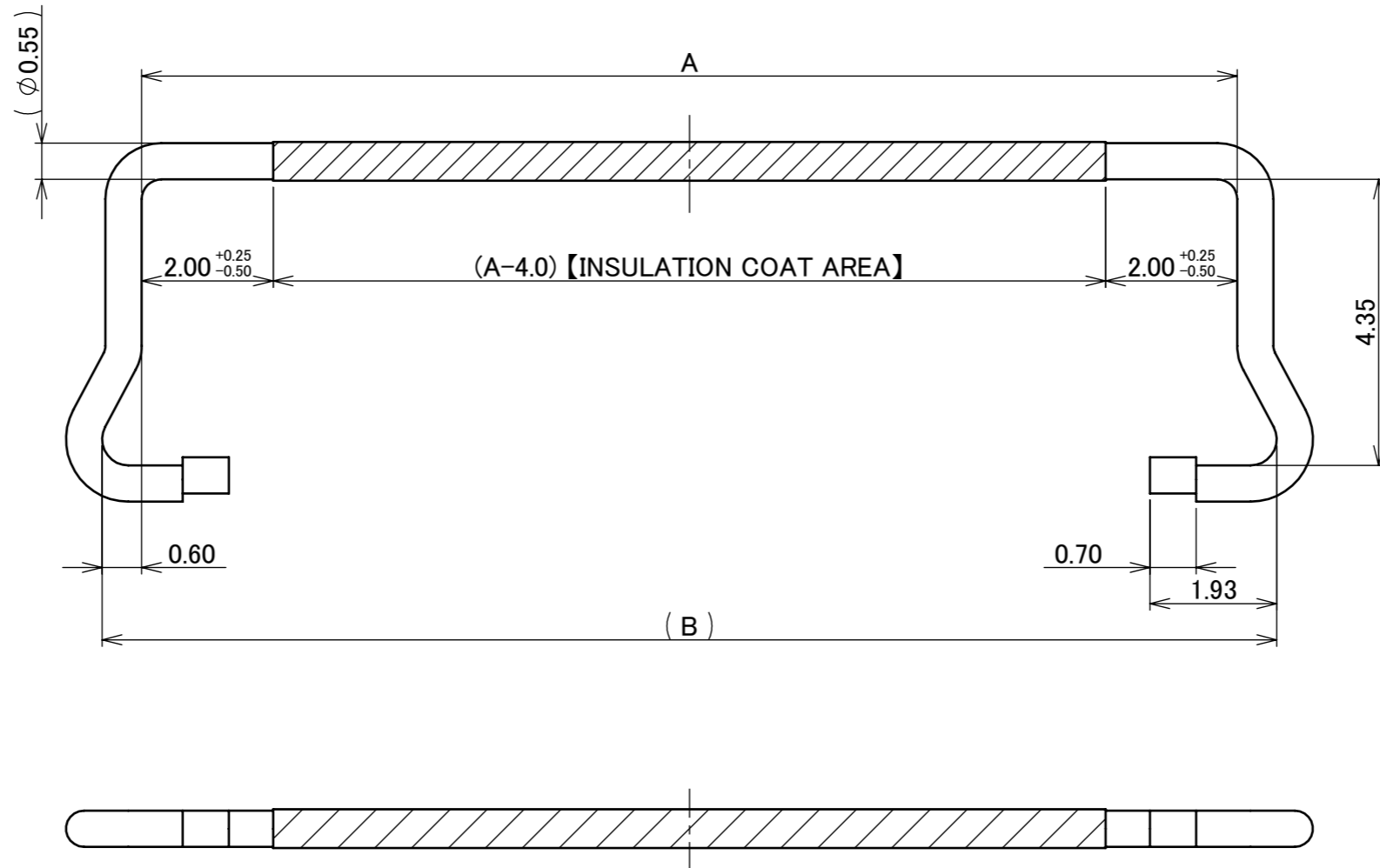
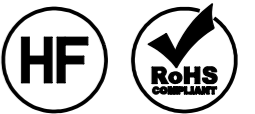

NO.	DISCRIPTION	MATERIAL	FINISH , REMARKS
1	PULL BAR	SUS	-

REV.	ECN	BY	DATE	APP.	APP.	DATE	DWG. No.	TITLE	SCALE	SHEET	REV.	
14	Z191176	Y.Sasa	Sept./06/'19	H.I	ANGLE	±2°	6 OVER 30 MAX.	±0.3	PROJECTION R4	CUSTOMER COPY	I-PEX	
13	Z181443	K.Hara	Nov./05/'18	Y.S	6 MAX.	±0.2	30 OVER 120 MAX.	±0.5				
12	Z180722	M.N	June/05/'18	Y.S	GENERAL TOLERANCE.			CABLIN [®] -CA PLUG PULL BAR				5:1
11	Z161117	K.B	Sept./07/'16	J.T	DWG.	T.K	DATE					Nov./13/'09
10	Z150570	T.K	May/26/'15	E.K	CHK.	Y.H	DATE	Nov./16/'09	A3	1/2	14	
9	Z150286	K.B	Mar./13/'15	E.K	APP.	T.H	DATE	Nov./18/'09	2766			
REVISION RECORD												

PART NO.	C	QTY. IN STICK (PIECES / STICK)	QTY. IN CARTON (STICKS / CARTON)	QTY. PER SHIPPING CARTON (PIECES / CARTON)	QTY. PER PACKING CARTON (PIECES / CARTON)	PACKING STANDARD
2766-0101	18.0	500	30	500 × 30 = 15000	60000 (4 BOXES)	300-823
2766-0121	18.8					
2766-0201	22.0					
2766-0301	26.0					
2766-0401	30.0					
2766-0501	34.0					
2766-0601	38.0					

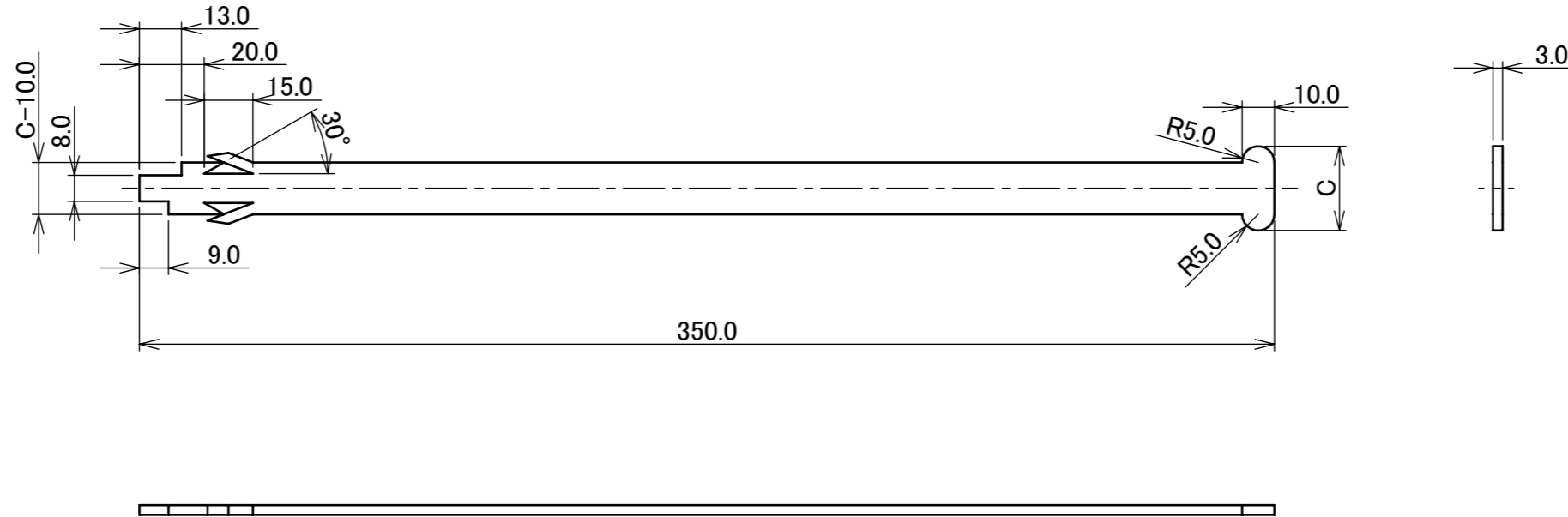

2	STICK	PP	
NO.	DISCRIPTION	MATERIAL	FINISH , REMARKS
ANGLE	±2°	6 OVER 30 MAX.	±0.3
6 MAX.	±0.2	30 OVER 120 MAX.	±0.5
GENERAL TOLERANCE.		PROJECTION	SERIES No.
DWG.	DATE		R4
CHK.	DATE	TITLE	
APP.	DATE	CABLIN [®] -CA PLUG PULL BAR	
		DWG. No.	SCALE
		2766	1:2
			UNIT
			mm
			SIZE
			A3
			SHEET 2/2
			REV. 14