

Recommended P/N 20634-1**T-02(12~60P) 20634-210T-02(10P)

PART NO.	Pos.	A	B	C	D	E	F	G	H	J	K
20634-#10T-02	10	5.10	4.65	4.30	3.60	4.40	6.66	9.40	3.40	-	-
20634-#12T-02	12	5.90	5.45	5.10	4.40	5.20	7.46	10.20	4.10	-	-
20634-#20T-02	20	9.10	8.65	8.30	7.60	8.40	10.66	13.40	-	5.00	-
20634-#30T-02	30	13.10	12.65	12.30	11.60	12.40	14.66	17.40	4.00	8.00	4.00
20634-#40T-02	40	17.10	16.65	16.30	15.60	16.40	18.66	21.40	8.00	12.00	4.00
20634-#50T-02	50	21.10	20.65	20.30	19.60	20.40	22.66	25.40	12.00	16.00	4.00
20634-#60T-02	60	25.10	24.65	24.30	23.60	24.40	26.66	29.40	16.00	20.00	4.00

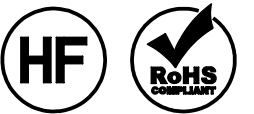

P/N : 20634- # ** T-02
 POS.
 SEE TABLE.1

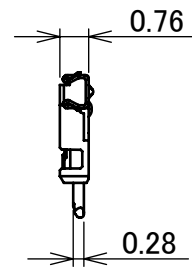
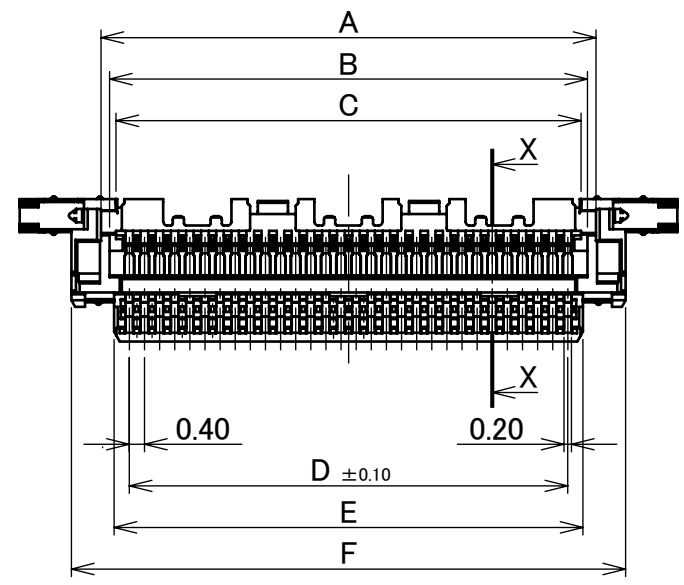
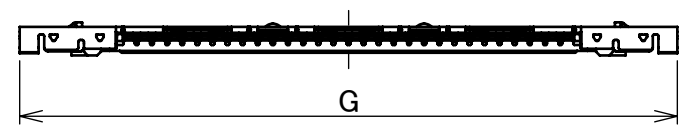
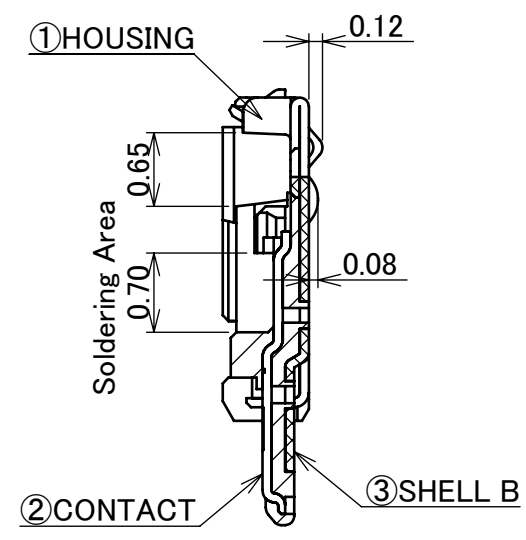
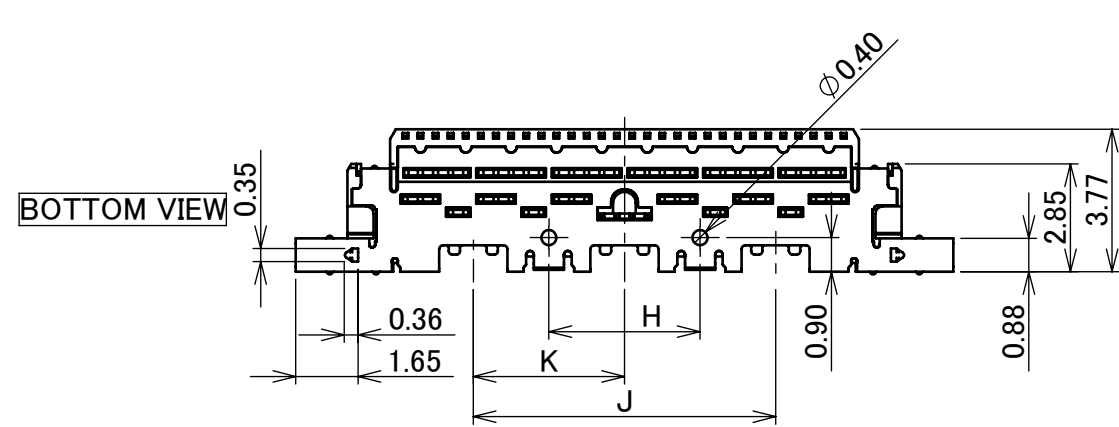
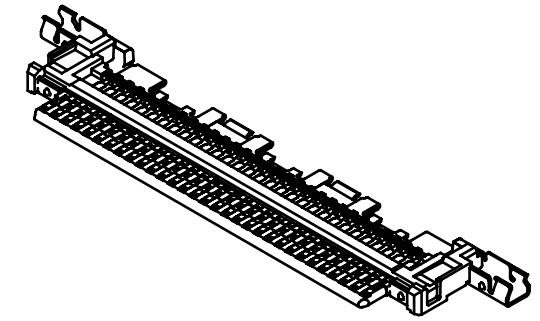

NOTES
 1. THIS PART IS ASSEMBLED WITH SHELL A(P/N 2764-0**1-00#)
 AND PULL BAR(P/N 2766-0**1) AFTER SOLDERED THE CABLE,
 AND IT BECOMES P/N 20633-***T-0#S

TABLE.1

PART NO.	CONTACT FINISH	SHELL B FINISH
20634-1**T-02	CONTACT AREA Au 0.1 μm MIN. OVER Ni 1.00 μm MIN. SOLDERING AREA Au 0.05 μm MIN. OVER Ni 1.00 μm MIN.	TOP SIDE Ni 1.00 μm MIN.(THERE IS THE POSSIBILITY THAT Au ATTACHES RANDOMLY) BOTTOM SIDE Au 0.03 μm MIN. OVER Ni 1.00 μm MIN.
20634-2**T-02	CONTACT AREA Au 0.03 μm MIN. OVER Ni 1.00 μm MIN. SOLDERING AREA Au 0.03 μm MIN. OVER Ni 1.00 μm MIN.	PARTIAL Au 0.003 μm MIN. OVER Ni 1.00 μm MIN.

NO.	DISCRIPTION	MATERIAL	FINISH , REMARKS
3	SHELL-B	PHOSPHOR BRONZE	SEE ABOVE TABLE.1
2	CONTACT	PHOSPHOR BRONZE	SEE ABOVE TABLE.1
1	HOUSING	LCP	UL94V-0, BLACK

REV.	ECN	BY	DATE	APP.	APP.	DATE	PROJECTION	SERIES No.	TITLE	SCALE	SHEET	REV.
11	Z210833	M.N	July/26/'21	H.I	ANGLE	±2°	6 OVER 30 MAX.	±0.3	CABLINER [®] -CA PLUG HOUSING ASSY	5:1	mm	11
10	Z200544	Y.Sasa	May/27/'20	H.I	6 MAX.	±0.2	30 OVER 120 MAX.	±0.5				
9	Z191176	Y.Sasa	Sept./06/'19	H.I	GENERAL TOLERANCE.							
8	Z190050	M.N	Jan./15/'19	Y.S	DWG.	H.Mashima	DATE	2014/08/11				
7	Z181443	K.Hara	Nov./05/'18	Y.S	CHK.	J.Tateishi	DATE	2014/08/11				
6	Z180930	M.N	July/17/'18	H.I	APP.	E.Kawabe	DATE	2014/08/18				
REVISION RECORD							20634		A3		1/4	

PART NO.	QTY. IN DITCH (PIECES / DITCH)	QTY. IN TRAY (PIECES / TRAY)	QTY. IN CARTON (TRAYS / CARTON)	QTY. PER SHIPPING CARTON (PIECES / CARTON)	QTY. PER PACKING CARTON (PIECES / CARTON)	PACKING STANDARD
20634-#10T-02	1	200	20	20 / CARTON = 4000	16000 (4BOXES)	300-821

FOR 10P

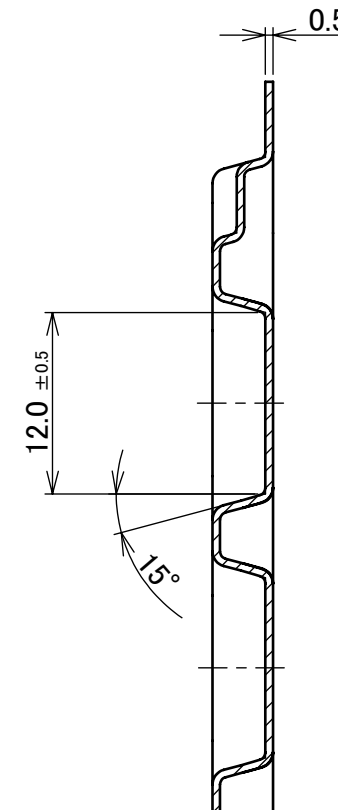
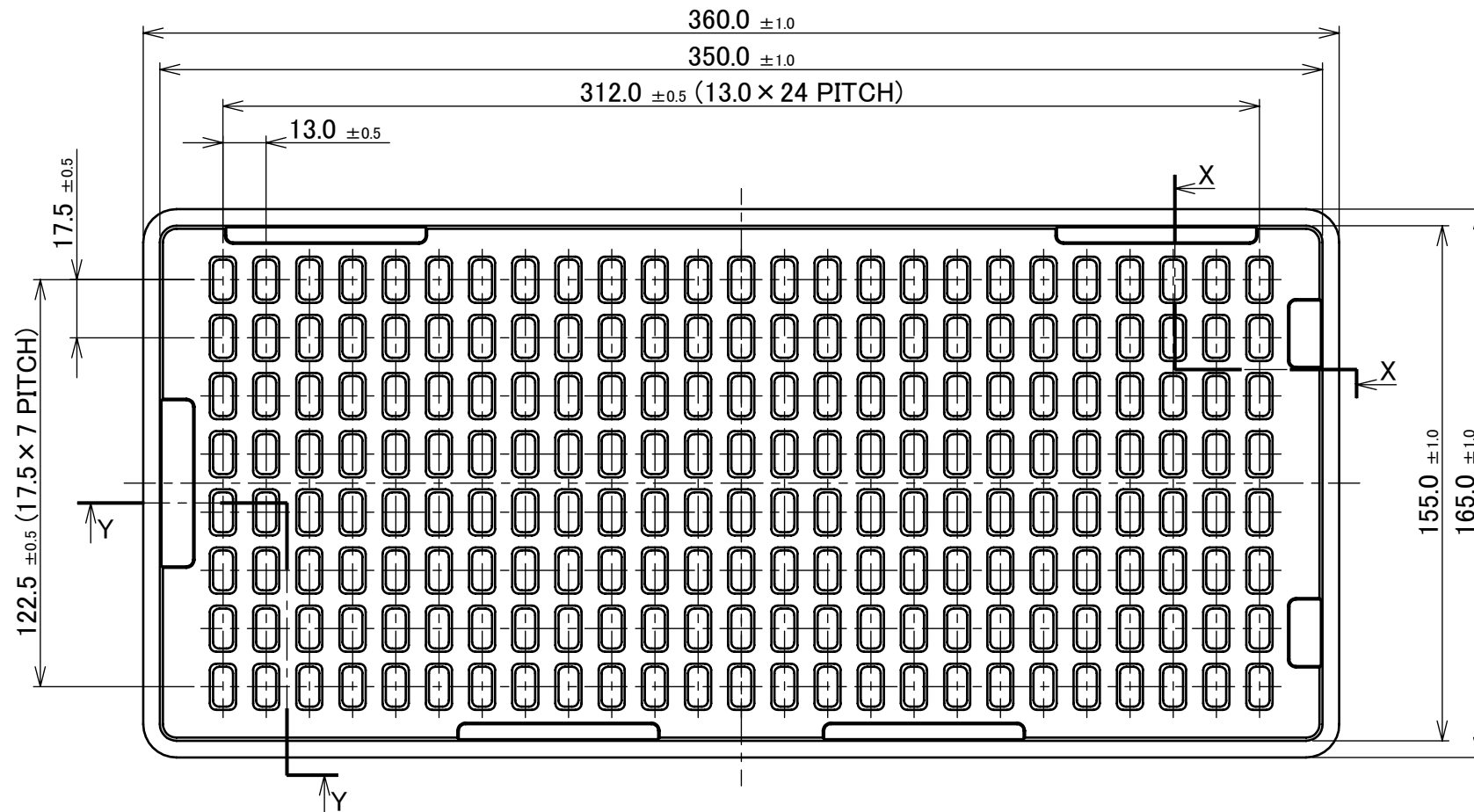

SECT. X-X
(S=2/1)

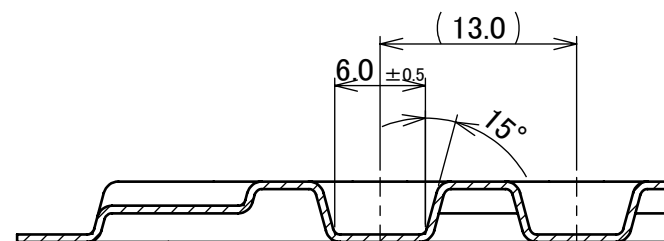
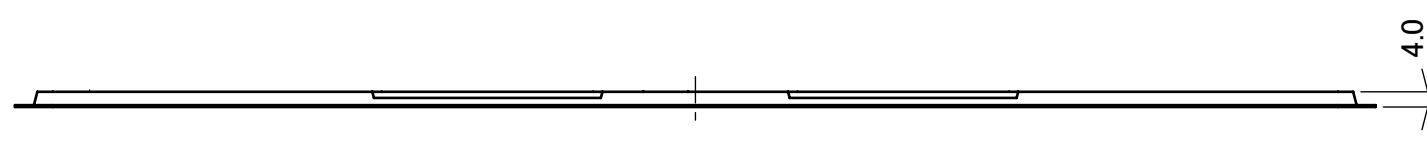

SECT. Y-Y
(S=2/1)

4	TRAY	PS	ANTI-STATIC TYPE
NO.	DISCRIPTION	MATERIAL	FINISH , REMARKS

ANGLE	±2°	6 OVER 30 MAX.	±0.3	PROJECTION ⊕	SERIES No. R1	CUSTOMER COPY
6 MAX.	±0.2	30 OVER 120 MAX.	±0.5			
GENERAL TOLERANCE.				TITLE CABLINE® -CA PLUG HOUSING ASSY	SCALE 1:2	UNIT mm
DWG.	DATE					
CHK.						
APP.						
DWG. No. 20634				SIZE A3	SHEET 2/4	REV. 11

PART NO.	QTY. IN DITCH (PIECES / DITCH)	QTY. IN TRAY (PIECES / TRAY)	QTY. IN CARTON (TRAYS / CARTON)	QTY. PER SHIPPING CARTON (PIECES / CARTON)	QTY. PER PACKING CARTON (PIECES / CARTON)	PACKING STANDARD
20634-#12T-02	1	100	20	20 / CARTON = 2000	8000 (4BOXES)	300-821
20634-#20T-02						
20634-#30T-02						
20634-#40T-02						
20634-#50T-02						

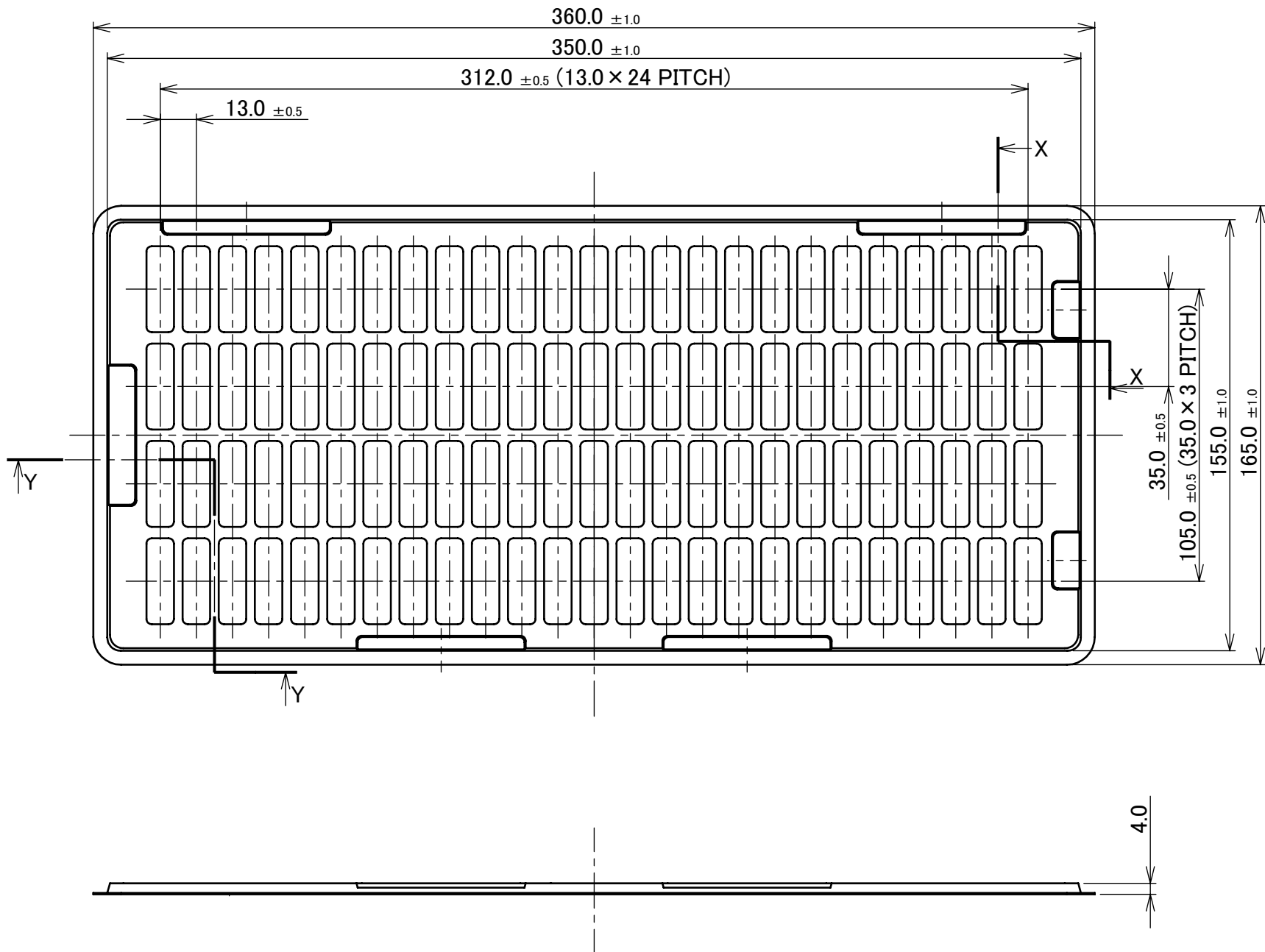

FOR 12,20,30,40,50P

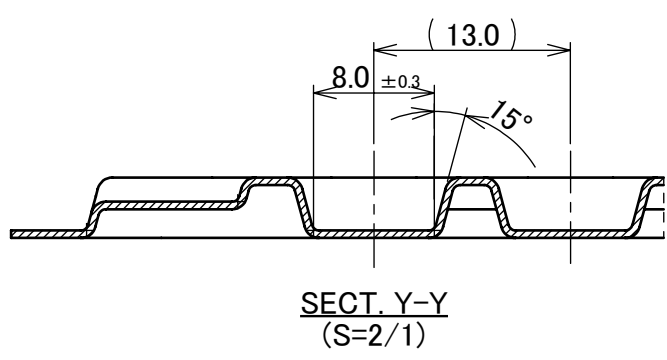
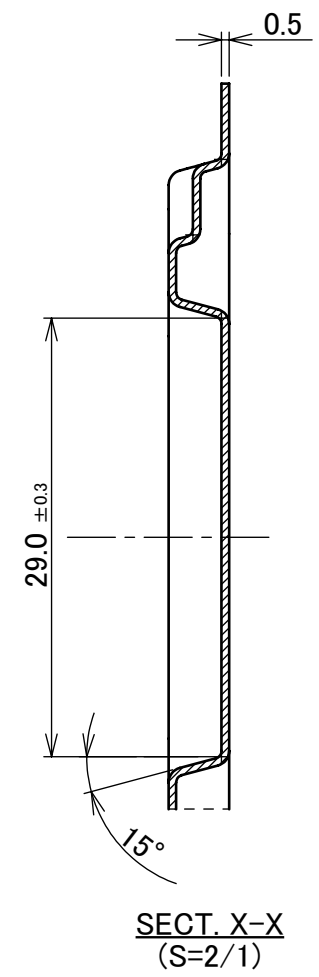

5	TRAY	PP	ANTI-STATIC TYPE
NO.	DISCRIPTION	MATERIAL	FINISH , REMARKS
ANGLE	±2°	6 OVER 30 MAX.	±0.3
6 MAX.	±0.2	30 OVER 120 MAX.	±0.5
GENERAL TOLERANCE.		PROJECTION	SERIES No.
DWG.	DATE	R1	CUSTOMER COPY
CHK.		TITLE	SCALE
APP.		CABLIN® -CA PLUG HOUSING ASSY	1:2
		DWG. No.	UNIT
		20634	mm
		SIZE	SHEET
		A3	3/4
		REV.	11

PART NO.	QTY. IN DITCH (PIECES / DITCH)	QTY. IN TRAY (PIECES / TRAY)	QTY. IN CARTON (TRAYS / CARTON)	QTY. PER SHIPPING CARTON (PIECES / CARTON)	QTY. PER PACKING CARTON (PIECES / CARTON)	PACKING STANDARD
20634-#60T-02	1	100	20	20 / CARTON = 2000	8000 (4BOXES)	300-821

FOR 60P

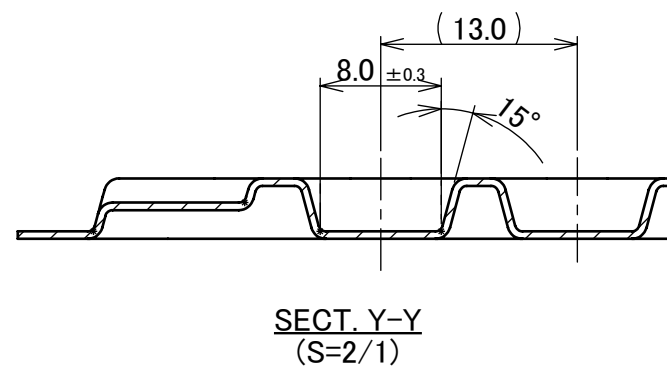
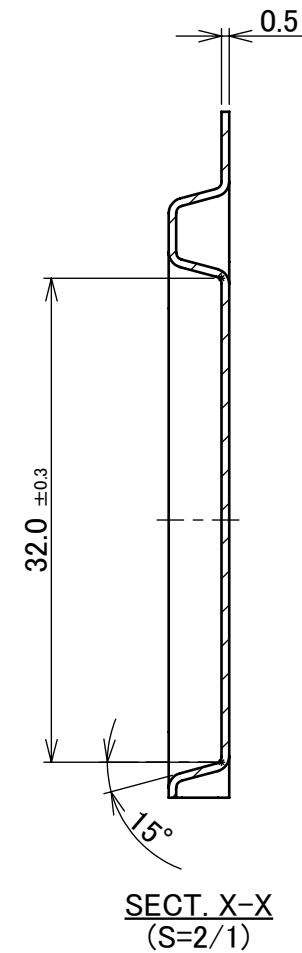
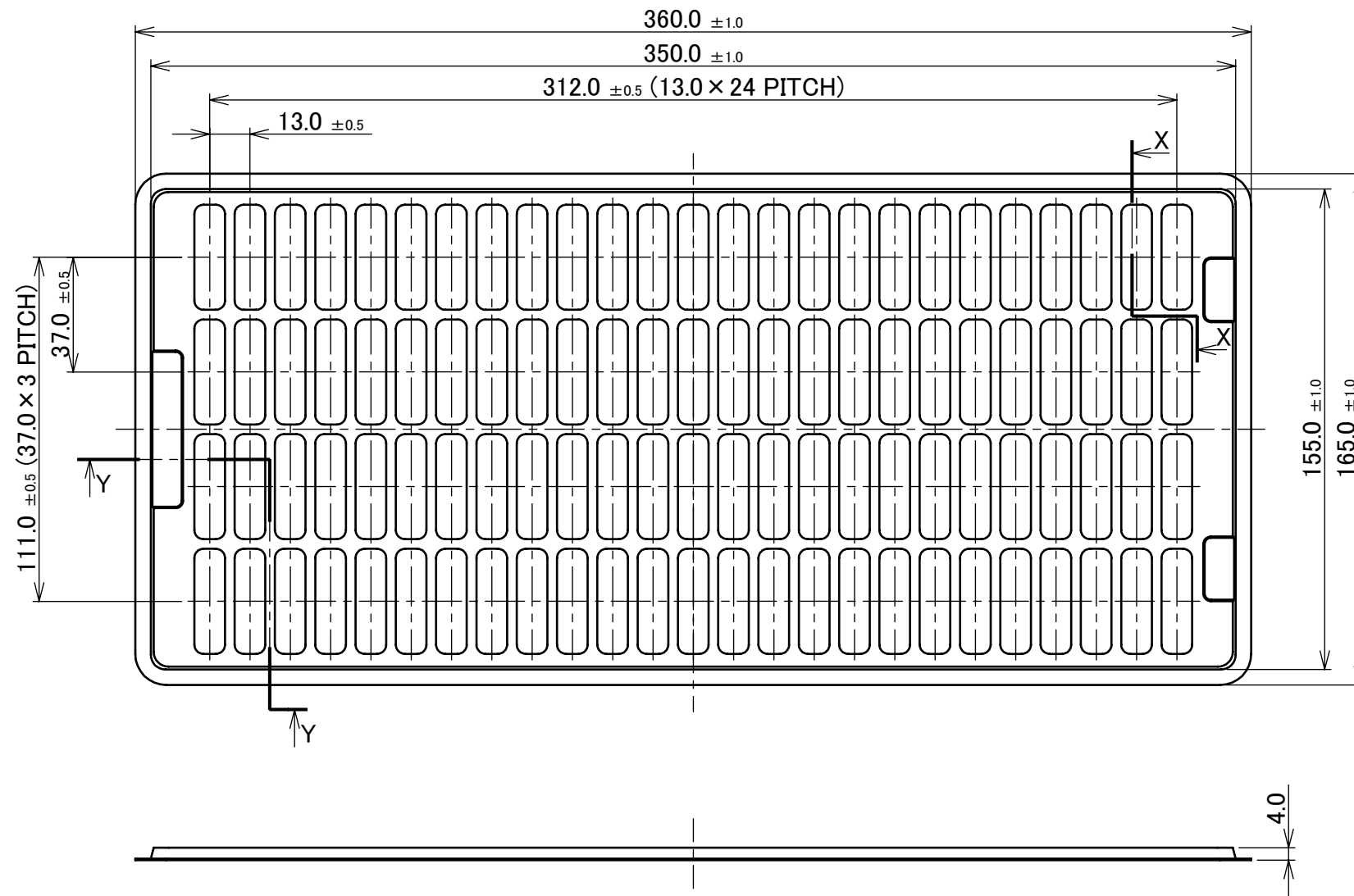

6	TRAY	PS	ANTI-STATIC TYPE
NO.	DISCRIPTION	MATERIAL	FINISH , REMARKS

ANGLE	±2°	6 OVER 30 MAX.	±0.3	PROJECTION	SERIES No.	CUSTOMER COPY
6 MAX.	±0.2	30 OVER 120 MAX.	±0.5		R1	
GENERAL TOLERANCE.				TITLE	SCALE	I-PEX
DWG.	DATE		CABLIN® -CA	1:2		
CHK.			PLUG HOUSING ASSY	UNIT		
APP.			DWG. No.	mm		
			20634	SIZE	SHEET	REV.
				A3	4/4	11