

Recommended P/N

20790-0\*\*E-02

PART NO.	Pos.
20790-060E-##	60

P/N : 20790-0 \*\* E- ##

- 1 : WITH BOSS
- 2 : WITHOUT BOSS
- SEE TABLE 1
- Pos.

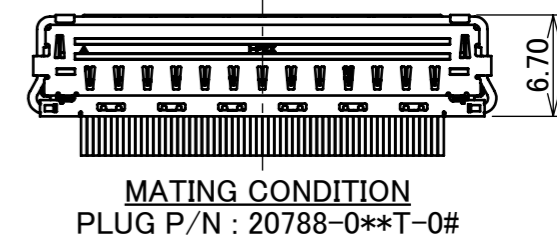
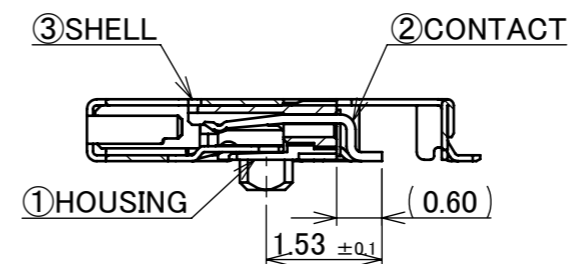
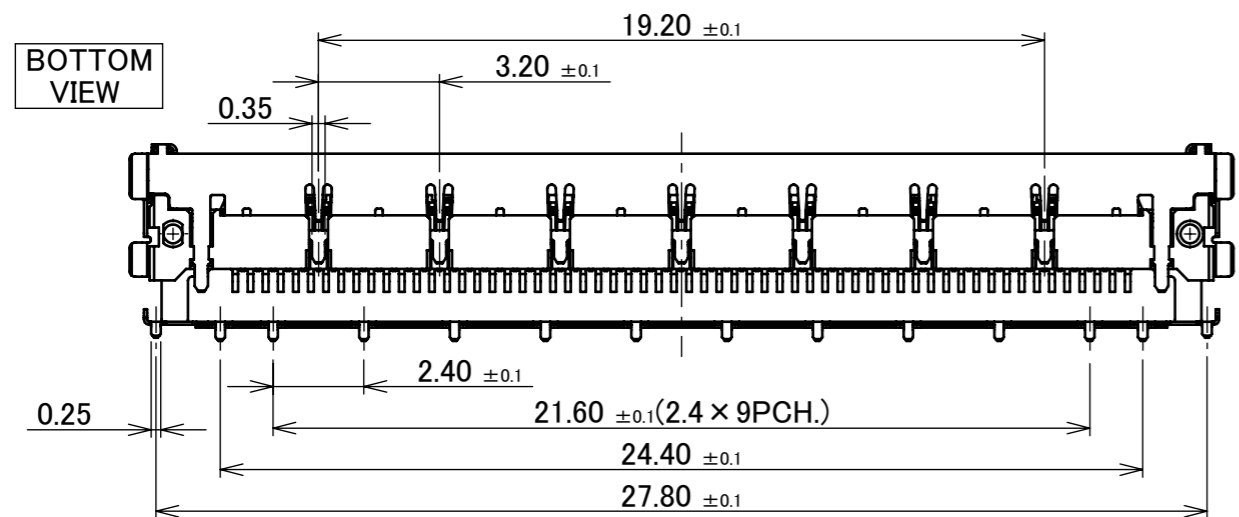
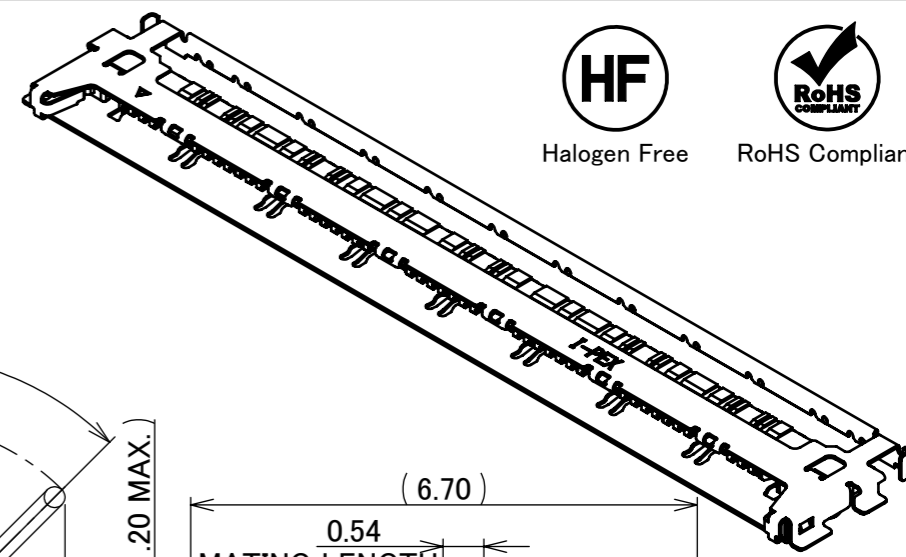
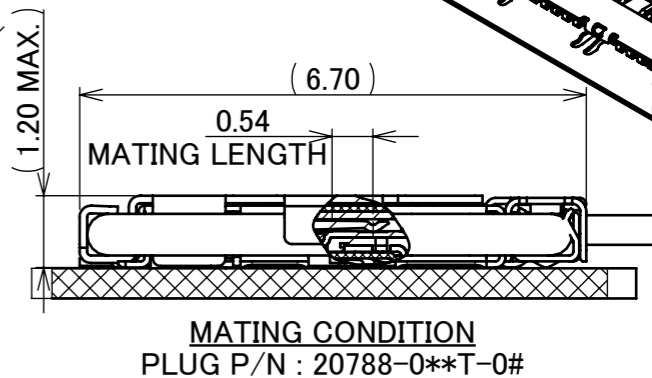
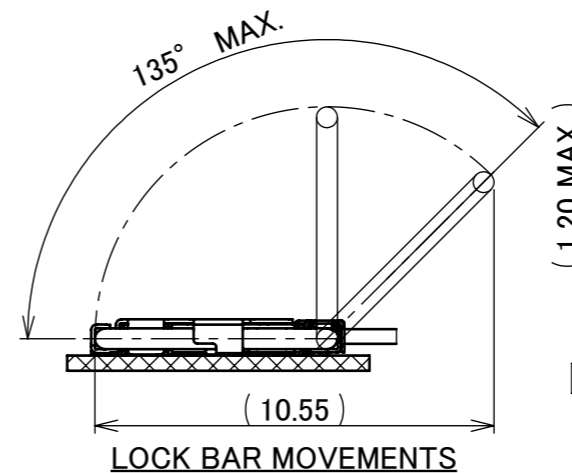
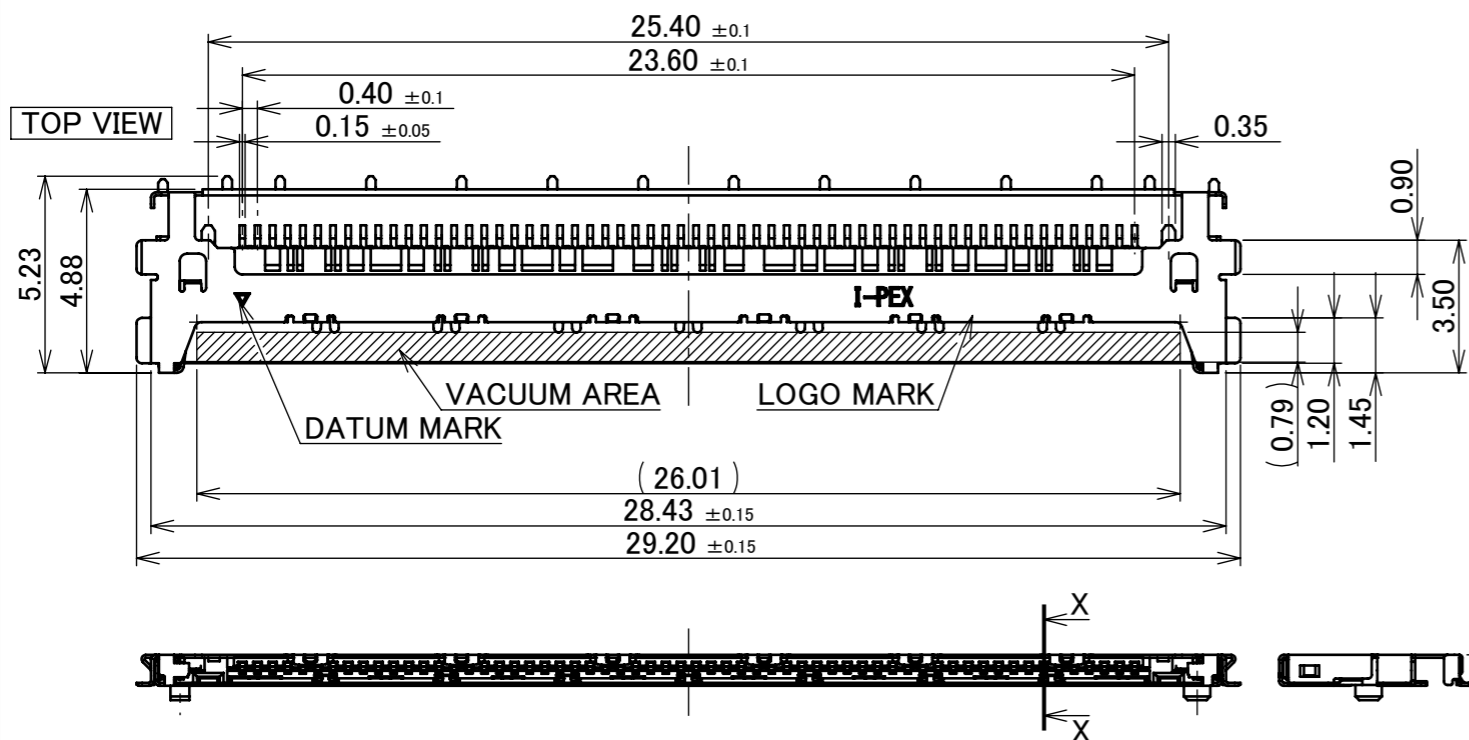
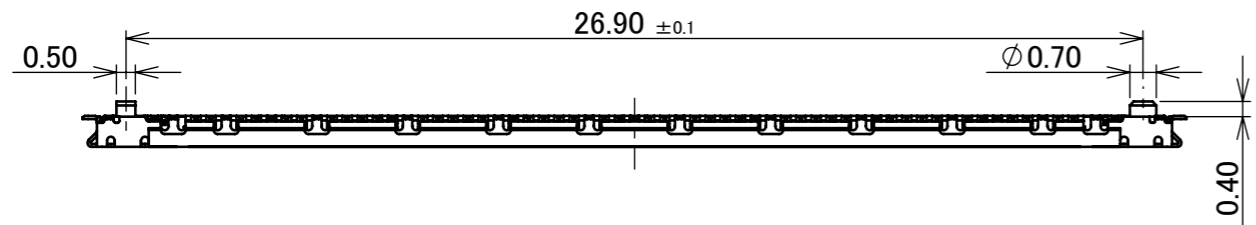

TABLE 1

PART NO.	CONTACT FINISH
20790-0**E-0#	CONTACT & SOLDERING AREA : Au 0.03 μ m MIN. OVER Ni 1.00 μ m MIN.
20790-0**E-1#	CONTACT AREA : Au 0.38 μ m MIN. OVER Ni 1.00 μ m MIN. SOLDERING AREA : Au 0.03 μ m MIN. OVER Ni 1.00 μ m MIN.

NO.	DISCRIPTION	MATERIAL	FINISH , REMARKS
3	SHELL	PHOSPHOR BRONZE	ALL OVER Ni 1.00 μ m MIN. SOLDERING AREA : Au 0.03 μ m MIN.
2	CONTACT	PHOSPHOR BRONZE	SEE TABLE 1
1	HOUSING	LCP	UL94V-0 ,BLACK



**PATENT REGISTERED**

14	Z241307	K.Hara	Sept./24/'24	H.I	ANGLE	±2°	6 OVER 30 MAX.	±0.3	PROJECTION ⊕	SERIES No. R0	CUSTOMER COPY
13	Z240025	K.Hara	Jan./12/'24	H.I	6 MAX.	±0.2	30 OVER 120 MAX.	±0.5			
12	Z230042	K.B	Jan./13/'23	H.I	GENERAL TOLERANCE.			TITLE CABLIN® -CA II PLUS RECEPTACLE ASSEMBLY	SCALE 5:1	UNIT mm	I-PEX
11	Z220151	K.Hara	Feb./14/'22	H.I	DWG.	DATE					
10	Z201144	A.K	Nov./04/'20	H.I	T.Masunaga		2016/11/14	APP.			
9	Z191187	A.K	Sept./11/'19	H.I	T.Kurachi		2016/11/14		REVISION RECORD		
REV.	ECN	BY	DATE	APP.	J.Tateishi		2016/11/14				

I-PEX Inc.

QKE-DFE06-02 REV.12

Confidential C

ITEMS	SPECIFICATION
APPLICABLE CABLE	MICRO-COAXIAL CABLE : AWG# 44 , 42 , 40 , 38 , 36 DISCRETE WIRE : AWG# 36 , 34 TWINAX CABLE : AWG# 40 , 42
RATING VOLTAGE	100V AC (PER CONTACT PIN) ※THIS IS THE RATED VOLTAGE OF THE CONNECTOR. PLEASE NOTE THAT THE RATED VOLTAGE MAY VARY IN THE HARNESS DEPENDING ON THE CABLES USED.
RATING AMPERAGE (FOR CONTACT)	0.1A AC/DC [AWG#44] PER CONTACT PIN/UP TO 60 CONTACTS 0.24A AC/DC [AWG#42] PER CONTACT PIN/UP TO 60 CONTACTS 0.3A AC/DC [AWG#40] PER CONTACT PIN/UP TO 60 CONTACTS 0.5A AC/DC [AWG#38] PER CONTACT PIN/UP TO 18 CONTACTS 0.8A AC/DC [AWG#36] PER CONTACT PIN/UP TO 6 CONTACTS 1.0A AC/DC [AWG#34] PER CONTACT PIN/UP TO 6 CONTACTS ※TESTING BY REAL MACHINE IS RECOMMENDED BECAUSE TEMPERATURE RISE MAY AFFECTED BY ACTUAL SITUATION.
OPERATING TEMPERATURE	233~378K(-40°C~105°C)
OPERATING HUMIDITY	85% MAX.(NON-CONDENDING)
CONTACT RESISTANCE	INITIAL : 180mohm MAX.(AWG#34) / AFTER TEST : $\triangle$ 40mohm MAX. 275mohm MAX.(AWG#36) 360mohm MAX.(AWG#38) 600mohm MAX.(AWG#40) 700mohm MAX.(AWG#42) 1080mohm MAX.(AWG#44)
GROUND SHELL RESISTANCE	INITIAL : 50mohm MAX. / AFTER TEST : $\triangle$ 40mohm MAX.
INSULATION RESISTANCE	INITIAL : 1000Mohm MIN. / AFTER TEST : 500Mohm MIN.
DIELECTRIC WITHSTANDING VOLTAGE	AC250V 1min
DURABILITY	30 CYCLES
MATING FORCE (INITIAL / AFTER 30 CYCLES)	29.10N MAX.
UN-MATING FORCE (INITIAL / AFTER 30 CYCLES)	6.0N MIN.
CABLE RETENTION FORCE	29.40N MIN.
COPLANARITY	0.10 MAX.
PRODUCT SPECIFICATION	PRS-2261
TEST REPORT	TR-16075, TR-23031
INSTRUCTION MANUAL	HIM-16028
PACKING STANDARD	PST-16078
APPEARANCE CRITERIA NO.	QLS-A***

ANGLE	$\pm 2^\circ$	6 OVER 30 MAX.	$\pm 0.3$	PROJECTION 	SERIES No. R0	CUSTOMER COPY		
	6 MAX.	$\pm 0.2$	30 OVER 120 MAX.			$\pm 0.5$	SCALE 5:1	<b>I-PEX</b>
GENERAL TOLERANCE.				TITLE CABLIN <sup>®</sup> -CA II PLUS RECEPTACLE ASSEMBLY	UNIT mm	SIZE A3	SHEET 2/5	
DWG.	DATE			DWG. No.	20790			
CHK.								
APP.								

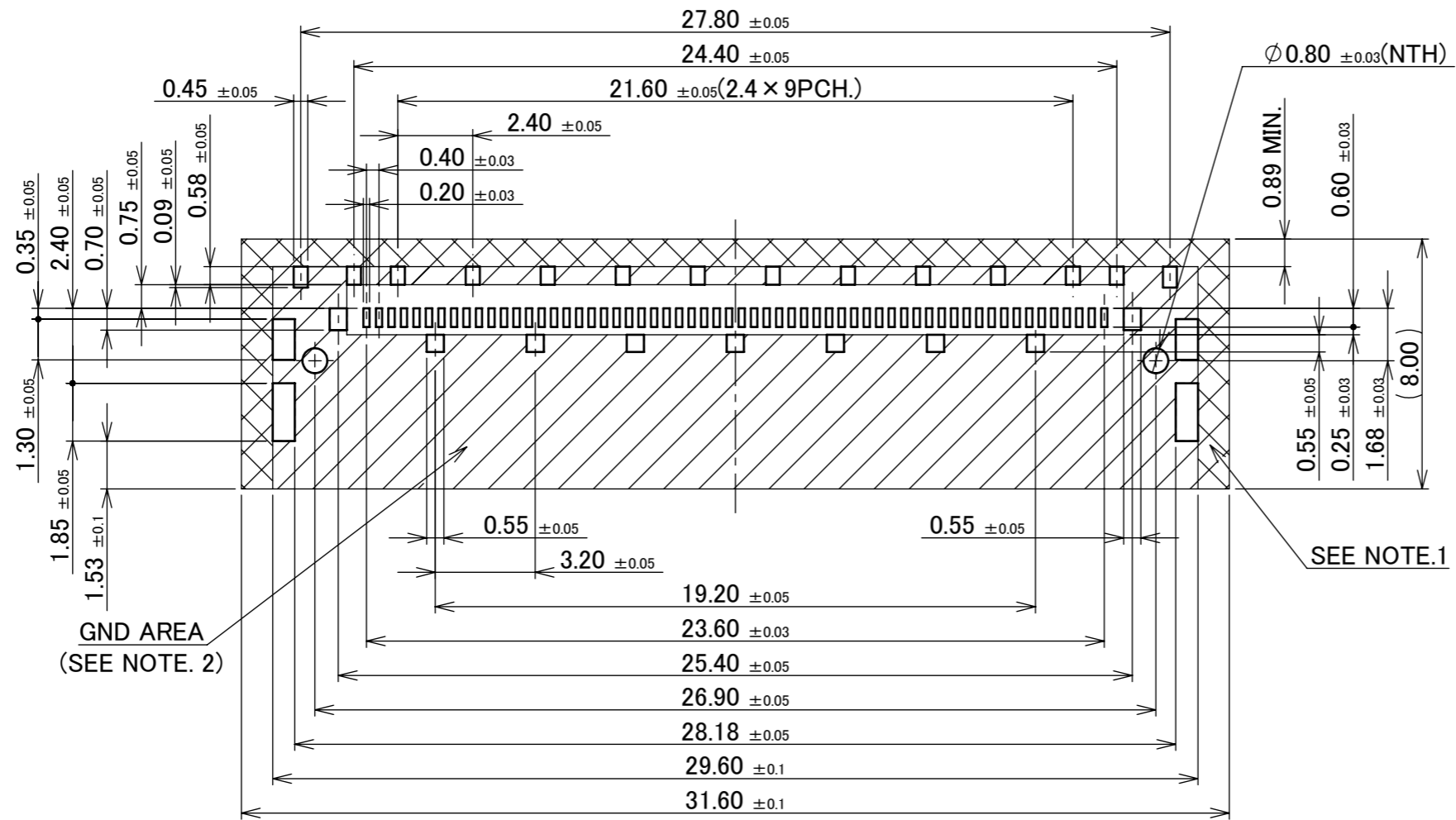

GND AREA  
(SEE NOTE. 2)

SEE NOTE.1

**RECOMMENDED FOOTPRINT PATTERN LAYOUT**

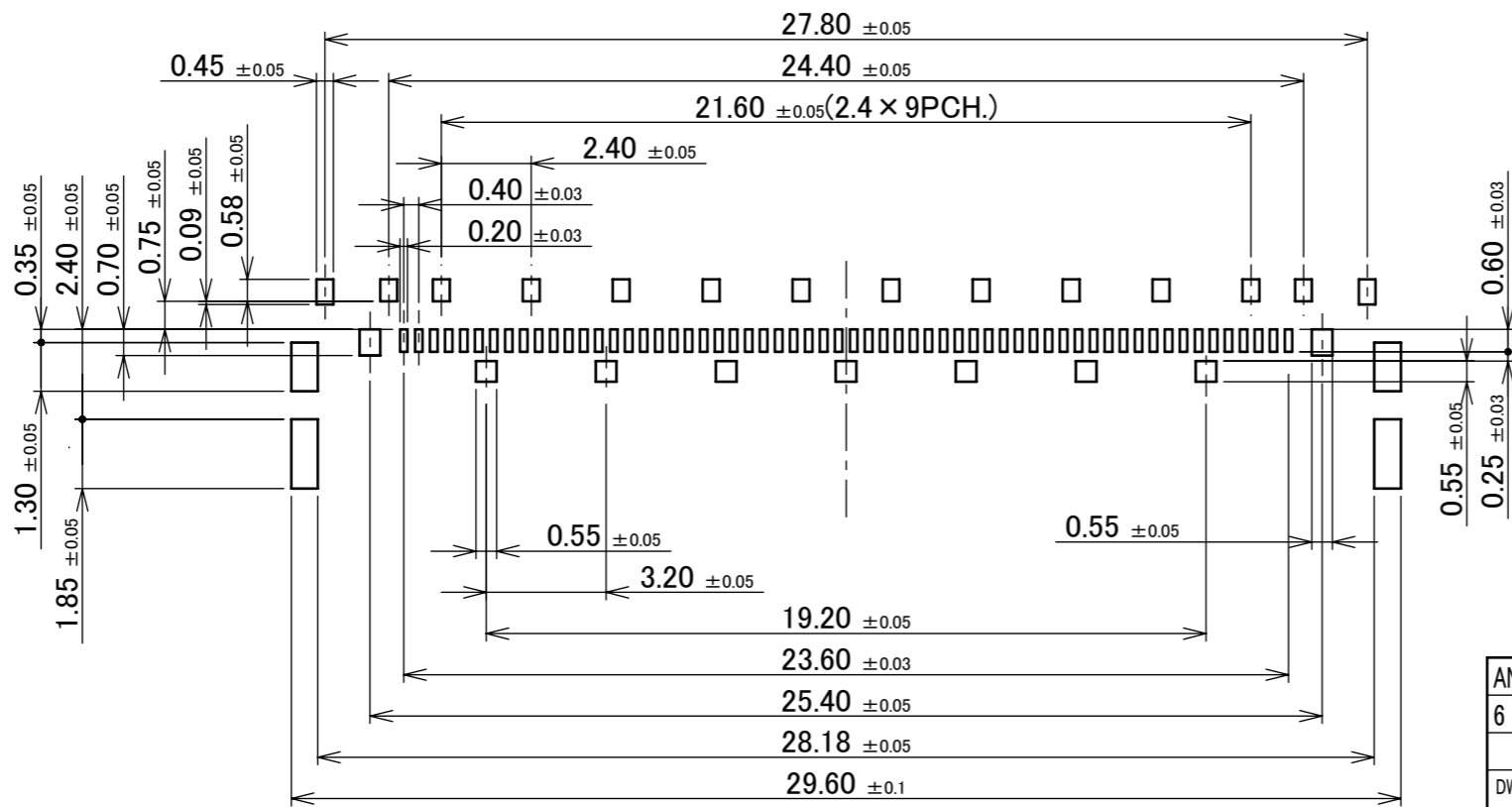

**RECOMMENDED METAL MASK LAYOUT**  
METAL MASK THICKNESS : t=0.12mm

- NOTES:  
 1. DO NOT MOUNT ANOTHER COMPONENT IN THIS AREA.  
 2. SOLDER RESIST MUST BE APPLIED TO THIS AREA.

ANGLE	±2°	6 OVER 30 MAX.	±0.3	PROJECTION	SERIES No.	CUSTOMER COPY		
	6 MAX.	±0.2	30 OVER 120 MAX.	±0.5	R0			
GENERAL TOLERANCE.				TITLE		SCALE		
DWG.	DATE			CABLIN <sup>®</sup> -CA II PLUS		5:1	I-PEX	
CHK.				RECEPTACLE ASSEMBLY		UNIT		
APP.				DWG. No.		mm	SIZE	SHEET
				20790		A3	3/5	REV.
								14

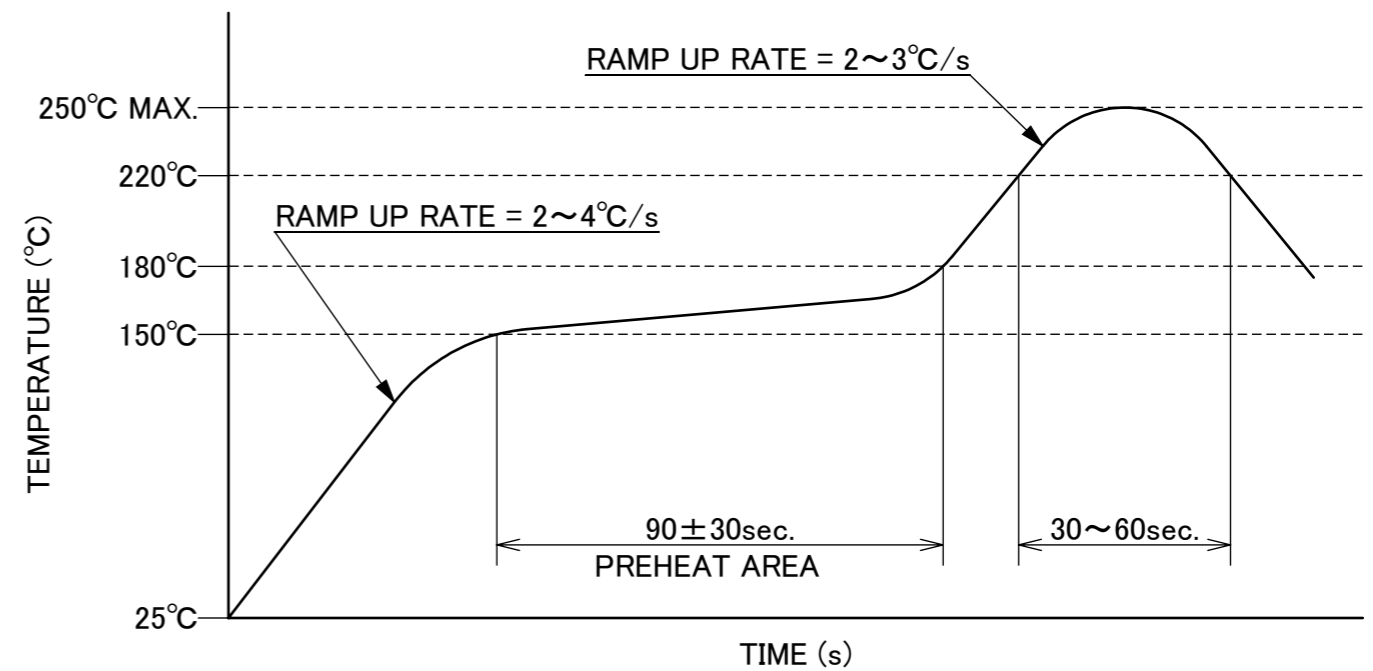
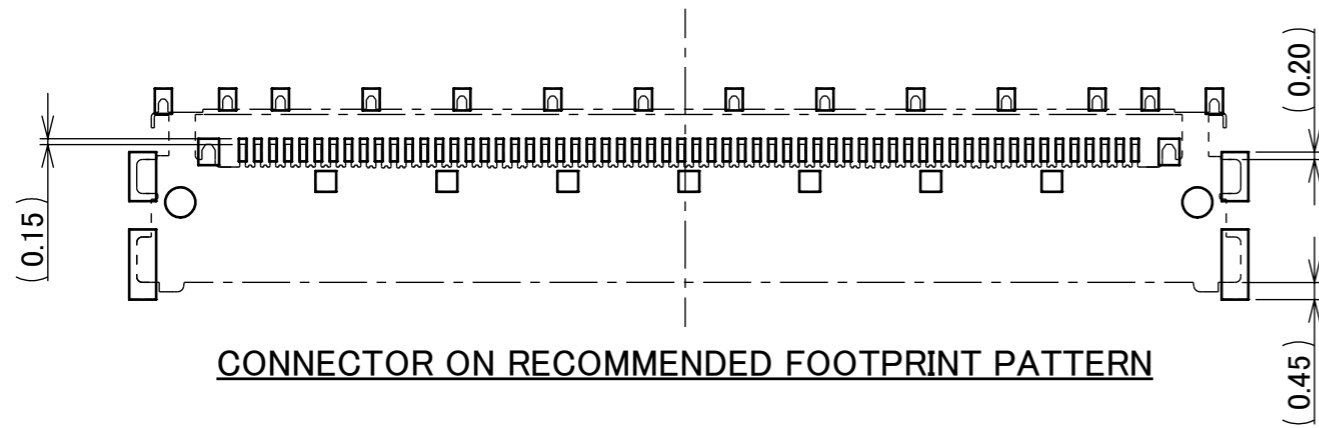

**REFLOW TEMPERATURE PROFILE**  
 SENJU METAL INDUSTRY CO., LTD. : M705-SHF(Sn96.5 Ag3.0 Cu0.5)

ANGLE	±2°	6 OVER 30 MAX.	±0.3	PROJECTION 	SERIES No. R0	CUSTOMER COPY		
6 MAX.	±0.2	30 OVER 120 MAX.	±0.5					
GENERAL TOLERANCE.				TITLE CABLIN <sup>®</sup> -CA II PLUS RECEPTACLE ASSEMBLY	SCALE 5:1 UNIT mm			
DWG.	DATE							
CHK.								
APP.								
				DWG. No.	20790	SIZE A3	SHEET 4/5	REV. 14

PART NO.	QTY. PER EMBOSS REEL (PIECES / REEL)	QTY. PER PACKING CARTON (REELS / CARTON)
20790-060E-##	5500 / REEL	3 / CARTON = 16500

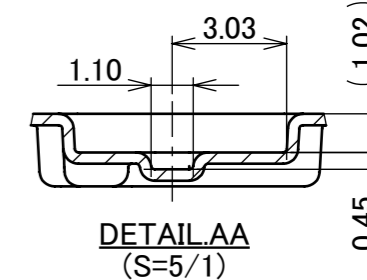
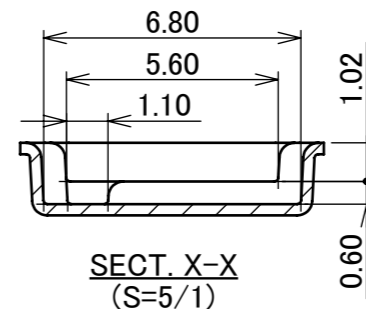
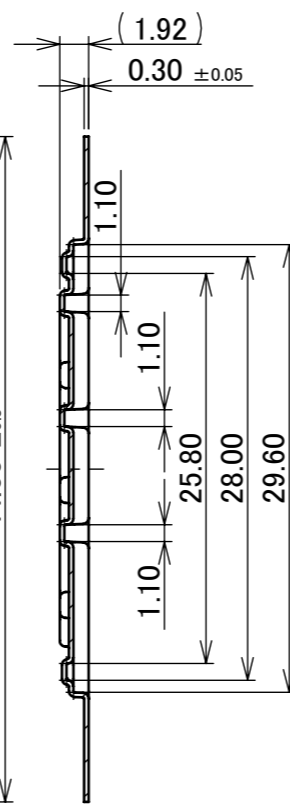
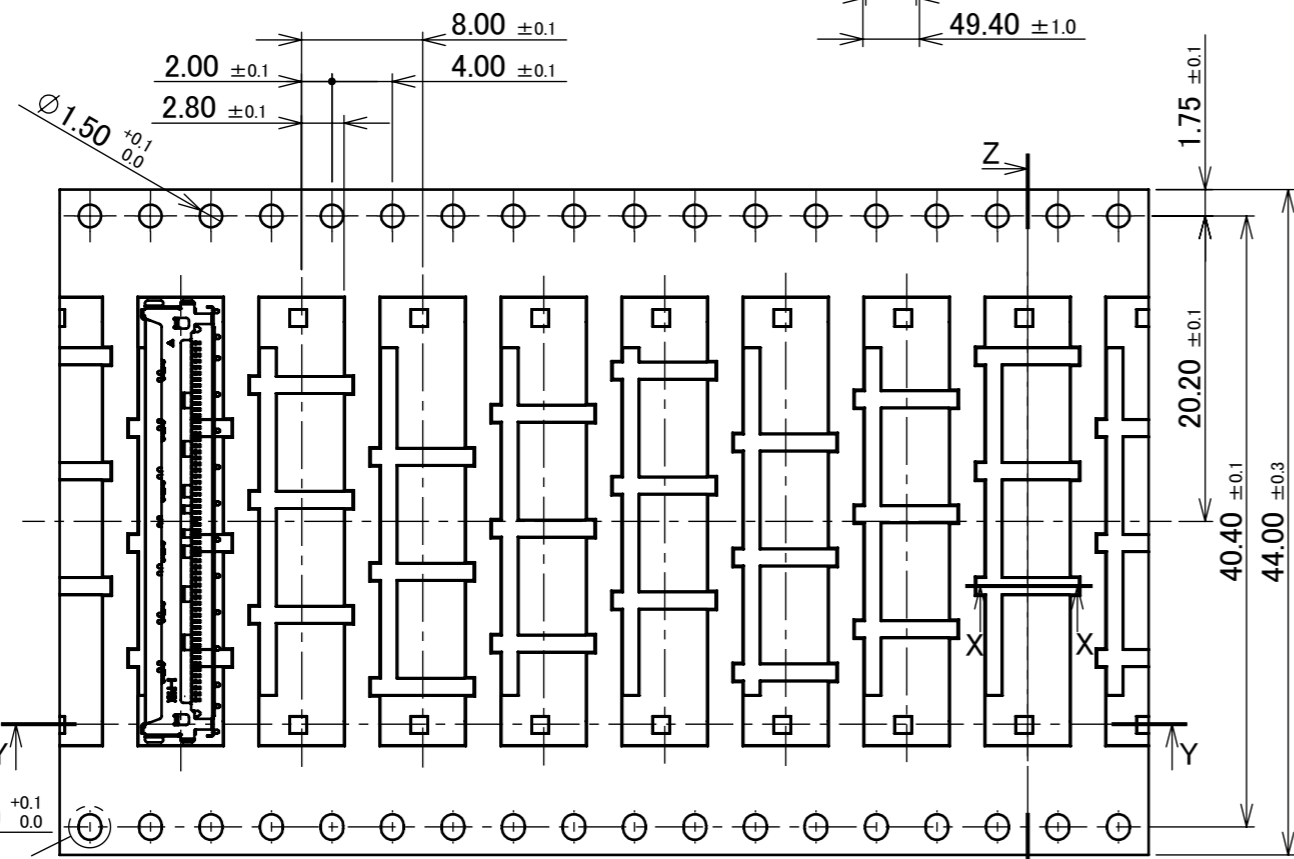
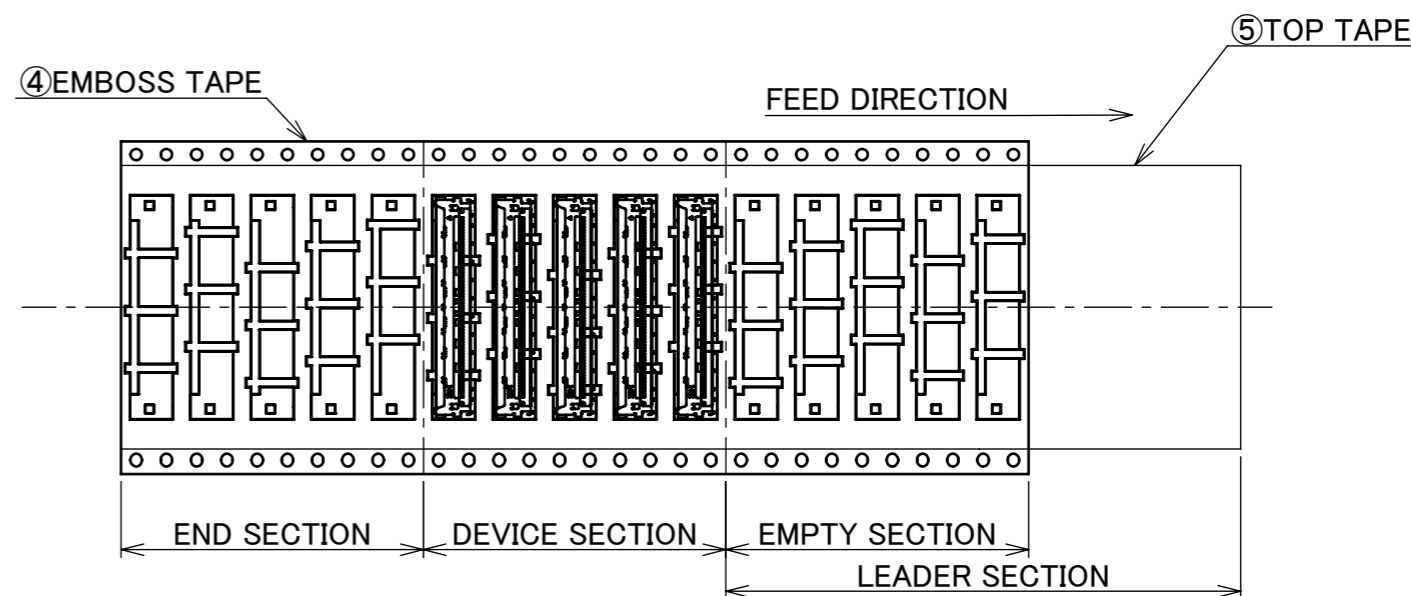
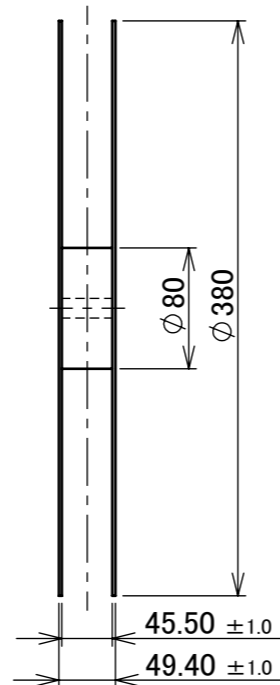
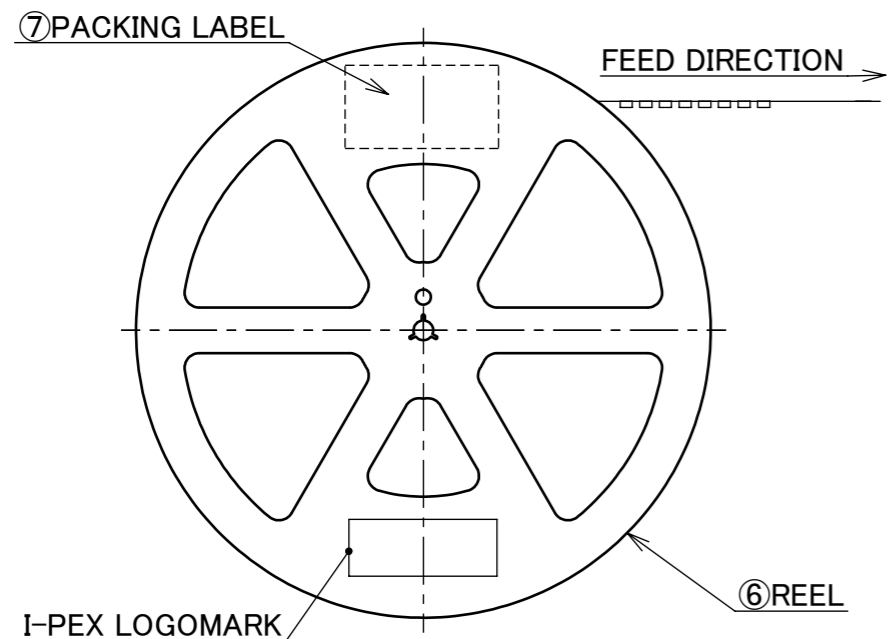

NOTES.

- TAPING SPECIFICATION FOLLOWS JIS C 0806 (IEC 60286-3).
- MAKE EMPTY SECTION OF LEADER AND END ON EACH END OF THE TAPE.
- TOP TAPE SHALL NOT STICK OUT FROM EMBOSS TAPE.
- TOP TAPE SHALL NOT COVER FEED HOLE.

NO.	DISCRIPTION	MATERIAL	FINISH , REMARKS
7	PACKING LABEL	-	-
6	REEL	PS	ANTI-STATIC TYPE BLACK
5	TOP TAPE	PET $t=0.062$ TRANSPARENCY	ANTI-STATIC TYPE
4	EMBASS TAPE	PS $t=0.3$ TRANSPARENCY	ANTI-STATIC TYPE

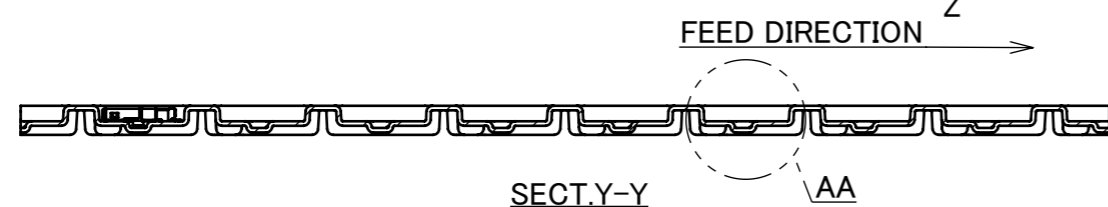
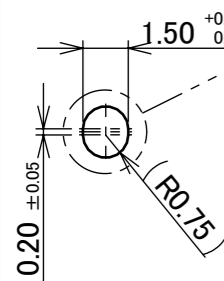

ANGLE	$\pm 2^\circ$	6 OVER 30 MAX.	$\pm 0.3$	PROJECTION	SERIES No.	CUSTOMER COPY
	6 MAX.	$\pm 0.2$	30 OVER 120 MAX.	$\pm 0.5$	R0	
GENERAL TOLERANCE.				TITLE	SCALE	I-PEX
DWG.	DATE			CABLIN <sup>®</sup> -CA II PLUS RECEPTACLE ASSEMBLY	2:1	
CHK.					UNIT	
APP.					mm	
				DWG. No.	20790	SIZE
						A3
						SHEET
						5/5
						REV.
						14