

Recommended P/N 3300-0**1

PART No.	Pos.	A	B
3300-0301	30	17.89	19.05
3300-0401	40	21.89	23.05

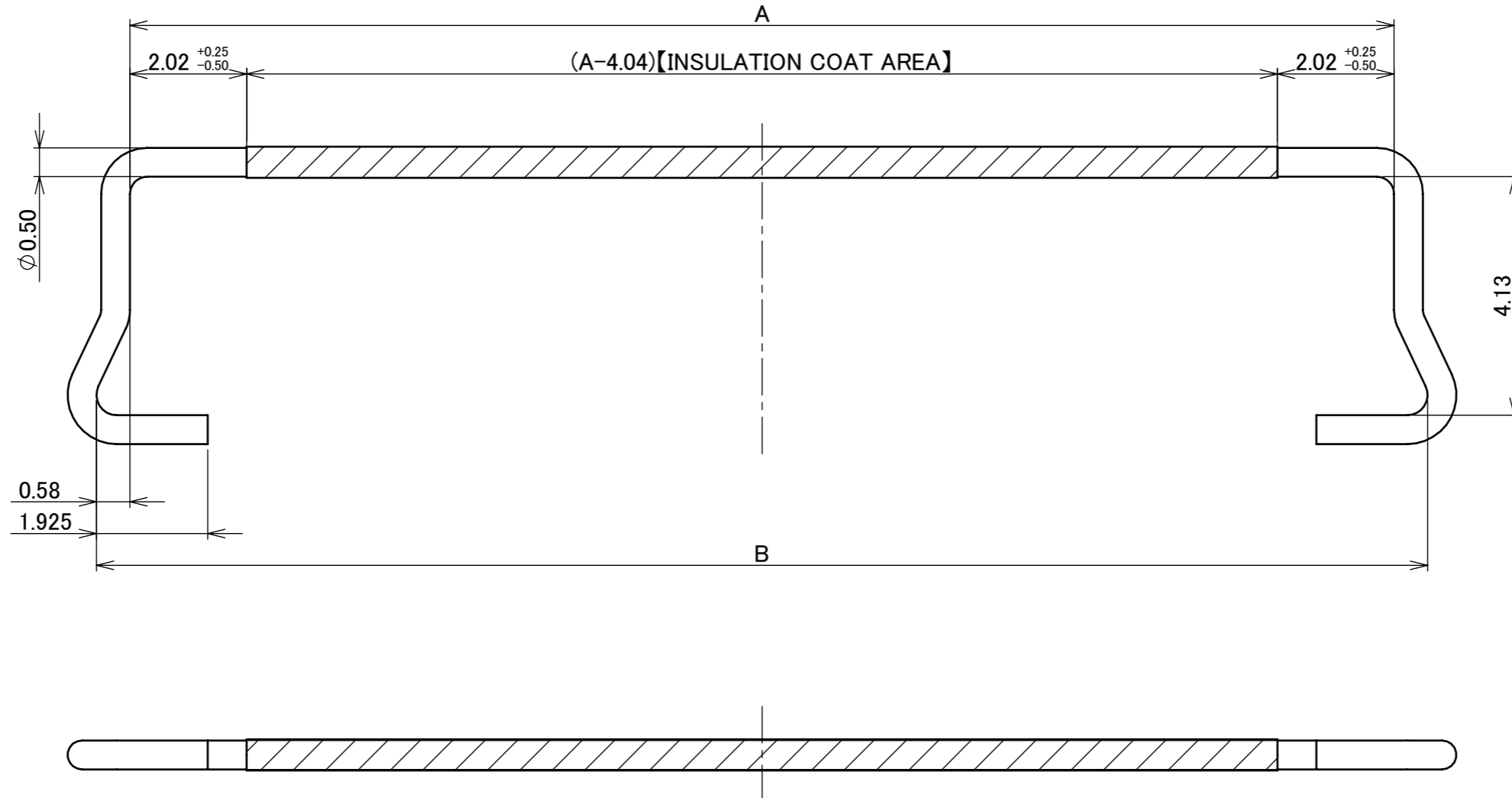
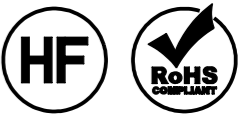

NO.	DISCRIPTION	MATERIAL	FINISH , REMARKS
1	LOCK BAR	SUS	-

REV.	ECN	BY	DATE	APP.	APP.	DATE	DWG. No.	SIZE	SHEET	REV.
3	Z191189	S.Y	Sept./06/'19	H.I			3300	A3	1/2	3
2	Z181287	M.I	Oct./01/'18	H.I						
1	Z180190	M.I	Feb./14/'18	H.I						
0	Z170418	M.I	Apr./12/'17							

Confidential C

I-PEX Inc.

QKE-DFFDE06-02 REV.11

PART NO.	POS.	C	STICK QTY.	QTY. PRE STICK	QTY. IN SHIPPING CARTON	QTY. IN PACKING CARTON	PACKING STANDARD
3300-0301	30	26	30	500	500 × 30 = 15000	60000 (4 BOXES)	PST-17057
3300-0401	40	30					

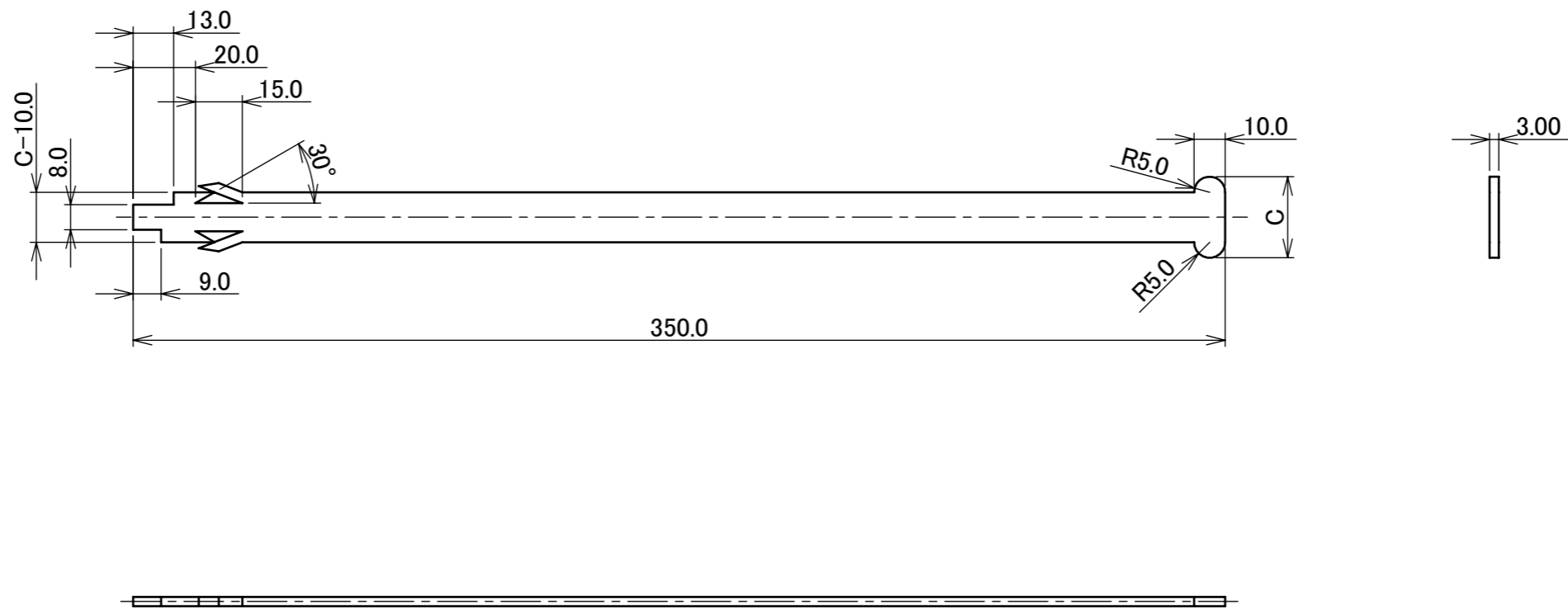

NO.	DISCRIPTION	MATERIAL	FINISH , REMARKS
2	STICK	PP	-

ANGLE	±2°	6 OVER 30 MAX.	±0.3	PROJECTION	SERIES No.	CUSTOMER COPY
6 MAX.	±0.2	30 OVER 120 MAX.	±0.5		R1	
GENERAL TOLERANCE.				TITLE		SCALE
DWG.	DATE			CABLINER®-CAL		1:2
CHK.	DATE			PLUG LOCK BAR		UNIT
APP.	DATE			DWG. No.		mm
				3300		SIZE
						A3
						SHEET 2/2
						REV. 3