

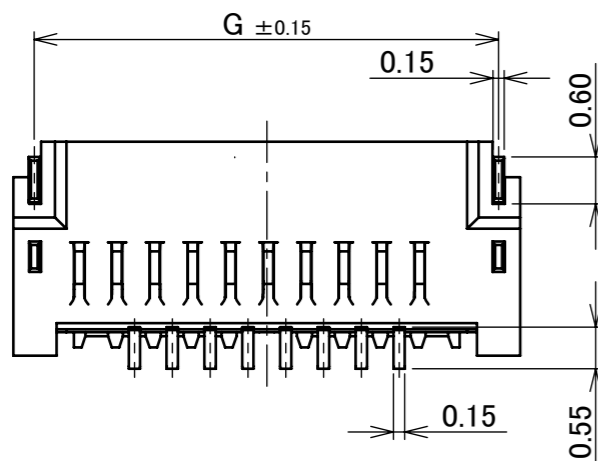

CAUTION VISIT OUR WEBSITE FOR LATEST VERSIONS OF INSTRUCTION MANUAL NO. HIM-14010 AND HIM-12019 TO HANDLE THE PRODUCT PROPERLY AND SAFELY.

PART No.	POS.	A	B	C	D	E	F	G
20597-006E-02	6	6.70	3.50	2.50	5.80	4.80	5.56	6.15
20597-008E-02	8	7.70	4.50	3.50	6.80	5.80	6.56	7.15
20597-010E-02	10	8.70	5.50	4.50	7.80	6.80	7.56	8.15
◆20597-020E-02	20	13.70	10.50	9.50	12.80	6.80	12.56	13.15

◆MARK MEANS NOT AVAILABLE

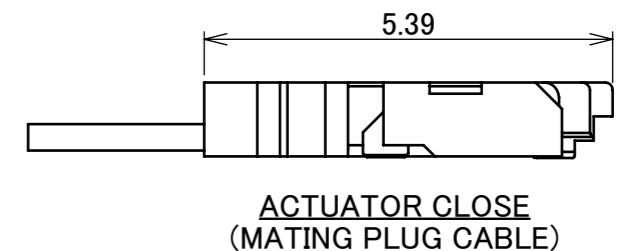
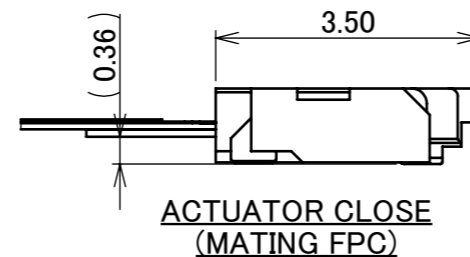
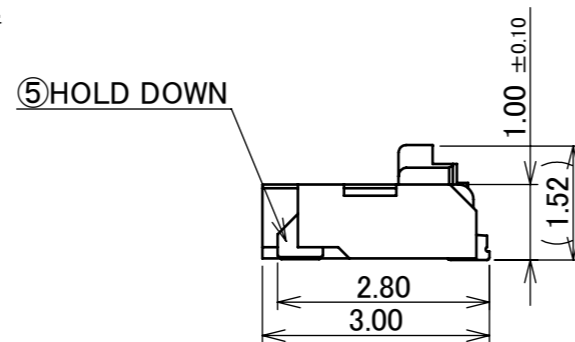
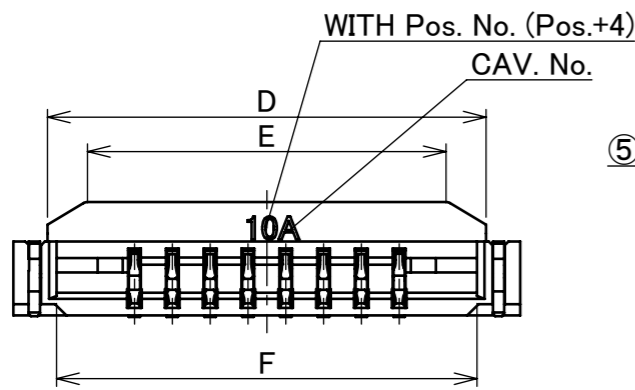
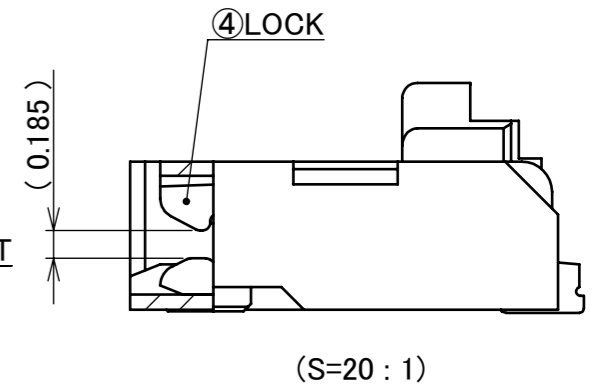
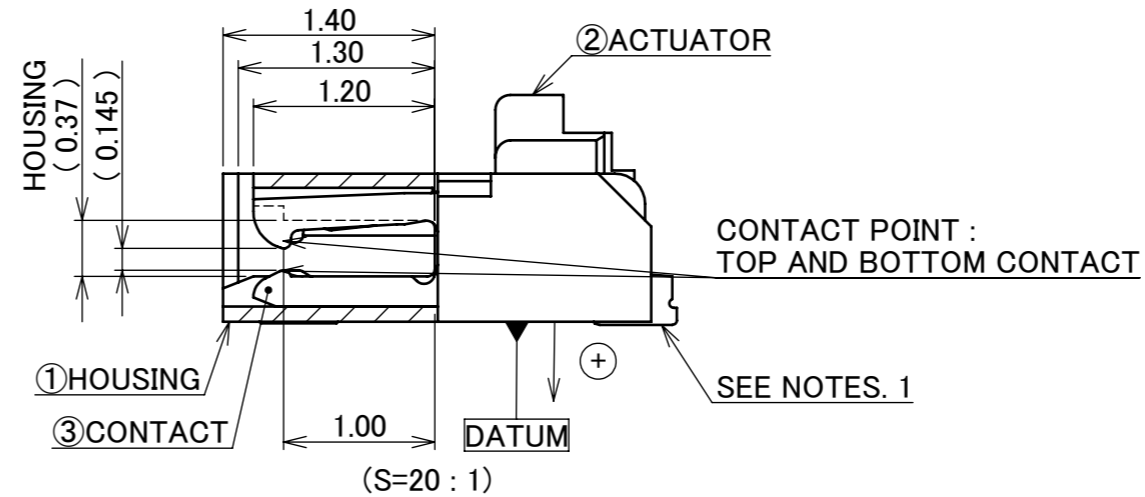
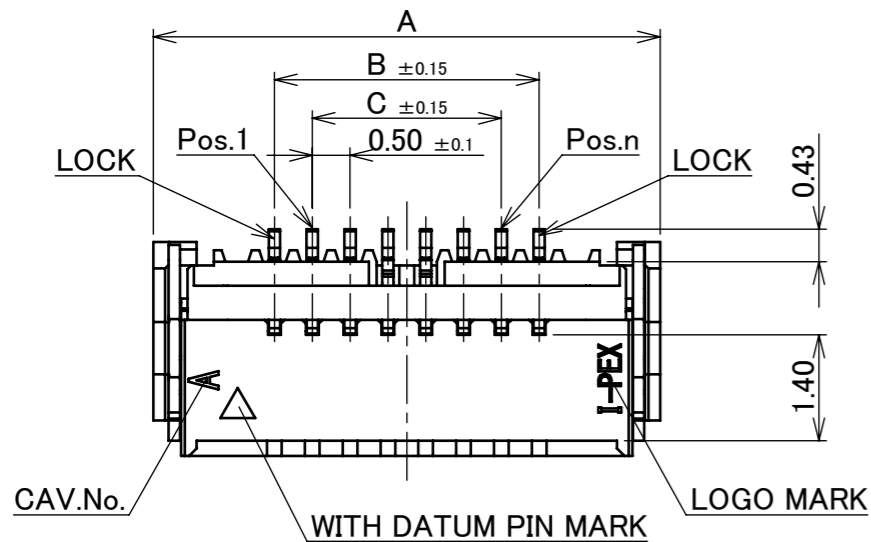

5	HOLD DOWN	PHOSPHOR BRONZE	Sn 2~6 μm MIN.OVER Ni 1.0 μm MIN.
4	LOCK	PHOSPHOR BRONZE	Au 0.03 μm MIN. OVER Ni 1.0 μm MIN.
3	CONTACT	PHOSPHOR BRONZE	CONTACT AREA : Au 0.1 μm MIN. OVER Ni 1.0 μm MIN. SOLDERING AREA : Au 0.03 μm MIN. OVER Ni 1.0 μm MIN.
2	ACTUATOR	LCP	UL94V-0, BEIGE
1	HOUSING	LCP	UL94V-0, BEIGE

REV.	ECN	BY	DATE	APP.	APP.	DATE	DWG. No.	20597	SIZE	A3	SHEET	1/5	REV.	7
7	Z191358	R.F	Oct./08/'19	H.I	ANGLE	±2°	6 OVER 30 MAX.	±0.3	PROJECTION	SERIES No.	R3	CUSTOMER COPY	SCALE	10:1
6	Z181430	K.T	Nov./01/'18	Y.S	6 MAX.	±0.2	30 OVER 120 MAX.	±0.5						
5	Z181301	K.T	Oct./03/'18	Y.S	GENERAL TOLERANCE.			TITLE	DW 5 RECEPTACLE	UNIT	mm	I-PEX		
4	Z170315	Y.O	Mar./24/'17	TAK	DWG.	DATE	Apr./07/'15							
3	Z170035	Y.O	Jan./12/'17	TAK	CHK.	DATE	Apr./07/'15							
2	Z161200	Y.O	Sept./28/'16	TAK	APP.	DATE	Apr./07/'15							
REVISION RECORD					T.Takano	Apr./07/'15			SIZE	A3	SHEET	1/5	REV.	7

NOTES
1. CONTACT TAIL IS PROJECTION FROM HOUSING IN THE + DIRECTION. (0~0.06)

ITEMS	SPECIFICATION
RATING VOLTAGE	50V AC (PER CONTACT)
RATING AMPERAGE	0.5A DC [FPC] (PER CONTACT) 0.7A DC [AWG#34] (PER CONTACT)
OPERATING TEMPERATURE	233~358K(-40°C~85°C)
OPERATING HUMIDITY	80% MAX.(NON-CONDENSING)
CONTACT RESISTANCE	INITIAL : 40mohm MAX. / AFTER TEST : \angle 20mohm MAX.
INSULATION RESISTANCE	INITIAL : 1000Mohm MIN. / AFTER TEST : 500Mohm MAX. (PLUG CABLE) 100Mohm MIN. (FPC)
DIELECTRIC WITHSTANDING VOLTAGE	AC200V 1min
DURABILITY	20TH CYCLES
ACTUATOR LOCKING FORCE (INITIAL / 20TH CYCLES)	INITIAL/ 20TH CYCLES : 0.6N(61gf) \times (n + 2) MAX.
ACTUATOR UNLOCKING FORCE (INITIAL / 20TH CYCLES)	INITIAL/ 20TH CYCLES : 0.05N(5gf) \times (n + 2) MIN.
PLUG AND FPC RETENTION FORCE (INITIAL / AFTER TEST)	INITIAL : 0.15N(15gf) \times n + 2.0N MIN. / AFTER TEST : 0.15N(15gf) \times n + 1.0N MIN.
COPLANARITY	0.08 MAX.
PRODUCT SPECIFICATION	PRS-1880
TEST REPORT	TR-13103
PACKING STANDARD	PST-13047
INSTRUCTION MANUAL	HIM-14010 (FOR MATING PLUG CABLE) HIM-12019 (FOR MATING FPC)
APPEARANCE CRITERIA No.	QLS-A***

※ "n" IS THE NUMBER OF PIN

ANGLE	$\pm 2^\circ$	6 OVER 30 MAX.	± 0.3	PROJECTION 	SERIES No. R3	CUSTOMER COPY
6 MAX.	± 0.2	30 OVER 120 MAX.	± 0.5			
GENERAL TOLERANCE.				TITLE DW 5 RECEPTACLE	SCALE	UNIT mm
DWG.	DATE					
CHK.	DATE					
APP.	DATE					
				DWG. No.	20597	SIZE A3
				SHEET 2/5		REV. 7

PART No.	POS.	B	C	G	H
20597-006E-02	6	3.50	2.50	6.15	5.50
20597-008E-02	8	4.50	3.50	7.15	6.50
20597-010E-02	10	5.50	4.50	8.15	7.50
◆20597-020E-02	20	10.50	9.50	13.15	12.50

◆ MARK MEANS NOT AVAILABLE

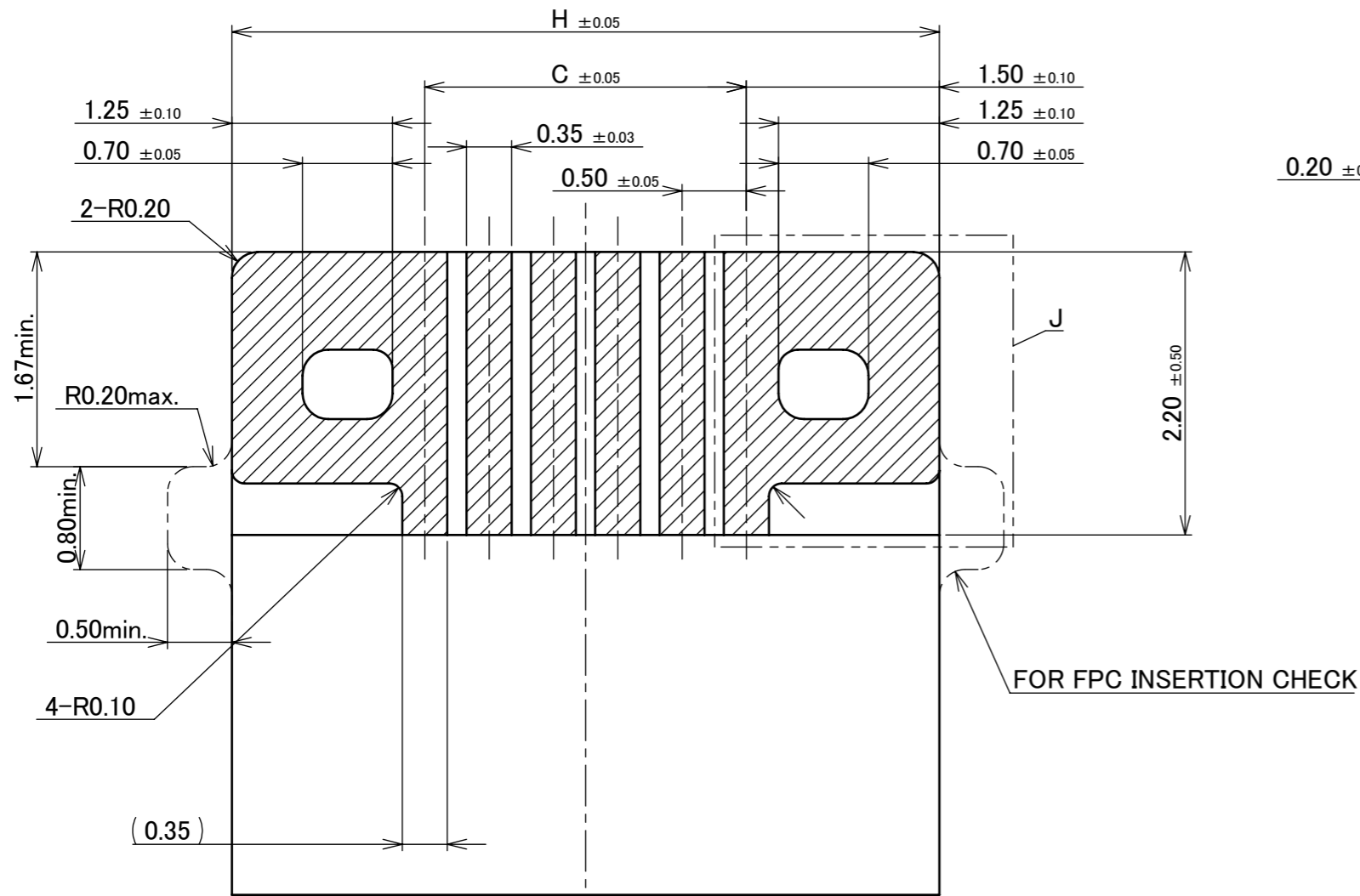

RECOMMENDED FPC LAYOUT

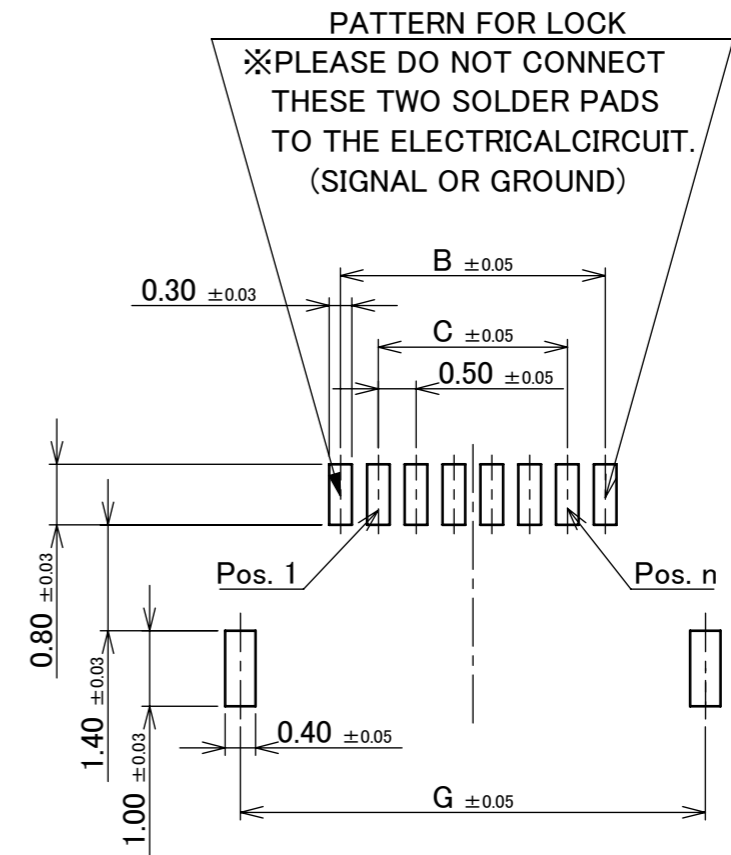
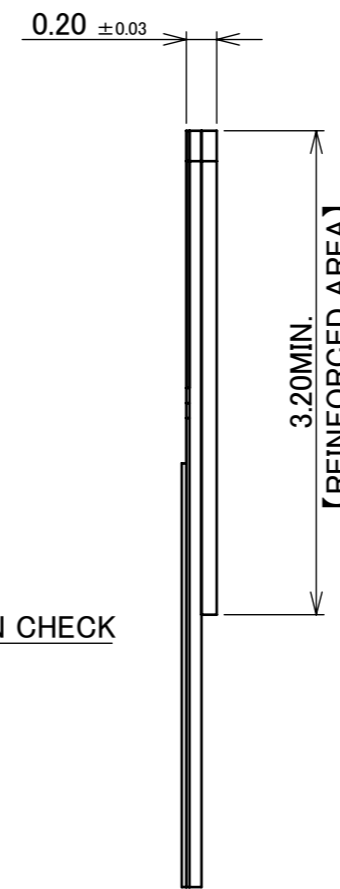

RECOMMENDED PCB LAYOUT & METAL MASK LAYOUT
METAL MASK THICKNESS : t=0.12mm

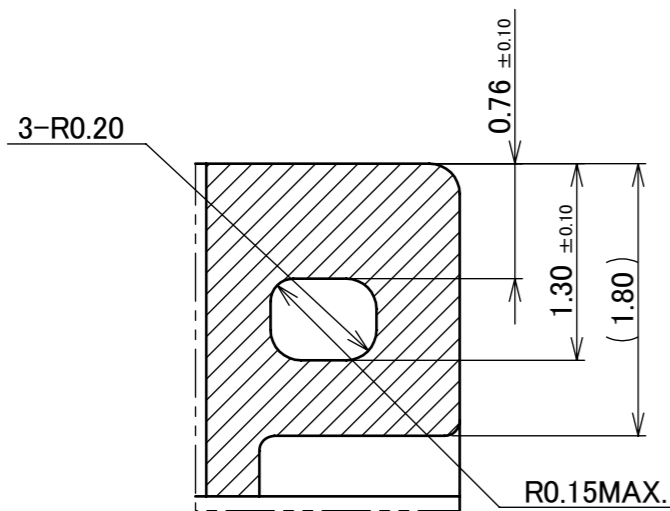

DETAIL J
(S=20/1)

- NOTES**
- MATERIAL**
COVER FILM : PI
CONDUCTOR : COPPER(RARE)
BASE FILM : PI
STIFFENER : PI
ADHESIVE : THERMOSETTING ADHESIVE
 - FINISH**
Au OVER Ni PLATING.

ANGLE	±2°	6 OVER 30 MAX.	±0.3	PROJECTION ⊕	SERIES No. R3	CUSTOMER COPY
6 MAX.	±0.2	30 OVER 120 MAX.	±0.5			
GENERAL TOLERANCE.				TITLE DW 5 RECEPTACLE	SCALE 10:1	UNIT mm
DWG.	DATE		DWG. No. 20597			
CHK.	DATE					
APP.	DATE					
				SIZE A3	SHEET 3/5	REV. 7

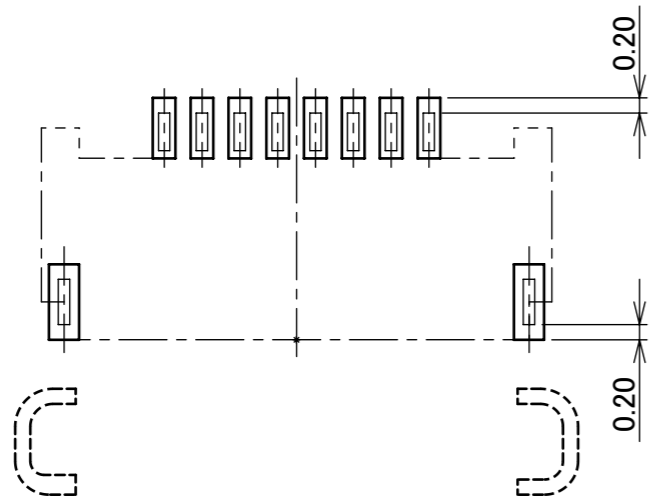

CONNECTOR ON RECOMMENDED FOOTPRINT PATTERN

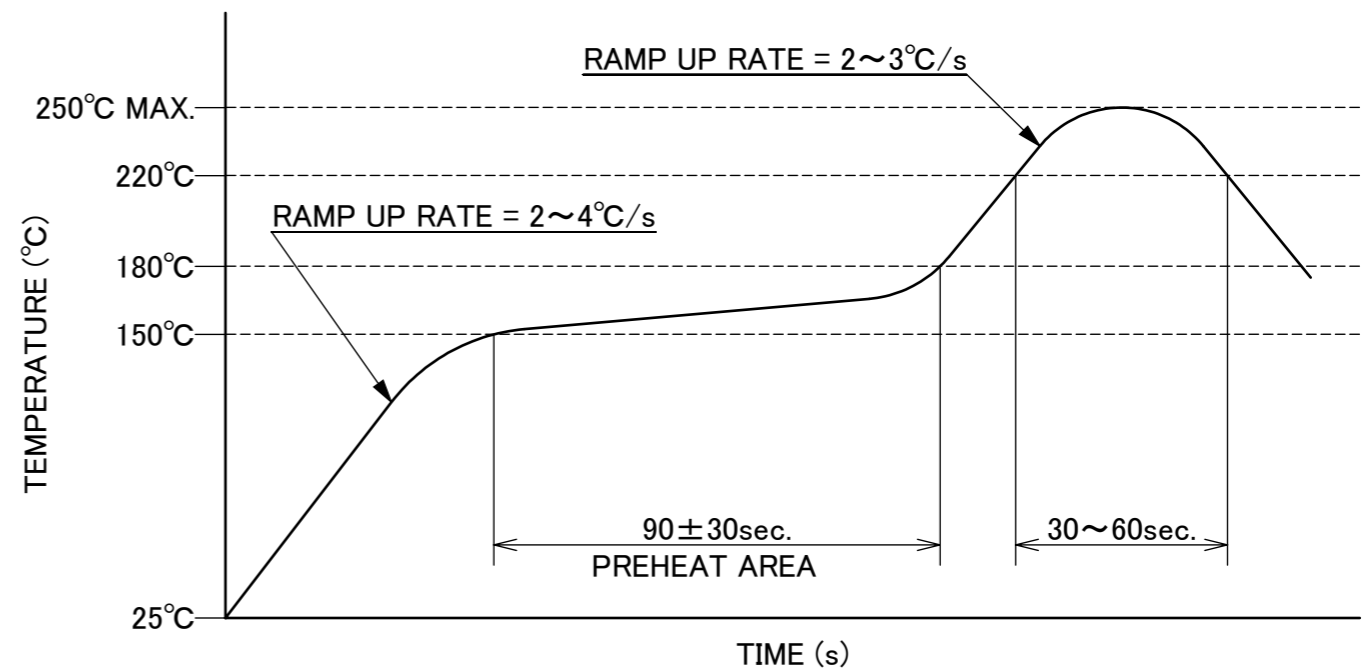

REFLOW TEMPERATURE PROFILE
 SENJU METAL INDUSTRY CO., LTD. : M705-SHF(Sn96.5 Ag3.0 Cu0.5)

ANGLE	±2°	6 OVER 30 MAX.	±0.3	PROJECTION 	SERIES No. R3	CUSTOMER COPY	
6 MAX.	±0.2	30 OVER 120 MAX.	±0.5				
GENERAL TOLERANCE.				TITLE DW 5 RECEPTACLE	SCALE 10:1	UNIT mm I-PEX	
DWG.	DATE						
CHK.	DATE						
APP.	DATE						
				DWG. No.	20597	SIZE A3	SHEET 4/5 REV. 7

⑨ PACKING LABEL

FEED DIRECTION

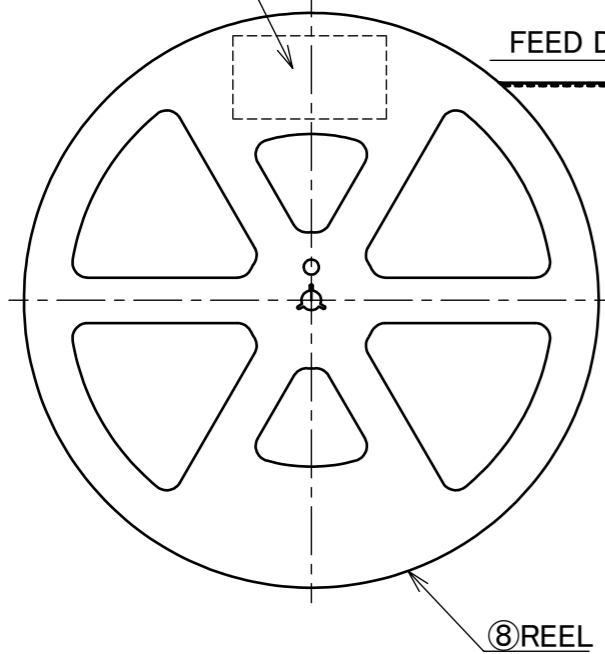

⑧ REEL

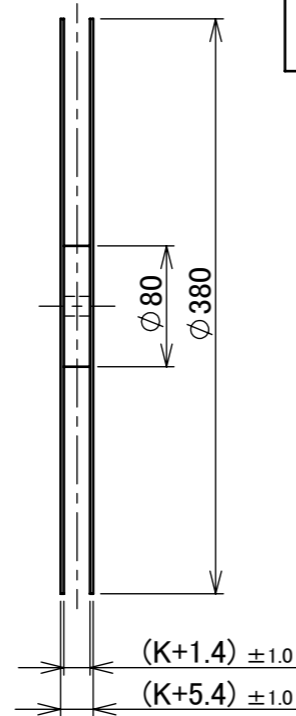

$(K+1.4) \pm 1.0$

$(K+5.4) \pm 1.0$

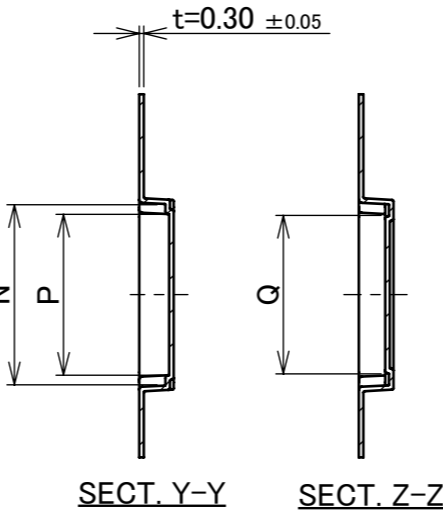

SECT. Y-Y

SECT. Z-Z

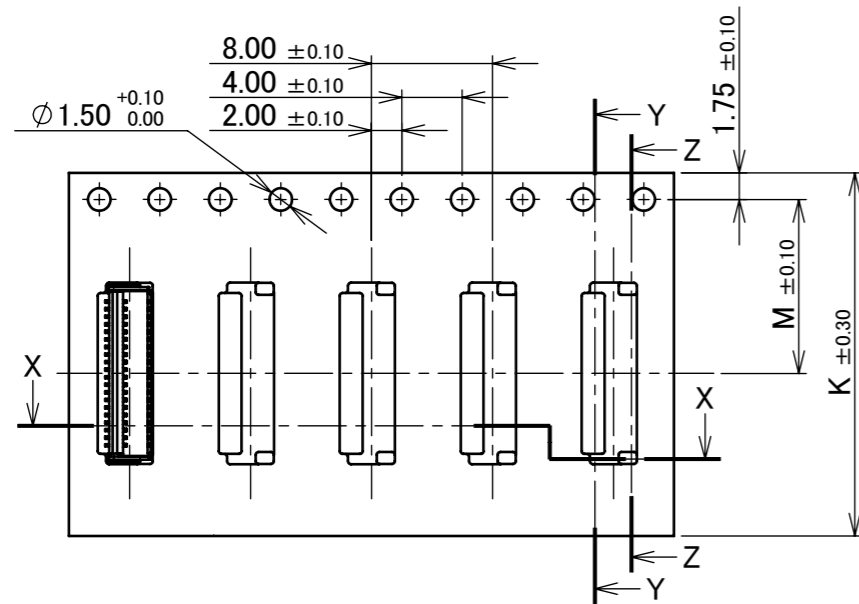

FEED DIRECTION

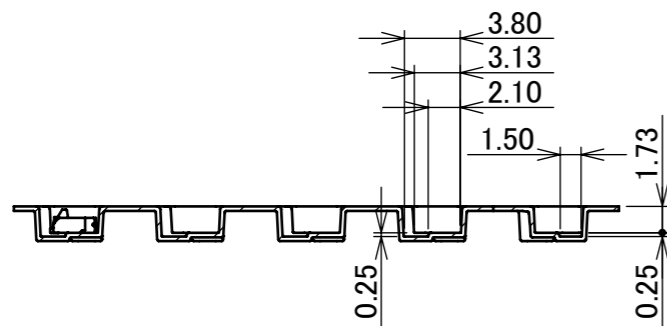

SECT. X-X

PART No.	K	L	M	N	P	Q	QTY. PER EMBOSS REEL (PIECES / REEL)	QTY. PER PACKING CARTON (REELS / CARTON)
20597-006E-02				7.0	5.5	5.0	5000 PIECES / REEL	7 REELS / CARTON (35000 PIECES / CARTON)
20597-008E-02	16.0	13.5	7.5	8.0	6.5	6.0		
20597-010E-02				9.0	7.5	7.0		
◆ 20597-020E-02	24.0	21.5	11.5	14.0	12.5	12.0	5000 PIECES / REEL	5 REELS / CARTON (25000 PIECES / CARTON)

◆ MARK MEANS NOT AVAILABLE

NOTES.

- TAPING SPECIFICATION FOLLOWS JIS C 0806 (IEC 60286-3).
- MAKE EMPTY SECTION OF LEADER AND END ON EACH END OF THE TAPE.
- TOP TAPE SHALL NOT STICK OUT FROM EMBOSS TAPE.
- TOP TAPE SHALL NOT COVER FEED HOLE.

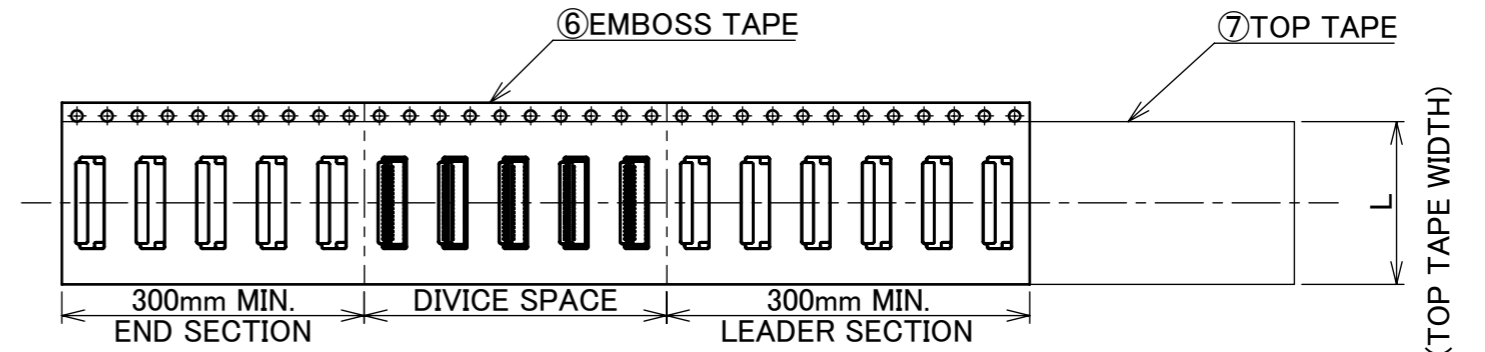

NO.	DISCRIPTION	MATERIAL	FINISH , REMARKS
9	PACKING LABEL	-	-
8	REEL	PS	BLACK
7	TOP TAPE	PET t=0.062 TRANSPARENCY	ANTI-STATIC TYPE HEAT WELDING TYPE
6	EMBOSS TAPE	PS t=0.3 TRANSPARENCY	ANTI-STATIC TYPE

ANGLE	±2°	6 OVER 30 MAX.	±0.3	PROJECTION	SERIES No.	CUSTOMER COPY
6 MAX.	±0.2	30 OVER 120 MAX.	±0.5		R3	
GENERAL TOLERANCE.				TITLE	DWG. No.	SCALE
DWG.	DATE		DW 5	UNIT		
CHK.	DATE		RECEPTACLE	mm		
APP.	DATE		20597	SIZE	SHEET 5/5 REV. 7	
				A3		