

CABLIN[®]-CBL

较低嵌合高度(嵌合高度 = 0.825mm), 机械锁扣, 带屏蔽, 多点接地设计, 0.4mm间距, 水平插拔款的极细同轴线连接器

Product Specifications:

| | | |
|--------------------|------------|--------------------------|
| Mating type | Horizontal | |
| Board Pitch (mm) | 0.4 | |
| Wiping Length (mm) | 0.44 | |
| Mated size (mm) | Height | 0.825 +/- 0.15 |
| | Width | Formula: 6.44 + (0.4*?p) |
| | Depth | 5.44 |
| Pin Counts | Range | Up to 40 |
| | Available | 30, 40 |

Applicable Cable Size:

| | |
|--------------------------------|--|
| Maximum O.D. (mm) | 0.4 |
| Micro-Coaxial for Signal (AWG) | 45 ohm: #40 or smaller wire 50 ohm: #40 or smaller wire |
| Twinax (AWG) | - |
| Discrete (AWG) | #36 or smaller wire |

Applicable Standards (Reference Only):

USB 3.1 Gen 1 (5 Gbps) V-By-One HS 1.4 (4 Gbps)
HDMI 1.3 (3.4 Gbps)

*如果您需要了解未列出或不在范围内的Pin数, 请咨询我们。

*较低高度 0.4 mm 间距连接器 CABLINE[®]-CAL (组合高度: 最高0.8 mm) 也可提供。



低背型连接器: 0.975mm max. 0.825mm nominal

| CABLIN [®] -CBL 40p | | | | CABLIN [®] -CAL 40p (低高度连接器) | | | |
|--|------|---------------------|--|--|------|-------------------|--|
| 宽度 | | 高度 | | 宽度 | | 高度 | |
| 深度 | | 嵌合 | | 深度 | | 嵌合 | |
| CABLIN [®] -CBL 40p 公母座嵌合状态尺寸 (mm) | | | | CABLIN [®] -CAL 40p 公母座嵌合状态尺寸 (mm) | | | |
| 宽度 | 深度 | 高度 | | 宽度 | 深度 | 高度 | |
| 22.44 | 5.44 | 0.825 (最高 0.975) | | 24.05 | 5.50 | 0.70 (最高 0.80) | |

可选机械锁扣, 可以防止连接器不完全插入或者连接器的脱落

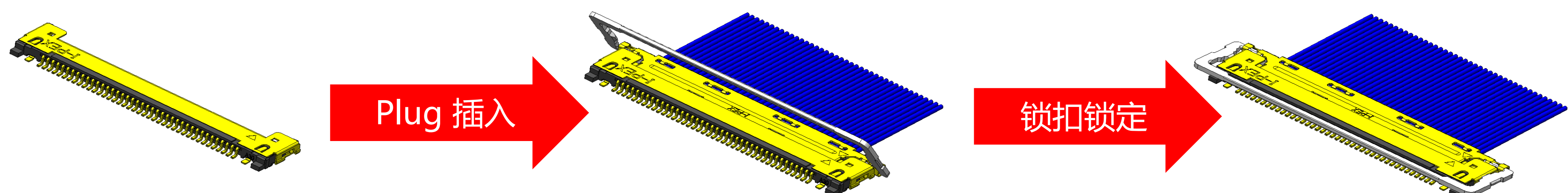

只有当 Plug 完全插入母座, 机械锁扣才能顺利锁上。

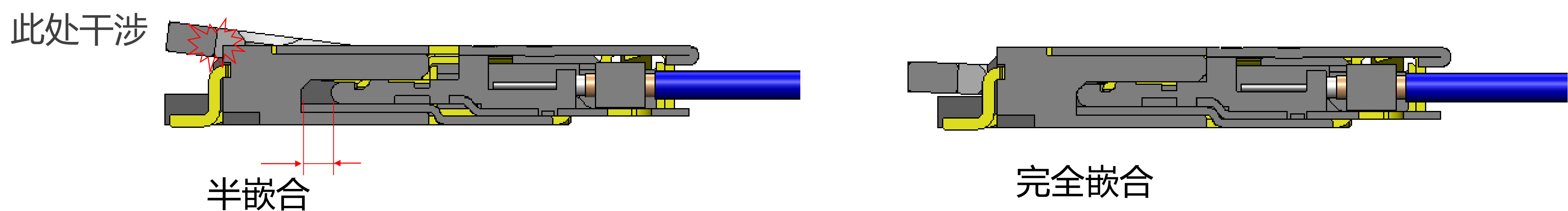

多点接地设计具有良好的抗EMI 性能

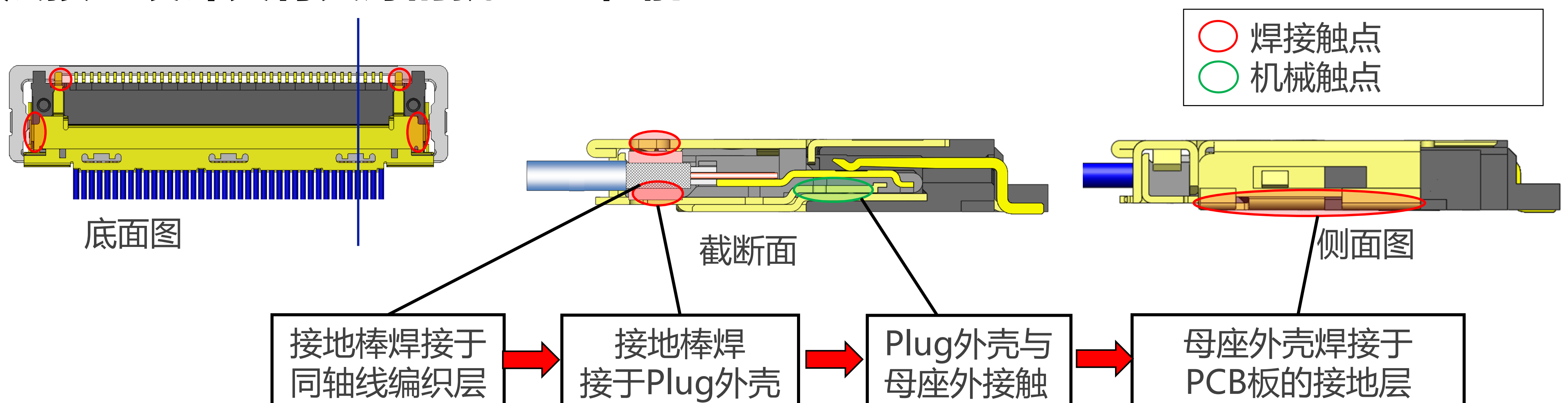

Component Parts Details

Component Parts

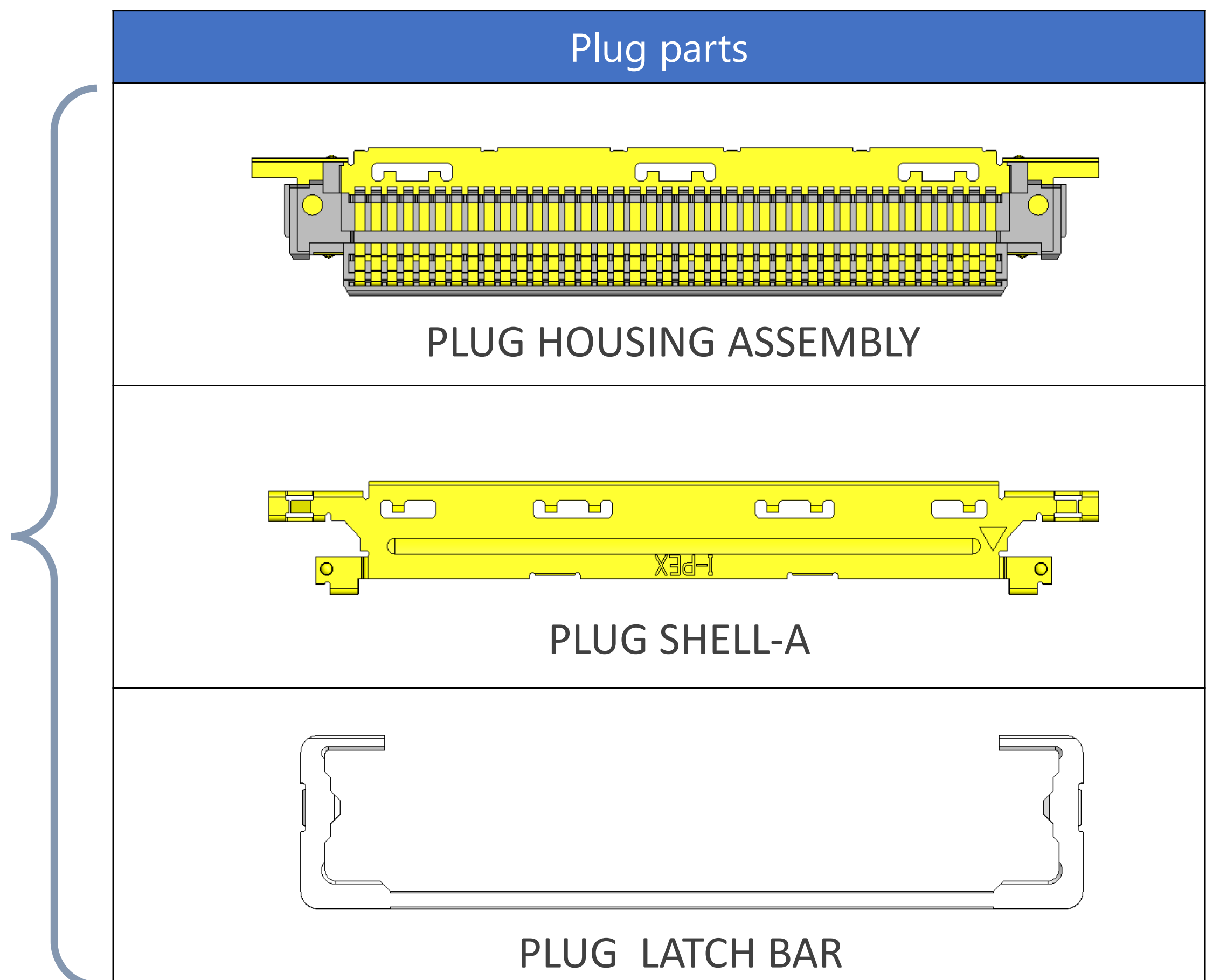
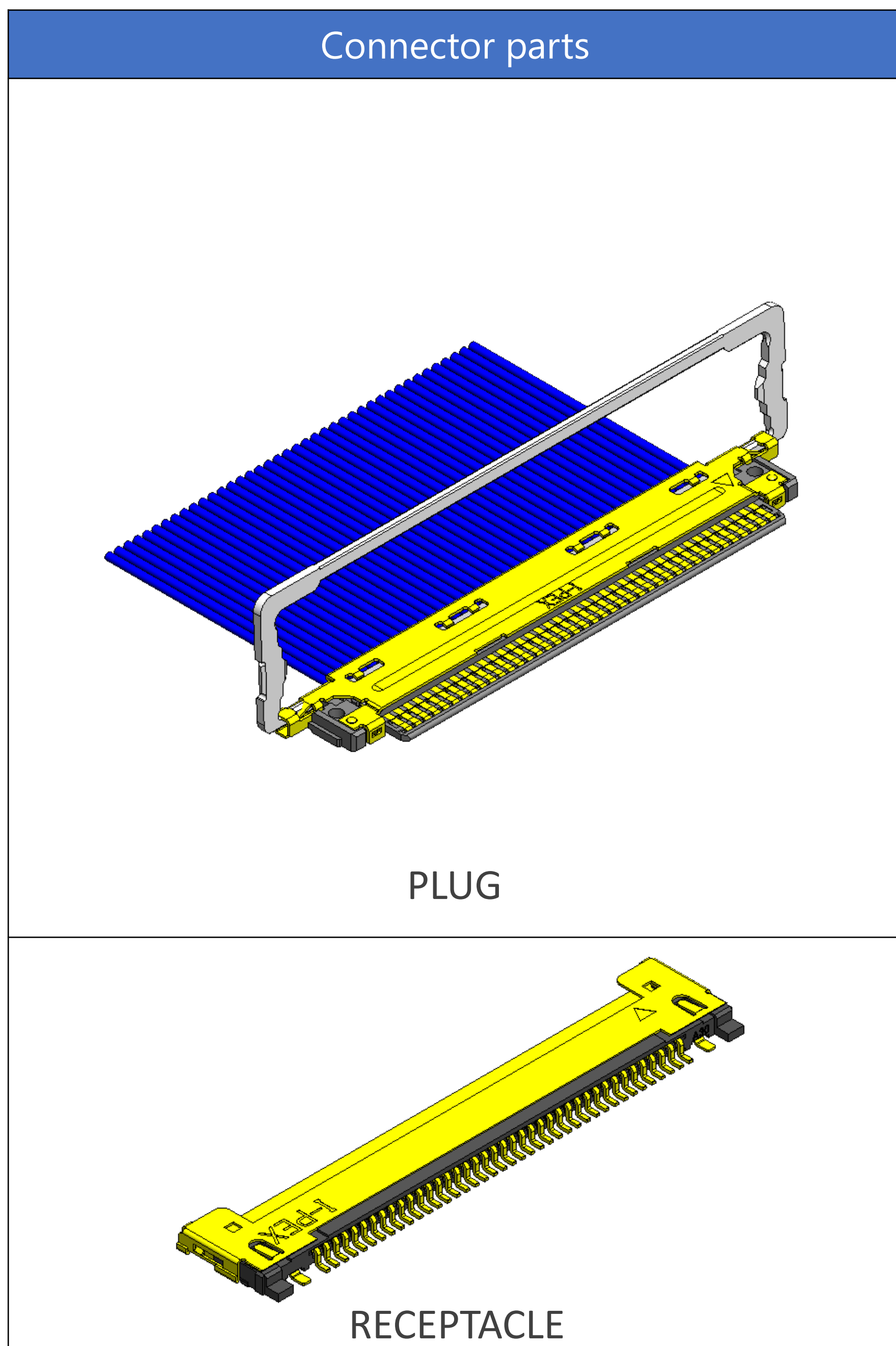

Plug for Cable Assembly

| Recommended P/N | | 20472-0**T-10 | | | |
|-----------------|------|---------------|-------|-------|-------|
| PART NO. | POS. | A | B | C | D |
| 20472-030T-10 | 30 | 11.60 | 12.40 | 18.44 | 13.00 |
| 20472-040T-10 | 40 | 15.60 | 16.40 | 22.44 | 17.00 |

P/N : 20472-***T-10

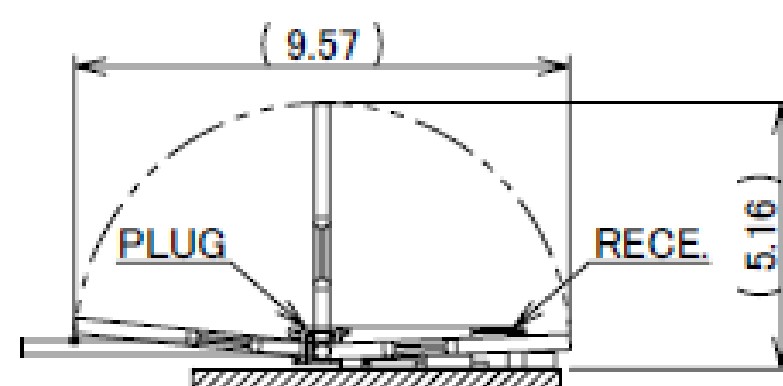
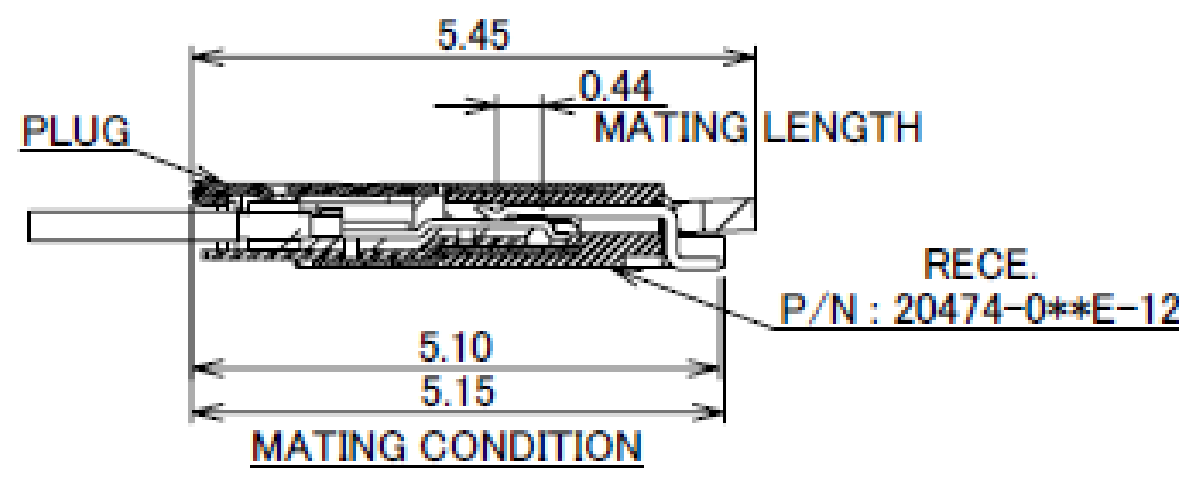
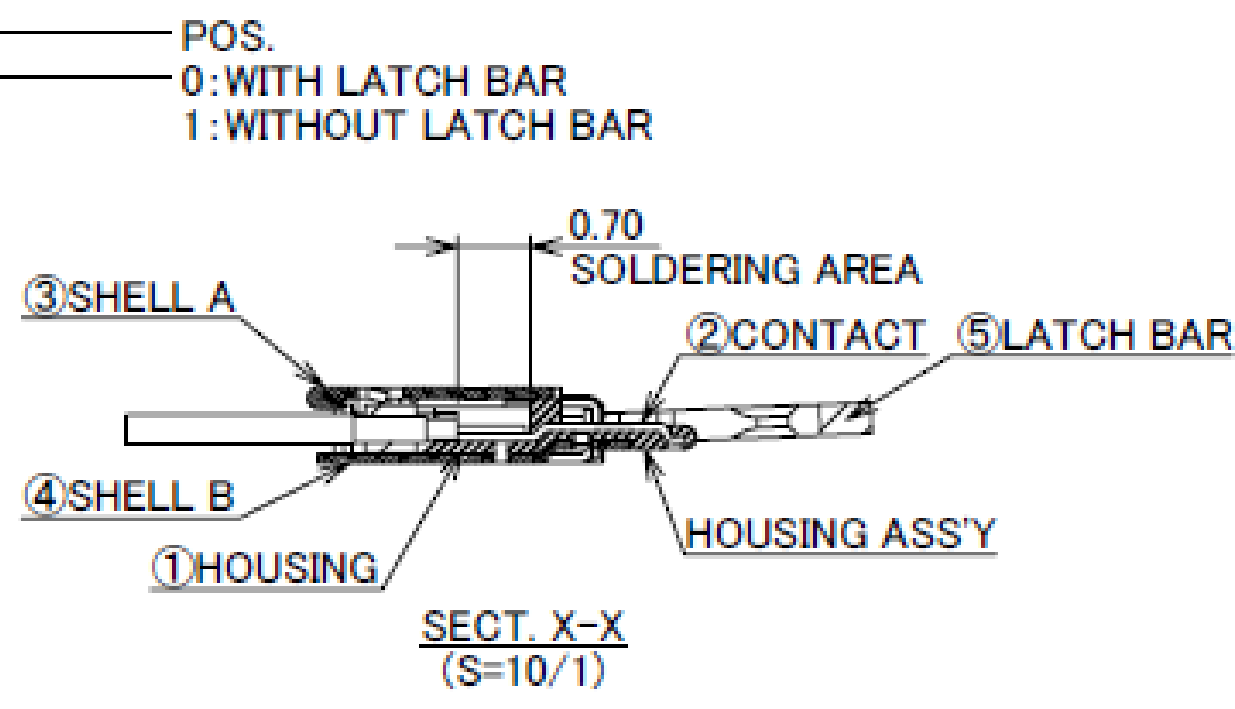
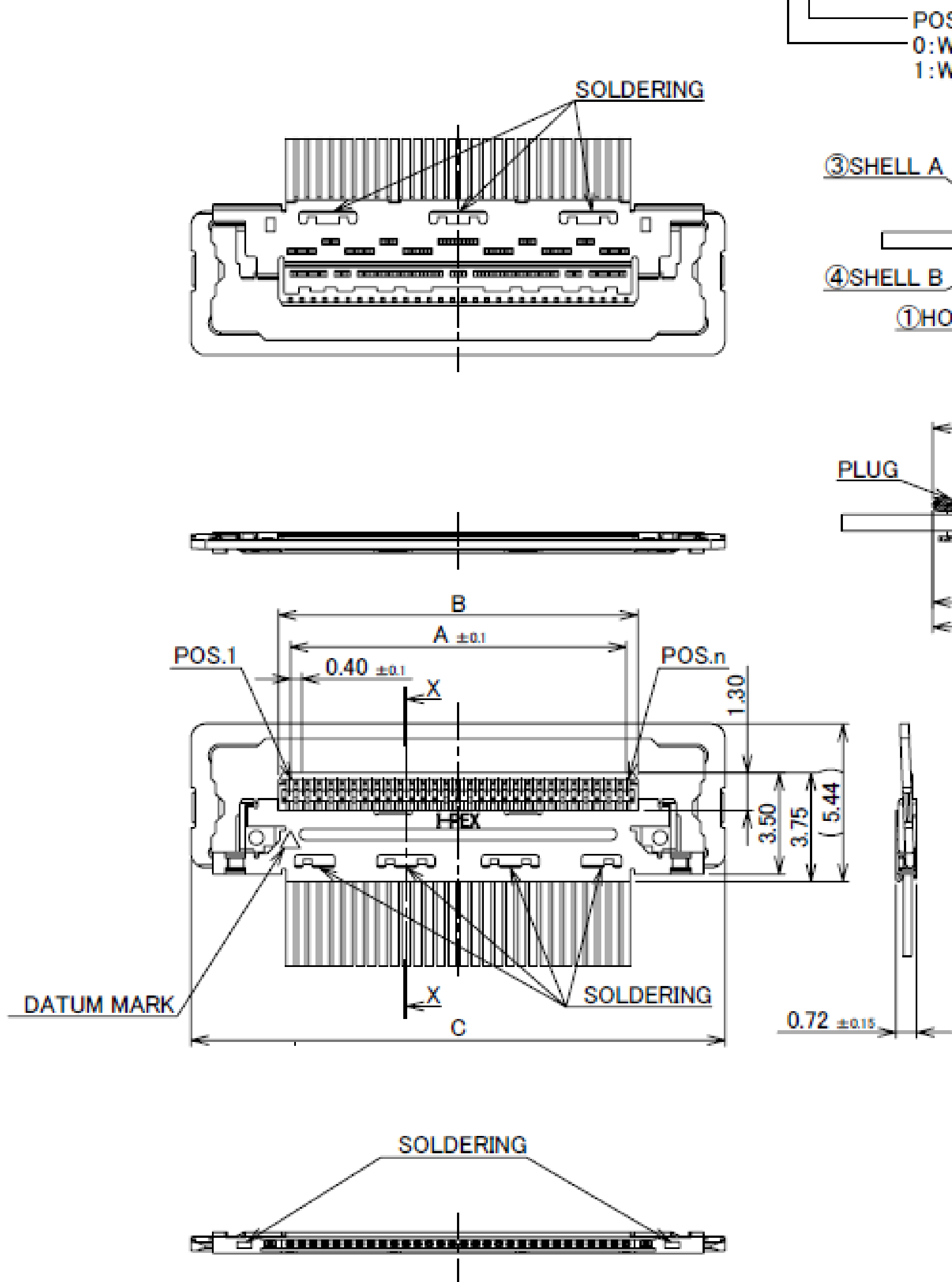

LATCH MOVEMENTS

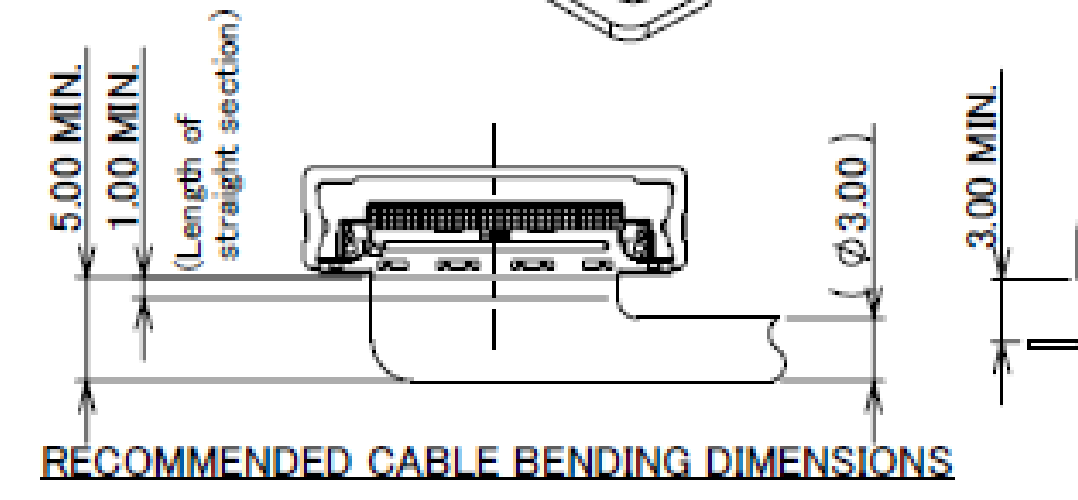
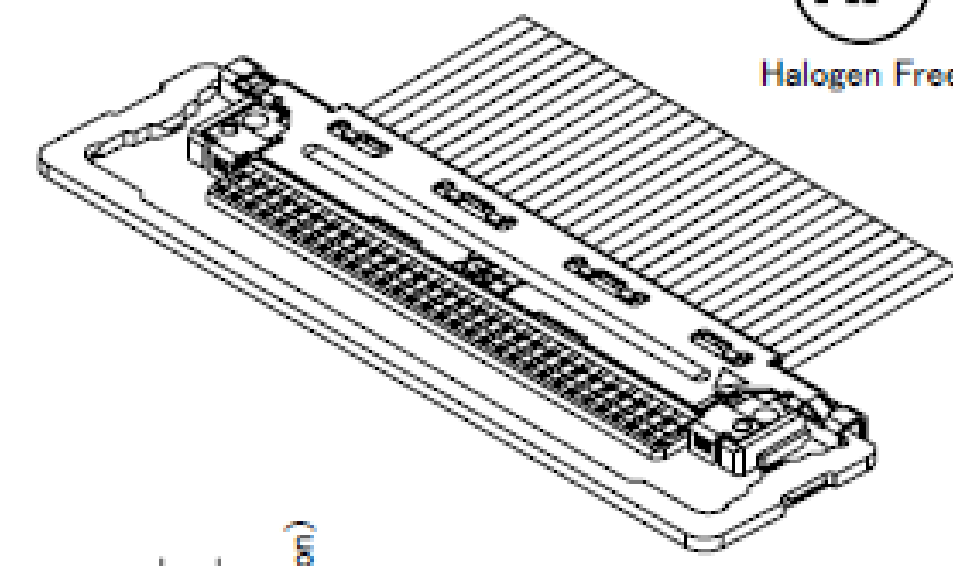

RECOMMENDED CABLE BENDING DIMENSIONS

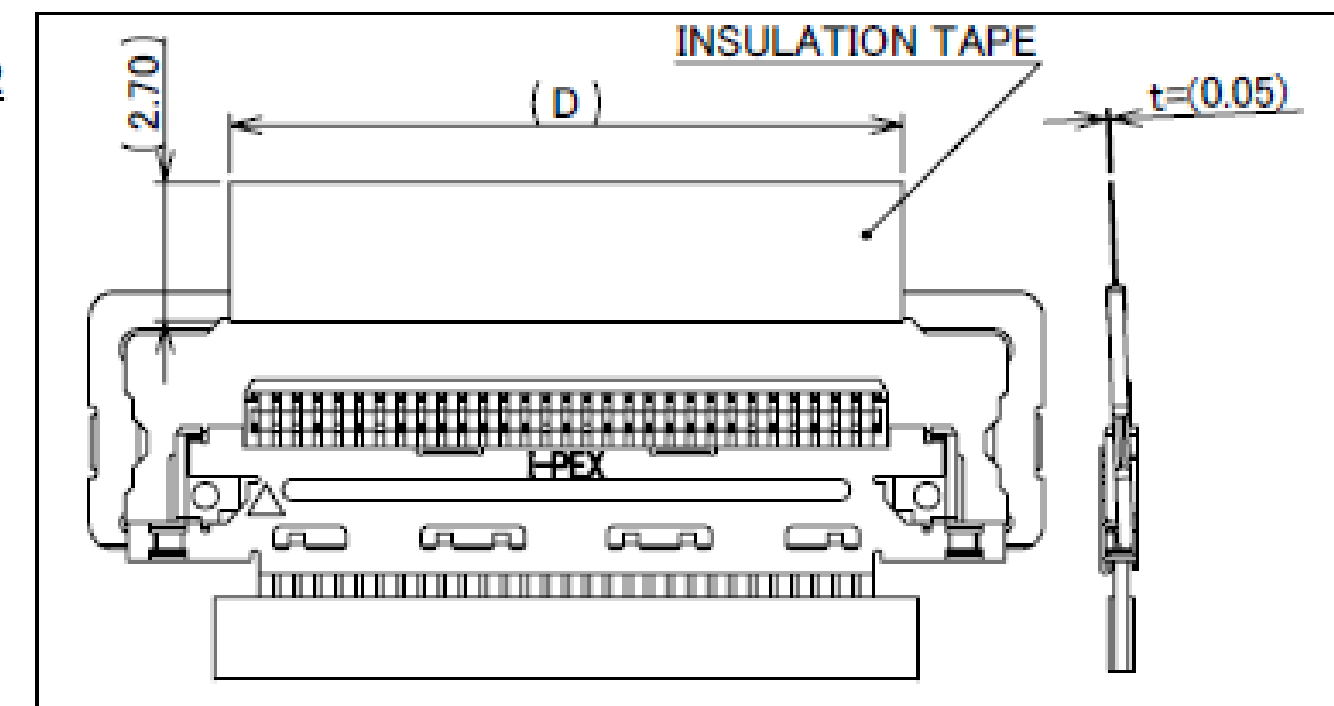

INSULATION TAPE RECOMMENDED DIMENSIONS

| NO. | DISCRIPTION | MATERIAL | FINISH , REMARKS |
|-----|-------------|-----------------|--------------------------------------|
| 5 | LATCH BAR | SUS | |
| 4 | SHELL B | PHOSPHOR BRONZE | Au 0.05 μm MIN. OVER Ni 1.00 μm MIN. |
| 3 | SHELL A | PHOSPHOR BRONZE | Au 0.05 μm MIN. OVER Ni 1.00 μm MIN. |
| 2 | CONTACT | PHOSPHOR BRONZE | Au 0.1 μm MIN. OVER Ni 1.00 μm MIN. |
| 1 | HOUSING | LCP | UL94V-0, BLACK |

WITH LATCH BAR

Rev.13

| Recommended P/N | | 20472-0**T-10 | | |
|-----------------|------|---------------|-------|-------|
| PART NO. | POS. | A | B | E |
| 20472-130T-10 | 30 | 11.60 | 12.40 | 16.94 |
| 20472-140T-10 | 40 | 15.60 | 16.40 | 20.94 |

P/N : 20472-***T-10

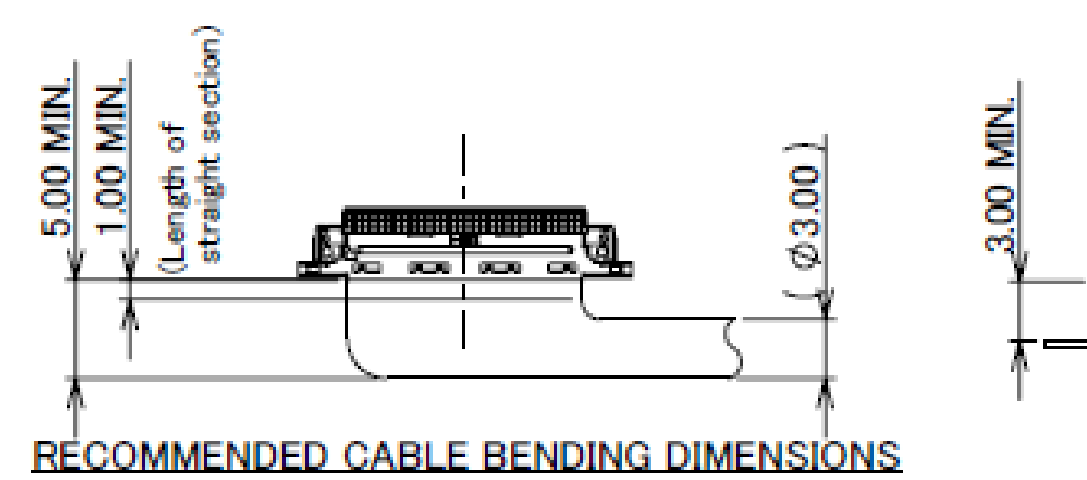
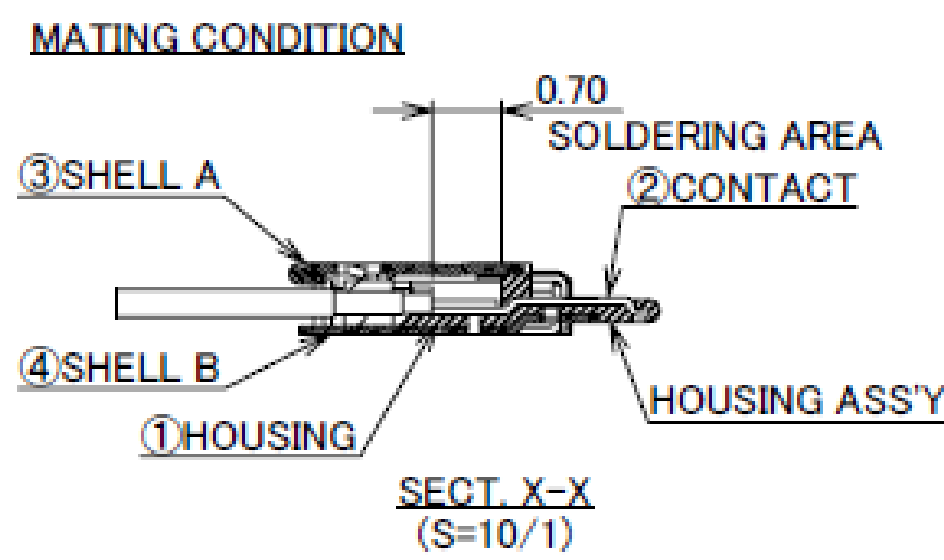
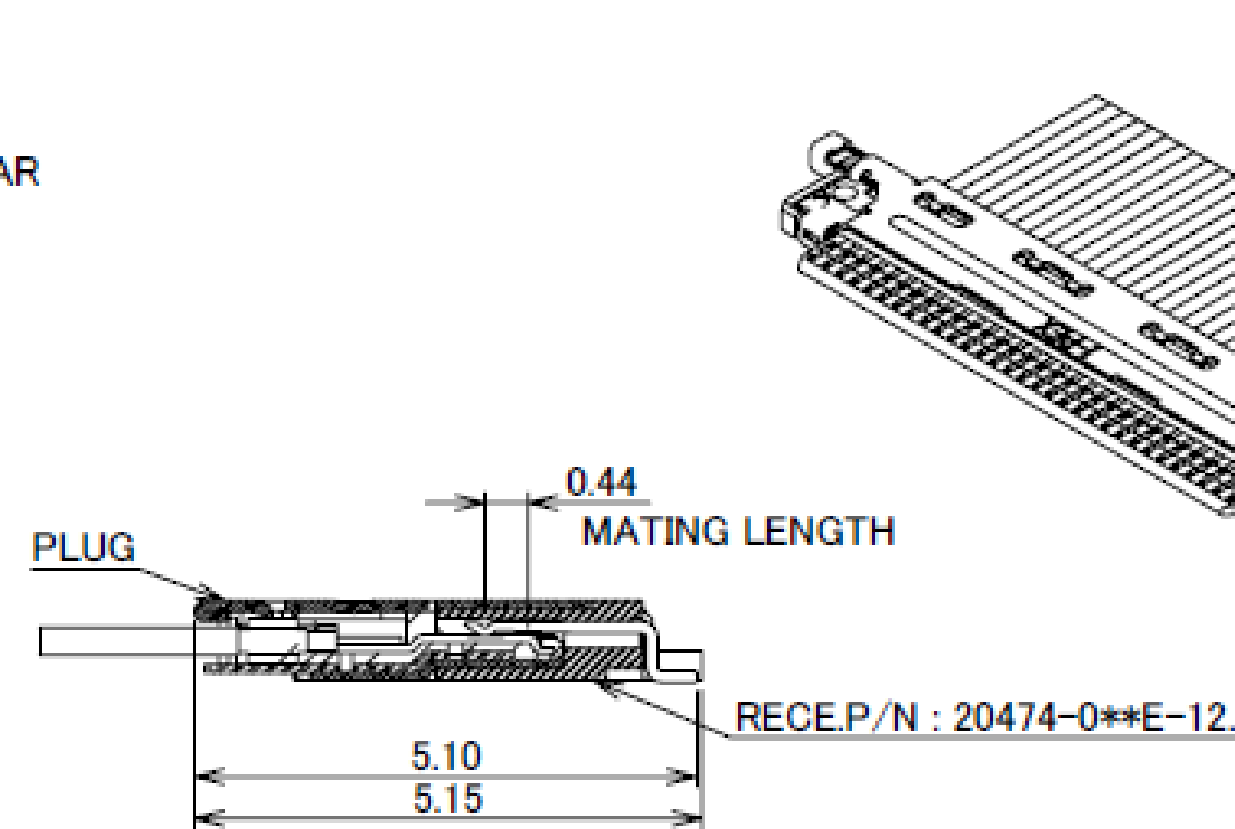
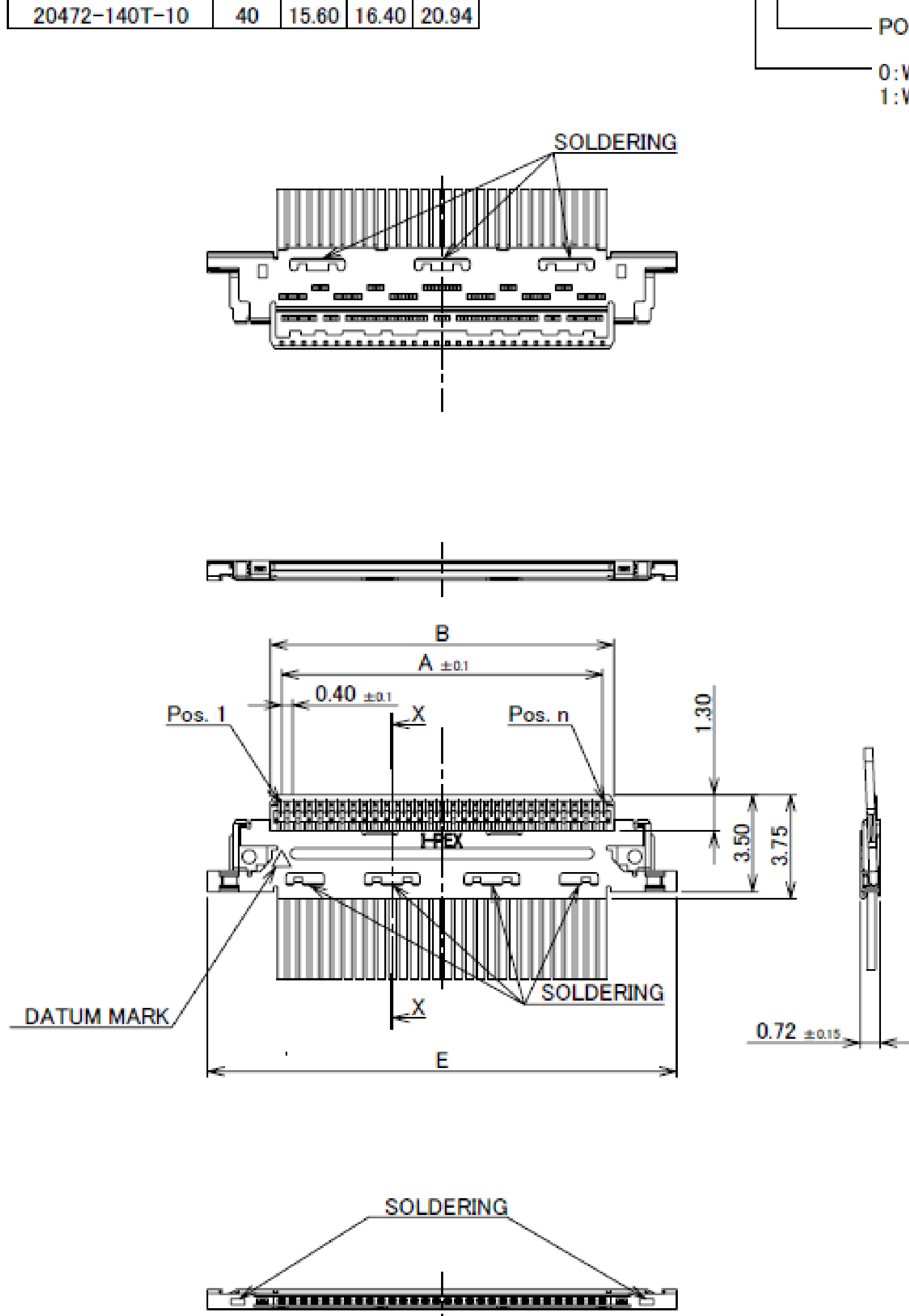

RECOMMENDED CABLE BENDING DIMENSIONS

WITHOUT LATCH BAR

Rev.13

Plug for Cable Assembly

| PART NO. | POS. | A |
|---------------|------|-------|
| 20472-#30T-10 | 30 | 11.60 |
| 20472-#40T-10 | 40 | 15.60 |

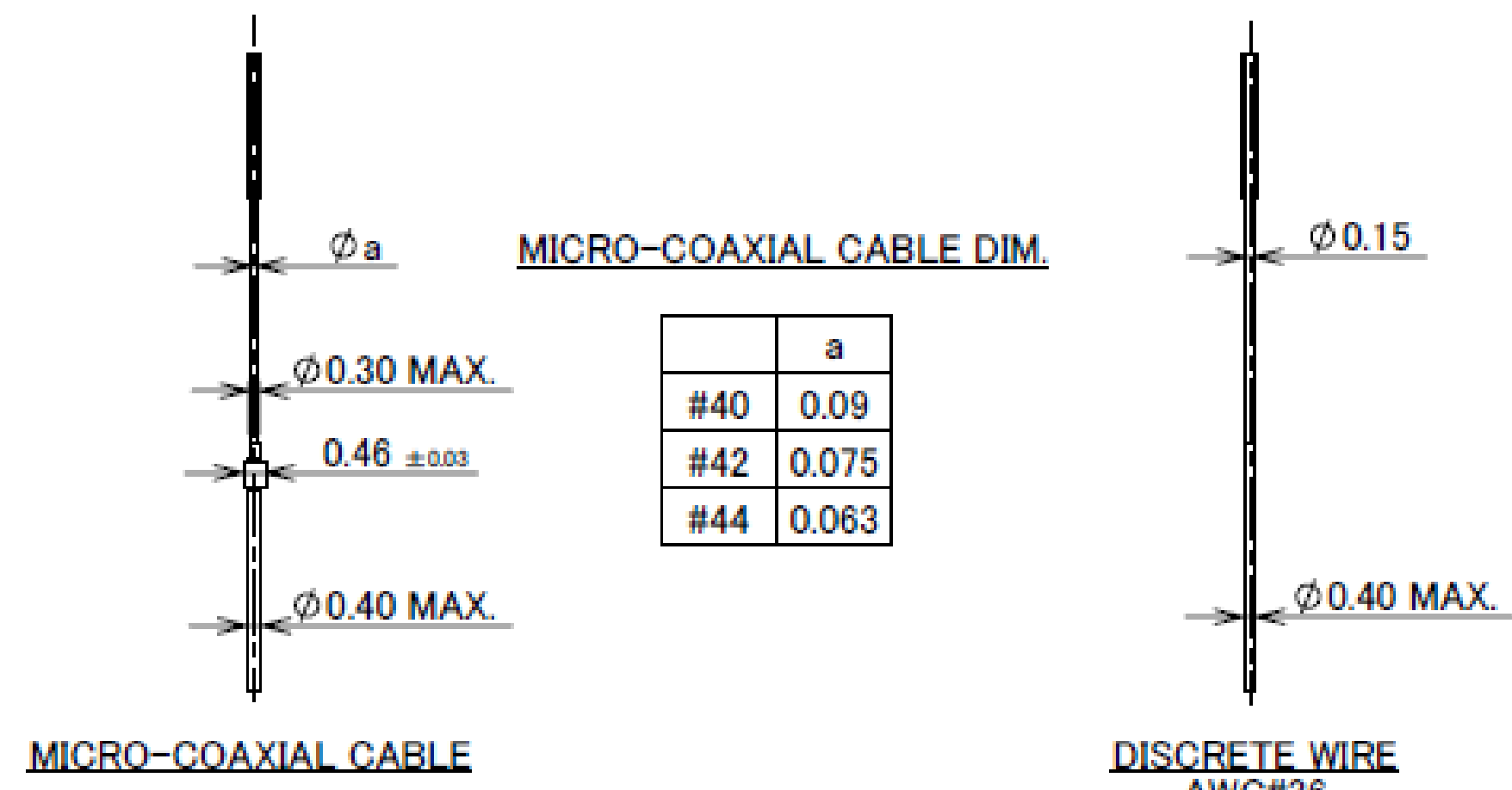
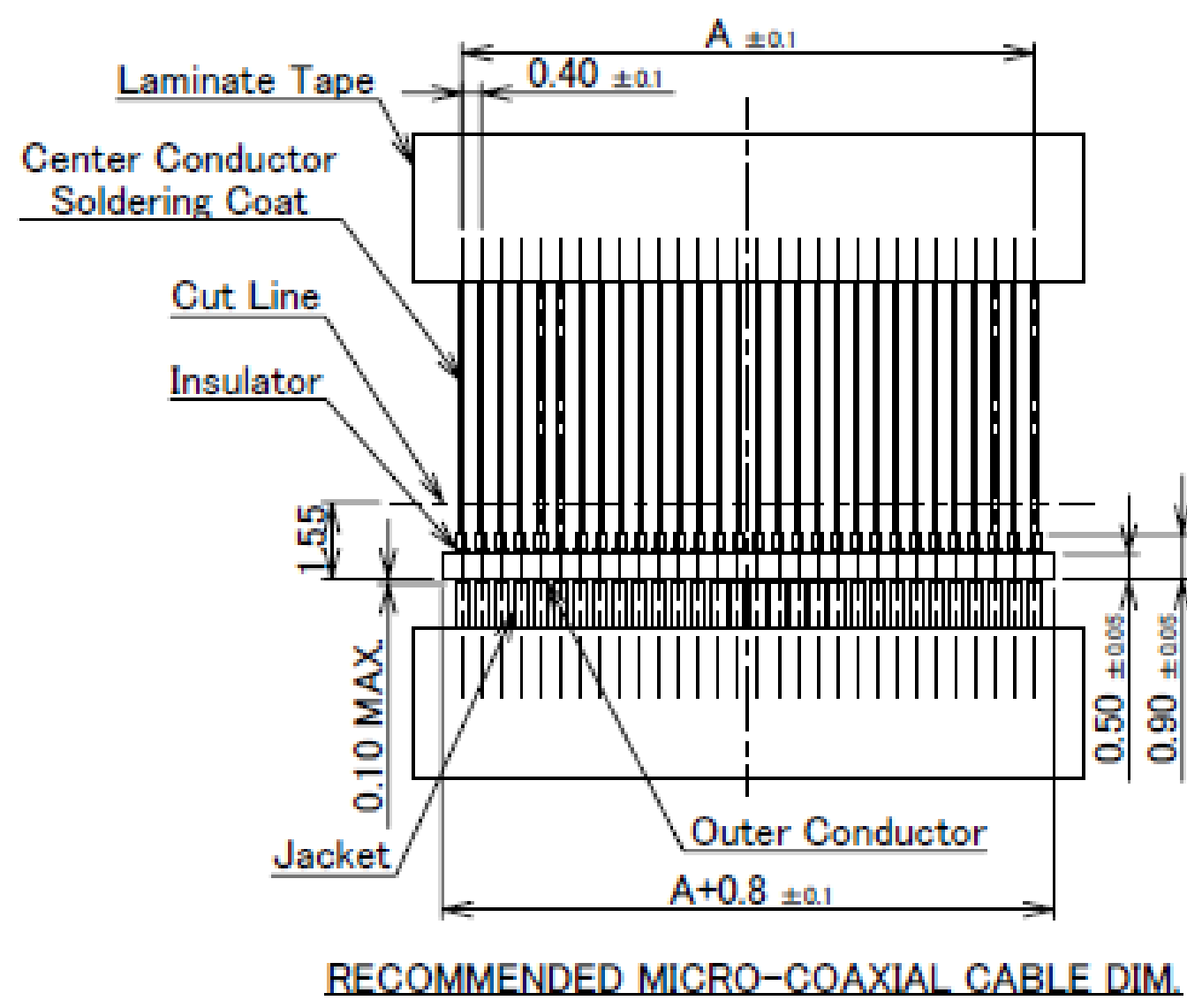

Rev.13

Plug Housing Assembly

| Recommended P/N | | 20473-0**T-10 | | | | | | | | | |
|-----------------|------|---------------|-------|-------|-------|-------|-------|-------|-------|-------|--|
| PART NO. | POS. | A | B | C | D | E | F | G | H | J | |
| 20473-030T-10 | 30 | 11.60 | 12.40 | 12.65 | 15.08 | 12.65 | 16.94 | 15.34 | 9.00 | 11.88 | |
| 20473-040T-10 | 40 | 15.60 | 16.40 | 16.65 | 19.08 | 16.65 | 20.94 | 19.34 | 13.00 | 15.88 | |

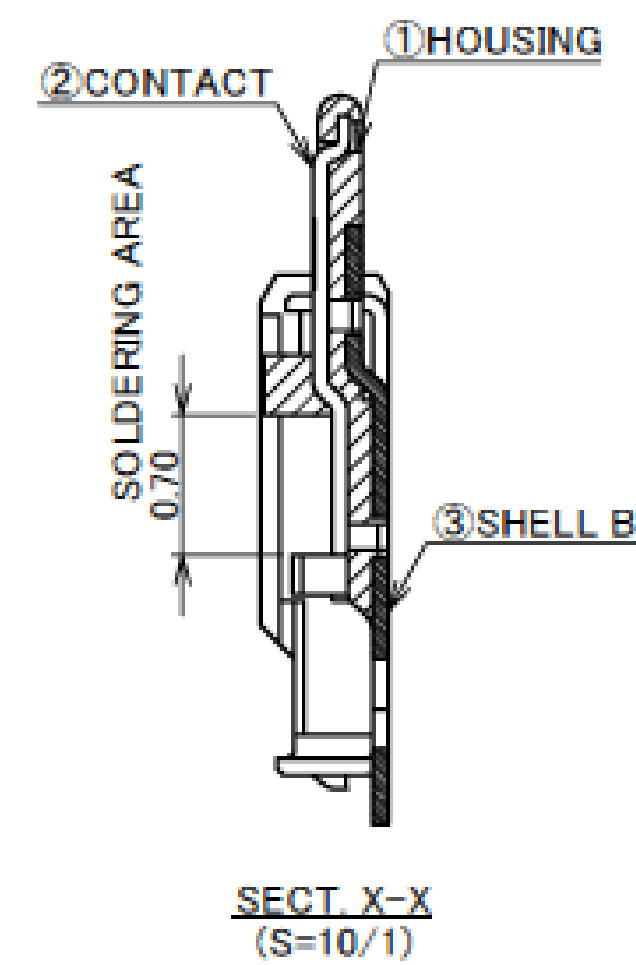
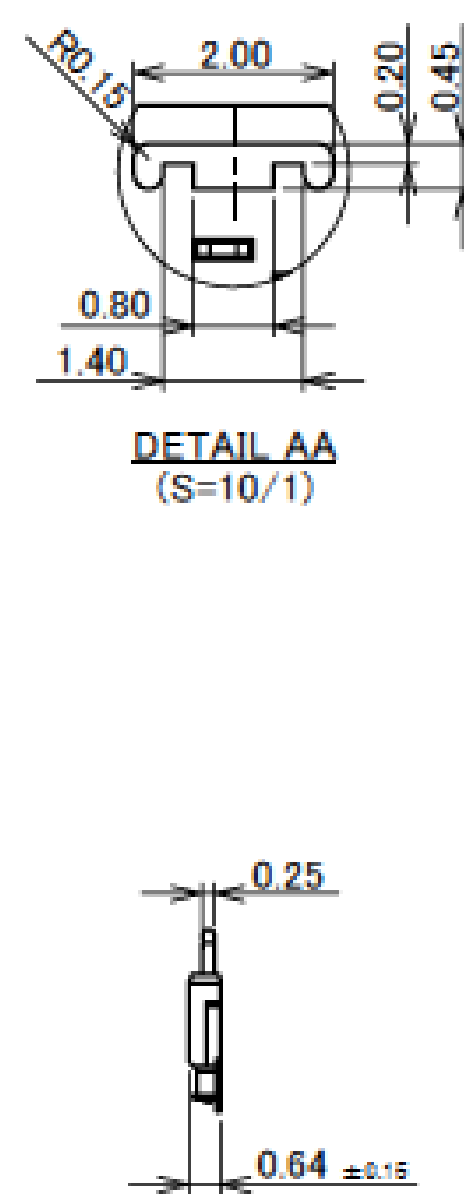
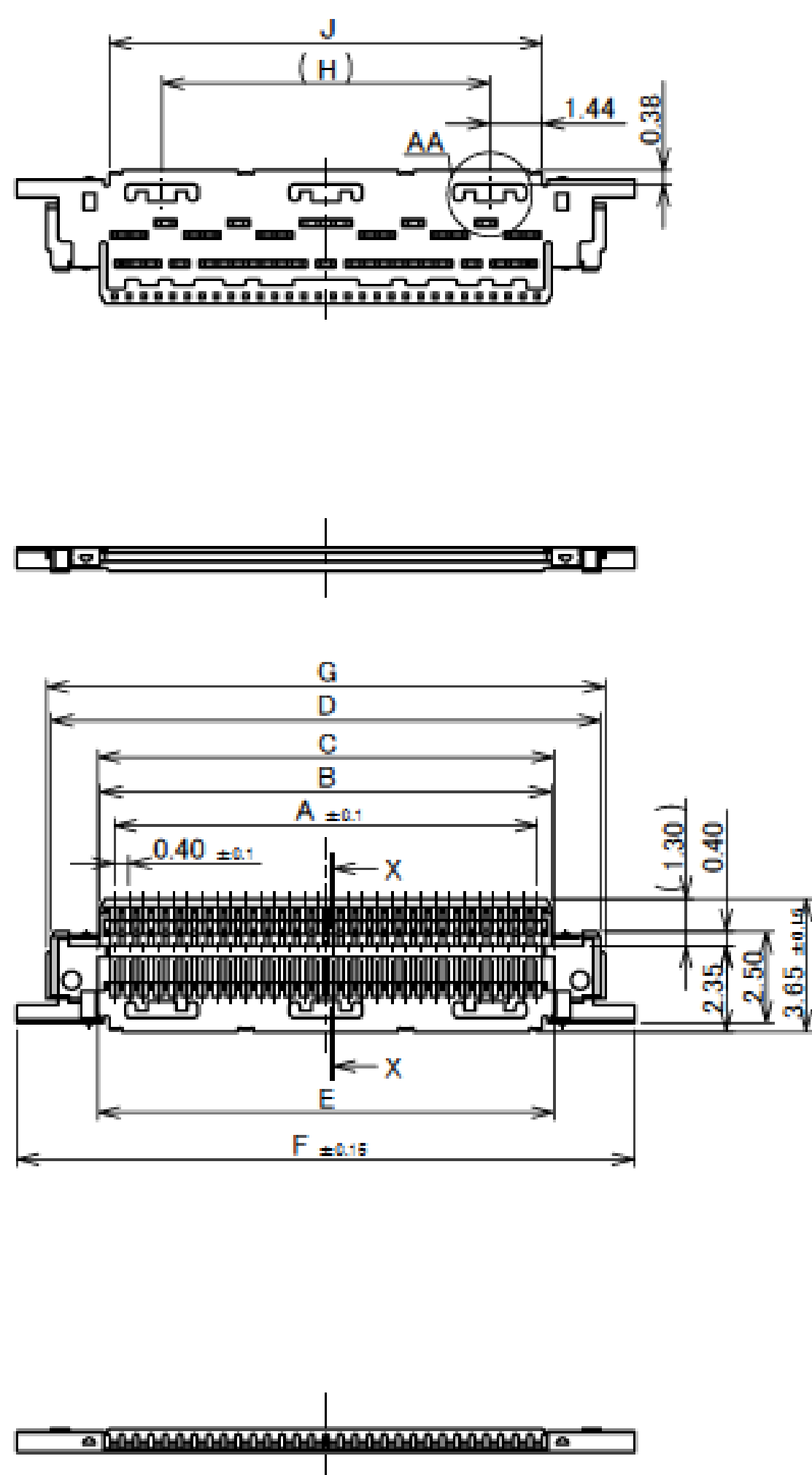

NOTES
 1. THIS PART IS ASSEMBLED WITH SHELL A(P/N 2618-0**1)
 AND LATCH BAR(P/N 2619-***0) AFTER SOLDERED THE CABLE,
 AND IT BECOMES P/N 20472-0**T-10

| NO. | DISCRIPTION | MATERIAL | FINISH . REMARKS |
|-----|-------------|-----------------|--------------------------------------|
| 3 | SHELL B | PHOSPHOR BRONZE | Au 0.05 μm MIN. OVER Ni 1.00 μm MIN. |
| 2 | CONTACT | PHOSPHOR BRONZE | Au 0.1 μm MIN. OVER Ni 1.00 μm MIN. |
| 1 | HOUSING | LCP | UL94V-0. BLACK |

Rev.6

Plug Shell-A

| Recommended P/N | | 2618-0**1 | | |
|-----------------|------|-----------|------|-------|
| PART NO. | POS. | A | B | C |
| 2618-0301 | 30 | 16.94 | 3.60 | 11.88 |
| 2618-0401 | 40 | 20.94 | 5.60 | 15.88 |

P/N:2618-0**1
POS.

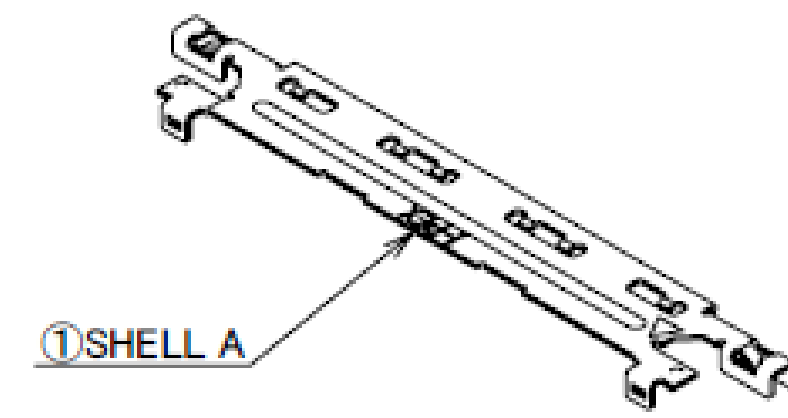
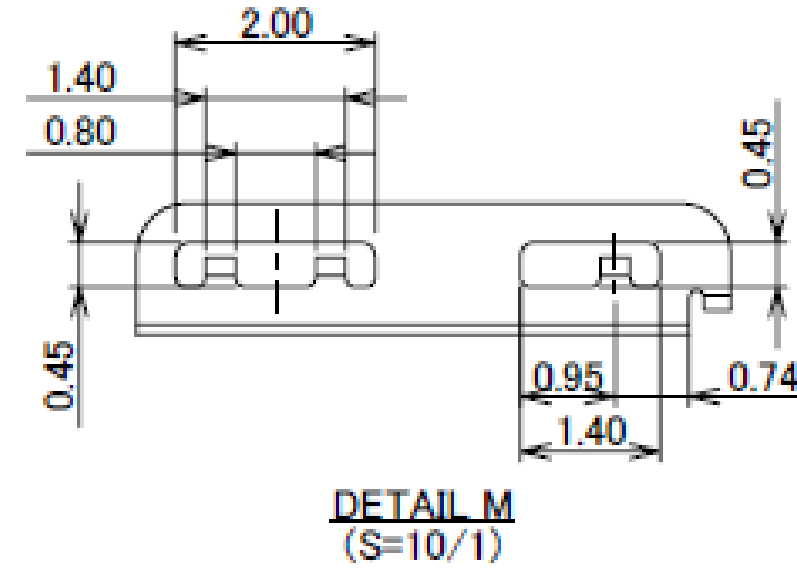
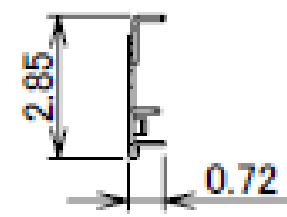
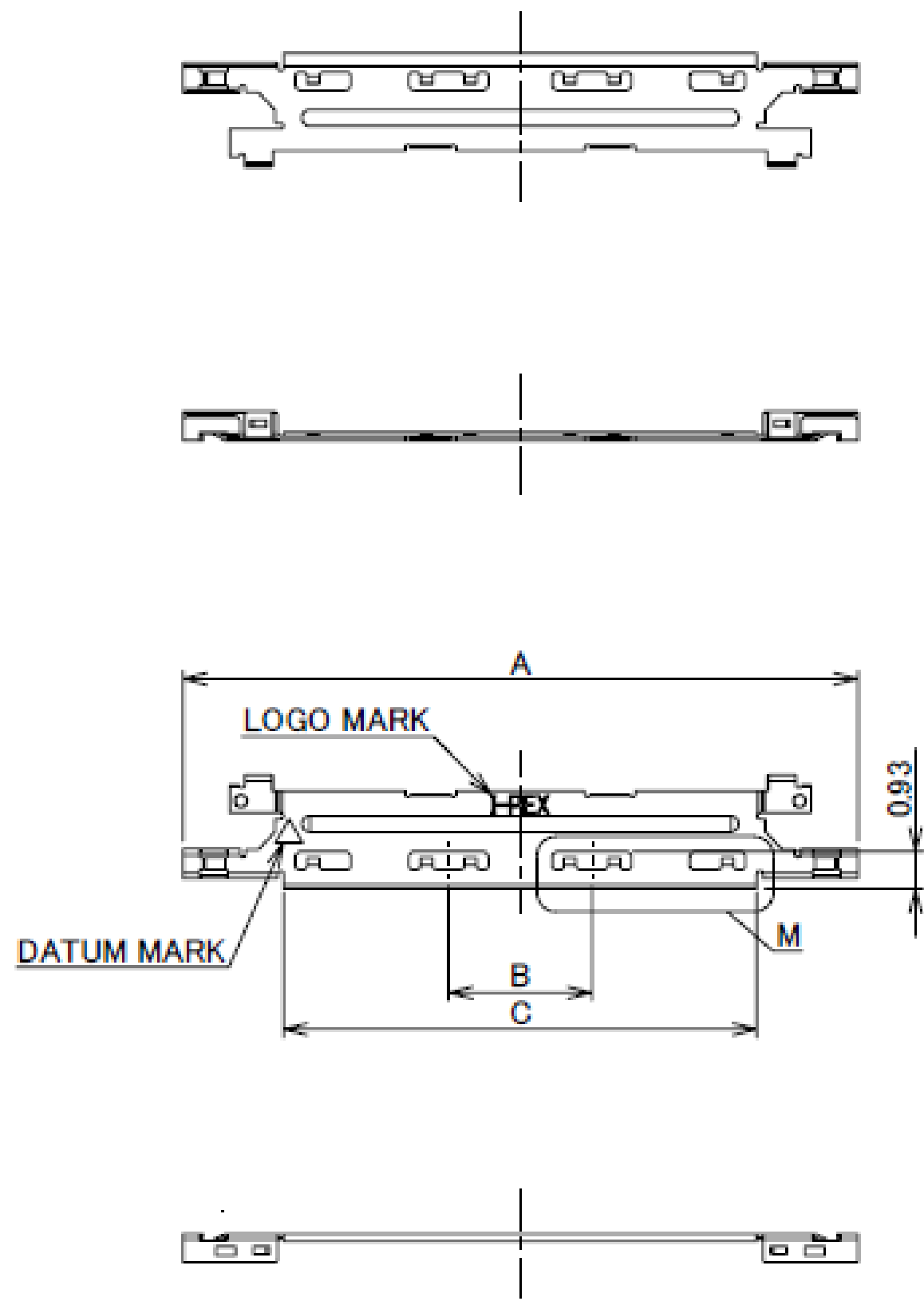
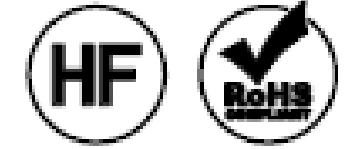

| NO. | DISCRIPTION | MATERIAL | FINISH , REMARKS |
|-----|-------------|-----------------|--------------------------------------|
| 1 | SHELL A | PHOSPHOR BRONZE | Au 0.05 μm MIN. OVER Ni 1.00 μm MIN. |

Rev.5

Plug Latch Bar

| Recommended P/N | | 2619-0**0 | |
|-----------------|------|-----------|-------|
| PART NO. | POS. | A | B |
| 2619-0300 | 30 | 18.44 | 13.00 |
| 2619-0400 | 40 | 22.44 | 17.00 |

2619-0**0
POS.

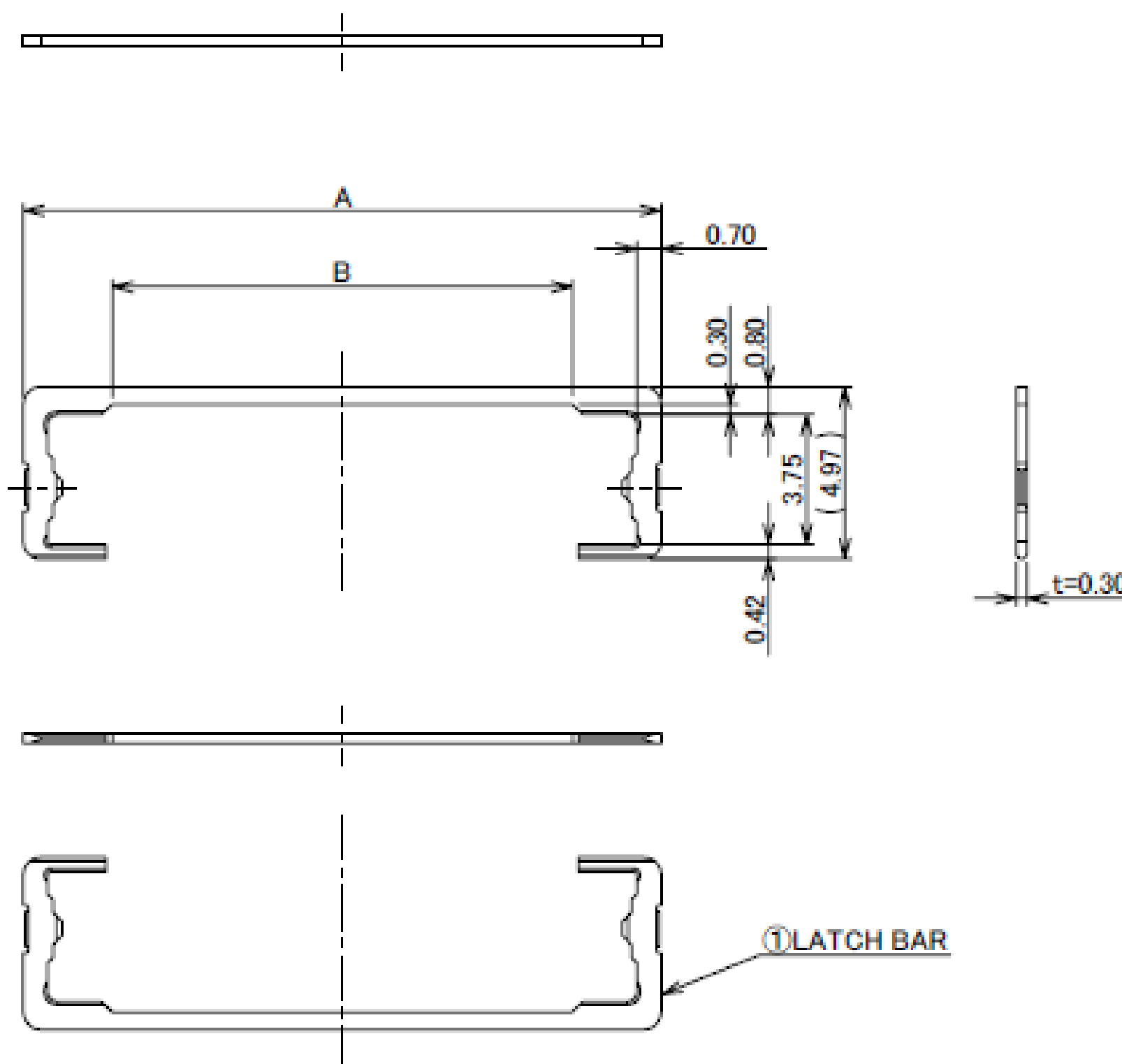

| NO. | DISCRIPTION | MATERIAL | FINISH , REMARKS |
|-----|-------------|----------|------------------|
| 1 | LATCH BAR | SUS | - |

Rev.7

Receptacle Assembly

| Recommended P/N | | 20474-0**E-12 | | | | |
|-----------------|------|---------------|-------|-------|-------|-------|
| PART NO. | POS. | A | B | C | G | S |
| 20474-030E-12 | 30 | 11.60 | 13.40 | 16.50 | 18.44 | 12.40 |
| 20474-040E-12 | 40 | 15.60 | 17.40 | 20.50 | 22.44 | 16.40 |

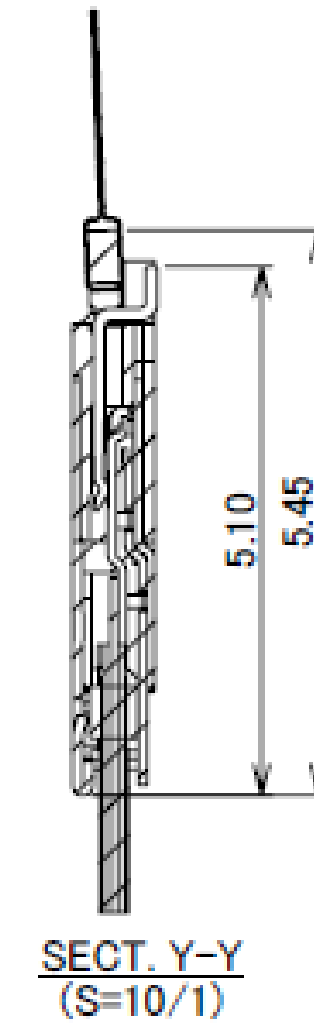
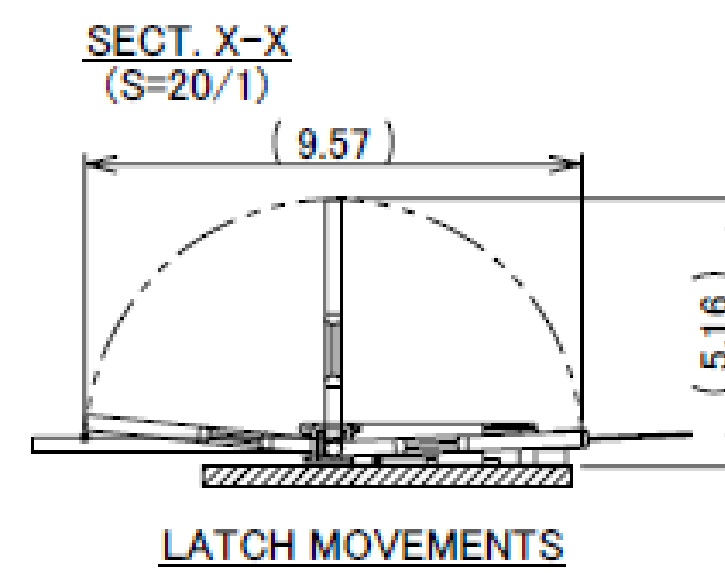
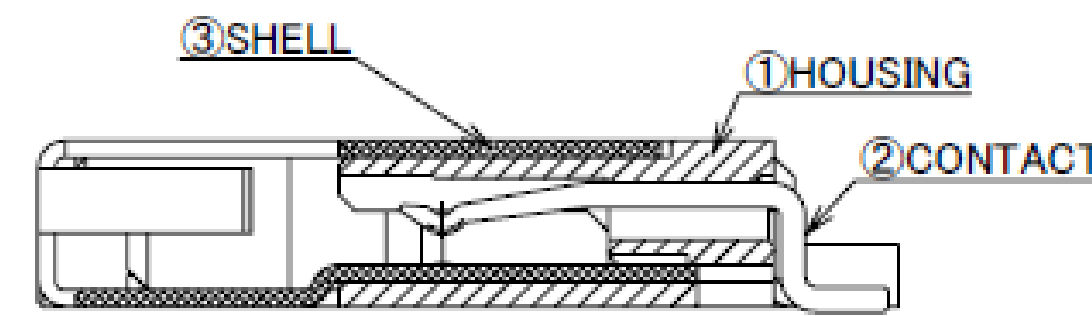
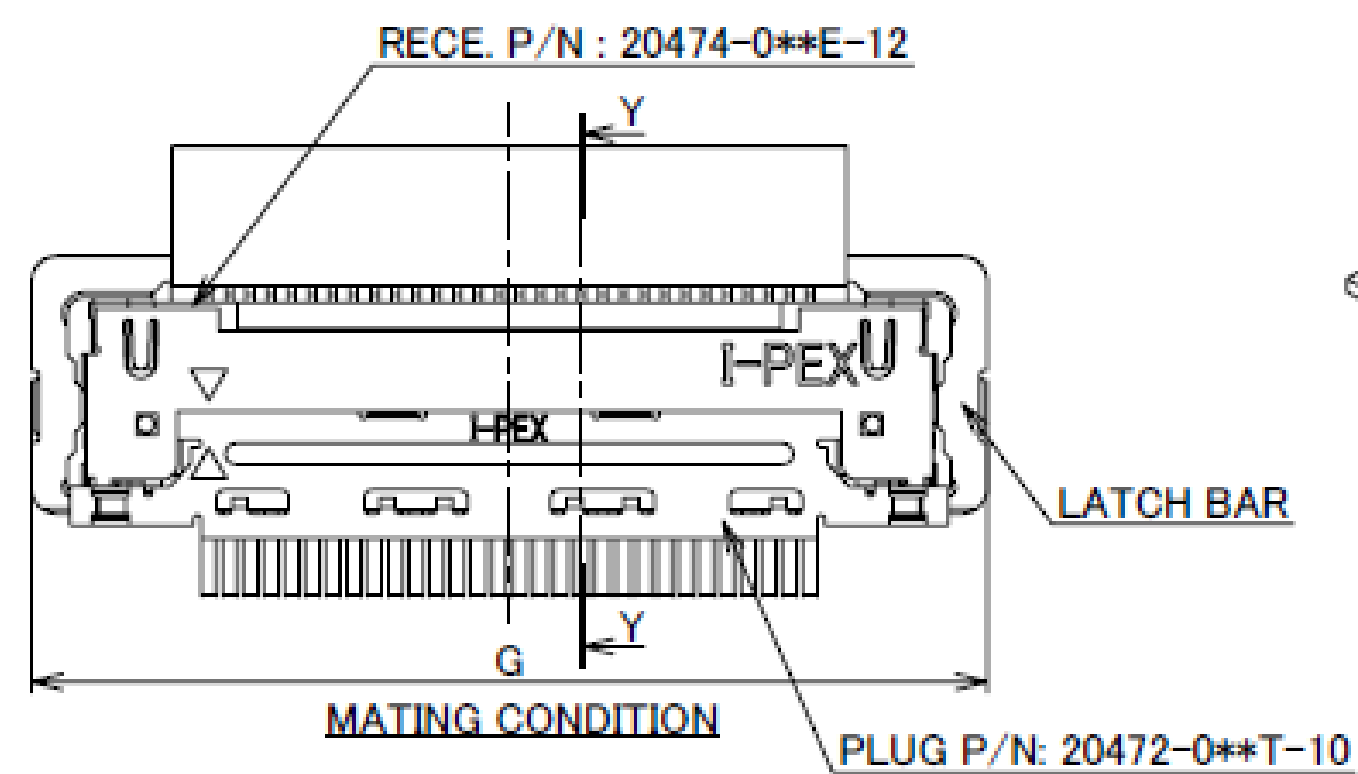
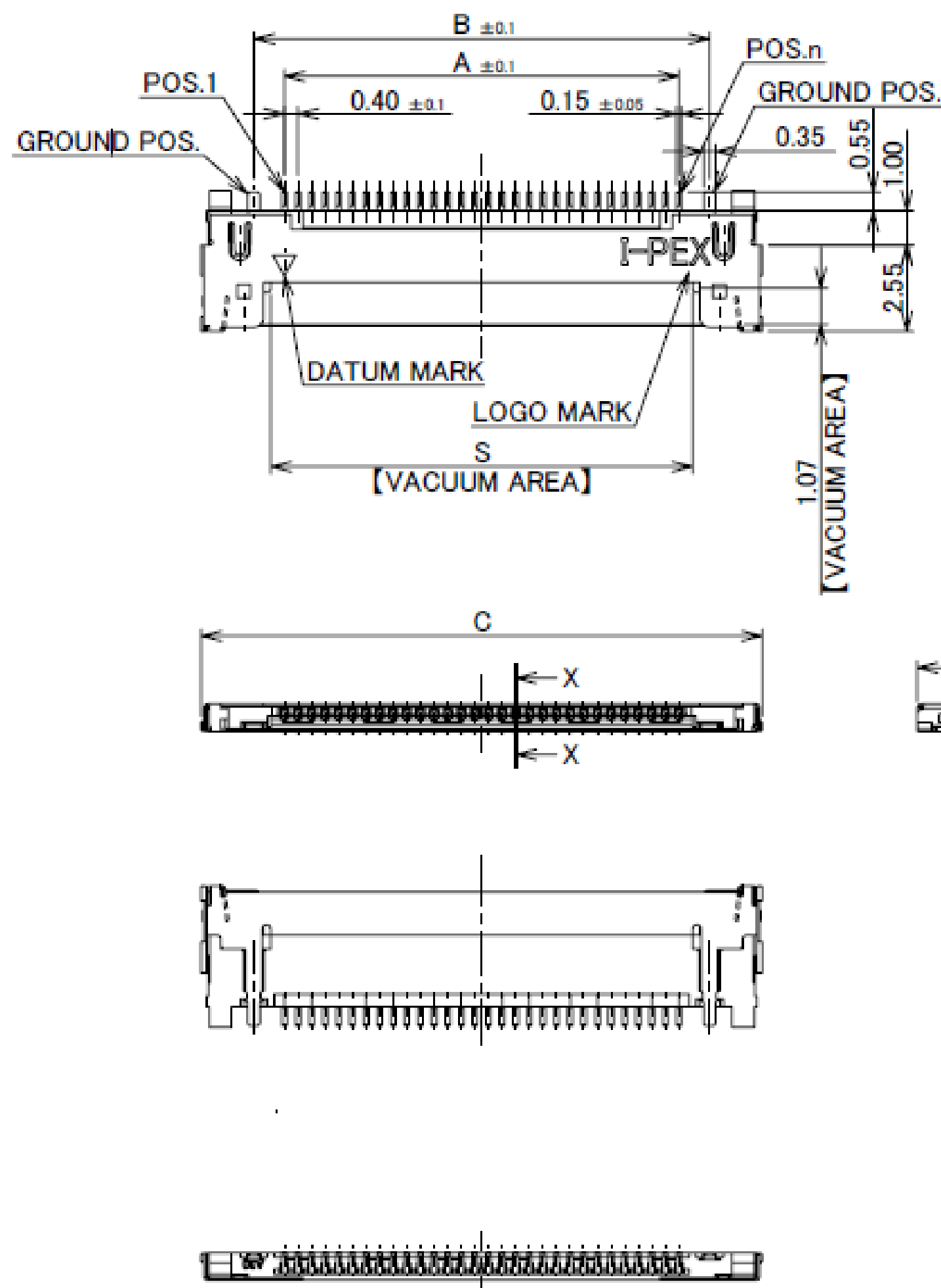

| NO. | DISCRIPTION | MATERIAL | FINISH . REMARKS |
|-----|-------------|-----------------|---|
| 3 | SHELL | PHOSPHOR BRONZE | Au 0.05 μm MIN. OVER Ni 1.00 μm MIN. |
| 2 | CONTACT | PHOSPHOR BRONZE | CONTACT AREA : Au 0.1 μm MIN. OVER Ni 1.00 μm MIN. SOLDERING AREA : Au 0.03 μm MIN. OVER Ni 1.00 μm MIN. |
| 1 | HOUSING | LCP | UL94V-0, BLACK |

Rev.13

| PART NO. | POS. | A | B | E | F | H | J | K |
|---------------|------|-------|-------|-------|-------|-------|-------|-------|
| 20474-030E-12 | 30 | 11.60 | 13.40 | 16.18 | 12.59 | 17.20 | 19.20 | 12.20 |
| 20474-040E-12 | 40 | 15.60 | 17.40 | 20.18 | 16.59 | 21.20 | 23.20 | 16.20 |

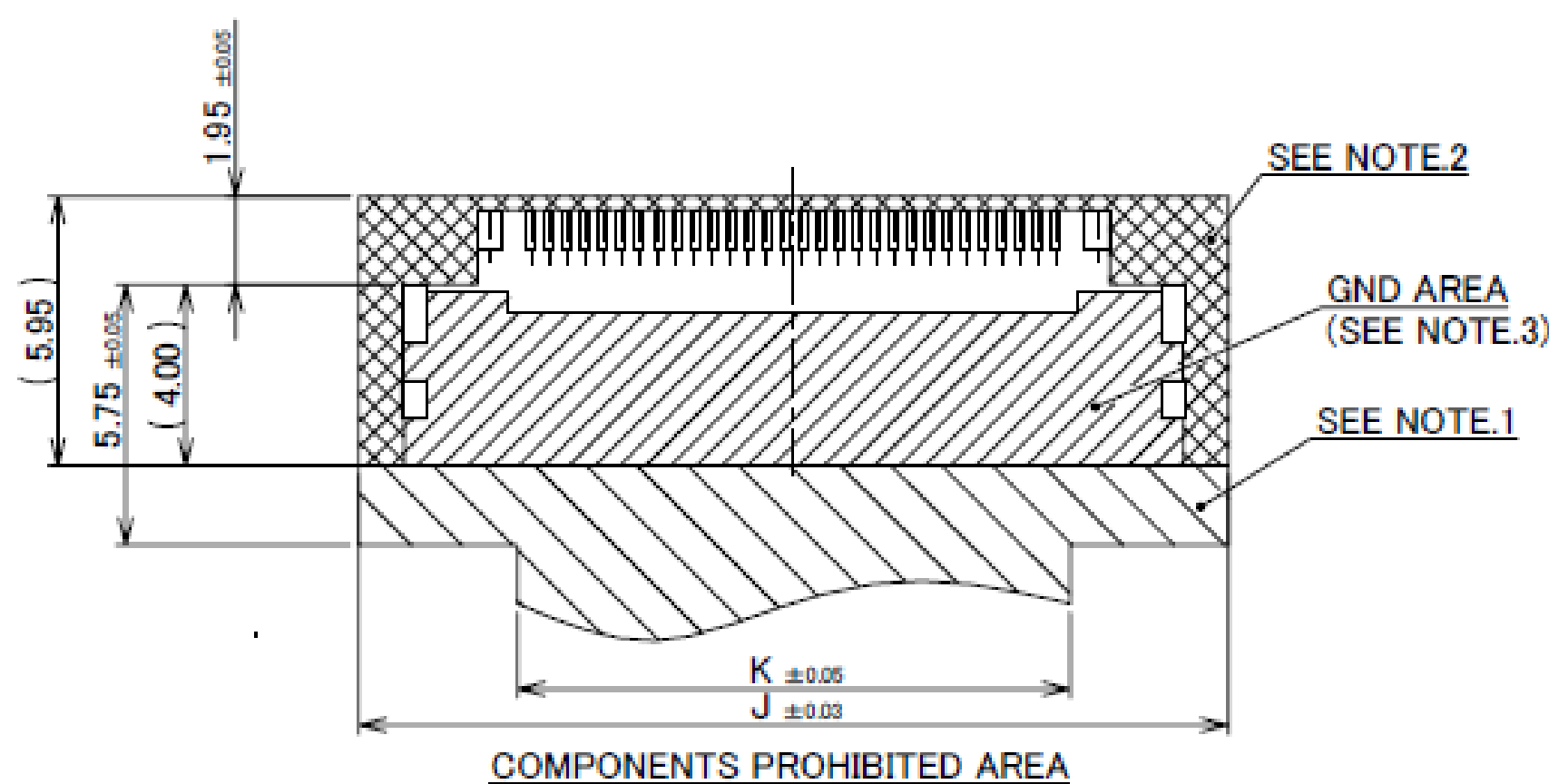
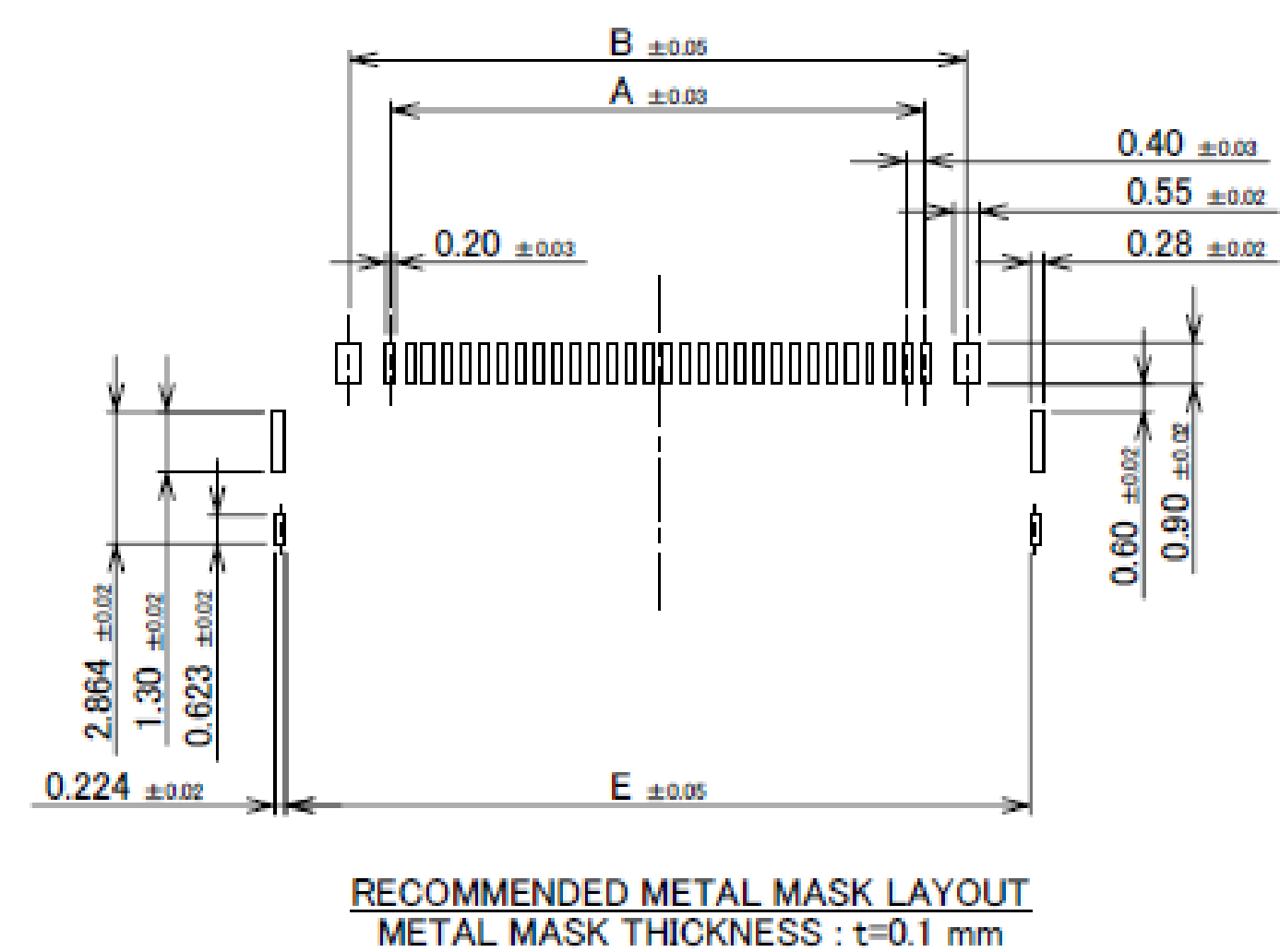
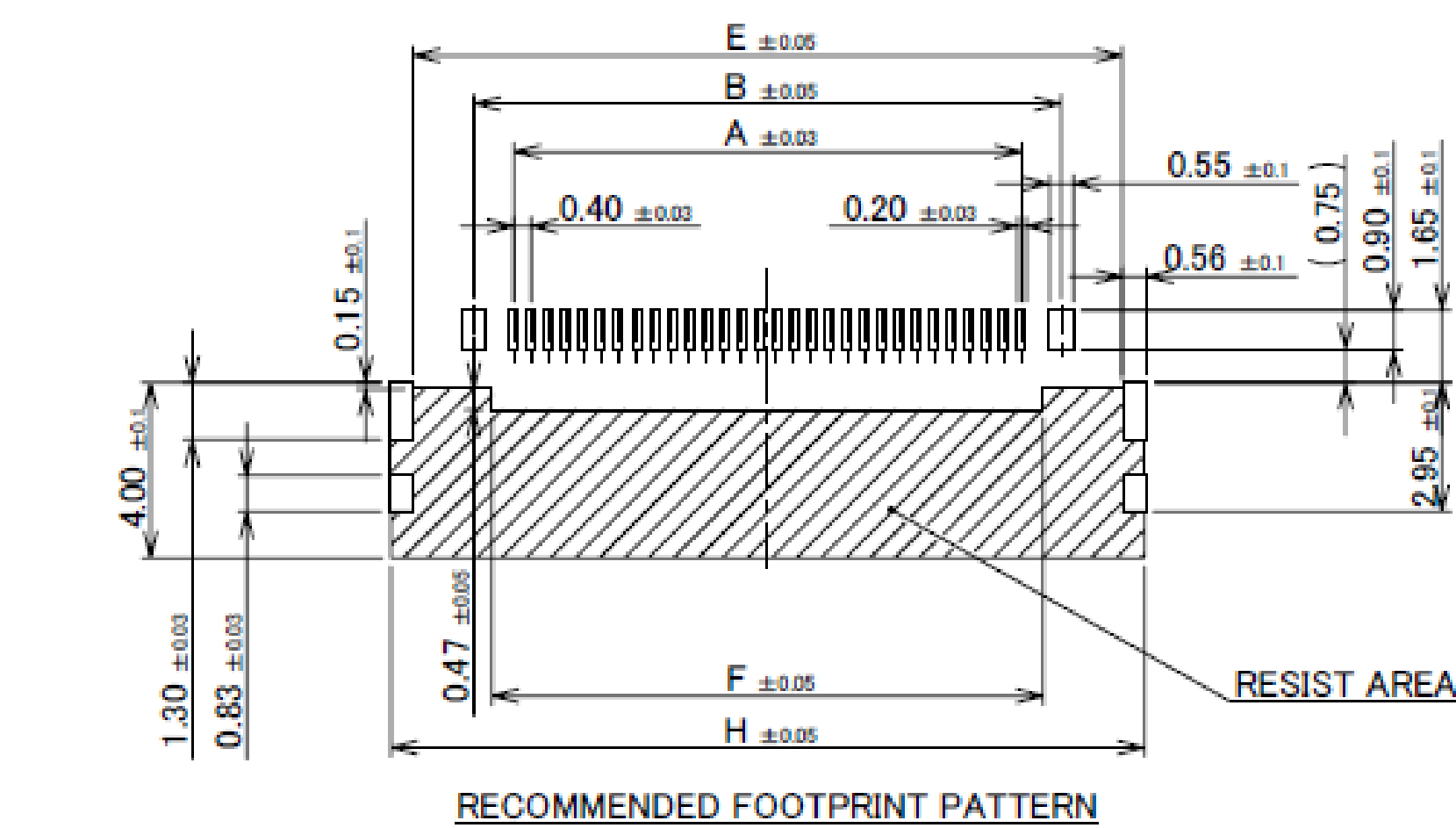

- NOTES.
1. DO NOT MOUNT ANOTHER COMPONENT IN THIS AREA.
2. IN CASE OF PLUG WITH LATCH BAR(20472-0**T-10), DO NOT MOUNT ANOTHER COMPONENT IN THIS AREA.
3. SODLER RESIST MUST BE APPLIED TO THIS AREA.

Rev.13

Receptacle Assembly

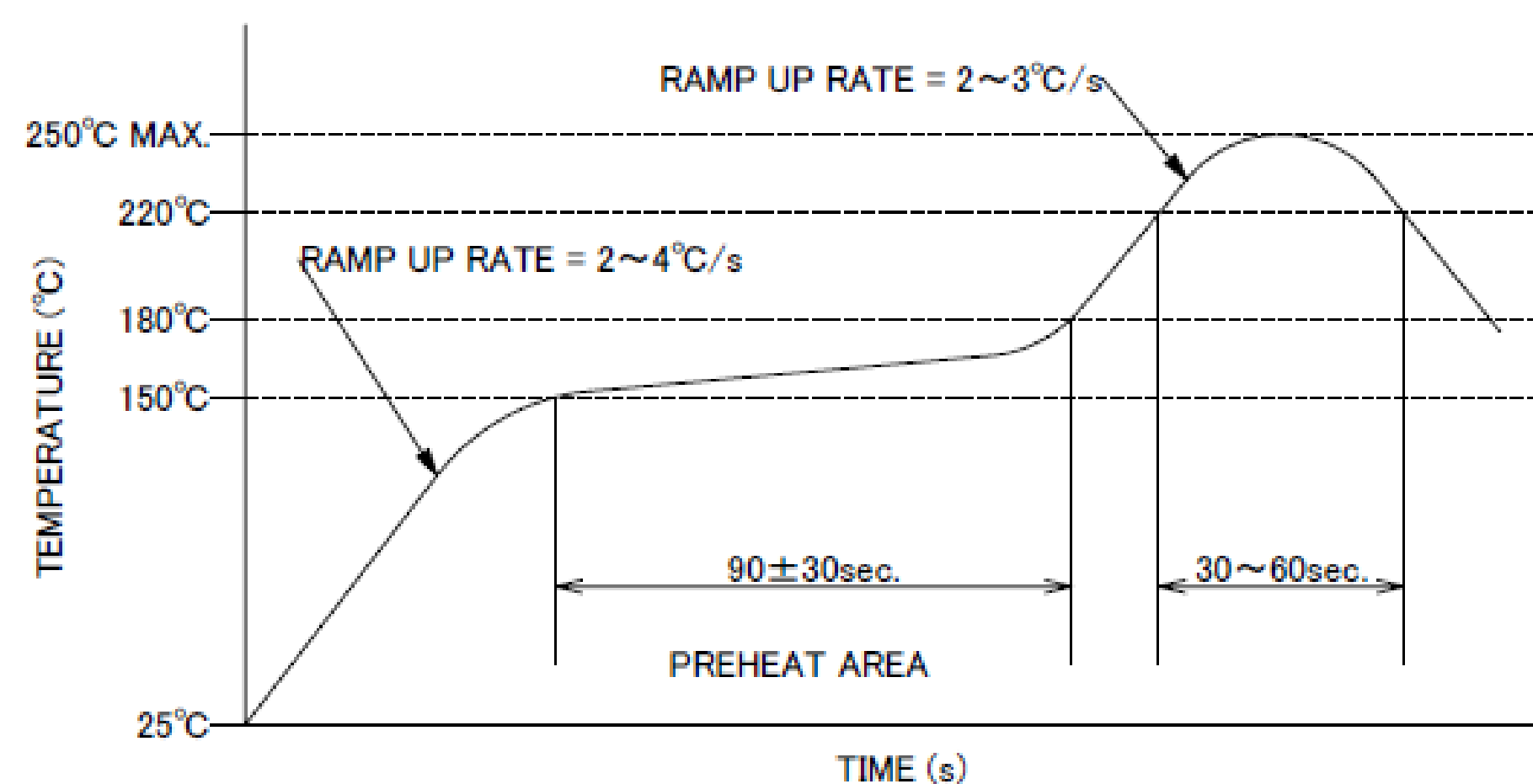
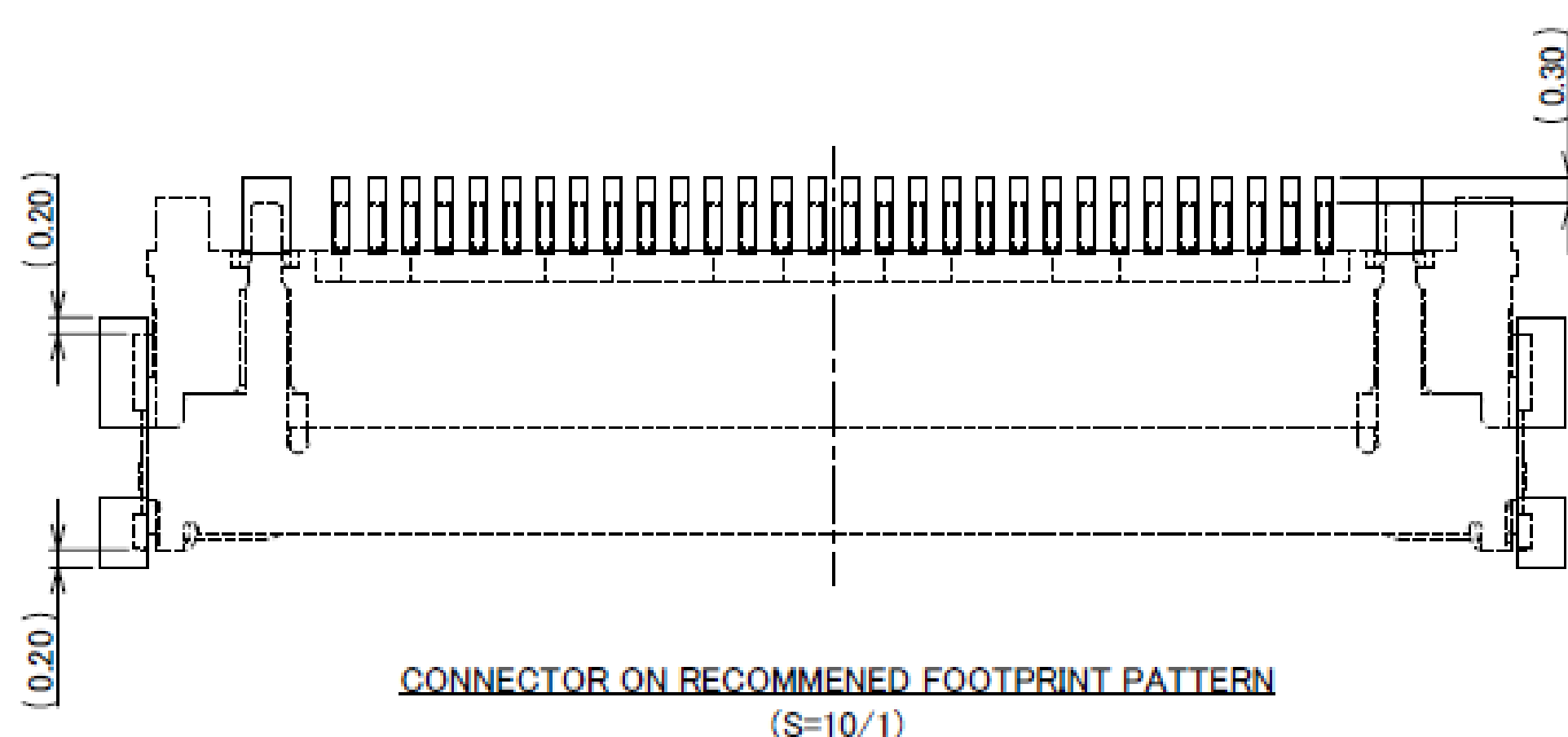

Rev.13

| ITEMS | SPECIFICATION |
|---------------------------------------|---|
| APPLICABLE CABLE | MICRO-COAXIAL CABLE : AWG# 40, 42, 44 DISCRETE WIRE : AWG# 36 |
| RATING VOLTAGE | 100V AC (PER CONTACT PIN) |
| RATING AMPERAGE (FOR CONTACT) | 0.1A AC/DC [AWG#44] PER CONTACT PIN 0.24A AC/DC [AWG#42] PER CONTACT PIN 0.3A AC/DC [AWG#40] PER CONTACT PIN 0.8A AC/DC [AWG#36] PER CONTACT PIN |
| OPERATING TEMPERATURE | 233~358K(-40°C~+85°C) |
| OPERATING HUMIDITY | 85% MAX.(NON-CONDENSING) |
| CONTACT RESISTANCE | INITIAL : 275mohm MAX. (AWG#36) / AFTER TEST : \triangle 40mohm MAX. 600mohm MAX. (AWG#40) 700mohm MAX. (AWG#42) 1080mohm MAX. (AWG#44) |
| GROUND SHELL RESISTANCE | INITIAL : 50mohm MAX. / AFTER TEST : \triangle 40mohm MAX. |
| INSULATION RESISTANCE | INITIAL : 1000Mohm MIN. / AFTER TEST : 500Mohm MIN. |
| DIELECTRIC WITHSTANDING VOLTAGE | AC250V 1min |
| DURABILITY | 30 CYCLES |
| MATING FORCE (INITIAL / AFTER TEST) | 30P : 10N MAX. 40P : 12N MAX. |
| UNMATING FORCE (INITIAL / AFTER TEST) | 30P : 3.0N MIN. 40P : 4.0N MIN. |
| CABLE RETENTION FORCE | 30P : 14.70N MIN. 40P : 19.60N MIN. |
| PRODUCT SPECIFICATION | PRS-1421 |
| TEST REPORT | TR-08030 |
| INSTRUCTION MANUAL | HIM-09002 |
| ASSEMBLY MANUAL | ASM-09002 |
| APPEARANCE CRITERIA No. | QLS-A*** |

Rev.13

Custom Connectors Available

 RF Connector

MHF® series



CABLINÉ® series
Micro-coaxial/Twinax/
Discrete Wire Connector

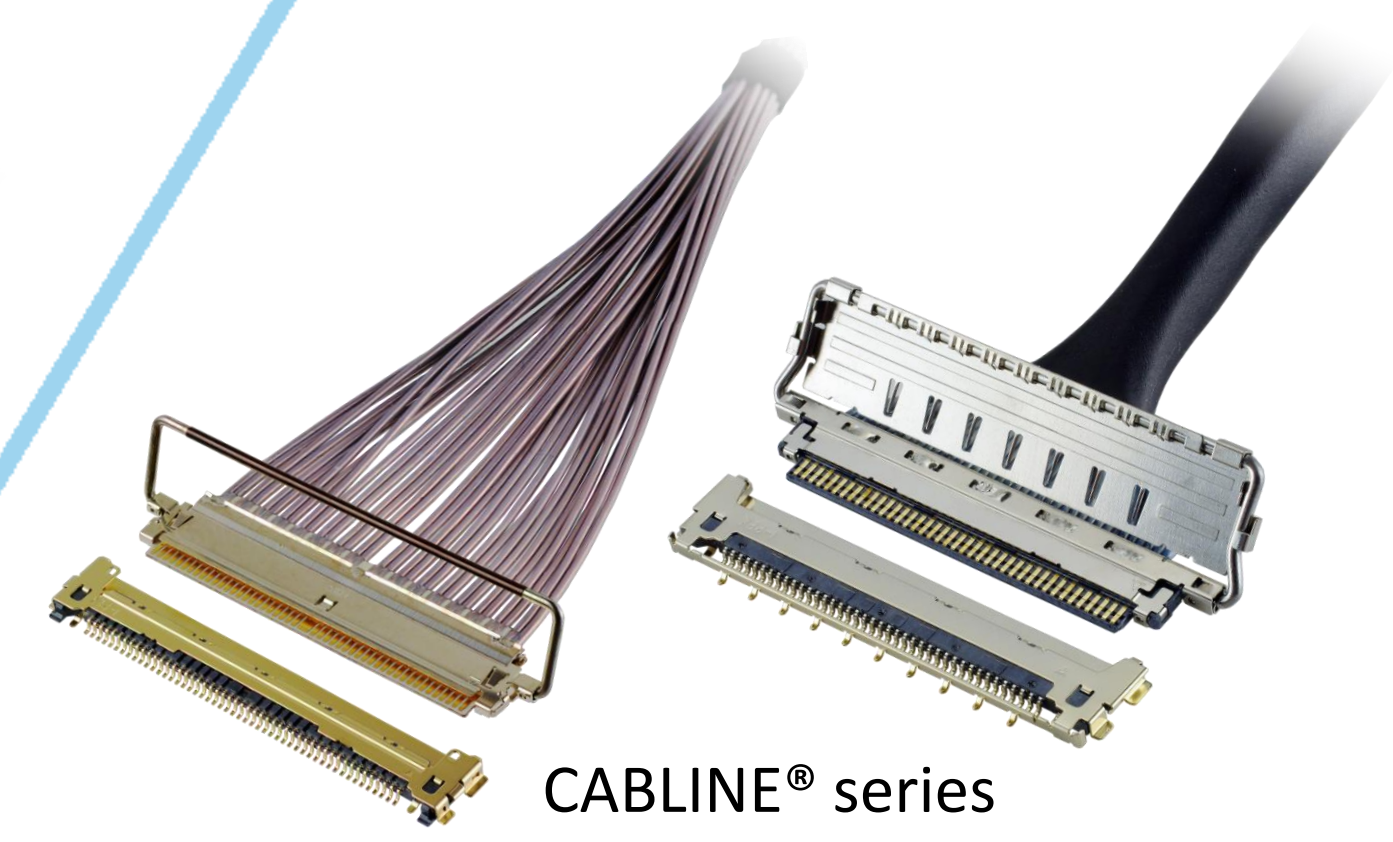

Optical Module

LIGHTPASS® series



NOVASTACK® series



Board-to-Board Connector

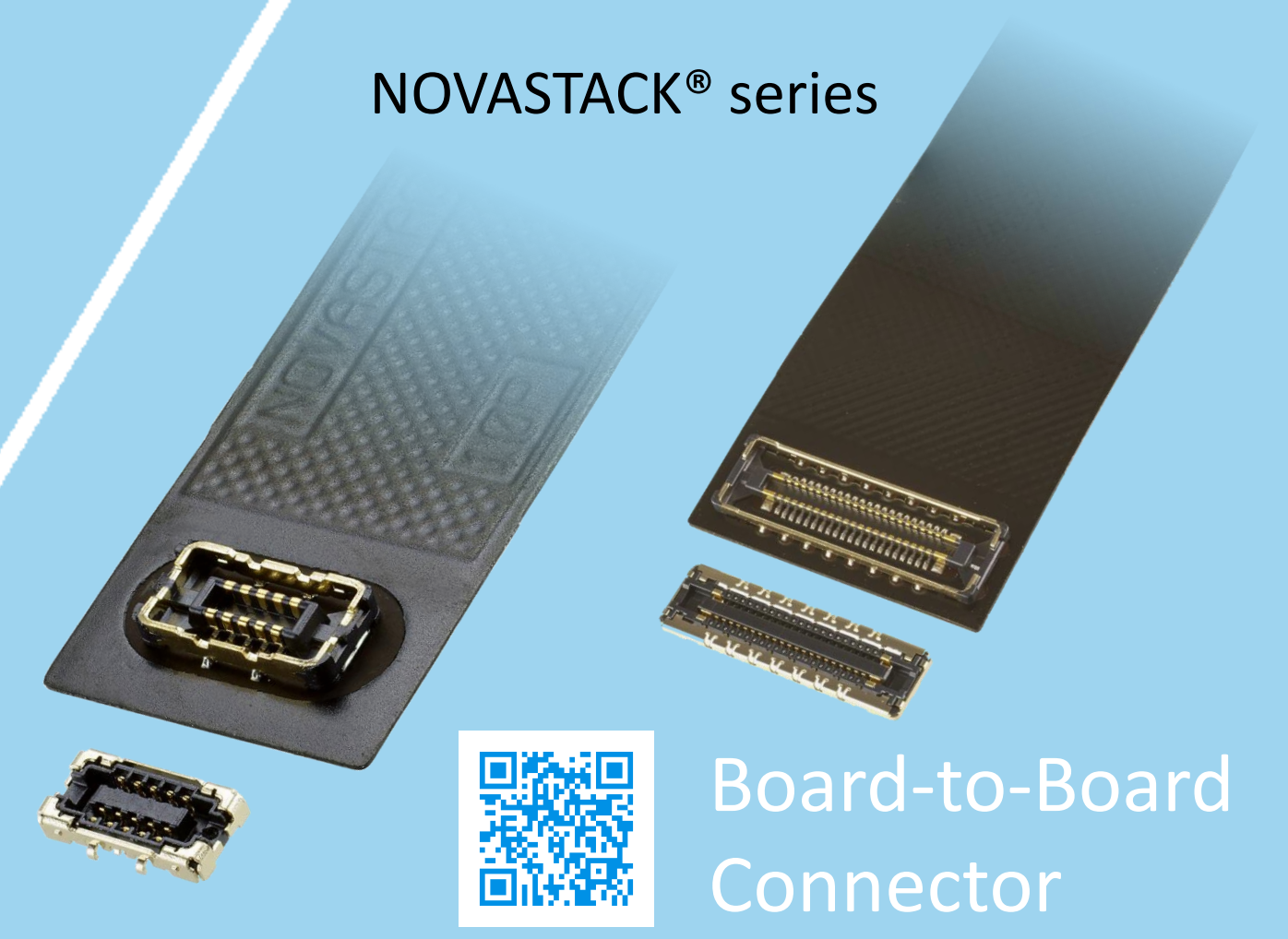

Power Connector/
Terminal

AP series

ISH® series



MINIFLEX® series

EVAFLEX® series



FPC FFC Connector



Inquiry



MINIDOCK® series



I/O Connector

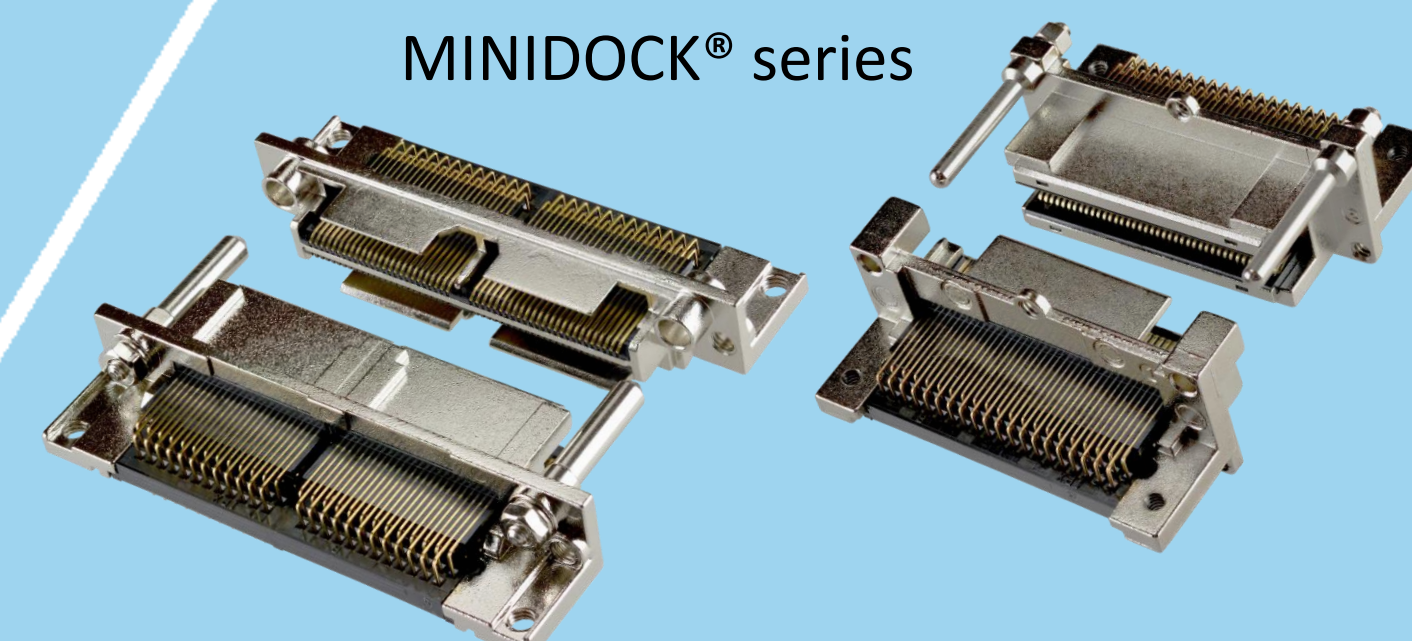

I-PEX, MHF, CABLINE, LIGHTPASS, NOVASTACK, ISH, IARPB, MINIFLEX, EVAFLEX, MINIDOCKS and ZenShield are registered trademarks of I-PEX Inc. Please note that the contents in the catalog might be changed without prior notification. I-PEX Inc. assumes no responsibility for any inaccuracies or obligation to update information on these documents. Please be sure to read and understand the latest "Precautions for Use" and "Instruction Manual" before you use our products. We shall not be responsible for any defects, damages or troubles in case you use our products without following the precautions for use. Please feel free to contact our sales representatives when you use our products for any applications that require very high reliability and safety, or that relate to human life (ex. nuclear power control, aerospace, transportation, medical equipment, safety equipment etc.).

Contact your sales representative or more detailed information.

www.i-pex.com

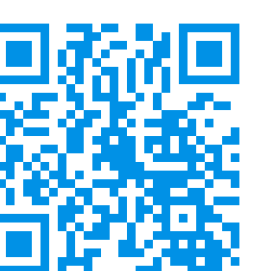

I-PEX

© I-PEX Inc. 2024
All rights reserved